



Temecula Office Sublease

27450 Ynez Road, Suite 316
Temecula, CA 92591

Key Highlights

- Seven private offices, 3 built-in cubicles, conference room, built-in reception desk, kitchen/ break room and private restroom.
- Furniture can be made available
- Class A building
- Restaurants within easy walking distance
- Immediate Occupancy
- Centrally located



Through July 31, 2026



\$2.00 / sf + Electric



3,373 RSF



Move-In Ready

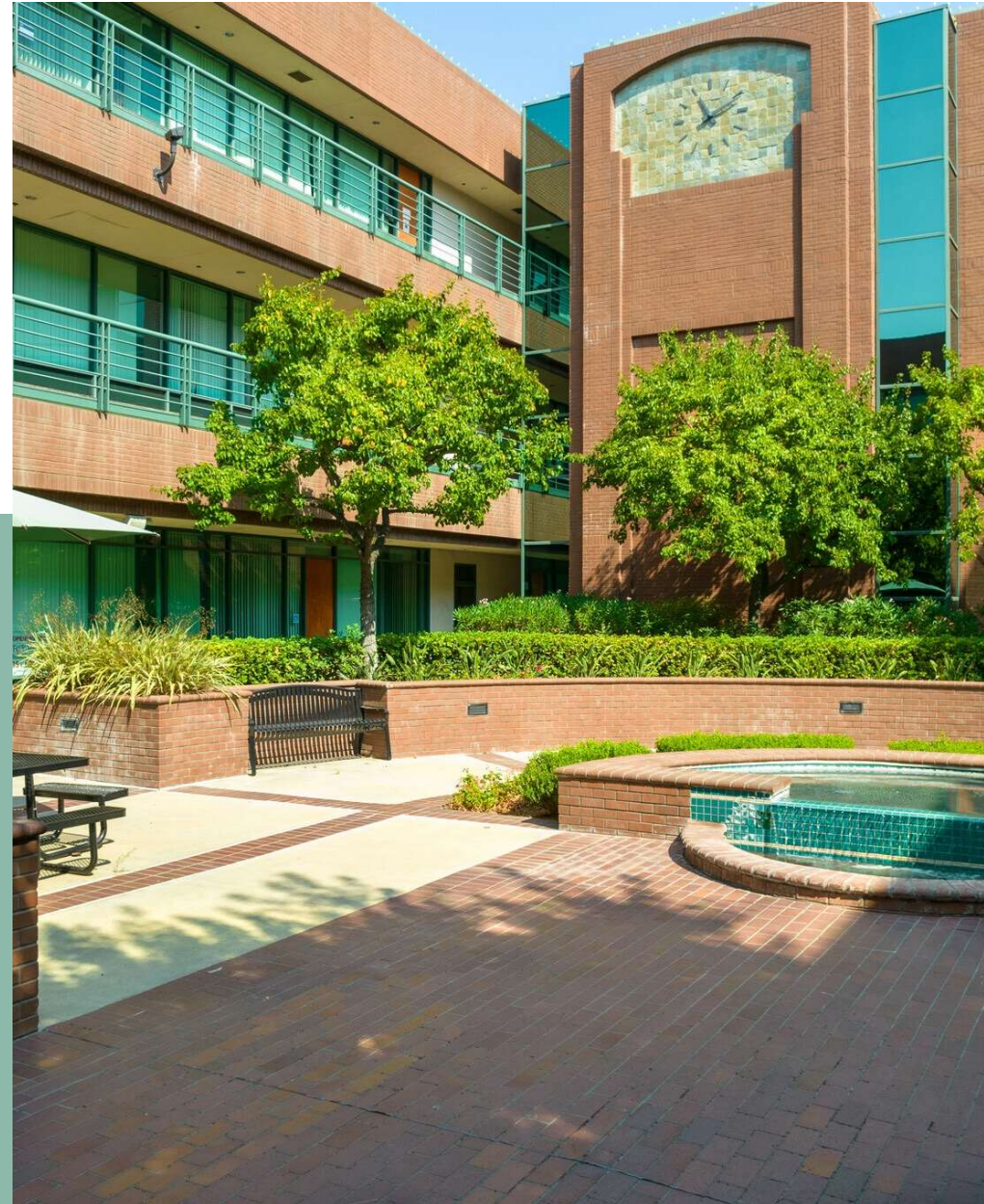

Carter+Co

Travis Carter
+ 619 665 1887
travis@carterco.us
carterco.us

Information contained herein has been obtained from sources deemed reliable. While we believe this information to be true, Carter+Co makes no guarantee, warranties or representations as to the completeness or accuracy thereof. All information submitted is subject to errors and/or omissions.



SUBLEASE
27450 Ynez Rd, Suite 316
Temecula, CA 92591



Carter+Co

Travis Carter
+ 619 665 1887
travis@carterco.us
carterco.us

Information contained herein has been obtained from sources deemed reliable. While we believe this information to be true, Carter+Co makes no guarantee, warranties or representations as to the completeness or accuracy thereof. All information submitted is subject to errors and/or omissions.



Suite 316 Floor Plan Details:

- RECEPTION:** 10' x 10' (10' x 10' AREA) - REMOVE EXISTING RECEPTION DESK, PLASTER AND MOULD WALL TEE. 4" CIRCLE OVER. FUSE WALL CAPS.
- TRANSACTION TOP:** 10' x 10' (10' x 10' AREA) - REMOVE EXISTING TRANSACTION TOP. TOTAL WIDTH CENTERED OVER 8" WIDE POINT SALL. 10" x 10" AREA. APPROX. 10' x 10' OR PER OWNER.
- WALL CAPS:** 10' x 10' (10' x 10' AREA) - WORK TOP TRANSACTION TOP AND WALL CAPS ARE TO BE PLASTIC LAMINATE "DOVE GRAY".
- RESTROOM:** 10' x 10' (10' x 10' AREA) - REMOVE EXISTING RESTROOM. 10' x 10' AREA. 10' x 10' AREA.
- UTILITIES:** 10' x 10' (10' x 10' AREA) - REMOVE EXISTING UTILITIES. 10' x 10' AREA.
- BALCONY:** 10' x 10' (10' x 10' AREA) - BALCONY RAILING.
- ADJACENT SUITE 315:** 10' x 10' (10' x 10' AREA) - ADJACENT SUITE 315.
- ADJACENT SUITE 318:** 10' x 10' (10' x 10' AREA) - ADJACENT SUITE 318.
- TO STAIR AND RESTROOMS:** 10' x 10' (10' x 10' AREA) - TO STAIR AND RESTROOMS.
- COURTYARD BELOW:** 10' x 10' (10' x 10' AREA) - COURTYARD BELOW.

Information contained herein has been obtained from sources deemed reliable. While we believe this information to be true, Carter+Co makes no guarantee, warranties or representations as to the completeness or accuracy thereof. All information submitted is subject to errors and/or omissions.