

# Monroe County - Parcel: 146G D 006.00

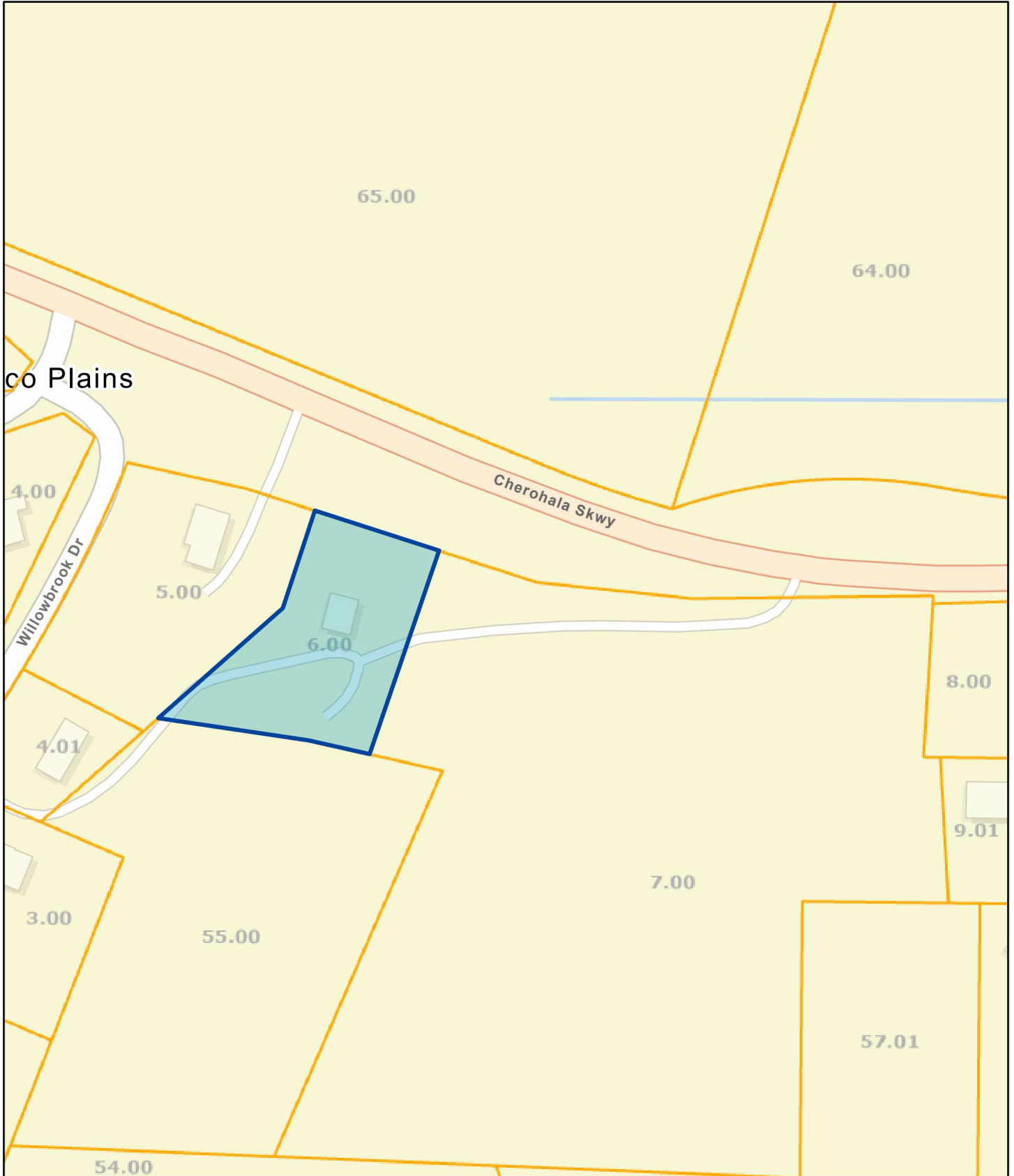

Date: May 29, 2026

County: MONROE  
Owner: VSM PROPERTIES LLC  
Address: HWY 165 1012  
Parcel ID: 146G D 006.00  
Deeded Acreage: 0  
Calculated Acreage: 0

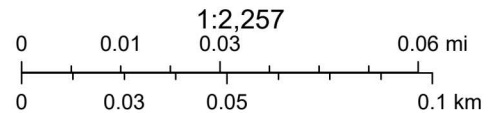

State of Tennessee, Comptroller of the Treasury, Division of Property Assessments (DPA), Esri Community Maps Contributors, State of North Carolina DOT, © OpenStreetMap, Microsoft, Esri, TomTom, Garmin, SafeGraph, GeoTechnologies, Inc, METI/NASA, USGS, EPA, NPS, US Census Bureau, USDA, USFWS

The property lines are compiled from information maintained by your local county Assessor's office but are not conclusive evidence of property ownership in any court of law.