

MEADOWGLEN BUSINESS PARK
11381 MEADOWGLEN, SUITE F
HOUSTON TEXAS 77082

MAP 

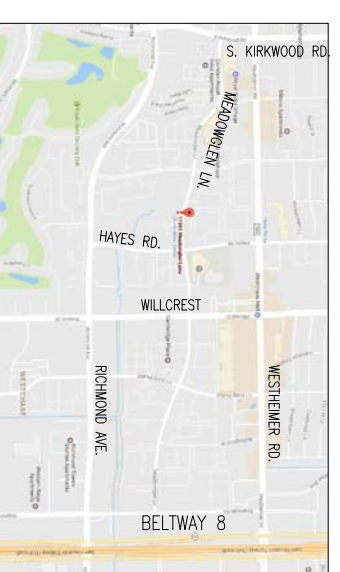

SITE PLAN 

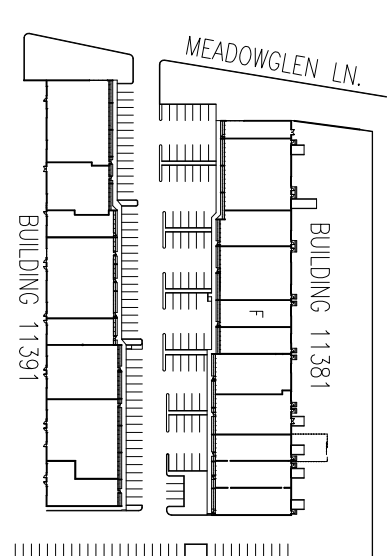

BUILDING SUMMARY

OFFICE AREA: 2,110 SQ. FT.
WAREHOUSE AREA: 290 SQ. FT.
TOTAL AREA: 2,400 SQ. FT.

BUILDING FEATURES

MASTER PLANNED BUSINESS PARK
CONCRETE TILT WALL CONSTRUCTION
SEMI DOCK HIGH REAR LOADING DOOR
14' AVERAGE CLEAR HEIGHT
ALL CONCRETE PAVING

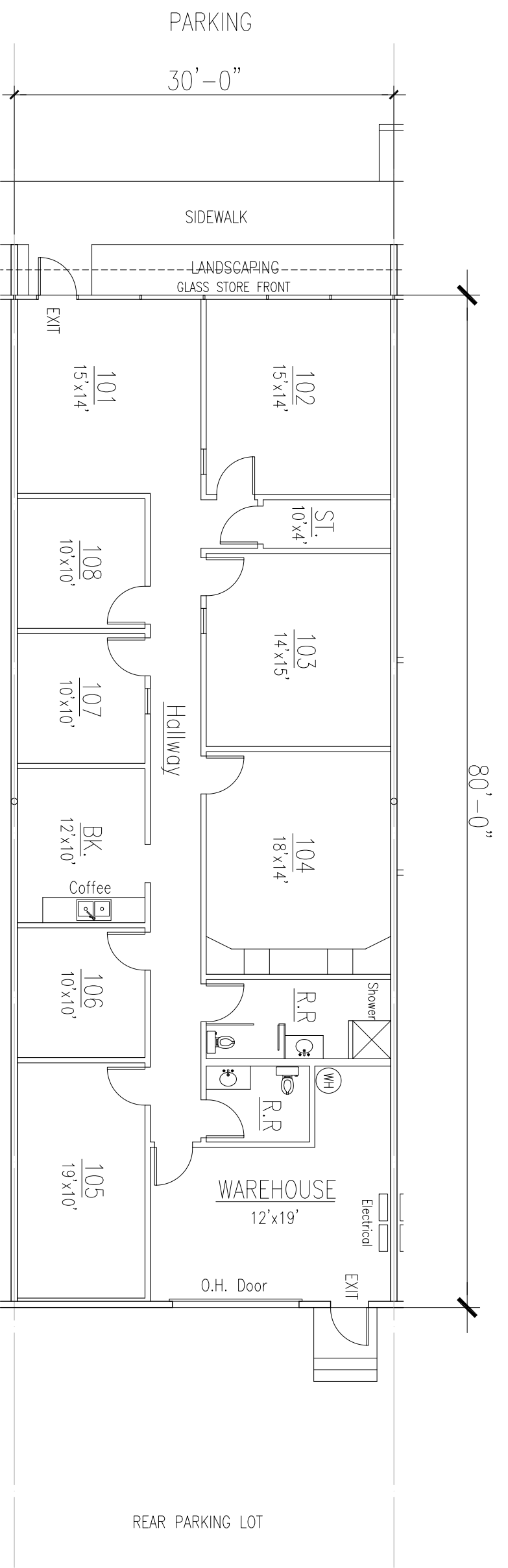

SUITE F FLOOR PLAN



NORTH 