

1.26 +/- Acres at Fieldstown Road and Chapelridge Drive Gardendale, AL at exit 271 I-65

\$225,000

1033 Fieldstown Road
Gardendale, AL 35071



PROPERTY DETAILS

- All utilities available
- 250 ft. frontage on Fieldstown Road
- Corner Property has frontage on Fieldstown Road and Chapelridge Drive
- Great location and excellent visibility near exit 271, I-65



POSSIBLE USES

- Retail
- Self Storage
- Office
- Conv Store



Bobby Bynum
205.500.1188
bobby@bobbybynum.com

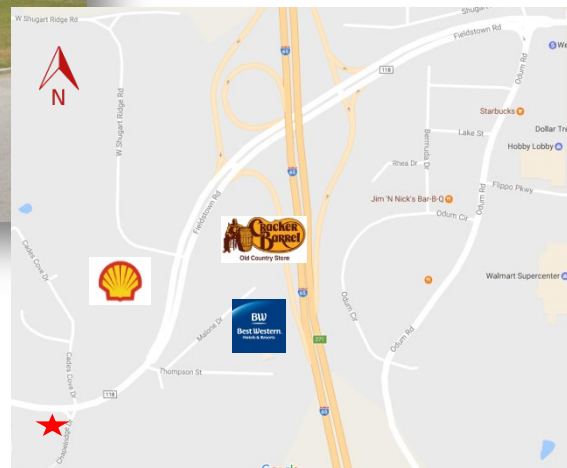

RE/MAX First Choice • 201 Amphitheater Road • Pelham, AL 35124

All information provided is deemed reliable but is not guaranteed and should be independently verified. All information is subject to change without notice including withdrawal of this listing. No warranty or representation is made as to the condition of the property.



Corner Lot located at the entrance to High Gate Apartments, 200 units.

Turn lanes installed on Fieldstown Road.

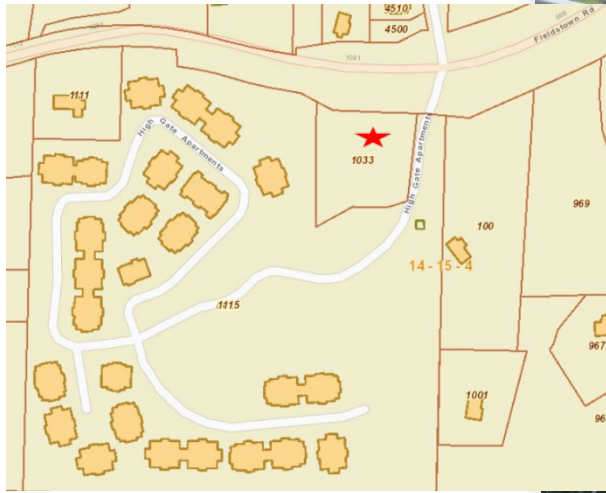

Bobby Bynum
205.500.1188
bobby@bobbybynum.com

RE/MAX First Choice • 201 Amphitheater Road • Pelham, AL 35124

All information provided is deemed reliable but is not guaranteed and should be independently verified. All information is subject to change without notice including withdrawal of this listing. No warranty or representation is made as to the condition of the property.