



For Sale

Industrial/Warehouse Condominium

Hugo F. Overdeput, CCIM

Vice President
+1 603 560 2764
hugo.overdeput@colliers.com



175 Canal Street, Suite 401
Manchester, NH 03101
+1 603 623 0100
colliersnh.com

4 Wilder Drive, Unit 7 & 9 Plaistow, NH

Property Highlights

- 15,656± SF industrial/warehouse condominium available for sale in Fieldstone Industrial Park in Plaistow, NH
- Space consists of 2,100± SF of office and 13,526± SF of warehouse
- Warehouse features a 15'± to 20'± clear height, 2 loading docks, 1 drive-in door, and security system
- HVAC in office and radiant heat in the warehouse
- Restrooms in warehouse and office area
- Water on community well until end of 2025, then will switch to public water
- Easily accessible from Route 125, I-495, and the MA border

Information herein has been obtained from sources deemed reliable, however its accuracy cannot be guaranteed by Colliers International | New Hampshire & Maine. The user is required to conduct their own due diligence and verification. Colliers International | New Hampshire & Maine is independently owned and operated.

For Sale

Specifications

Address:	4 Wilder Drive, Unit 7 & 9
Location:	Plaistow, NH 03865
Building Type:	Industrial
Year Built:	2003
Condominium SF:	15,656± <ul style="list-style-type: none">• Office: 2,100±• Warehouse: 13,526±
Utilities*:	Community well & septic; T1 data lines HVAC (office) & radiant/propane gas (whse)
Zoning:	Industrial
Clear Height:	15'± to 20'±
Drive-in Door:	1 (14' x 14')
Loading Docks:	2
Security System:	Yes
Power:	400A; 480V; 3 phase
Parking:	20± on-site spaces
2025 Taxes:	\$11,920
Condominium Fees:	\$1,939.80/month
List Price:	See Agent

**Utilities are separately metered.*

Locator Map

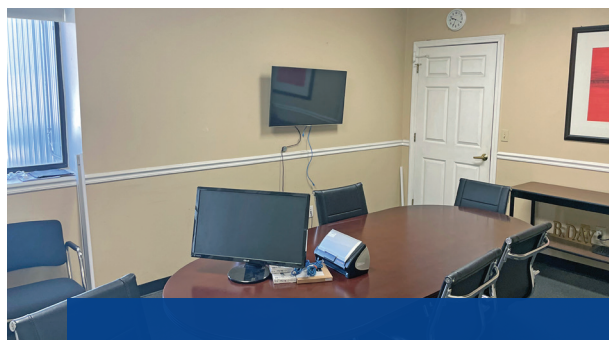
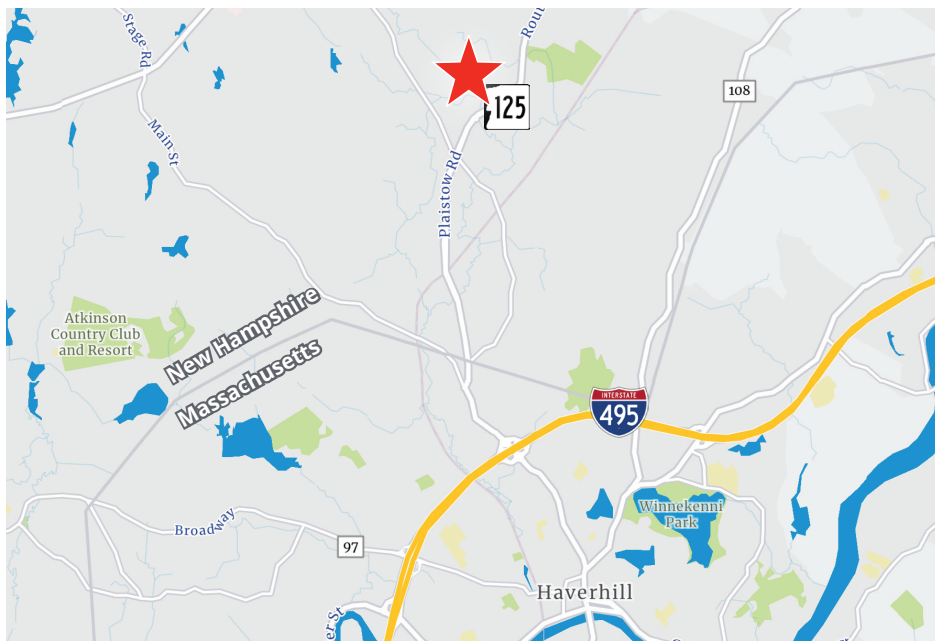

Contact us:

Hugo F. Overdeput, CCIM

Vice President
+1 603 560 2764
hugo.overdeput@colliers.com

Colliers

175 Canal Street, Suite 401
Manchester, NH 03101
+1 603 623 0100
colliersnh.com



Floor Plan

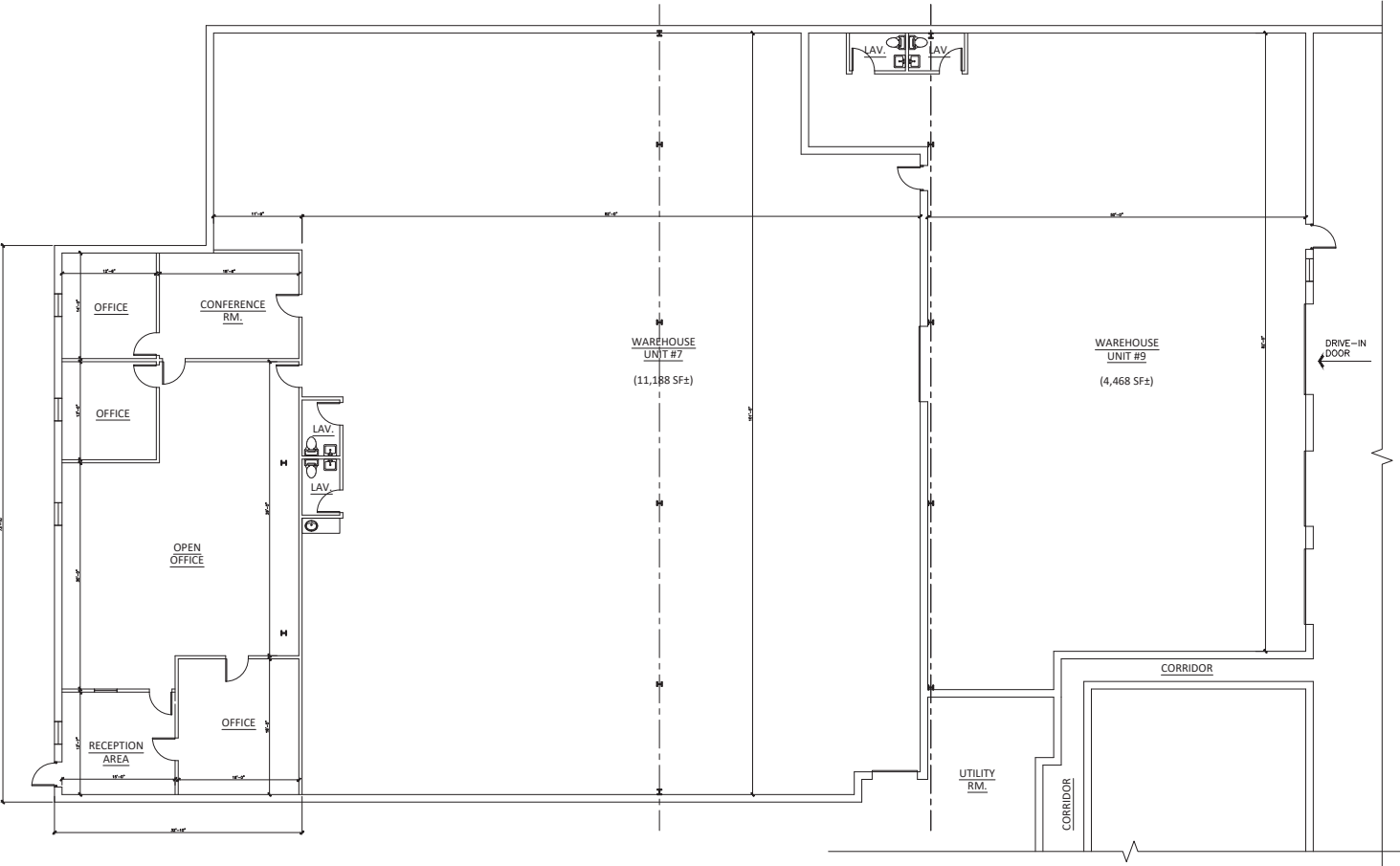

1
A2 EXISTING SCHEMATIC LEASE SPACE PLAN
SCALE: 1/8" = 1'-0"

PROJECT: LEASE SPACE PLAN FOR TOWB REALTY, LLC 4 WILDER DRIVE, UNITS 7 & 9 PLAISTOWN, ROCKINGHAM COUNTY, NEW HAMPSHIRE FILE #: 23108		
DRAWN: F. BRANCATO DATE: 2/23/23	SHEET No:	
	A-1	
DWG. TITLE: EXISTING SCHEMATIC LEASE SPACE PLAN UNITS 7 & 9	SCALE: 1/8" = 1'-0"	1 OF 1

*Not to scale