



FOR LEASE

675 Endeavor Circle, Brea, CA 92821

+45,227 SF

Warehouse Distribution

PROPERTY HIGHLIGHTS

- **Building Size:** ±45,227 SF
- **Lot Size:** 2.29 acres
- **Office Space:** ±3,000 SF of high-quality office area
- **Dock Doors:** Three (3) dock-high doors
- **Ground Level Doors:** Three (3) ground-level doors
- **Clear Height:** 24'
- **Power Supply:** 800 AMPS, 277/480V, 3-phase
- **Parking:** 86 surface parking spaces
- **Fenced Yard:** Large secure yard
- **Fire Sprinklers:** Yes .45/3,000 GPM

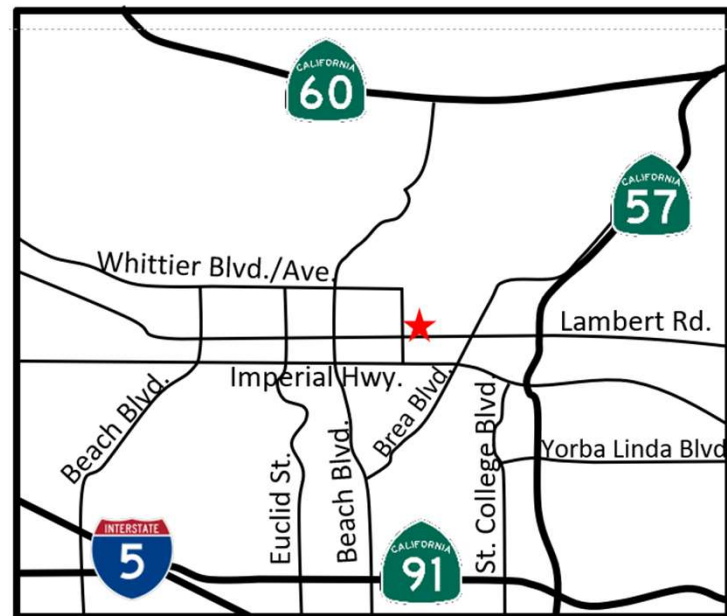

*Map Not to Scale

CLICK HERE 

www.675endeavor.com

GARY MARTINEZ, CCIM, SIOR

(714) 905-9383

gary@ashwillassociates.com

CA DRE Lic.#01318932

STEVE CRANE

(714) 856-29233

stevec@ashwillassociates.com

CA DRE Lic.#00844752

SITE PLAN

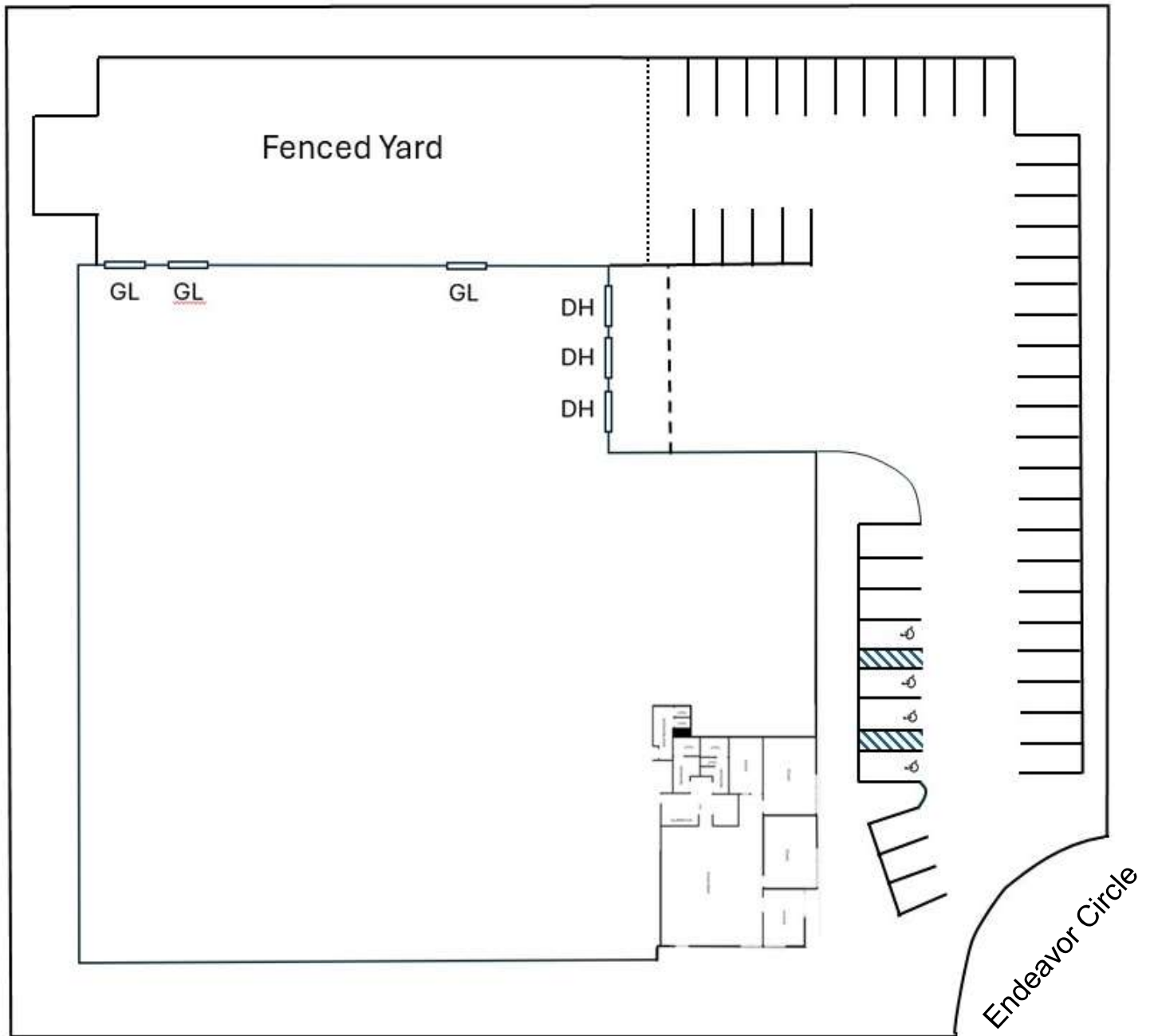

CLICK HERE 

www.675endeavor.com

GARY MARTINEZ, CCIM, SIOR

(714) 905-9383

gary@ashwillassociates.com

CA DRE Lic.#01318932

STEVE CRANE

(714) 856-29233

stevec@ashwillassociates.com

CA DRE Lic.#00844752

PROPERTY PHOTOS



Three (3) Dock Doors



Large Fenced Yard



Free Standing Building

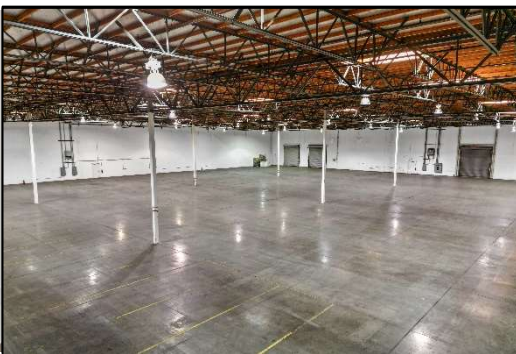

Warehouse w/ 24' Ceiling Height



Ground Doors in Yard



Kitchen



Office Space



800 AMPS, 277/480V, 3-phase



Lobby

CLICK HERE 

www.675endeavor.com

GARY MARTINEZ, CCIM, SIOR

(714) 905-9383

gary@ashwillassociates.com

CA DRE Lic.#01318932

STEVE CRANE

(714) 856-29233

stevec@ashwillassociates.com

CA DRE Lic.#00844752