

# Beacon

Commercial Real Estate, LLC



**161 LEVERINGTON AVE | PHILADELPHIA, PA**

## PROPERTY HIGHLIGHTS:

- Divisible up to 5,500 SF
- Ground floor
- Off street parking
- Reserved covered parking available
- High tech loft type space
- Manayunk amenities
- \$22.00 psf plus utilities & janitorial

**For more information call:**

**Jere Shertzer**

[jshertzer@beaconcre.com](mailto:jshertzer@beaconcre.com)

**484-433-5090**

290 King of Prussia Road | Building 1 | Suite 200 | Radnor, PA 19087 | 610.828.0100 (o) | 610.828.3873 (f) | [www.beaconcre.com](http://www.beaconcre.com)

No warranty or representation, expressed or implied, is made as to the accuracy of the information contained herein, and same is submitted subject to errors, omissions, change of price, rental or other conditions, withdrawal without notice, and to any special listing conditions imposed by our principals.

## 161 LEVERINGTON AVE | PHILADELPHIA, PA

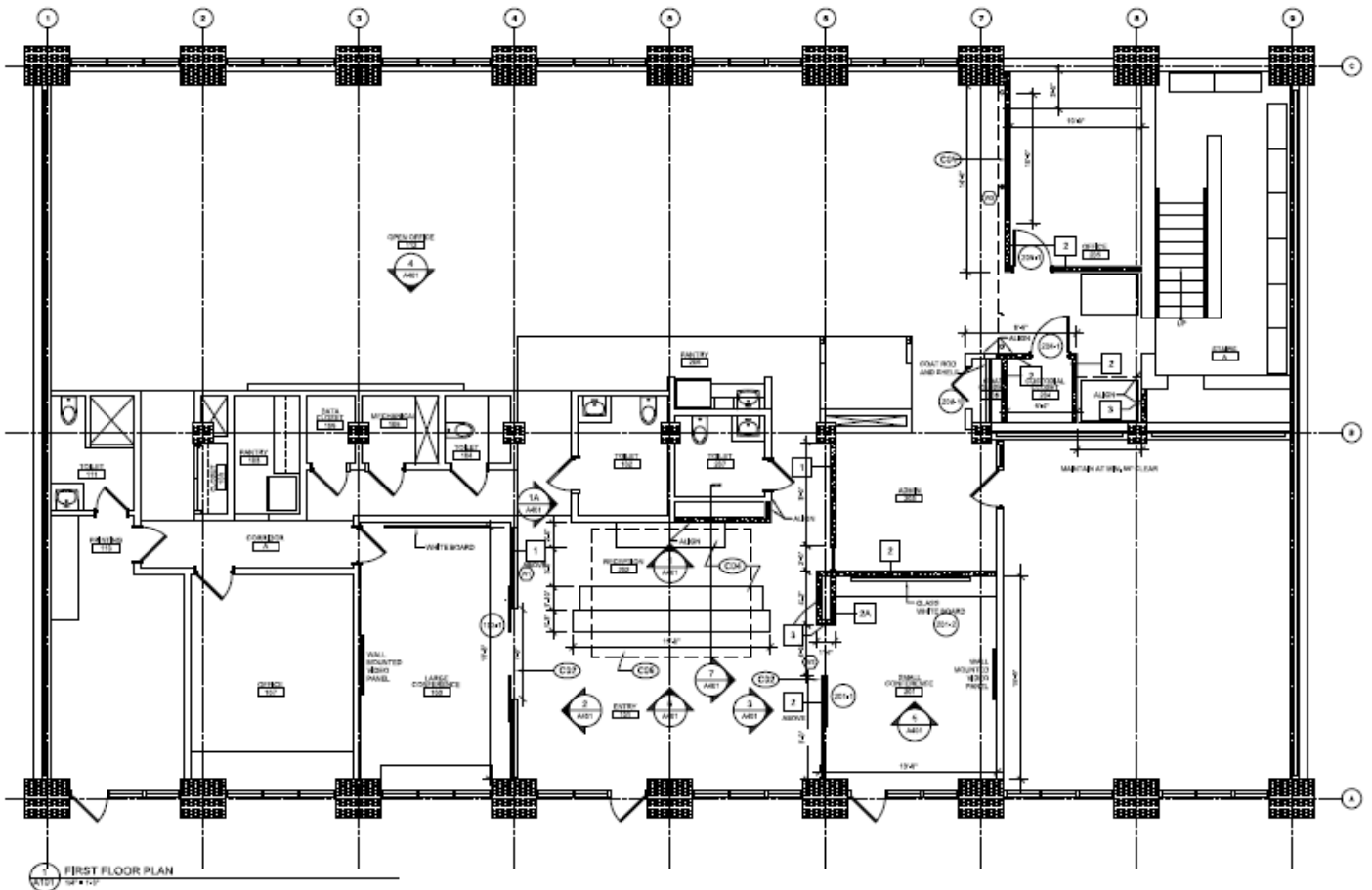
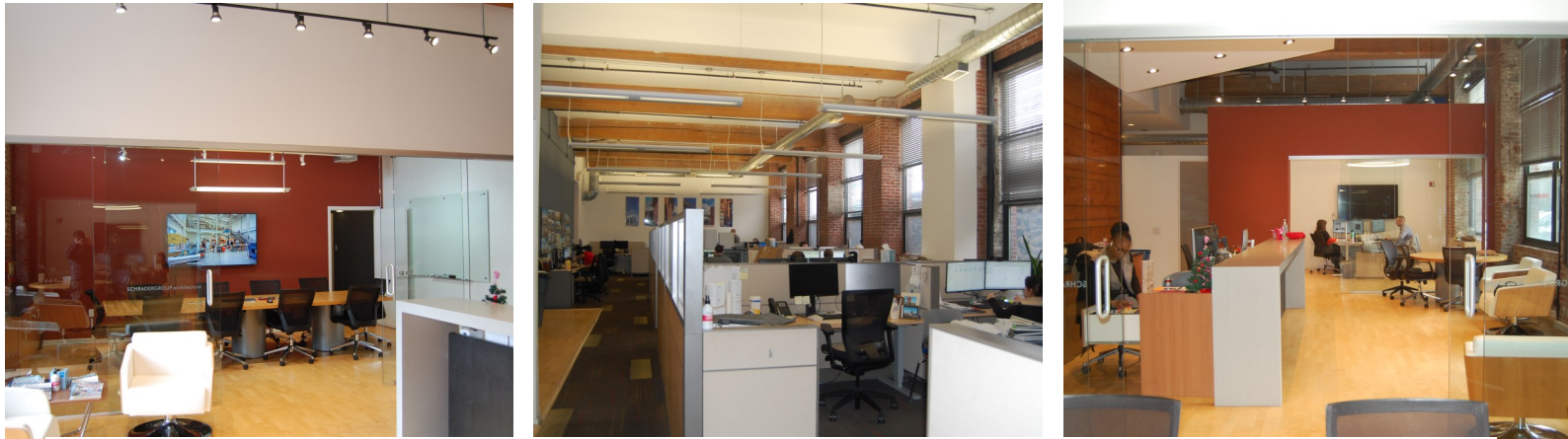

**Jere Shertzer** [jshertzer@beaconcre.com](mailto:jshertzer@beaconcre.com) | 610.828.0100

290 King of Prussia Road | Building 1 | Suite 200 | Radnor, PA 19087 | 610.828.0100 (o) | 610.828.3873 (f) | [www.beaconcre.com](http://www.beaconcre.com)

No warranty or representation, expressed or implied, is made as to the accuracy of the information contained herein, and same is submitted subject to errors, omissions, change of price, rental or other conditions, withdrawal without notice, and to any special listing conditions imposed by our principals.