



Freeway-Visible Warehouse Spaces Available | ±754 SF - 3,004 SF

FOR LEASE

# Lone Palm Industrial Park

Lone Palm Avenue + N Emerald Avenue | Modesto, CA 95351

**STEVE DUNN**  
Senior Director  
+1 209 992 0953  
[steve.dunn@cushwake.com](mailto:steve.dunn@cushwake.com)  
CA Lic #01410812

©2025 Cushman & Wakefield. All rights reserved. The information contained in this communication is strictly confidential. This information has been obtained from sources believed to be reliable but has not been verified. NO WARRANTY OR REPRESENTATION, EXPRESS OR IMPLIED, IS MADE AS TO THE CONDITION OF THE PROPERTY (OR PROPERTIES) REFERENCED HEREIN OR AS TO THE ACCURACY OR COMPLETENESS OF THE INFORMATION CONTAINED HEREIN, AND SAME IS SUBMITTED SUBJECT TO ERRORS, OMISSIONS, CHANGE OF PRICE, RENTAL OR OTHER CONDITIONS, WITHDRAWAL WITHOUT NOTICE, AND TO ANY SPECIAL LISTING CONDITIONS IMPOSED BY THE PROPERTY OWNER(S). ANY PROJECTIONS, OPINIONS OR ESTIMATES ARE SUBJECT TO UNCERTAINTY AND DO NOT SIGNIFY CURRENT OR FUTURE PROPERTY PERFORMANCE.



**Property Highlights**

**1325 Lone - Unit A**

Availability: **Available Now**  
 Asking Rate: **\$850/mo Modified Gross**  
 Available SF: **±847 SF**  
 Clear Height: **±12'-14'**  
 GL Doors: **One (1) GL Roll Up Doors**

**1325 Lone - Unit C**

Availability: **Available Now**  
 Asking Rate: **\$800/mo Modified Gross**  
 Available SF: **±754 SF**  
 Clear Height: **± 12'-14'**  
 GL Doors: **One (1) GL Doors (10' x 12')**

**1325 Lone - Unit D,E & F**

Availability: **Available Now**  
 Asking Rate: **\$2,300/mo Modified Gross**  
 Available SF: **• Unit D-F: ±2,264 SF; Open Space w/no walls  
 • May be able to be demised to Units that are  
 ±754 SF with (1) Grade Level Door each**  
 Clear Height: **±12'-14'**  
 GL Doors: **Three (3) GL Doors (10' x 12')**  
 Power: **110 Volts & some units have 220 Volts**

Property  
Features:

- **Common area restroom**
- **Chain link entry gate**
- **Electricity, water, sewer included**
- **No garbage service provided**
- **No outdoor storage without written approval by Landlord**

**Aerial View**



**Property Photos**



All properties require first month's rent, a security deposit and an insurance certificate, along with an executed Lease. Credit report, bank or financial information will be required.

Floor Plan

1325 Lone Palm - Unit A / Unit C / Unit D, E, F

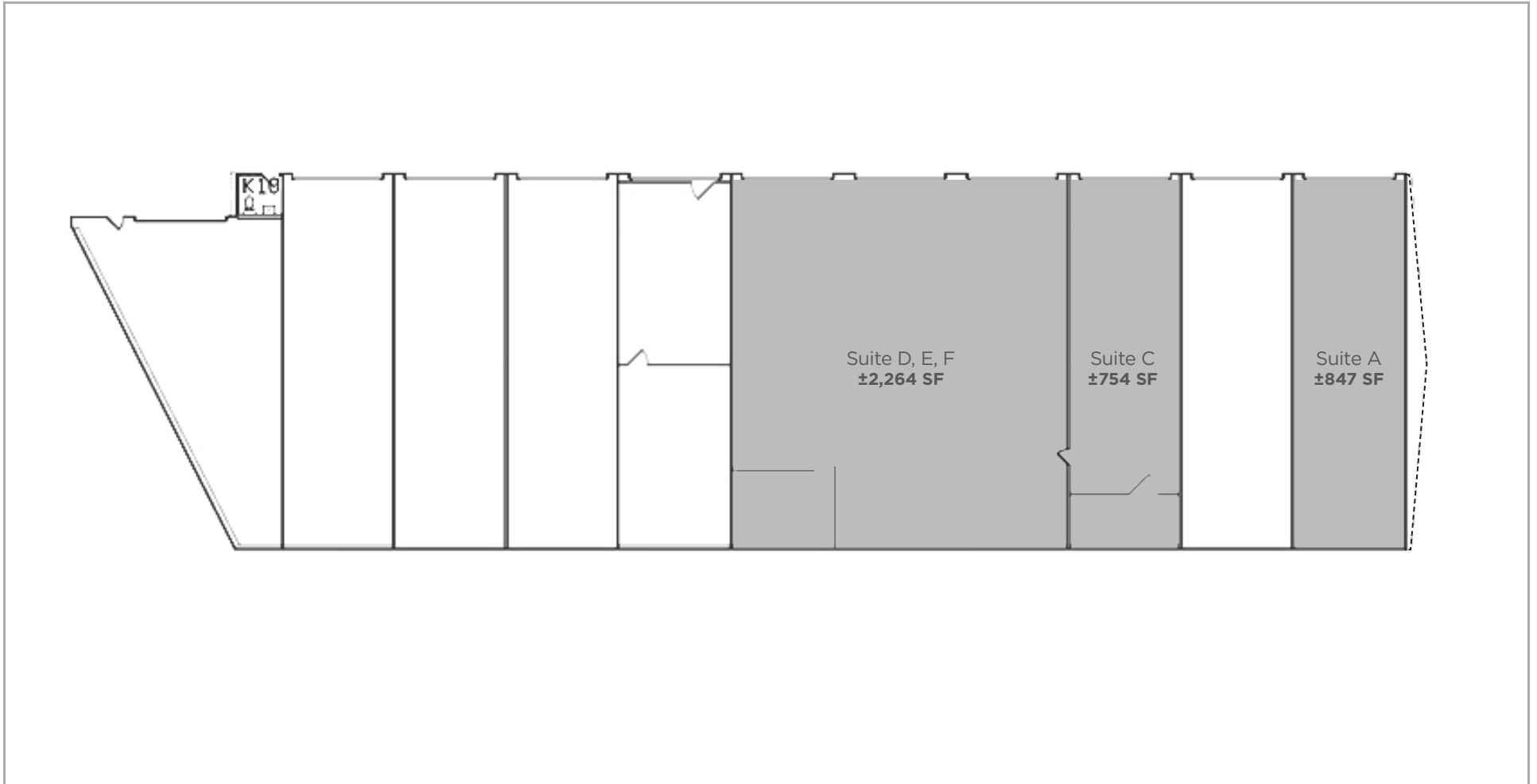

All properties require first month's rent, a security deposit and an insurance certificate, along with an executed Lease. Credit report, bank or financial information will be required.

Property Highlights

**1503 Lone Palm - Unit F & G**

Availability: **May/June 2025**

Asking Rate: **\$3,345/mo Modified Gross**

Available SF: **±3,004 SF Warehouse**

GL Doors: **Two (2) GL Doors - 10' X 12'**

Property  
Features:

- **Small office**
- **Private Restroom**
- **Fenced & Gated Entry**
- **Includes electricity, water, sewer**
- **No garbage service is provided**
- **No outdoor storage without approval by Landlord**

Clear Height: **±15'**

**Aerial View**



**Property Photos**



All properties require first month's rent, a security deposit and an insurance certificate, along with an executed Lease. Credit report, bank or financial information will be required.

Floor Plan

1503 Lone Palm - Unit F & G

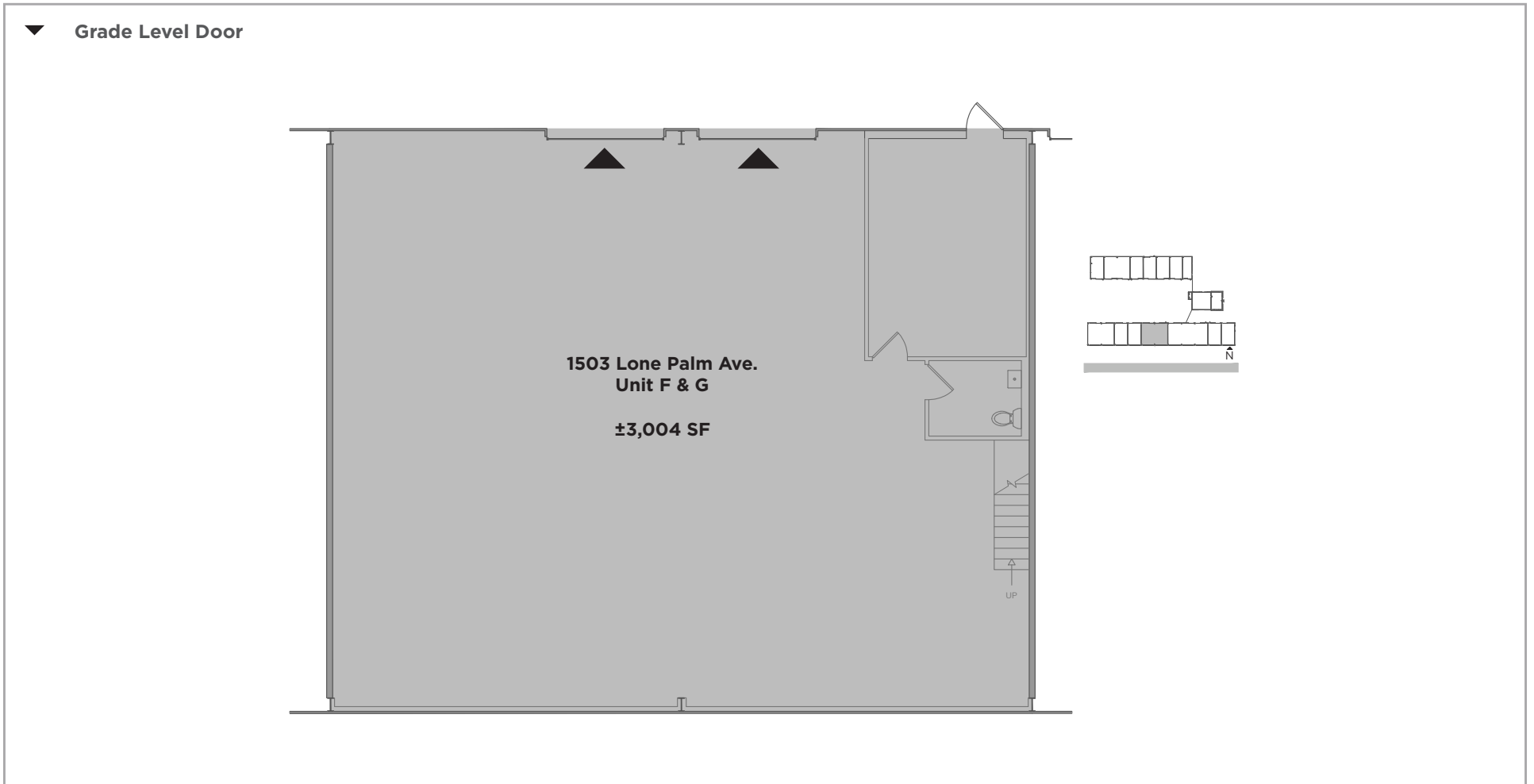

All properties require first month's rent, a security deposit and an insurance certificate, along with an executed Lease. Credit report, bank or financial information will be required.

Property Highlights

1511 Lone Palm - Unit H

Availability: **Available Now**

Asking Rate: **\$1,695/mo Modified Gross**

Available SF: **±1,493 SF**

Space Dimension: **± 30'W x 50'L**

Clear Height: **±15'**

GL Doors: **One (1) GL Door Per Unit; 10' x 12'**

Power: **110 Volts**

Property  
Features:

- **Common Restroom**
- **Fenced & Gated Entry**
- **Includes electricity, water, sewer**
- **No garbage service is provided**
- **No outdoor storage without approval by Landlord**

Aerial View

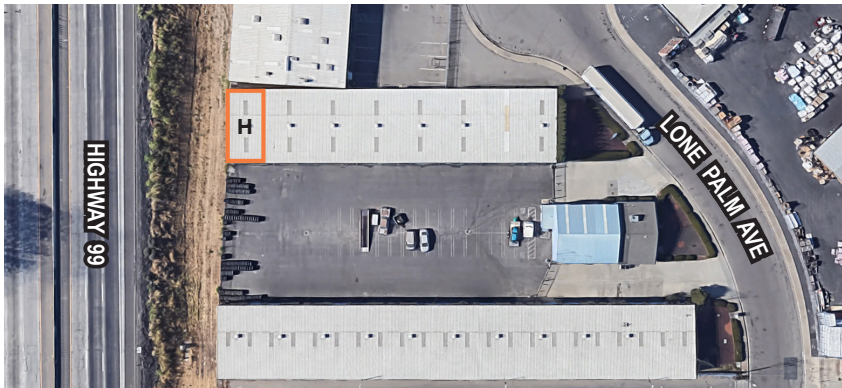

Property Photos



All properties require first month's rent, a security deposit and an insurance certificate, along with an executed Lease. Credit report, bank or financial information will be required.

Floor Plan

1511 Lone Palm Ave - Unit H



All properties require first month's rent, a security deposit and an insurance certificate, along with an executed Lease. Credit report, bank or financial information will be required.