

254

West Broadway Road

Mesa, Arizona 85210

AVAILABLE FOR SALE OR LEASE



±71,707 SF Manufacturing & Distribution Building
±4.12 Acres

GABE ORTEGA
480.561.0189
gortega@camcre.com

SHELBY TWOREK
602.491.1030
stworek@camcre.com

CHRIS GEROW
602.491.1041
cgerow@camcre.com

2701 E. CAMELBACK RD., #170, PHOENIX, AZ 85016 | 602.489.7990 | WWW.CAMCRE.COM



Capital Asset
Management



PROPERTY OVERVIEW

Purchase Price	\$13,930,000
-----------------------	---------------------

Lease Rate	Contact Agent
-------------------	---------------

Main Building	±61,011 SF
----------------------	------------

Building A	±1,155 SF
-------------------	-----------

Building B	±6,842 SF
-------------------	-----------

Building C	±2,699 SF
-------------------	-----------

Total Building Area	±71,707 SF
----------------------------	-------------------

Below Grade Storage	±30,800 SF (not included in the Total Building Area)
----------------------------	---------------------------------------------------------

Land Area	±4.12 AC
------------------	----------

Power	3,000A (277/480v)
--------------	-------------------

Loading	Dock platform, 5 positions 9 grade-level doors (Main Bldg) 14 grade-level doors (Bldgs A/B/C)
----------------	-----------------------------------------------------------------------------------------------------

Zoning	DB-2, City of Mesa
---------------	--------------------

Opportunity Zone	Yes
-------------------------	-----

SITE PLAN

The Site Plan as shown is Preliminary and Representative only, and may not represent the final layout, as it has not been approved by an architect or engineer

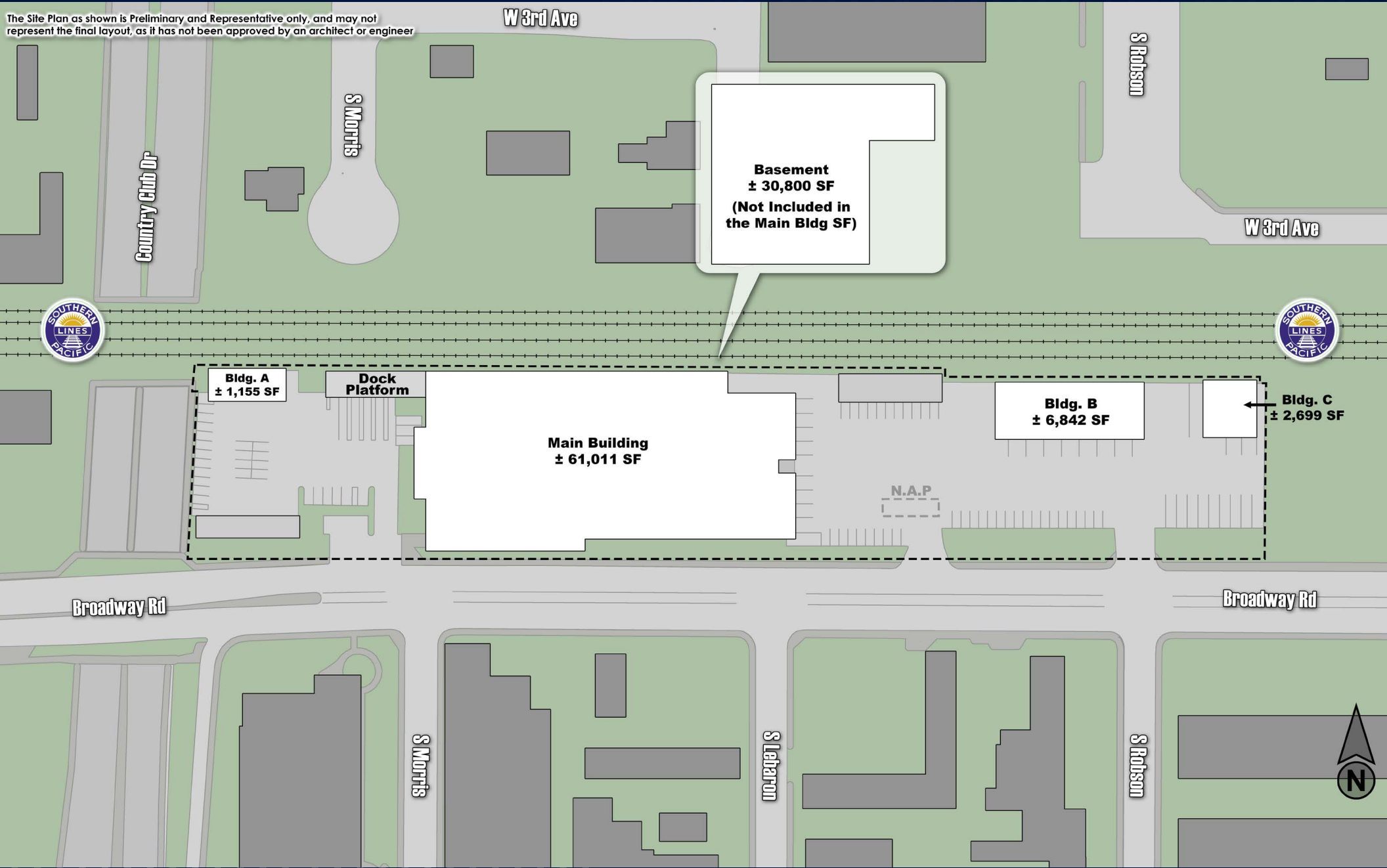

DETAILS

- $\pm 6,040$ SF of modern office space
- $\pm 54,860$ SF of production/warehouse area
- Total of $\pm 60,900$ SF, plus $\pm 30,800$ SF of storage space below the office & warehouse

Loading

Versatile layout with a dock platform on the west side of the building and 9 grade level doors on the east side of the building

Electrical

3,000A (277/480v)

Clear Height

12' on the western portion of the warehouse
20-26' on the eastern side of the warehouse

Cooling

HVAC for office, chiller system for warehouse



MAIN BUILDING



MAIN BUILDING



- Showroom
- 2 conference rooms
- Open/shared workspace
- 5 private offices

- 2 restrooms for office
- 2 restrooms in warehouse
- 1 private restroom
- Fire sprinkler system



MAIN BUILDING



Warehouse (Eastern side)

- 20-26' clear height (slab to beam)

Warehouse (Western side)

- 12' clear height (slab to truss)

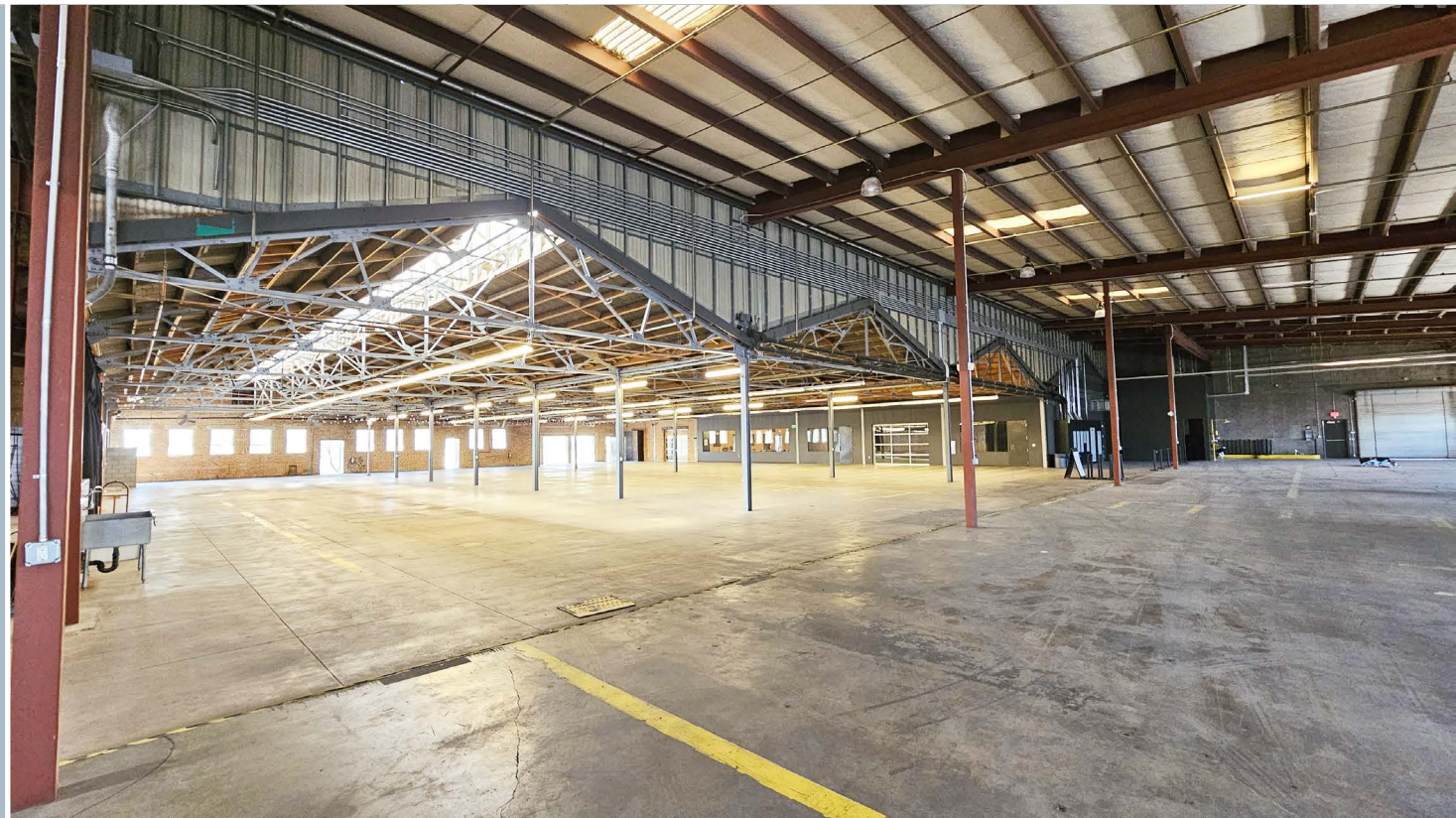

FLOOR PLAN

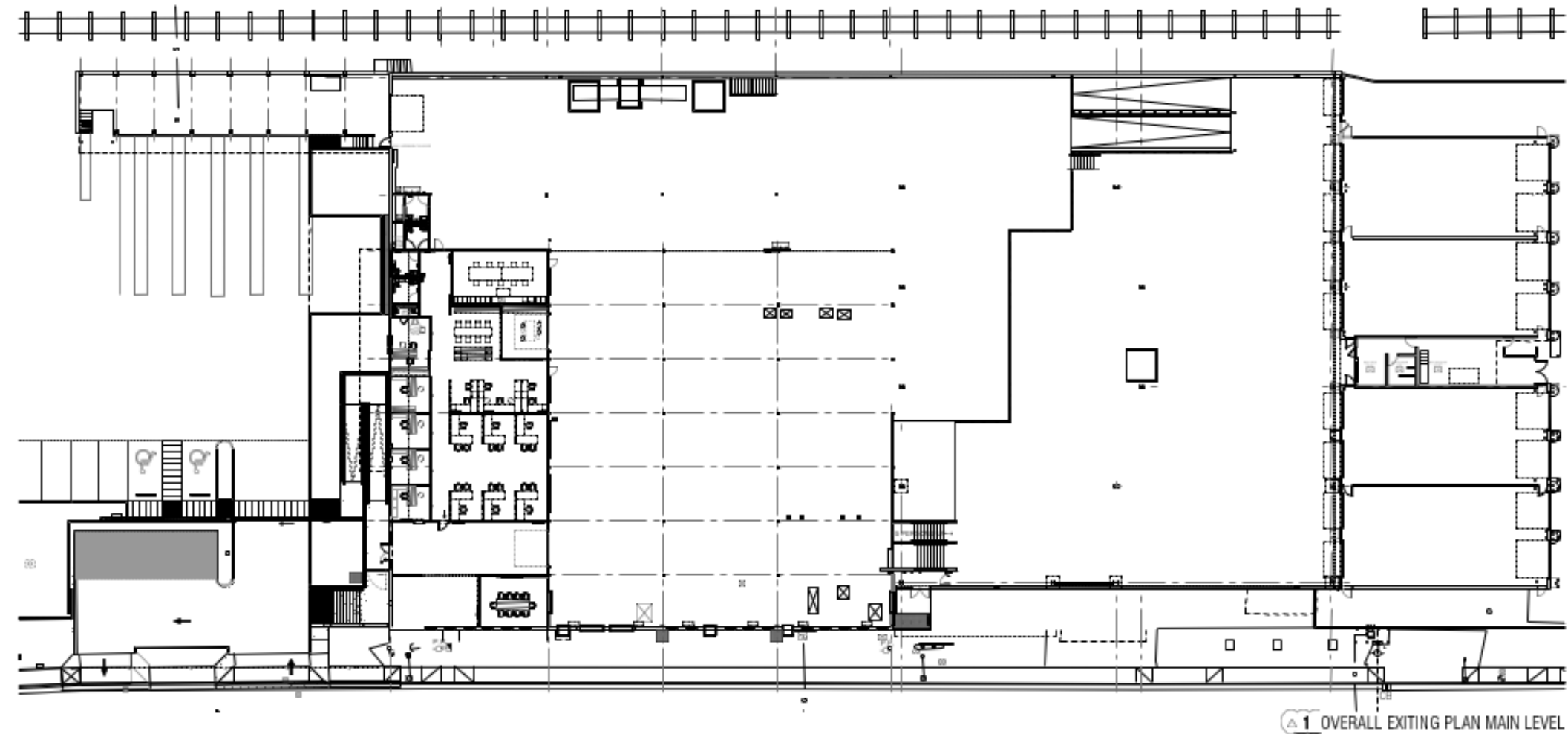

MAIN BUILDING

BUILDING A

DETAILS

- $\pm 1,155$ SF of warehouse space
- $+1,000$ SF canopy area

Parking

10 covered + 26 uncovered
Fenced with automatic gate

Loading

3 grade level doors

Electrical

No electrical service

Cooling

No cooling



Building B

- ±6,842 SF of warehouse space
- 9 grade level doors
- Fenced yard
- No electrical service, no cooling

Building C

- +2,699 SF of warehouse space
- 2 grade level doors
- Fenced yard
- No electrical service, no cooling

BUILDINGS B & C



254

West Broadway Road

Mesa, Arizona 85210

FOR SALE OR LEASING INFORMATION CONTACT

GABE ORTEGA

DIR: (480) 561-0189

gortega@camcre.com

CHRIS GEROW

DIR: (602) 491-1041

cgerow@camcre.com

SHELBY TWOREK

DIR: (602) 491-1030

stworek@camcre.com

CONFIDENTIALITY STATEMENT 2025 Capital Asset Management, LLC. All rights reserved. The information contained in this communication is strictly confidential. This information has been obtained from sources believed to be reliable but has not been verified. No warranty or representation, express or implied, is made as to the condition of the property (or properties) referenced herein or as to the accuracy or completeness of the information contained herein, and same is submitted subject to errors, omissions, change of price, rental or other conditions, withdrawal without notice, and to any special listing conditions imposed by the property owner(s). Any projections, opinions or estimates are subject to uncertainty and do not signify current or future property performance.

CAMCRE.