

FOR SALE

±27,801 SF ON ±4.64 ACRES

1260 S. DUPONT AVENUE

ONTARIO, CA 91761



RYAN EARNHART

rearnhart@lee-assoc.com
D 909.373.2724
DRE #01426559

BRIAN PHARRIS

bpharris@lee-assoc.com
D 909.373.2927
DRE #01329363

JEFF RUSCIGNO

jruscigno@lee-associates.com
D 951.276.3630
DRE #01030286

NICK ZOLFERINO

nzolferino@lee-assoc.com
D 909.373.2703
DRE #02207120

LEE & ASSOCIATES - ONTARIO

3535 Inland Empire Boulevard
Ontario, CA 91764
(909) 989-7771 | lee-associates.com



CORPORATE ID #00976995

All information furnished regarding property for sale, rental or financing is from sources deemed reliable, but no warranty or representation is made to the accuracy thereof and same is submitted to errors, omissions, change of price, rental or other conditions prior to sale, lease or financing or withdrawal without notice. No liability of any kind is to be imposed on the broker herein.

FOR SALE
±27,801 SF ON ±4.64 ACRES

1260 S. DUPONT AVENUE
ONTARIO, CA 91761

PROPERTY HIGHLIGHTS

- ±27,801 SF Available on ±4.64 Acre Lot
- ±3,596 SF of Two-Story Office Space
- Large ±2.02 Acre Yard
- Gated & Secured Lot - 3 Ingress/Egress Points
- (1) Ground Level Door
- 24' Clear Height
- 1,200 Amp/Panel (Verify)
- ±130 Auto Stalls (More Possible in Yard)
- 100% HVAC Warehouse
- Above Standard IT Room
- Close Proximity CA-60, I-15, & I-10 Freeways



RYAN EARNHART
rearnhart@lee-assoc.com
D 909.373.2724
DRE #01426559

BRIAN PHARRIS
bpharris@lee-assoc.com
D 909.373.2927
DRE #01329363

JEFF RUSCIGNO
jruscigno@lee-associates.com
D 951.276.3630
DRE #01030286

NICK ZOLFERINO
nzolferino@lee-assoc.com
D 909.373.2703
DRE #02207120

LEE & ASSOCIATES - ONTARIO
3535 Inland Empire Boulevard
Ontario, CA 91764
(909) 989-7771 | lee-associates.com

LEE & ASSOCIATES
COMMERCIAL REAL ESTATE SERVICES
ONTARIO
CORPORATE ID #00976995

FOR SALE
±27,801 SF ON ±4.64 ACRES

1260 S. DUPONT AVENUE
ONTARIO, CA 91761

SITE PLAN

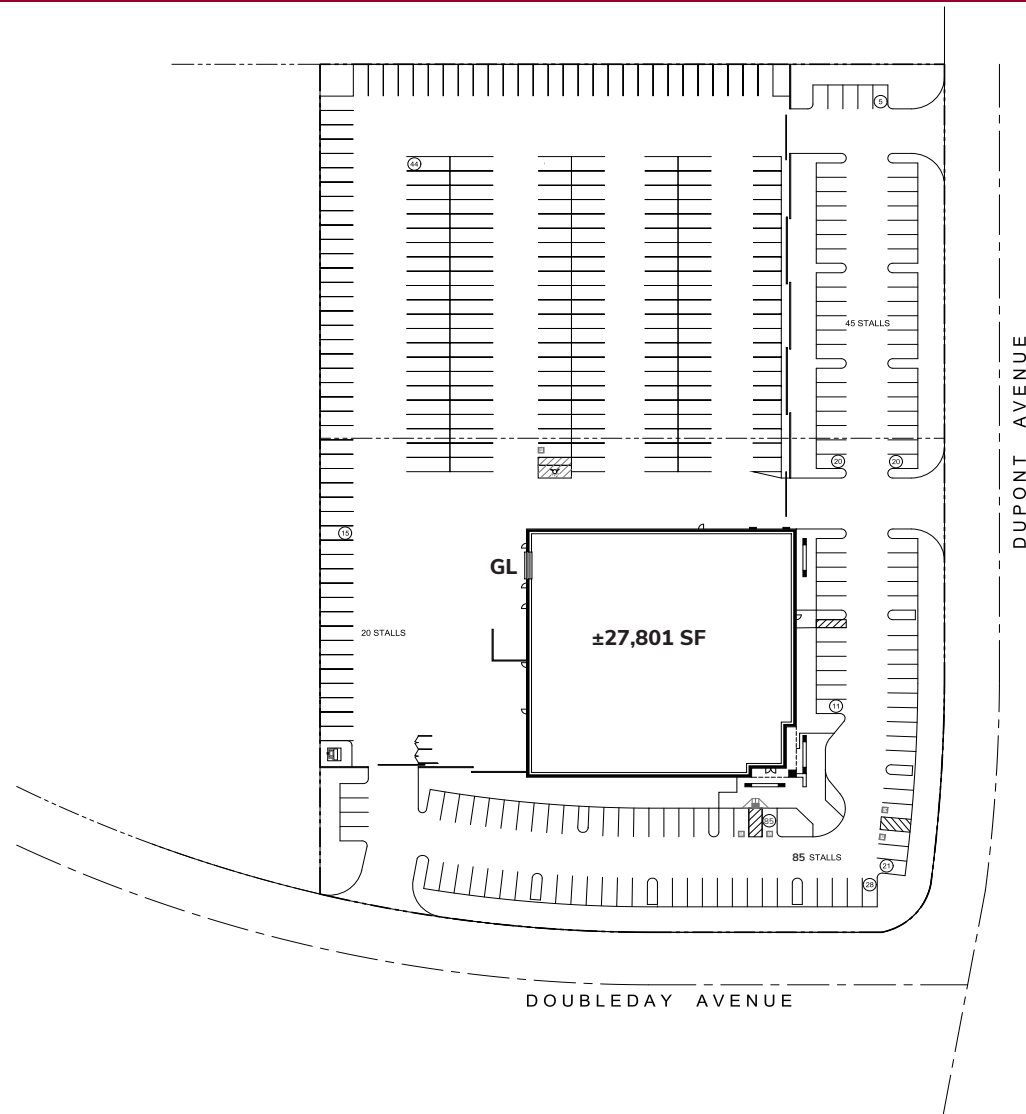

RYAN EARNHART
rearnhart@lee-assoc.com
D 909.373.2724
DRE #01426559

BRIAN PHARRIS
bpharris@lee-assoc.com
D 909.373.2927
DRE #01329363

JEFF RUSCIGNO
jruscigno@lee-associates.com
D 951.276.3630
DRE #01030286

NICK ZOLFERINO
nzolferino@lee-assoc.com
D 909.373.2703
DRE #02207120

LEE & ASSOCIATES - ONTARIO
3535 Inland Empire Boulevard
Ontario, CA 91764
(909) 989-7771 | lee-associates.com

LEE & ASSOCIATES
COMMERCIAL REAL ESTATE SERVICES
ONTARIO

CORPORATE ID #00976995

All information furnished regarding property for sale, rental or financing is from sources deemed reliable, but no warranty or representation is made to the accuracy thereof and same is submitted to errors, omissions, change of price, rental or other conditions prior to sale, lease or financing or withdrawal without notice. No liability of any kind is to be imposed on the broker herein.

FOR SALE
±27,801 SF ON ±4.64 ACRES

1260 S. DUPONT AVENUE
ONTARIO, CA 91761

MEZZANINE

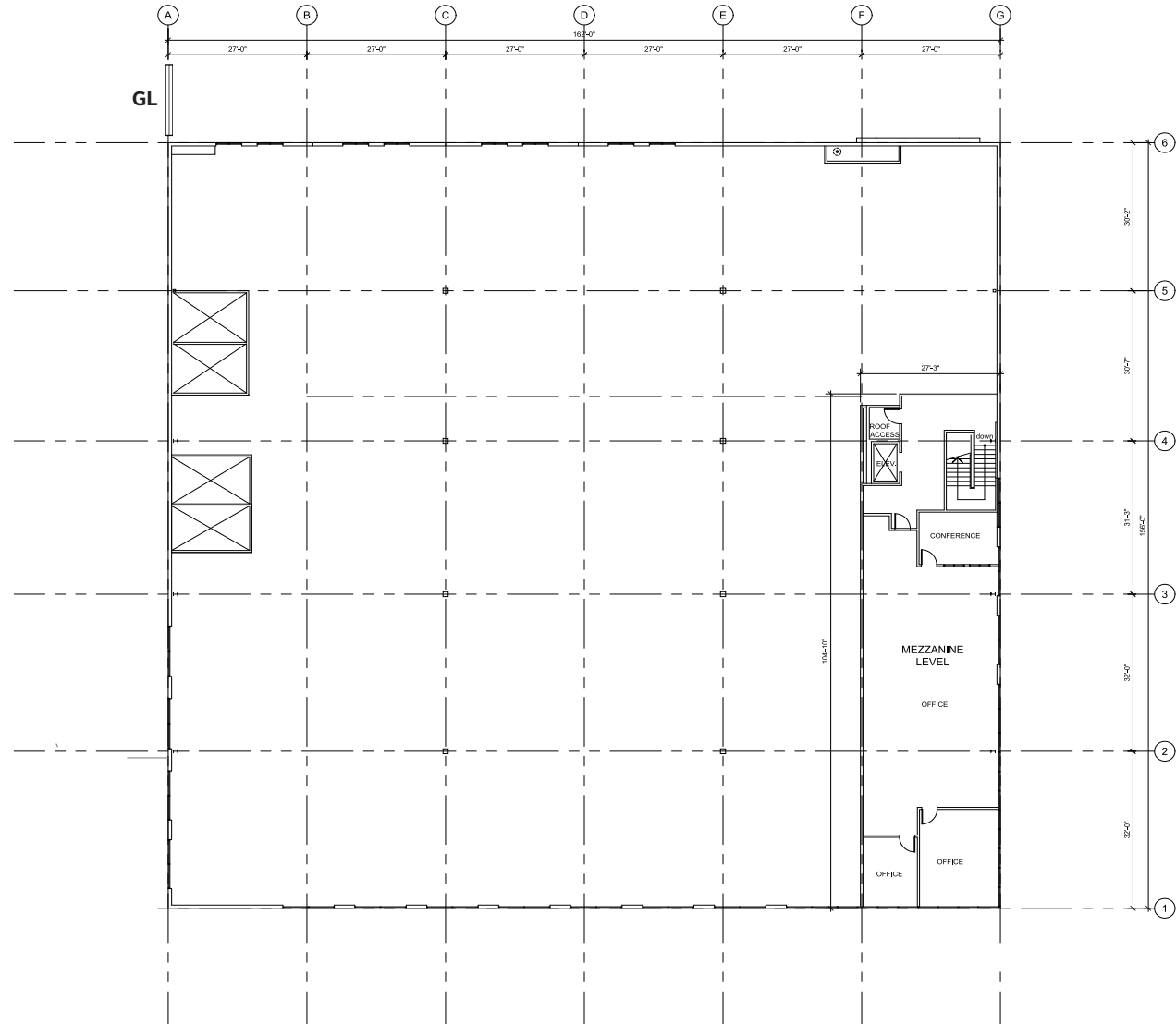

RYAN EARNHART
rearnhart@lee-assoc.com
D 909.373.2724
DRE #01426559

BRIAN PHARRIS
bpharris@lee-assoc.com
D 909.373.2927
DRE #01329363

JEFF RUSCIGNO
jruscigno@lee-associates.com
D 951.276.3630
DRE #01030286

NICK ZOLFERINO
nzolferino@lee-assoc.com
D 909.373.2703
DRE #02207120

LEE & ASSOCIATES - ONTARIO
3535 Inland Empire Boulevard
Ontario, CA 91764
(909) 989-7771 | lee-associates.com

LEE & ASSOCIATES
COMMERCIAL REAL ESTATE SERVICES
ONTARIO

CORPORATE ID #00976995

All information furnished regarding property for sale, rental or financing is from sources deemed reliable, but no warranty or representation is made to the accuracy thereof and same is submitted to errors, omissions, change of price, rental or other conditions prior to sale, lease or financing or withdrawal without notice. No liability of any kind is to be imposed on the broker herein.

FOR SALE
±27,801 SF ON ±4.64 ACRES

1260 S. DUPONT AVENUE
ONTARIO, CA 91761

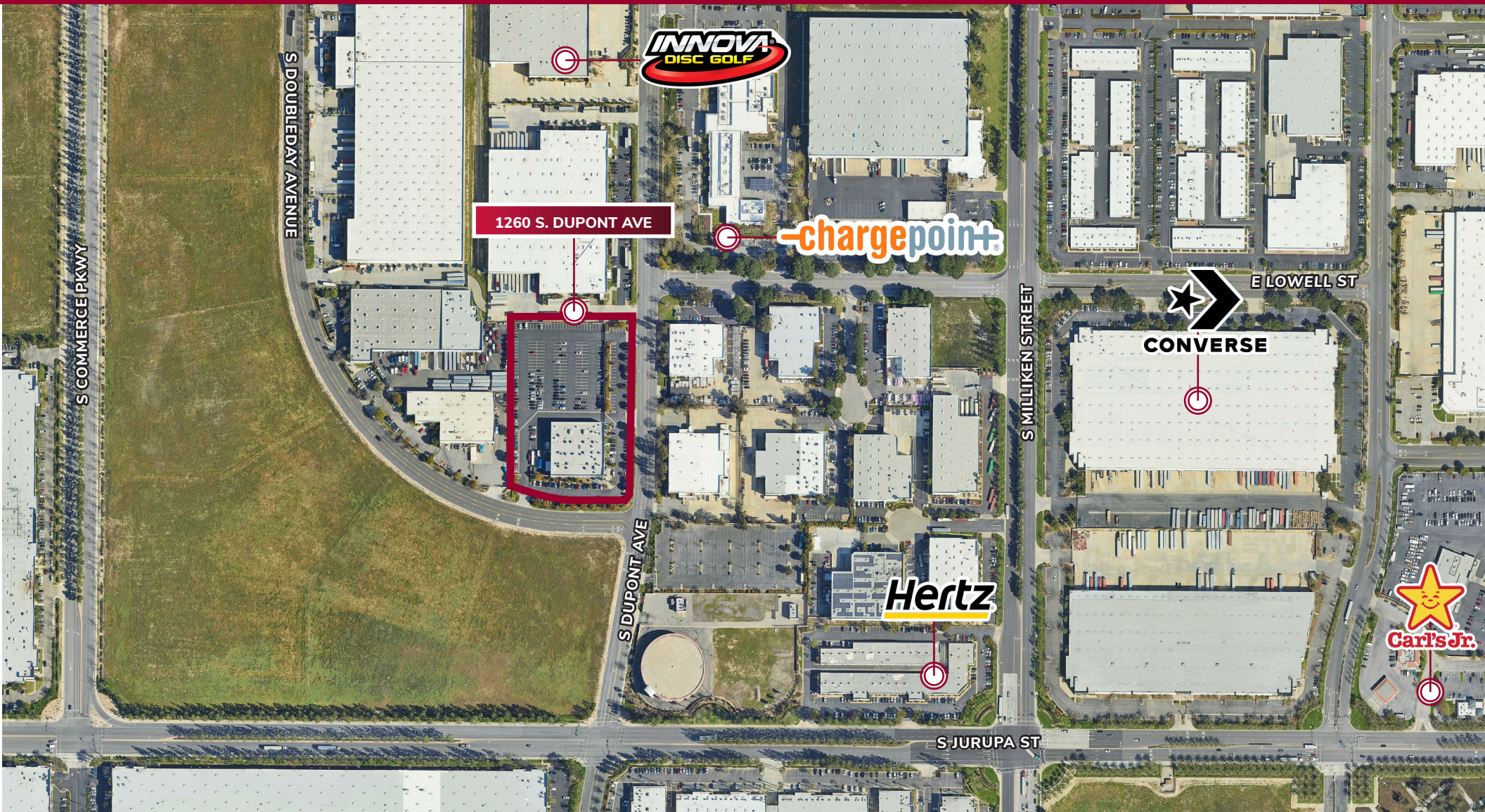

RYAN EARNHART
rearnhart@lee-assoc.com
D 909.373.2724
DRE #01426559

BRIAN PHARRIS
bpharris@lee-assoc.com
D 909.373.2927
DRE #01329363

JEFF RUSCIGNO
jruscigno@lee-associates.com
D 951.276.3630
DRE #01030286

NICK ZOLFERINO
nzolferino@lee-assoc.com
D 909.373.2703
DRE #02207120

LEE & ASSOCIATES - ONTARIO
3535 Inland Empire Boulevard
Ontario, CA 91764
(909) 989-7771 | lee-associates.com

LEE & ASSOCIATES
COMMERCIAL REAL ESTATE SERVICES
ONTARIO
CORPORATE ID #00976995

All information furnished regarding property for sale, rental or financing is from sources deemed reliable, but no warranty or representation is made to the accuracy thereof and same is submitted to errors, omissions, change of price, rental or other conditions prior to sale, lease or financing or withdrawal without notice. No liability of any kind is to be imposed on the broker herein.

FOR SALE
±27,801 SF ON ±4.64 ACRES

1260 S. DUPONT AVENUE
ONTARIO, CA 91761



RYAN EARNHART
rearnhart@lee-assoc.com
D 909.373.2724
DRE #01426559

BRIAN PHARRIS
bpharris@lee-assoc.com
D 909.373.2927
DRE #01329363

JEFF RUSCIGNO
jruscigno@lee-associates.com
D 951.276.3630
DRE #01030286

NICK ZOLFERINO
nzolferino@lee-assoc.com
D 909.373.2703
DRE #02207120

LEE & ASSOCIATES - ONTARIO
3535 Inland Empire Boulevard
Ontario, CA 91764
(909) 989-7771 | lee-associates.com

LEE & ASSOCIATES
COMMERCIAL REAL ESTATE SERVICES
ONTARIO

CORPORATE ID #00976995

All information furnished regarding property for sale, rental or financing is from sources deemed reliable, but no warranty or representation is made to the accuracy thereof and same is submitted to errors, omissions, change of price, rental or other conditions prior to sale, lease or financing or withdrawal without notice. No liability of any kind is to be imposed on the broker herein.

FOR SALE
±27,801 SF ON ±4.64 ACRES

1260 S. DUPONT AVENUE
ONTARIO, CA 91761



RYAN EARNHART
rearnhart@lee-assoc.com
D 909.373.2724
DRE #01426559

BRIAN PHARRIS
bpharris@lee-assoc.com
D 909.373.2927
DRE #01329363

JEFF RUSCIGNO
jruscigno@lee-associates.com
D 951.276.3630
DRE #01030286

NICK ZOLFERINO
nzolferino@lee-assoc.com
D 909.373.2703
DRE #02207120

LEE & ASSOCIATES - ONTARIO
3535 Inland Empire Boulevard
Ontario, CA 91764
(909) 989-7771 | lee-associates.com

LEE & ASSOCIATES
COMMERCIAL REAL ESTATE SERVICES
ONTARIO

CORPORATE ID #00976995

All information furnished regarding property for sale, rental or financing is from sources deemed reliable, but no warranty or representation is made to the accuracy thereof and same is submitted to errors, omissions, change of price, rental or other conditions prior to sale, lease or financing or withdrawal without notice. No liability of any kind is to be imposed on the broker herein.

1260 S. DUPONT AVENUE

ONTARIO, CA 91761

FOR MORE INFORMATION

RYAN EARNHART

rearnhart@lee-assoc.com
D 909.373.2724
DRE #01426559

BRIAN PHARRIS

bpharris@lee-assoc.com
D 909.373.2927
DRE #01329363

JEFF RUSCIGNO

jruscigno@lee-associates.com
D 951.276.3630
DRE #01030286

NICK ZOLFERINO

nzolferino@lee-assoc.com
D 909.373.2703
DRE #02207120

RYAN EARNHART

rearnhart@lee-assoc.com
D 909.373.2724
DRE #01426559

BRIAN PHARRIS

bpharris@lee-assoc.com
D 909.373.2927
DRE #01329363

JEFF RUSCIGNO

jruscigno@lee-associates.com
D 951.276.3630
DRE #01030286

NICK ZOLFERINO

nzolferino@lee-assoc.com
D 909.373.2703
DRE #02207120

LEE & ASSOCIATES - ONTARIO

3535 Inland Empire Boulevard
Ontario, CA 91764



CORPORATE ID #00976995

All information furnished regarding property for sale, rental or financing is from sources deemed reliable, but no warranty or representation is made to the accuracy thereof and same is submitted to errors, omissions, change of price, rental or other conditions prior to sale, lease or financing or withdrawal without notice. No liability of any kind is to be imposed on the broker herein.