



DEVELOPMENT HIGHLIGHTS

- New 124-acre Mixed-Use Development
- Excellent access and visibility at Rt 288 and Iron Bridge Road
- Prime location at Chesterfield County Courthouse
- 2 Signalized access points
- 5 Acre Medical Office Park
- Delivery 2026
- Road Widening for Courthouse Road & Iron Bridge Road Complete

PROJECT

MEDICAL OFFICE	COURTHOUSE LANDING VA
OUTPARCELS & RETAIL (5 Acres)	COURTHOUSE LANDING VA
116 ROOMS	TOWNEPLACE SUITES
300 MF UNITS	EDWARD ROSE & SONS
184 TH/CONDO UNITS	STANLEY MARTIN

2025 DEMOGRAPHIC RADIUS

Total Population		
3 miles:	34,031	
5 miles:	105,876	
Median Household Income		
3 miles:	\$75,951	
5 miles:	\$71,156	
Average Household Income		
3 miles:	\$93,296	
5 miles:	\$89,024	
Traffic Counts		
RT 288:	58,000 AADT / 52,000 VPD	
RT 10:	57,000 AADT / 53,000 VPD	
Daytime Population:	25,000 people	

For more information regarding this property:

JEFF DOXEY, CCIM

804 363 0332

jeffdoxey@naidominion.com

PARCELS FOR SALE

GROUND LEASE

BUILD-TO-SUIT

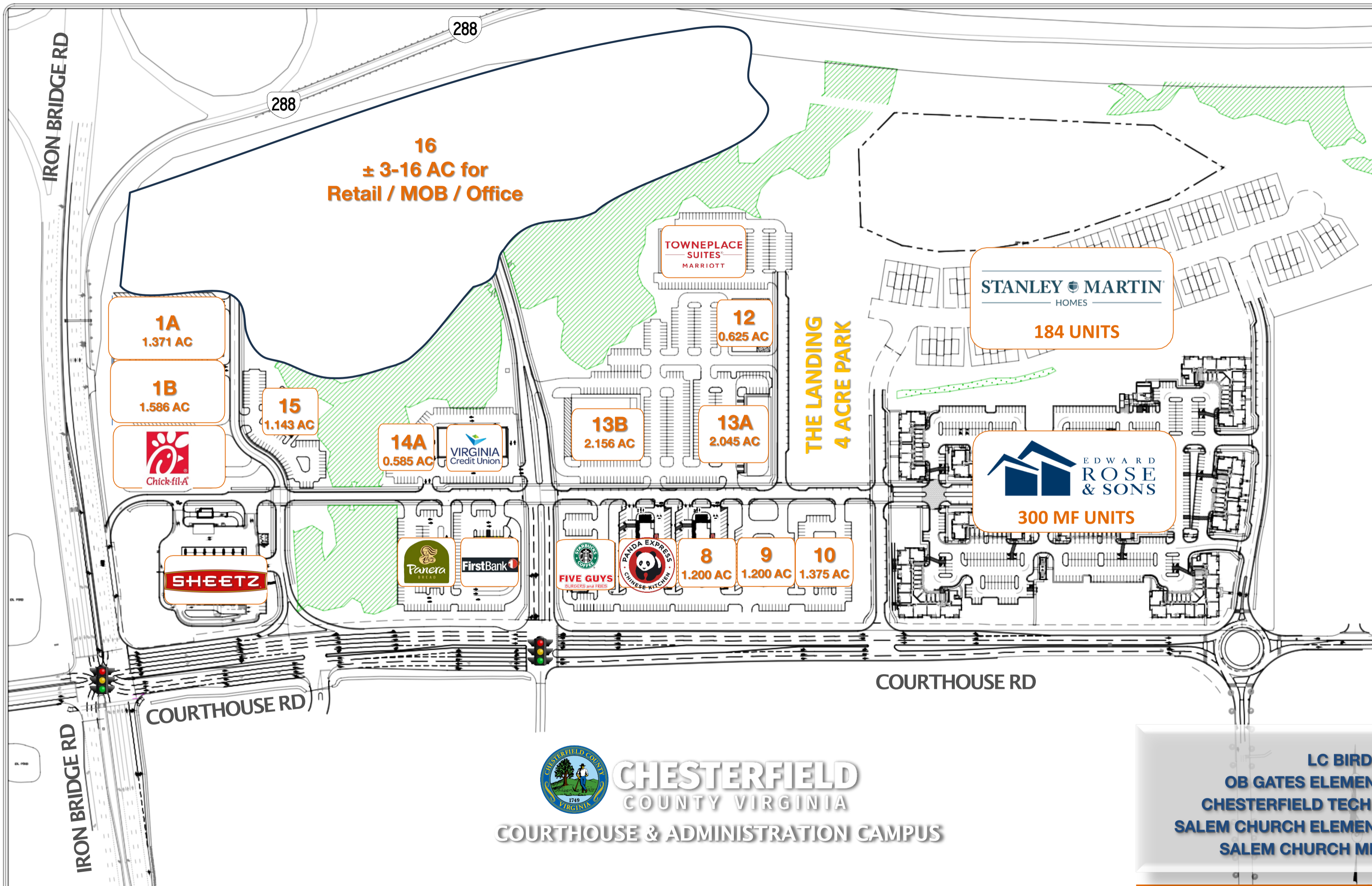

Courthouse Landing



CHESTERFIELD COUNTY VIRGINIA

COURTHOUSE & ADMINISTRATION CAMPUS

LC BIRD HIGH SCHOOL
 OB GATES ELEMENTARY SCHOOL
 CHESTERFIELD TECHNICAL CENTER
 SALEM CHURCH ELEMENTARY SCHOOL
 SALEM CHURCH MIDDLE SCHOOL

For more information regarding this property:

JEFF DOXEY, CCIM
 804 363 0332
jeffdoxey@naidominion.com

CHRIS RICE
 804 513 6162
chrisrice@naidominion.com

COURTHOUSE RD
 WILL EXTEND THROUGH TO
 SALEM CHURCH RD



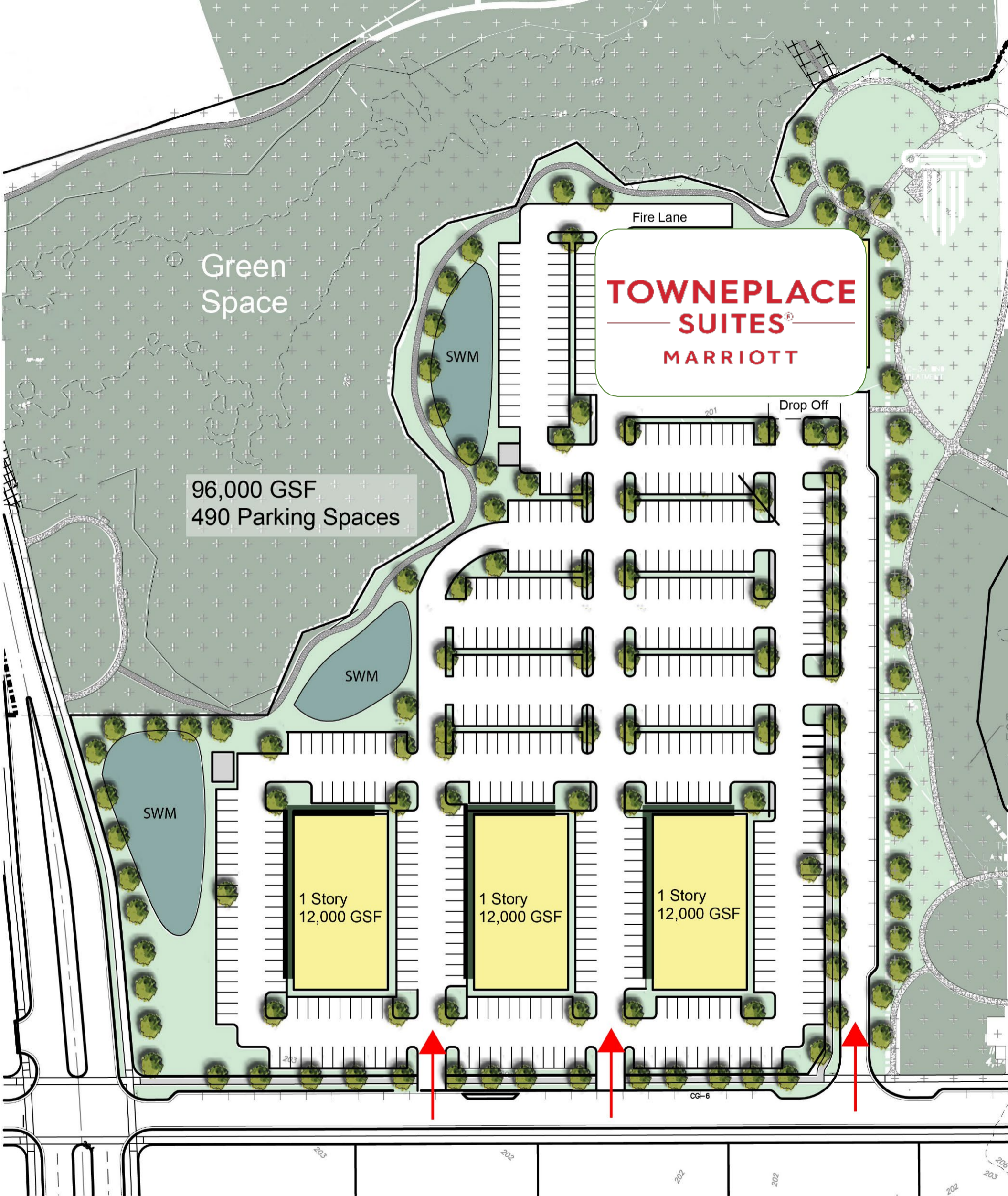

Medical Office Building Site Features

- Up to 5.5 acres or 40,000 RSF
- Build to suit and or lease opportunities from 2,500 - 40,000 RSF
- Building ownership from 6,000 - 40,000 RSF
- Ample Parking

No warranty or representation, express or implied, is made as to the accuracy of the information contained herein, and the same is submitted subject to errors, omissions, change of price, rental or other conditions, prior sale, lease or financing, or withdrawal without notice, and of any special listing conditions imposed by our principals. No warranties or representations are made as to the condition of the property or any hazards contained therein are any to be implied.

For more information regarding this property: