



1001 Hingham Street

managed & leased by

RADER PROPERTIES, INC



A prestigious building address located on 228 at exit 14 off Route 3. This first-class office building offers a convenient location with easy access provided by a traffic signal at the driveway entrance. 1001 is within walking distance to three national hotels, a conference center, restaurants and many other amenities.

An inviting three-story, all glass atrium lobby greets both tenant and visitors. Full-height, solid glass entry doors and high end interior finishes provide a quality office environment.



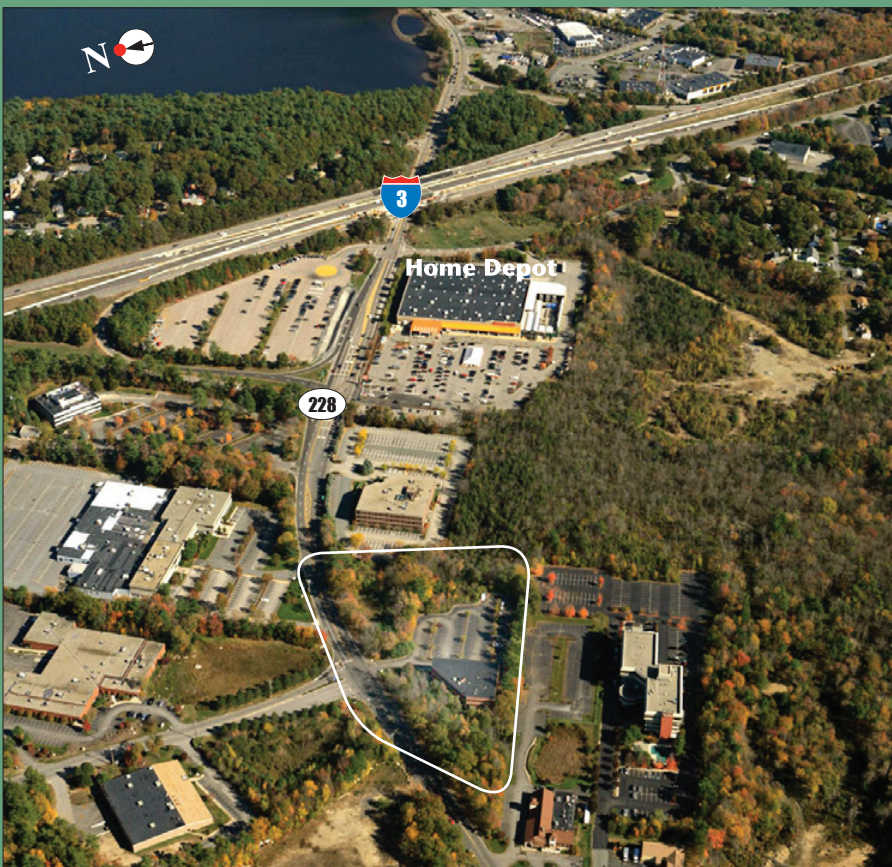

Building Size

- 32,000 SF

Stories

- Three Stories

Construction

- Steel frame structure with brick red facade and horizontal windows

Sewer

- Town sewer

Fire Protection

- Fully sprinklered with monitored fire alarm

Major Tenants

- J.P. Morgan, Needel, Welch & Stone

Comments

- Common areas renovated 2005
- 1001 Hingham Street is first-class office building prominently located on Route 228, just off Exit 14 on Route 3
- 2,500 - 12,000 SF Office available
- Excellent highway access
- Two story atrium lobby
- Ample parking
- Professionally managed
- Walking distance to three major hotels, a conference center, restaurants, and other amenities.



1001 Hingham Street

managed & leased by

RADER PROPERTIES, INC

For more information or to schedule a building tour contact:

David Mitchell, or Jim Rader 781-681-9000

dmitchell@raderproperties.net

jrader@raderproperties.net



All information is from sources deemed reliable, however, Rader Properties, Inc. makes no representation as to its accuracy and is subject to change or withdrawal without notice.