

## 23.58 ACRES AVAILABLE FOR SALE

### PROPERTY HIGHLIGHTS

- Mixed-use commercial and multifamily land available in Larimer County
- Immediate regional access from the interchange of I-25 and Highway 392
- Tremendous visibility from I-25
- Centrally located along the north front range adjacent to Fort Collins, Loveland, and Windsor
- Extension of water and sewer service needed from the south
- Left turn lane may be required from the frontage road depending on traffic study
- Part of mixed-use plan to include office, industrial, commercial, and multifamily uses across the full 23 acre site

### PRICING

±12.12 Acres Industrial: \$3,170,000 (\$6.00/SF)

±11.46 Acres Multifamily: \$1,500,000 (\$3.00/SF)

### PROPERTY FEATURES

**Site Size** 23.58 Acres

**Zoning** CC - Commercial Corridor, Larimer County  
MF - Multifamily, Larimer County

**Frontage** ±1,175' on I-25



## CONCEPTUAL PLAN

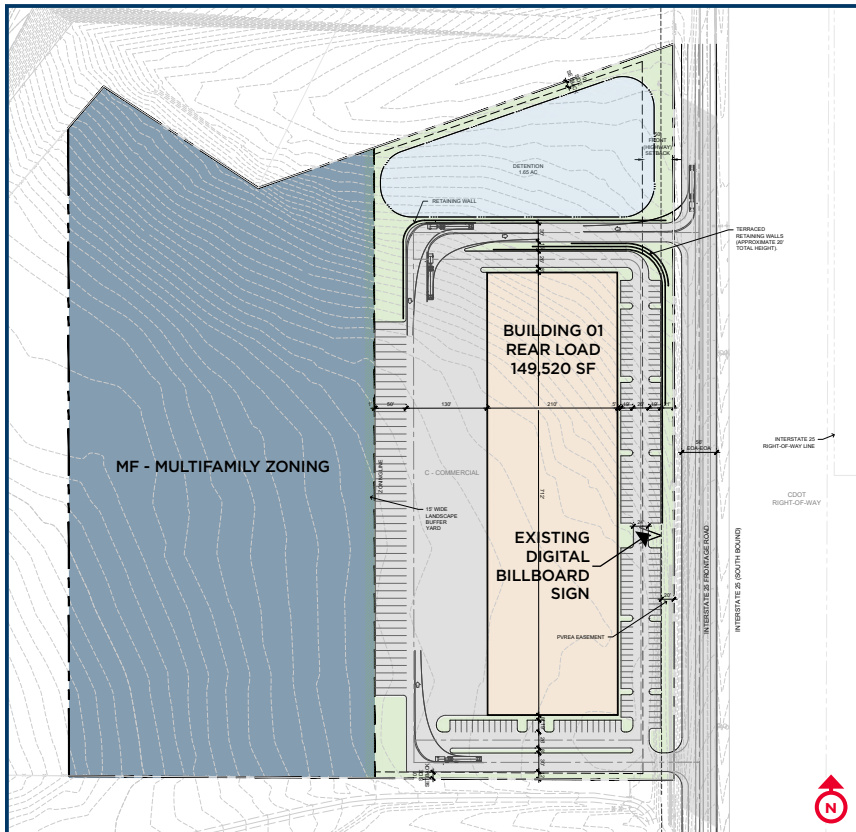

## PROPERTY INFORMATION SUMMARY

<b>Jurisdiction</b>	Larimer County
<b>Zoning</b>	CC Commercial   MF Multifamily
<b>Electric</b>	Poudre Valley REA
<b>Gas</b>	Xcel Energy
<b>Water</b>	South Fort Collins-Loveland Water District
<b>Sewer</b>	South Fort Collins Sanitation



## TARGETED USES



Retail



Warehouse/  
Distribution



Multifamily



Assisted  
Living



Recreational



MOB/  
Healthcare



Building  
Supplies



Self Storage,  
Boat, RV

**LARIMER COUNTY LAND USE**

## NORTHERN COLORADO INDUSTRIAL MARKET OVERVIEW



For more information,  
please contact:

**JASON ELLS, CCIM**  
**Senior Director**  
+1 970 231 7513  
jason.ells@cushwake.com

772 Whalers Way, Suite 200  
Fort Collins, Colorado 80525

T +1 970 776 3900  
F +1 970 267 7419

[cushmanwakefield.com](http://cushmanwakefield.com)

©2024 Cushman & Wakefield. All rights reserved. The information contained in this communication is strictly confidential. This information has been obtained from sources believed to be reliable but has not been verified. NO WARRANTY OR REPRESENTATION, EXPRESS OR IMPLIED, IS MADE AS TO THE CONDITION OF THE PROPERTY (OR PROPERTIES) REFERENCED HEREIN OR AS TO THE ACCURACY OR COMPLETENESS OF THE INFORMATION CONTAINED HEREIN, AND SAME IS SUBMITTED SUBJECT TO ERRORS, OMISSIONS, CHANGE OF PRICE, RENTAL OR OTHER CONDITIONS, WITHDRAWAL WITHOUT NOTICE, AND TO ANY SPECIAL LISTING CONDITIONS IMPOSED BY THE PROPERTY OWNER(S). ANY PROJECTIONS, OPINIONS OR ESTIMATES ARE SUBJECT TO UNCERTAINTY AND DO NOT SIGNIFY CURRENT OR FUTURE PROPERTY PERFORMANCE.

