

Office/Flex ★ LEASE

LanCarte.com

3501 NW LOOP 820 FORT WORTH, TX 76106



Riley Dow
817-681-2022
rdow@lancarte.com

Daniel Shelley
512-461-5363
dshelley@lancarte.com

Office/Flex ★ LEASE

3501 NW LOOP 820

LanCarte.com

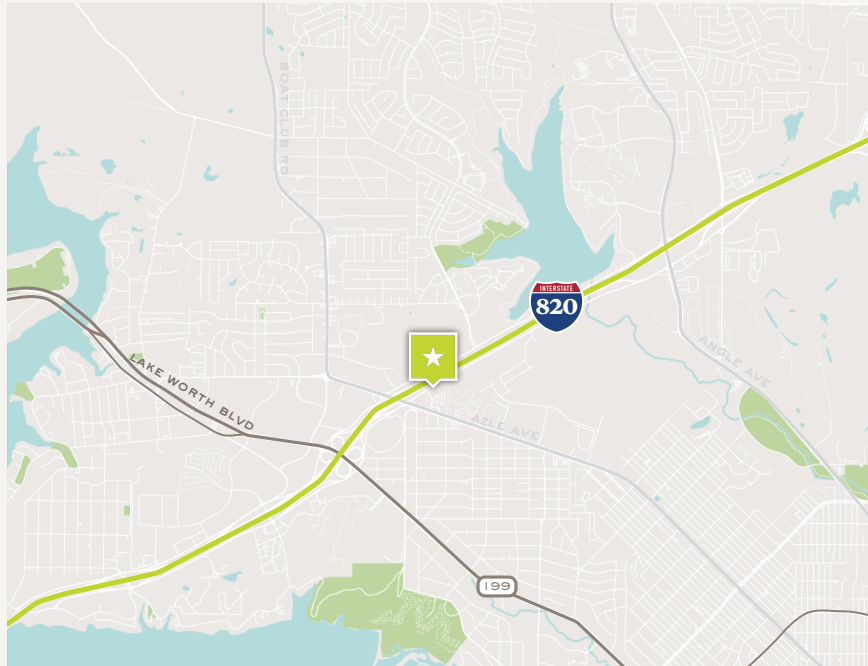

PROPERTY FEATURES

- 2,500 - 5,000 SF Available
- 10 x 12 Grade Level Door
- Hwy 820 Frontage
- Ample Parking 4/1,000 SF
- Professional/Office Park
- Monument Signage Available
- Flex Warehouse/Office

LOCATION OVERVIEW

Located directly off Loop 820 in Fort Worth, this industrial business park offers outstanding visibility and immediate highway access. Just east of I-35W, the site provides seamless connections to critical north Fort Worth and regional distribution networks. With signage opportunities above each suite's entry and ample parking, the property is engineered for both ease of use and strong brand presence.

AVAILABLE SPACES

SUITE 3519	2,500	SF	FLEX
------------	-------	----	------

SUITE 3527	2,500	SF	FLEX
------------	-------	----	------

LEASING STRUCTURE

CONTACT BROKER

Office/Flex ★ LEASE
3501 NW LOOP 820

LanCarte.com

DRONE PHOTOS



Office/Flex ★ LEASE

3501 NW LOOP 820

LanCarte.com

FLOOR PLANS

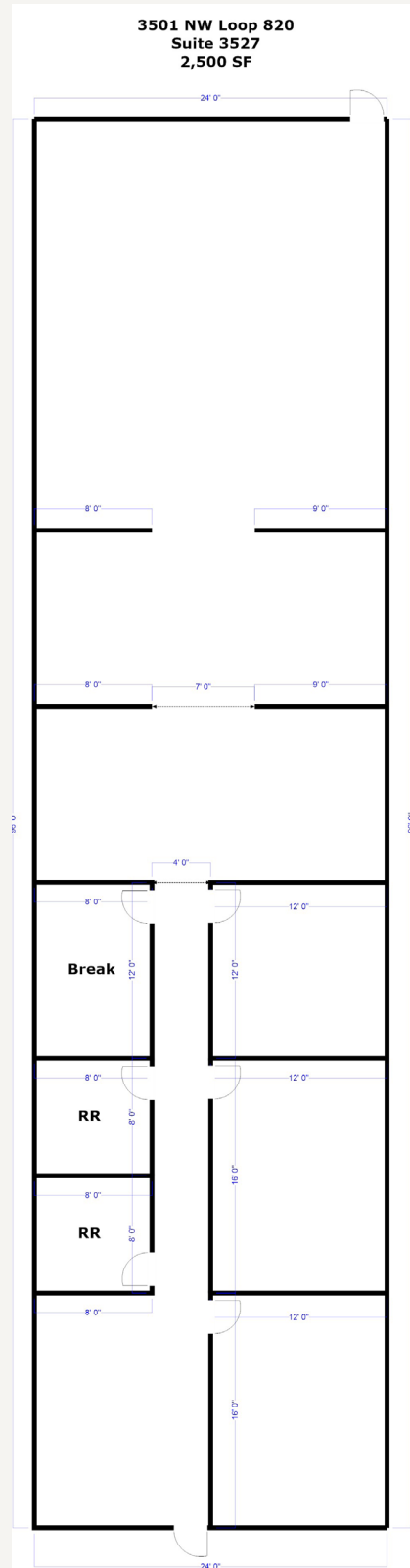
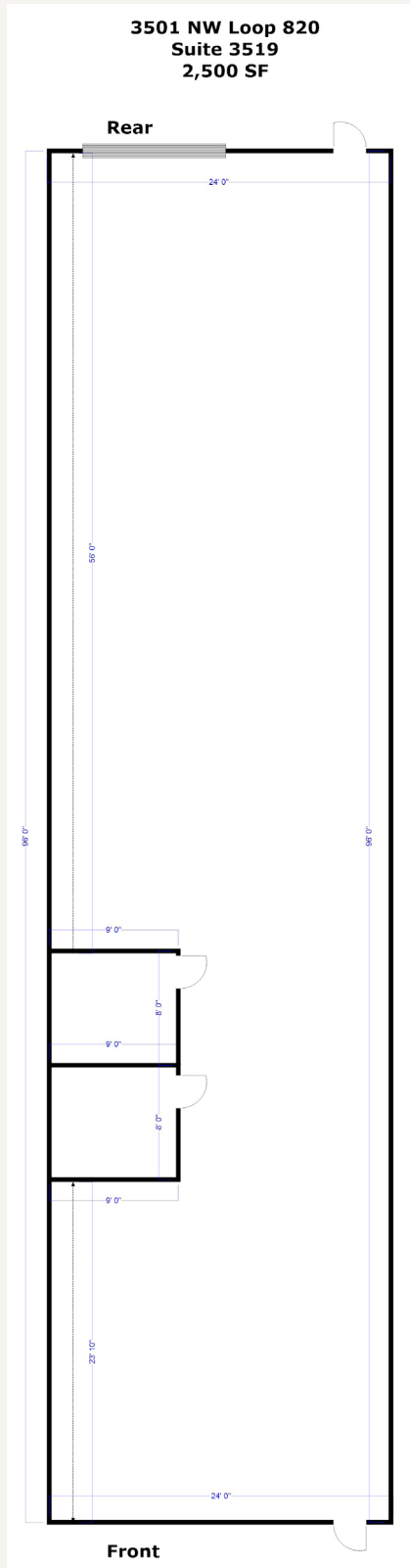

Office/Flex ★ LEASE
3501 NW LOOP 820

LanCarte.com

SUITE 3519





LANCARTE

COMMERCIAL

Relentlessly Pursuing What Matters

Riley Dow

817-681-2022 | rdow@lancarte.com

Daniel Shelley

512-461-5363 | dshelley@lancarte.com

The information provided herein was obtained from sources believed to be reliable. However, LanCarte Commercial makes no guaranties, warranties or representations as to the completeness or accuracy thereof. The presentation of this property is submitted subject to errors, omissions, change of price or conditions, prior to sale or lease, or withdrawal without notice. Copyright 2025 LanCarte Commercial Real Estate, LLC.