

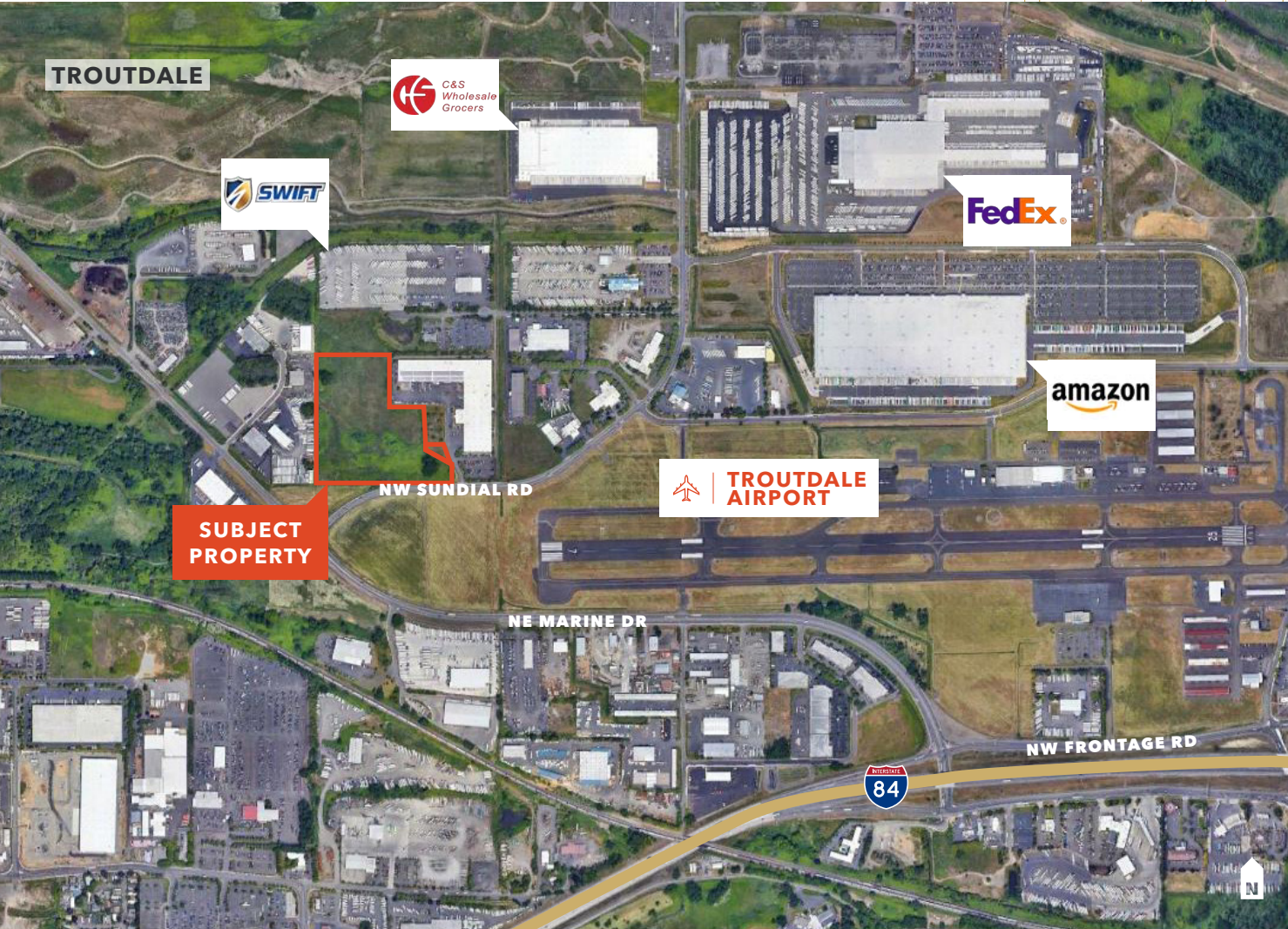

# 15.0 Acres of Industrial Land

1459 NW SUNDIAL RD, TROUTDALE, OR 97060

# FOR SALE

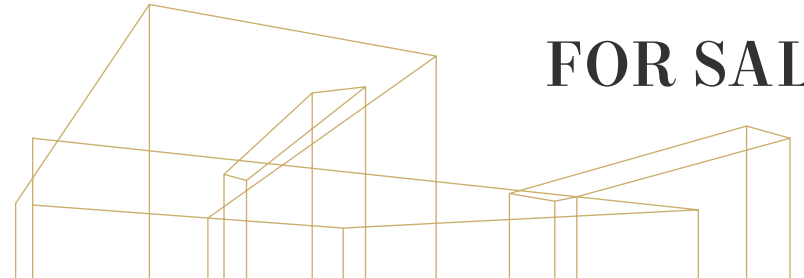

## Property Overview

For Sale	15.0 acres (653,400 SF)
Address	1459 NW Sundial Rd Troutdale, OR 97060
Legal	#R713193IN3E22D 00103
Utilities	All to site (Sundial Rd)
Zoning	General Industrial, City of Troutdale
Topography	Generally flat
Sale Price	Contact Broker

### Kidder Mathews

**SEAN MCNAMARA**  
503.721.2738  
sean.mcnamara@kidder.com

**TOM TALBOT, SIOR**  
503.221.2270  
tom.talbot@kidder.com

This information supplied herein is from sources we deem reliable. It is provided without any representation, warranty, or guarantee, expressed or implied as to its accuracy. Prospective Buyer or Tenant should conduct an independent investigation and verification of all matters deemed to be material, including, but not limited to, statements of income and expenses. Consult your attorney, accountant, or other professional advisor.



# 15.0 Acres of Industrial Land

1459 NW SUNDIAL RD, TROUTDALE, OR 97060

# FOR SALE



## Kidder Mathews

**SEAN MCNAMARA**  
 503.721.2738  
[sean.mcnamara@kidder.com](mailto:sean.mcnamara@kidder.com)

**TOM TALBOT, SIOR**  
 503.221.2270  
[tom.talbot@kidder.com](mailto:tom.talbot@kidder.com)

This information supplied herein is from sources we deem reliable. It is provided without any representation, warranty, or guarantee, expressed or implied as to its accuracy. Prospective Buyer or Tenant should conduct an independent investigation and verification of all matters deemed to be material, including, but not limited to, statements of income and expenses. Consult your attorney, accountant, or other professional advisor.