

# 12.75 AC Container Yard For Lease

3851 Brandon Road, Joliet, IL 60436



 **CenterPoint**  
INTERMODAL CENTER  
[centerpoint-intermodal.com](http://centerpoint-intermodal.com)

**CONTAINER / TRAILER  
PARKING AVAILABLE**  
*STACKING PERMITTED\**

*\*IMPROVEMENTS REQUIRED*

## Property Highlights



**12.75 AC**

Available



**360 Stalls**

Available

- + **Site:** Paved, Lit, and Fenced
- + **Parking Area:** 8" Thick RCC
- + **Lease Rate:** Subject to Offer



## Campus Advantages at CenterPoint Intermodal Center

- + North America's Largest Inland Port with the lowest drayage charges in the entire region
- + Public bus service with access to deep and skilled labor
- + Retail amenities; truck center with scale
- + Low Will County real estate taxes
- + Full interchanges at I-55 and Arsenal Road, I-80 and I-55, I-80 and Houbolt, & I-80 and Route 53
- + Pre-designated Foreign Trade Zone & Enterprise Zone
- + ±40 miles to Chicago
- + Direct access to the Union Pacific Joliet Intermodal Terminal (JIT) and BNSF Logistics Park Chicago (LPC)
- + Heavyweight capacity roads
- + On-site overflow container storage 24/7
- + FTZ savings
- + No trailer parking ratio restrictions
- + Flexible zoning for manufacturing, distribution or container operations

# Site Plan

**CONTAINER / TRAILER  
PARKING AVAILABLE**  
STACKING PERMITTED\*

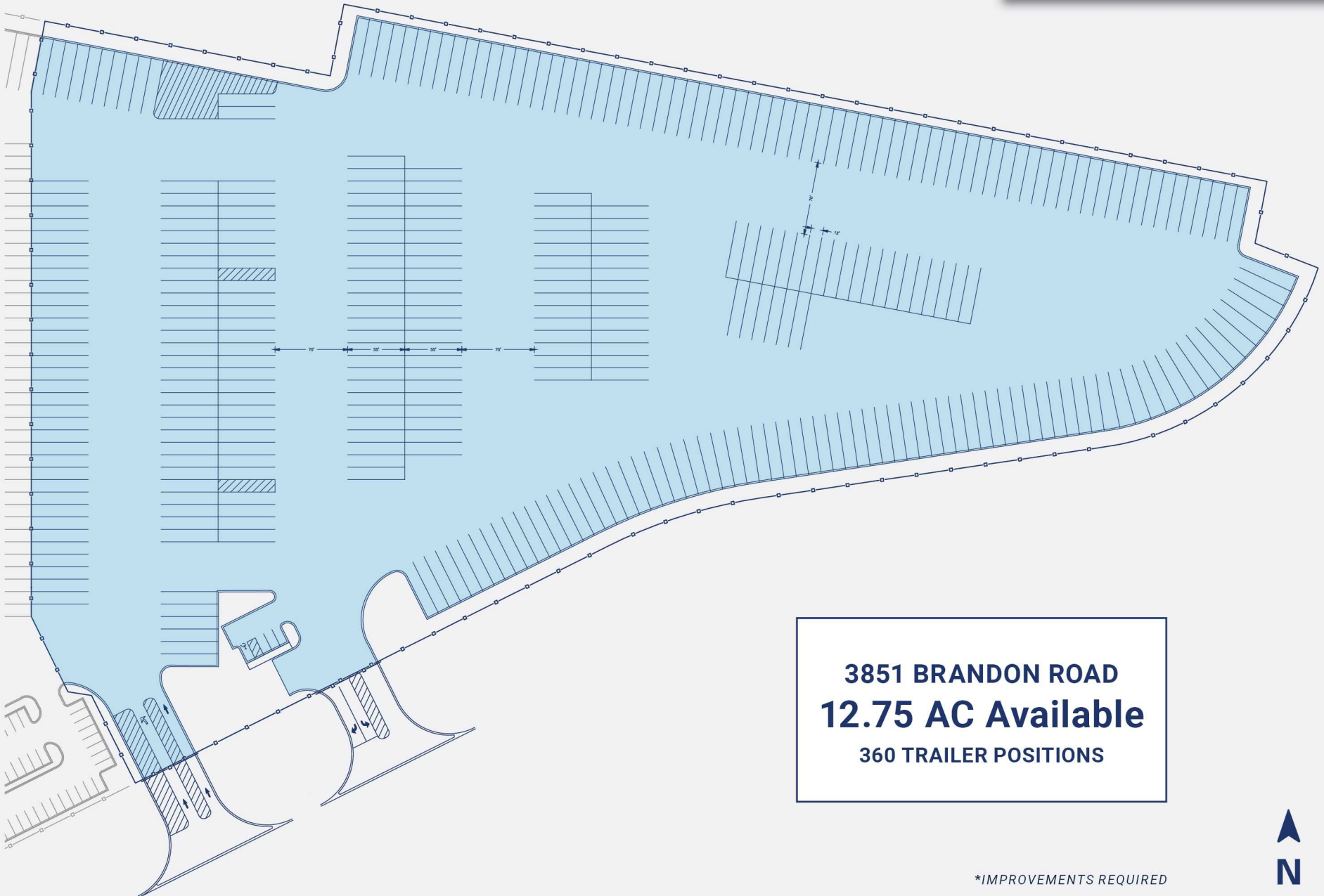

**3851 BRANDON ROAD**  
**12.75 AC Available**  
**360 TRAILER POSITIONS**

\*IMPROVEMENTS REQUIRED



# Key Distances

Measurements based on one-way travel and inclusive of new Houbolt Road Extension access

**Union Pacific Joliet Intermodal Terminal**

1.6 miles

**BNSF Logistics Park Chicago**

5.6 miles

**Downtown Chicago**

40 miles

**Interstate 55**

7.6 miles

**Interstate 80**

6.7 miles

# CenterPoint INTERMODAL CENTER

[centerpoint-intermodal.com](http://centerpoint-intermodal.com)



**NAI Hiffman**

Dan Leahy  
630.691.0604  
[dleahy@hiffman.com](mailto:dleahy@hiffman.com)

Adam Roth, CCIM, SIOR  
630.691.0607  
[aroth@hiffman.com](mailto:aroth@hiffman.com)

**CenterPoint**

Danielle Radtke  
630.586.8146  
[dradtke@centerpoint.com](mailto:dradtke@centerpoint.com)

All information is subject to verification and no liability for errors or omissions is assumed.  
[centerpoint.com](http://centerpoint.com)