



MARINA SIDE VIEW 1 PERSPECTIVE

1575 RESTAURANT

VENTURA HARBOR VILLAGE, VENTURA CA.





MARINA SIDE VIEW 2 PERSPECTIVE

1575 RESTAURANT

VENTURA HARBOR VILLAGE, VENTURA CA.





TOP DECK SEATING

1575 RESTAURANT

VENTURA HARBOR VILLAGE, VENTURA CA.



ARCHITECTS



COURTYARD VIEW 1 PERSPECTIVE

1575 RESTAURANT

VENTURA HARBOR VILLAGE, VENTURA CA.





COURTYARD VIEW 2 PERSPECTIVE

1575 RESTAURANT

VENTURA HARBOR VILLAGE, VENTURA CA.





Cafe Entry - View

1575 RESTAURANT

VENTURA HARBOR VILLAGE, VENTURA CA.



FILE PATH & NAME: P:\060637_VHY_1575_Restaurant\DRAWINGS\DESIGN_PHASE\PLANNING_SUBMITTALS\1575_Restaurant_2A_with_roof_deck_for_Planning_3.21.24.rvt PLOTTED: 3/29/2024 3:58:24 PM

marina

promenade

Legend

indoor dining area	new landscaping	new outdoor dining patio with steel shade structures	new wooden outdoor seat with concrete base
back of house area	(e) landscaping to remain	(e) tree to remain	new steel trellis

A5
1

A5
4

A5
2

A5
3

outdoor dining area 1
1450 sf

outdoor dining area 2
450 sf

indoor dining area 1
1800 sf

indoor dining area 2
1040 sf

kitchen 1
800 sf

outdoor dining
300 sf

kitchen 2
490 sf

entry 1

entry 2

(e) building to remain

1575 Spinnaker Restaurant: Proposed Floor and Site Plan

Enter address here

scale: 3/16" = 1'=0"

3.29.2024

RASMUSSEN & ASSOCIATES
 Architecture
 Planning
 Interiors
 21 S. CALIFORNIA STREET
 VENTURA, CA 93001
 VOICE: (805) 648-1234
 FAX: (805) 648-4444

3

FILE PATH & NAME: P:\060637_VHY_1575_Restaurant\DRAWINGS\DESIGN_PHASE\PLANNING_SUBMITTALS\1575_Restaurant_2A_with_roof_deck_for_Planning_3.21.24.rvt PLOTTED: 3/29/2024 3:58:23 PM

marina

promenade

Legend

- new roof deck
- new landscaping
- new first floor outdoor dining patio with steel shade structures
- (e) tree to remain
- new wooden outdoor seat with concrete base
- new steel trellis

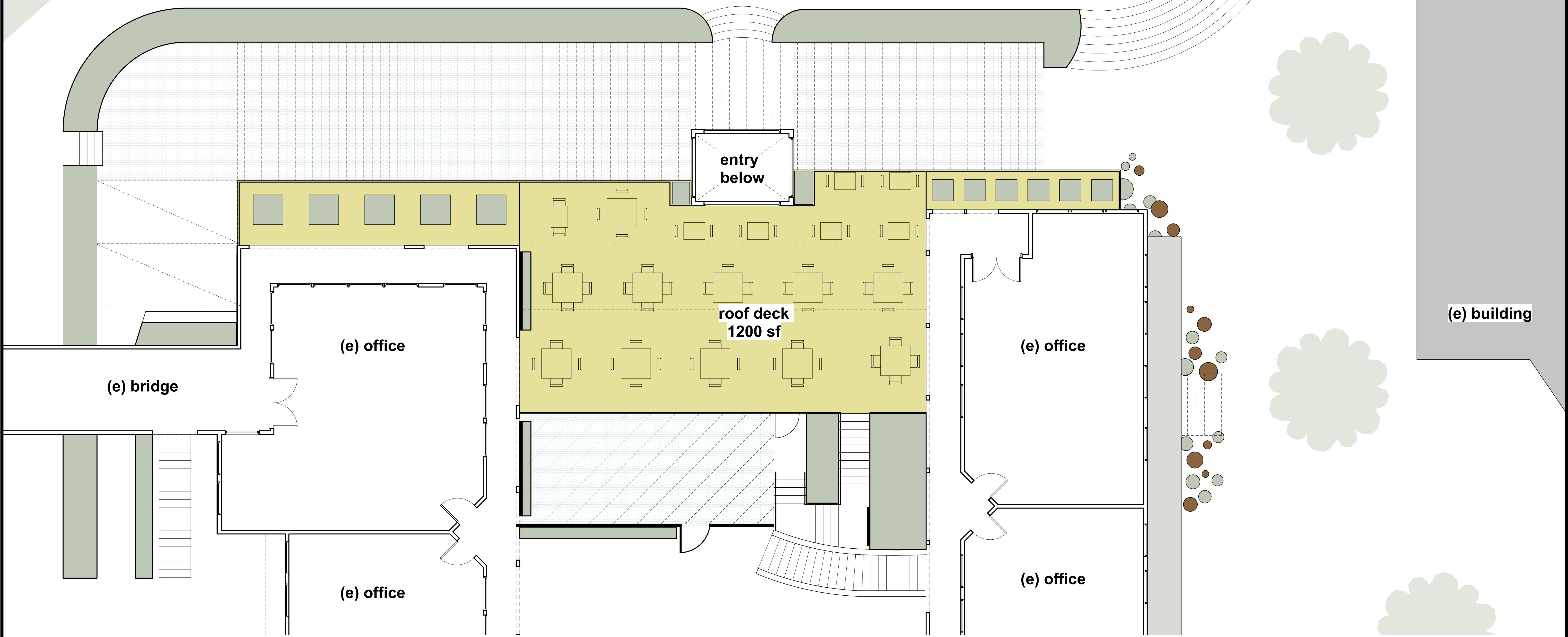

1575 Spinnaker Restaurant: Proposed Second Floor Deck

Enter address here

scale: 3/16" = 1' = 0"

3.29.2024

RASMUSSEN & ASSOCIATES
 Architecture
 Planning
 Interiors
 21 S. CALIFORNIA STREET
 VENTURA, CA 93001
 VOICE: (805) 648-1234
 FAX: (805) 648-4444