

5565 CENTERVIEW DR

RALEIGH, NC 27606 | OFFICE SPACE FOR LEASE



@yorkproperties1

JUDSON MCMILLAN

judsonmcmillan@yorkproperties.com

919.645.2764

york

PROPERTY DETAILS

5565 Centerview Dr, Raleigh, NC 27606

AVAILABILITY:

1st Floor

Suite 107 | \pm 11,091 RSF | Potential to subdivide

2nd Floor

Suite 201 | \pm 7,783 RSF

Suite 202 | \pm 7,653 RSF

Suite 203 | \pm 2,486 RSF

3rd Floor

Suite 300 | \pm 16,086 SF | Potential to subdivide

Suite 303 | \pm 4,269 SF

DETAILS

- LOCATION LOCATION LOCATION!
- In the middle of the Triangle, 10 minutes from everything!
- Easy access to major highways including I-40, I-440 and US-1
- Surrounded by shopping centers, top-rated dining options, coffee shops and entertainment
- Recently renovated common areas
- Ample and well maintained parking lot
- Flexible terms and square footage
- Move-in ready suites for immediate occupancy
- Tenant improvements + customizable options available

LEASE RATE

\$23.50 PSF | Full Service



FLOOR PLANS

6

AVAILABLE SPACES

16,086 - 2,486

SF AVAILABLE

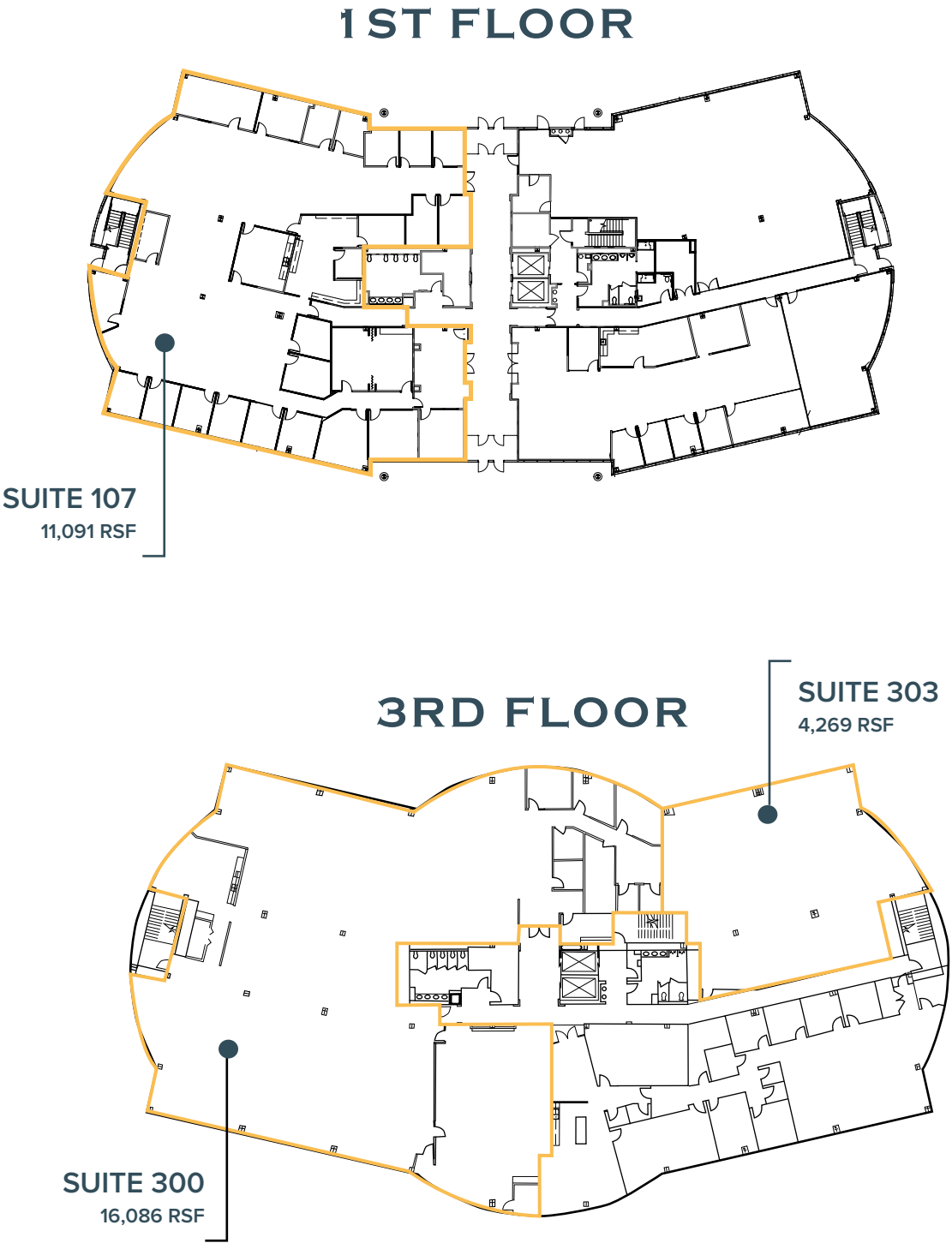
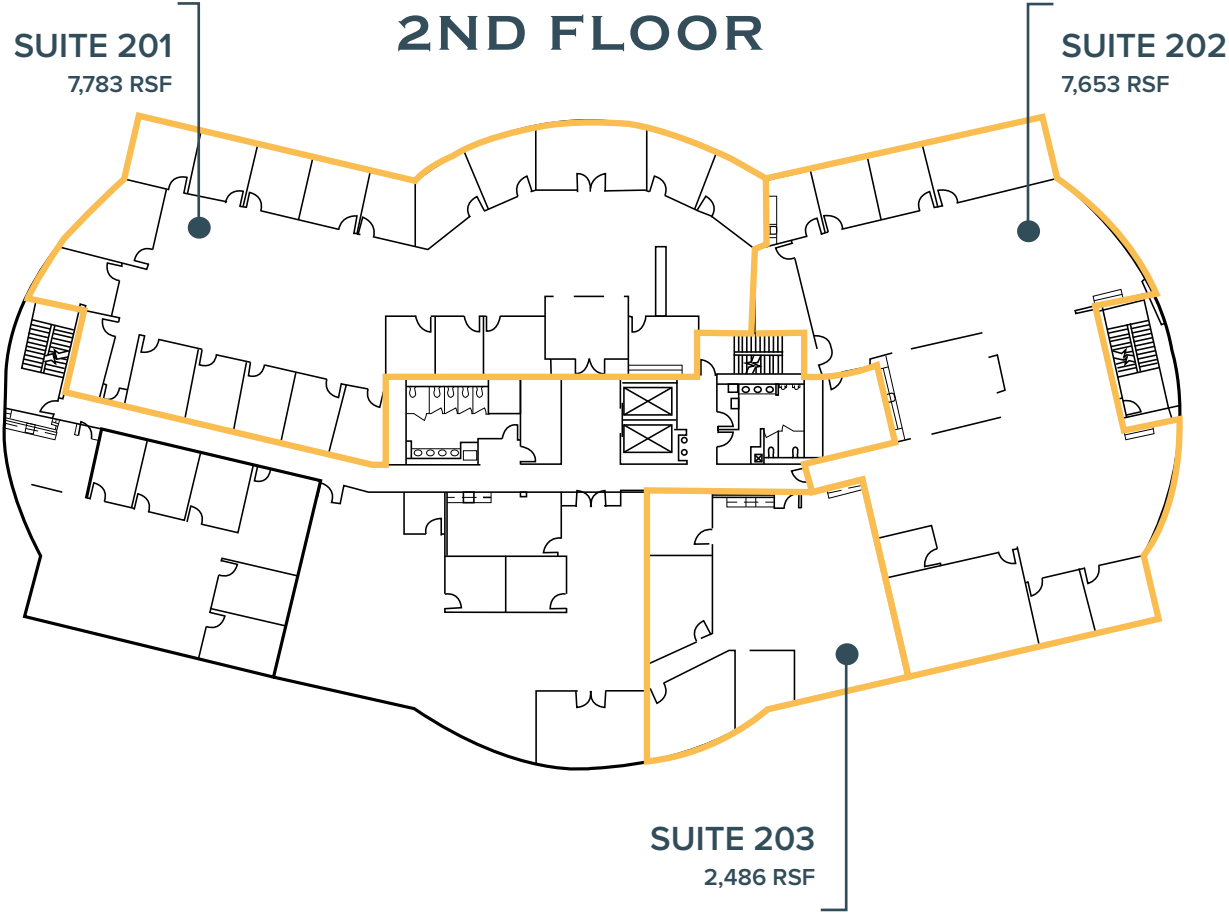



INTERIOR PHOTOS

4



 **DOWNTOWN CARY**
10 min drive from site

 **Harris Teeter**

FENTON

- Superica
- M Sushi
- Club Pilates
- Lululemon
- Dram & Draught
- Colletta
- Crawford Brothers
- Williams Sonoma



SOUTH HILLS
Future planned mixed-use development



WALNUT STREET



DOWNTOWN RALEIGH
10 min drive from site 

.14 miles to I-40
.35 miles to I-440
1.2 miles to Crossroads Plaza
1.8 miles to Centrum Crossroads
3.5 miles to Fenton

5565
CENTERVIEW DR

CENTRUM CROSSROADS

- Carolina Ale House
- Red Robin
- Firehouse Subs
- BJ's Restaurant & Brewhouse



CROSSROADS PLAZA

- Target
- Chick-Fil-A
- Noodles & Co.
- Cava
- Home Goods
- Panera Bread
- Chipotle
- Olive Garden
- Marshalls
- Total Wine



 **Harris Teeter**

ABOUT THE PROPERTY

5565 Centerview Dr, Raleigh, NC 27606

Positioned in a highly accessible neighborhood, 5565 Centerview Drive offers easy connectivity to major highways, public transportation, and nearby amenities, ensuring convenience for your team and visitors. The office boasts a modern layout with flexible configurations to suit a variety of business needs. It is designed to accomodate both open work environments and private office setups.

This premium office space is strategically located to meet your business needs while leaving a positive impression on clients and employees alike. With its turnkey options, flexible layouts, and thoughtful amenities, it sets the stage for productivity, collaboration, and growth. Don't miss the opportunity to elevate your business. Schedule a tour at 5565 Centerview Drive today!

2025 DEMOGRAPHICS REPORT

Population



1 Mile	3 Miles	5 Miles
10,070	78,208	191,171

Average Household Income



1 Mile	3 Miles	5 Miles
\$101,165	\$113,890	\$133,977

Employees



1 Mile	3 Miles	5 Miles
9,262	41,962	106,665

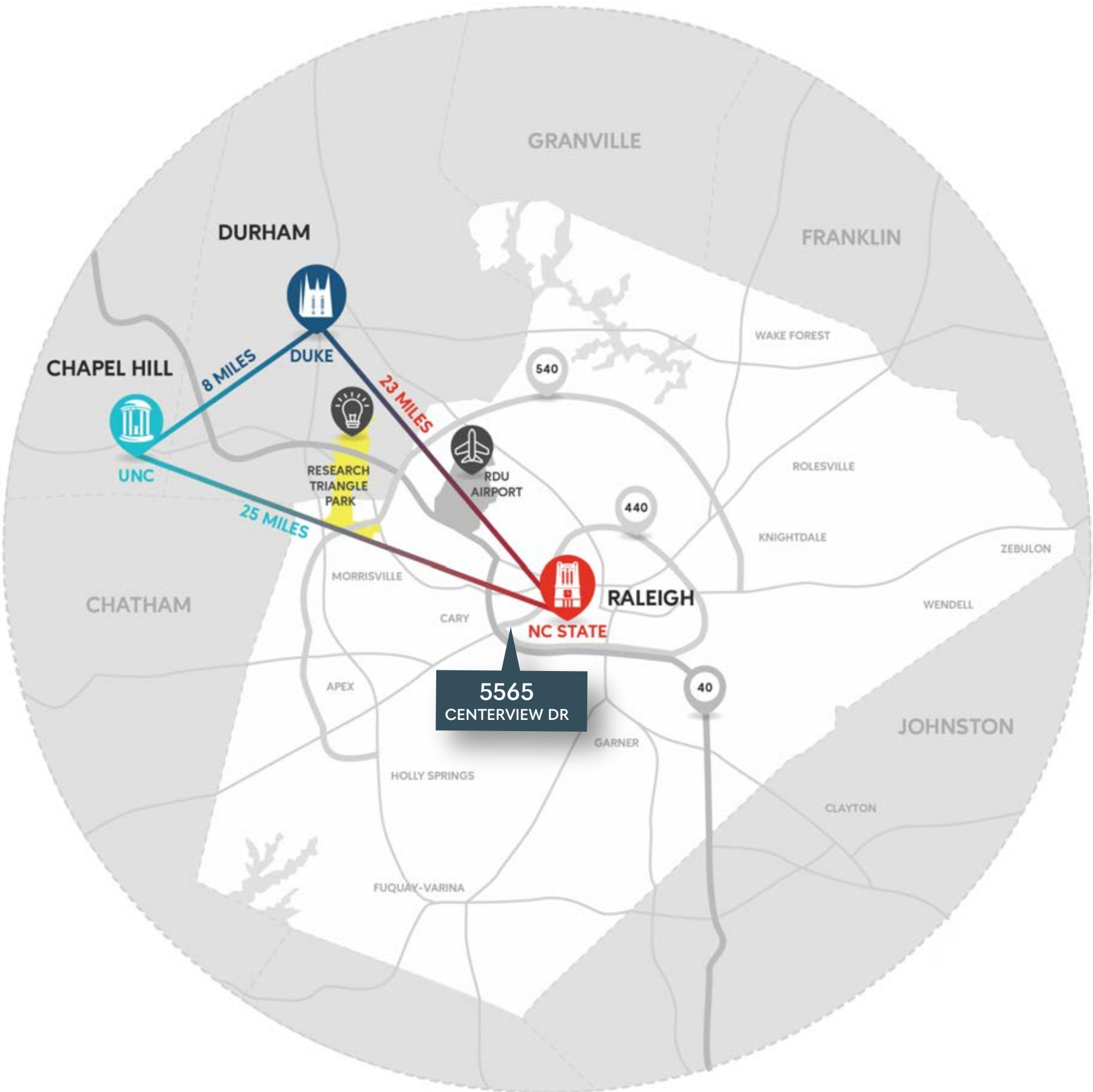

RALEIGH, NC | CITY PROFILE

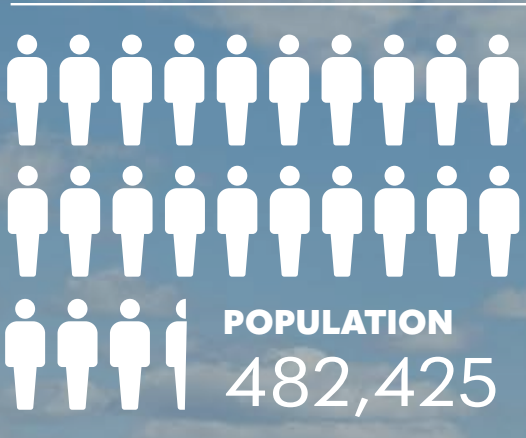

PEOPLE
PER
SQUARE
MILE

3,228.1

MEDIAN AGE
34.9

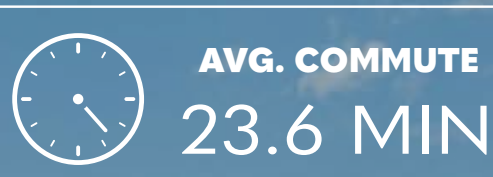

MEDIAN
HOUSEHOLD
INCOME
\$86,309



CARY, NC | CITY PROFILE

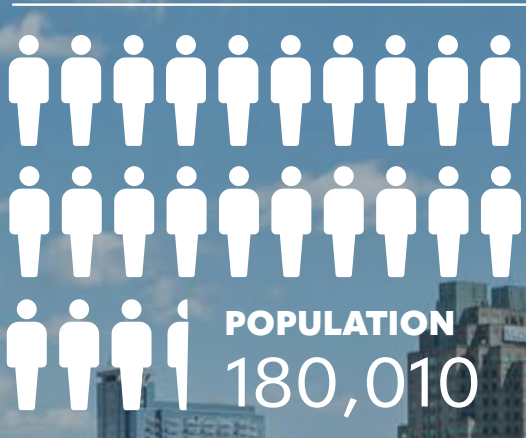

PEOPLE
PER
SQUARE
MILE

2,950

MEDIAN AGE
39.8



MEDIAN
HOUSEHOLD
INCOME
\$129,399



ACCOLADES

#1 Best Performing City for Economic Growth - 2025 Milken Institute

#3 Best State Capital to Live In 2025 WalletHub

#1 Most Livable City 2024 Far & Wide

#3 Fastest Growing City for Construction - 2025 CoreLogic

#1 Best Performing Large Metro Area 2025 Milken Institute

#7 Fastest Growing Cities in the US 2025 U-Haul Annual Growth Report

5565 CENTERVIEW DR.

LEASING

Judson McMillan

judsonmcmillan@yorkproperties.com

919 645 2764

MARKETING

Gardenia Buendia

gardeniabuendia@yorkproperties.com

YORK PROPERTIES

Brokerage · Property Management · Security
Maintenance · Association Management · Construction
Landscaping · Accounting

ADDRESS

2108 Clark Avenue

Raleigh, NC 27605

ONLINE

[@yorkproperties1](https://www.yorkproperties.com)

www.yorkproperties.com