

G.C. TO COORDINATE REQUIREMENTS FOR INSTALLATION AND DELIVERY OF EQUIPMENT VENDORS

ALIGN CENTER LINE OF NEW PARTITION WITH CENTER OF EXISTING WINDOW MULLION

G.C. TO VERIFY THAT DOOR HARDWARE MEETS CODE COMPLIANCE FOR FIRE EXIT PANIC DEVICE, TYP

PROVIDE FIELD-APPLIED OPACIFIER ON NUMBER 4 SURFACE. COLOR TO BE SELECTED BY ARCHITECT FROM MFR'S. STANDARD COLORS (1ST FLOOR @ WEST, SOUTH, EAST SIDES OF MRI ROOM LOCATION).

REINFORCED SLAB AND FOOTING EXTENT OF ENTIRE MRI ROOM. SEE 2/A-5 FOR STRUCTURAL SPECIFICATIONS. VERIFY WITH EQUIPMENT MANUFACTURER EXACT SIZE AND LOCATION OF REINFORCED SLAB.

G.C. TO BE RESPONSIBLE TO BE AWARE OF EXISTING CONDITIONS OF TENANT SPACE. BID SHOULD INCLUDE ALL PHASES OF WORK--FROM ANY DEMO AND CLEAN-UP OF EXISTING SPACE, TO COMPLETION OF THE PROJECT

MRI ROOM, DOOR, WINDOW AND REQUIRED SHIELDING TO BE PROVIDED BY EQUIPMENT MANUFACTURER (N.I.C.)

CONTRACTOR TO REBUILD/ REPLACE SILL AND WALL INTERSECTION AT LOCATIONS DAMAGED / EXPOSED FROM DEMOPLITION WORK, TYP THROUGHOUT

PROVIDE HORIZONTAL BLINDS AT WINDOWS ALONG ENTIRE NORTH SIDE OF BUILDING. MATCH EXISTING TYPE, COLOR, STYLE ETC.

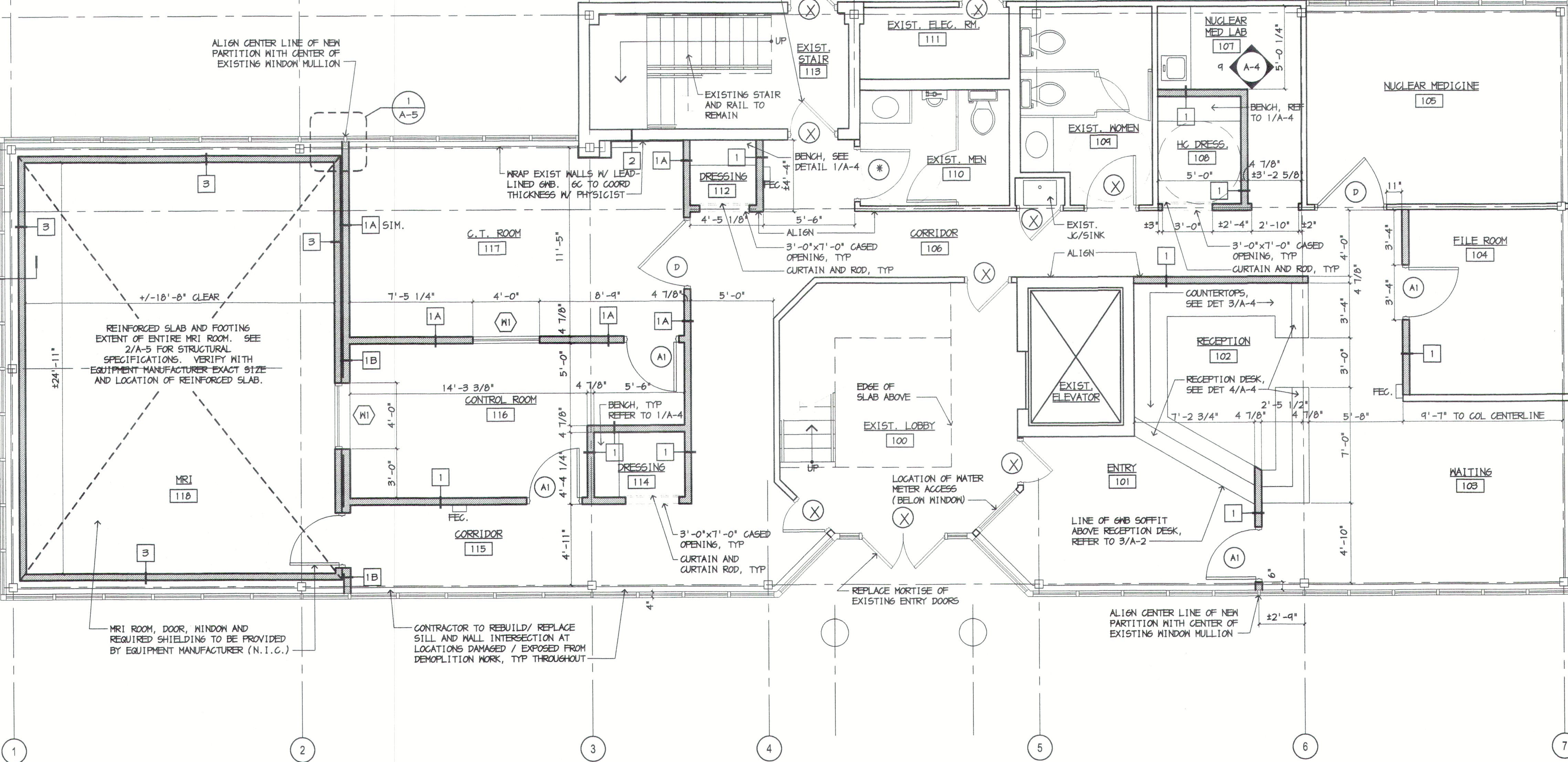

1 FIRST FLOOR PLAN
SCALE: 1/4"=1'-0"



