

SUITE FOR LEASE

*A ±1,691 SF Office Space available now
within the prestigious Phoenix Biltmore
area on Camelback Road.*

2901 E CAMELBACK RD, SUITE 225 | PHOENIX, AZ 85016

SUITE 225

AVAILABLE

NOW

AVAILABLE

±22,172

TWO STORY OFFICE BLDG

\$36.00

LEASE RATE, (FSG)

Discover premium office space in the heart of the Camelback Corridor — Suite 225 offers an exceptional business address with upscale surroundings and unbeatable convenience.

PROPERTY FEATURES

+/-22,172 RBA two story office building

Free underground parking

Built 1999

Zoning C-O/G-O (commercial office / general office); City of Phoenix

Monument signage available

Building signage available facing West fronting Camelback Road

Located within the prestigious Biltmore area



FLOOR PLAN

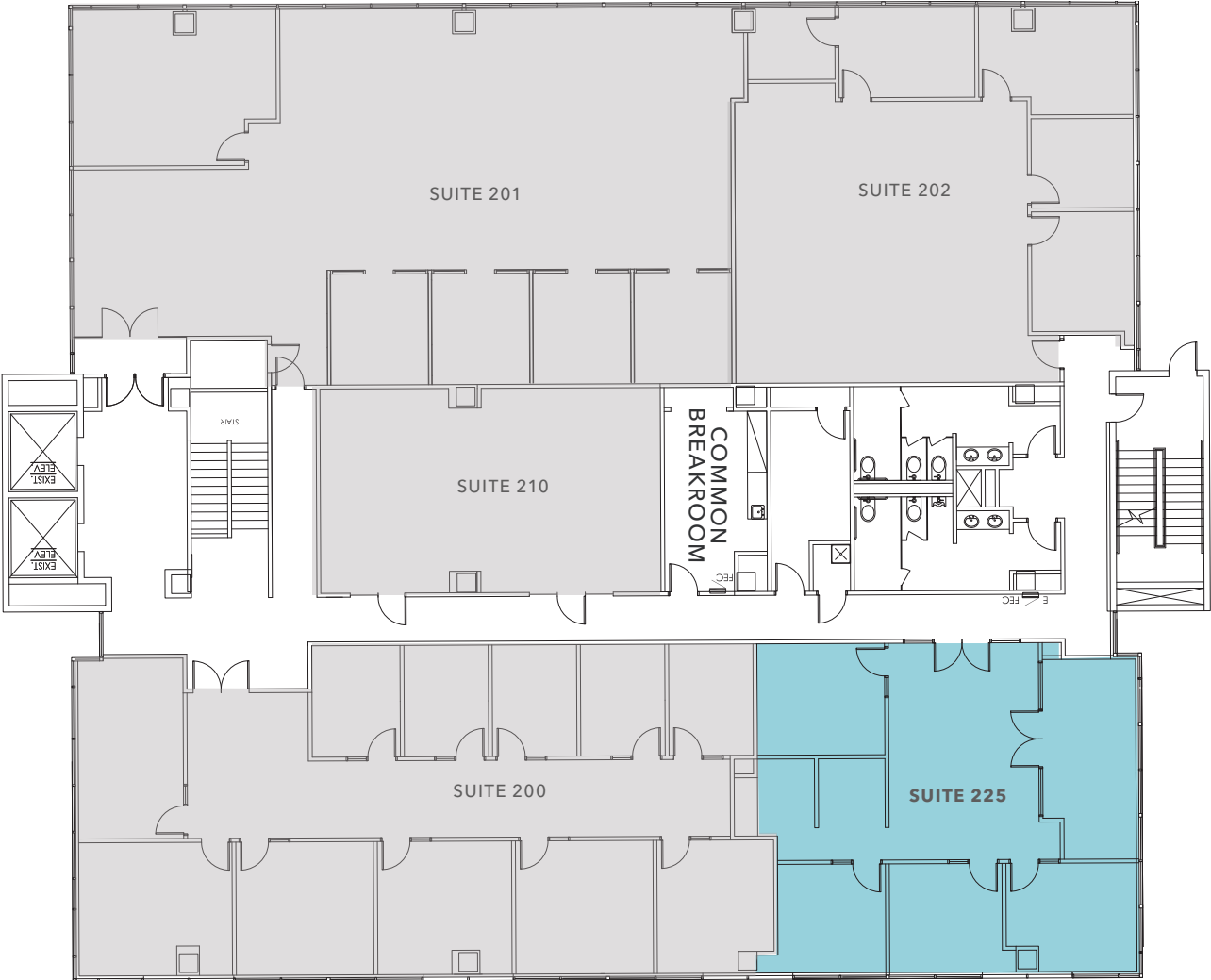

±1,691 SF

SUITE 225

\$36.00

LEASE RATE (FSG)

NOW

AVAILABLE



2901 E CAMELBACK RD, SUITE 225

*For more information on
this property, please contact*

MICHELLE GARDNER
602.513.5126
michelle.gardner@kidder.com

KIDDER.COM

This information supplied herein is from sources we deem reliable. It is provided without any representation, warranty, or guarantee, expressed or implied as to its accuracy. Prospective Buyer or Tenant should conduct an independent investigation and verification of all matters deemed to be material, including, but not limited to, statements of income and expenses. Consult your attorney, accountant, or other professional advisor. All Kidder Mathews designs are the sole property of Kidder Mathews. Branded materials and layouts are not authorized for use by any other firm or person.

