

For Lease

2655 E Grand River Ave
East Lansing, MI 48823

MERIDIAN POINT

- Join Crunch Fitness and Foods for Living
- Directly east of MSU Campus
- High exposure location near Whole Foods and the new Trader Joe's



2501 Coolidge Rd Suite 300
East Lansing, MI 48823
P: +1 517 662 3535
colliers.com



Shawn O'Brien, CCIM
Senior Vice President
+1 517 303 5554
shawn.obrien@colliers.com



Amy Richter-Perkins
Associate Vice President
+1 517 614 1314
amy.richter-perkins@colliers.com



Property Highlights

- Located on E Grand River at Park Lake Road
- Directly east of MSU Campus, convenient to East Lansing and Okemos
- Highly visible location with plenty of parking
- Readily available for food related use - suite includes loading dock, walk-in cooler and freezer
- Adjacent to Auto Zone and Denny's and within 1-2 blocks from Whole Foods and new Trader Joe's.
- 4.5+/- Acre out parcel available

Suite 1 +/- 15,000 SF Available

Lease Term Minimum 5 years

Year Built 2001

Municipality Meridian Township

2021 AADT Grand River Ave: 21,827
Park Lake Rd: 8,094



2021 Population

(1 Mile)
12,639
(3 Mile)
75,764
(5 Mile)
137,610



Avg Income

(1 Mile)
\$73,841
(3 Mile)
\$88,025
(5 Mile)
\$82,297



Median Age

(1 Mile)
23
(3 Mile)
24.5
(5 Mile)
28

Lease Rate

\$15.00/SF - \$17.00/SF

NNN

+/- \$3.95/SF

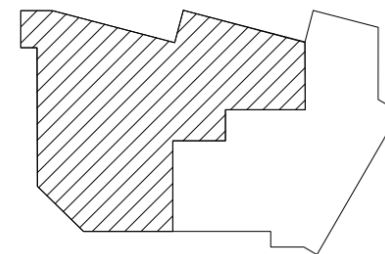
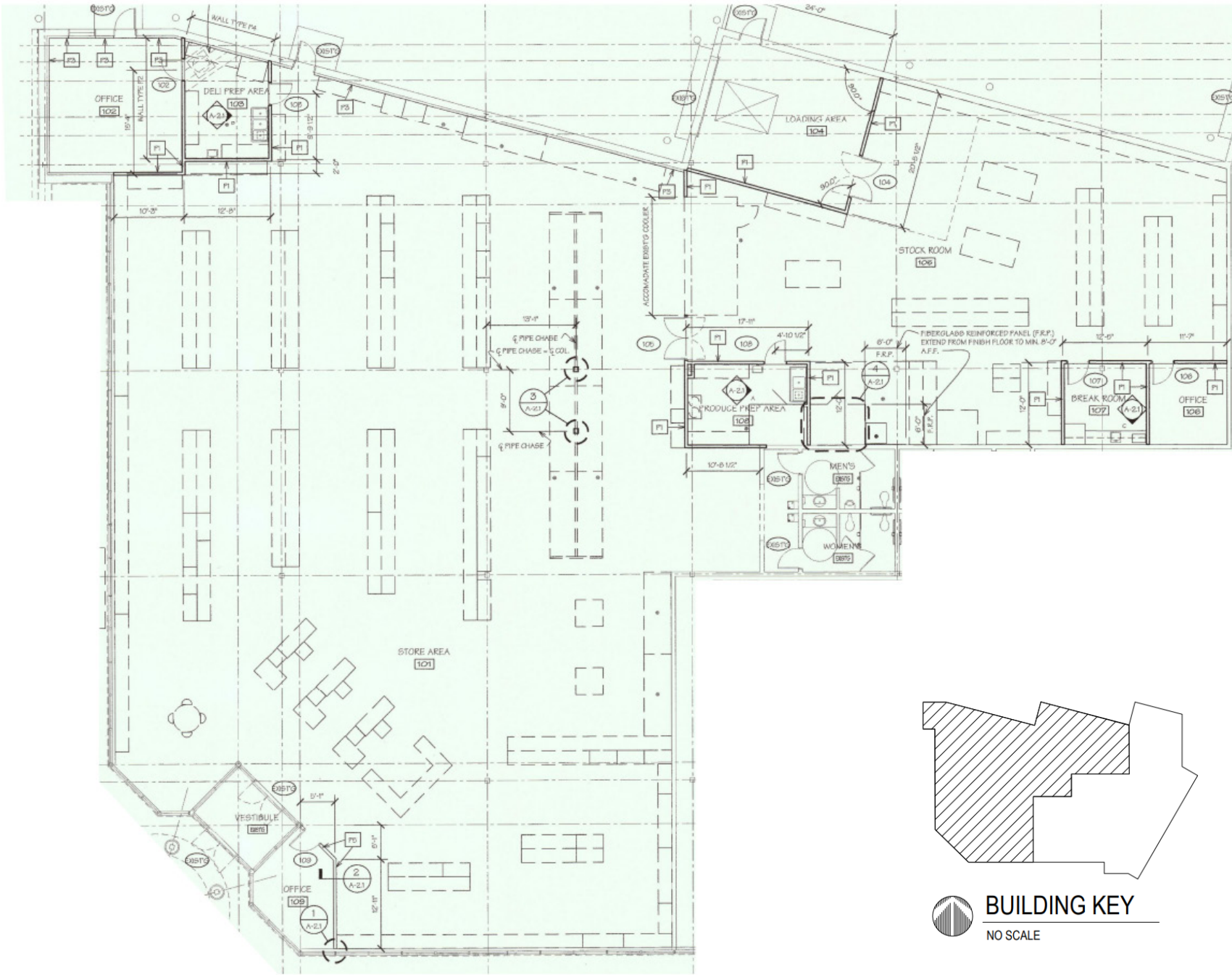

BUILDING KEY
NO SCALE



2501 Coolidge Rd Suite 300
East Lansing, MI 48823
P: +1 517 662 3535
colliers.com



Shawn O'Brien, CCIM
Vice President
+1 517 303 5554
shawn.obrien@colliers.com



Amy Richter-Perkins
Associate Vice President
+1 517 614 1314
amy.richter-perkins@colliers.com



This document has been prepared by Colliers International for advertising and general information only. Colliers International makes no guarantees, representations or warranties of any kind, expressed or implied, regarding the information including, but not limited to, warranties of content, accuracy and reliability. Any interested party should undertake their own inquiries as to the accuracy of the information. Colliers International excludes unequivocally all inferred or implied terms, conditions and warranties arising out of this document and excludes all liability for loss and damages arising there from. This publication is the copyrighted property of Colliers International and/or its licensor(s). ©2024. All rights reserved.