

# **FOR LEASE – PROFESSIONAL OFFICE**

***MOVE-IN READY – 2<sup>nd</sup> Generation Office***  
**2260 Highland Village Road**  
**Highland Village, TX**



## **2260 Highland Village Road Highland Village, TX**

### **AVAILABLE SPACE**

- Suite 100 – 1,350 RSF

### **LEASE RATE**

- Base Rent \$19.75/SF/YR + NNNs

### **ABOUT THIS SPACE**

- 2<sup>nd</sup> generation office space with well-laid out floor plan consisting of reception area, conference room, 4 private offices, storage, break area and private restroom.

### **LOCATION**

- Located in Highland Village, North of the intersection of FM 407 (Justin Road) and Highland Village Road.
- Easy access to FM 407, I-35E and FM 2499
- Highland Village ranks in the Top Ten safest cities in Texas according to Safewise.
- High median household income: \$133,161\*
- Situated among other office buildings with professional and medical office tenants.

### **HIGHLIGHTS**

- Monument signage on Highland Village Road
- Walkability to nearby restaurant offerings

\*according to highlandvillage.org

## **FOR INFORMATION:**

Diana Pergande | Phyllis Garcia

972.899.1851 | [Diana@BridgeRealtyTexas.com](mailto:Diana@BridgeRealtyTexas.com) | [Phyllis@BridgeRealtyTexas.com](mailto:Phyllis@BridgeRealtyTexas.com)

[www.BridgeRealtyTexas.com](http://www.BridgeRealtyTexas.com)

400 Parker Square, Suite 270H | Flower Mound, TX 75028

This information is believed to be accurate, but no representation or warranty, express or implied, as to its accuracy or completeness is made by any party. The presentation of this property is submitted subject to errors, omissions, change of price or prior sale or lease, or withdrawal without notice.



# 2260 Highland Village Road

## Maps

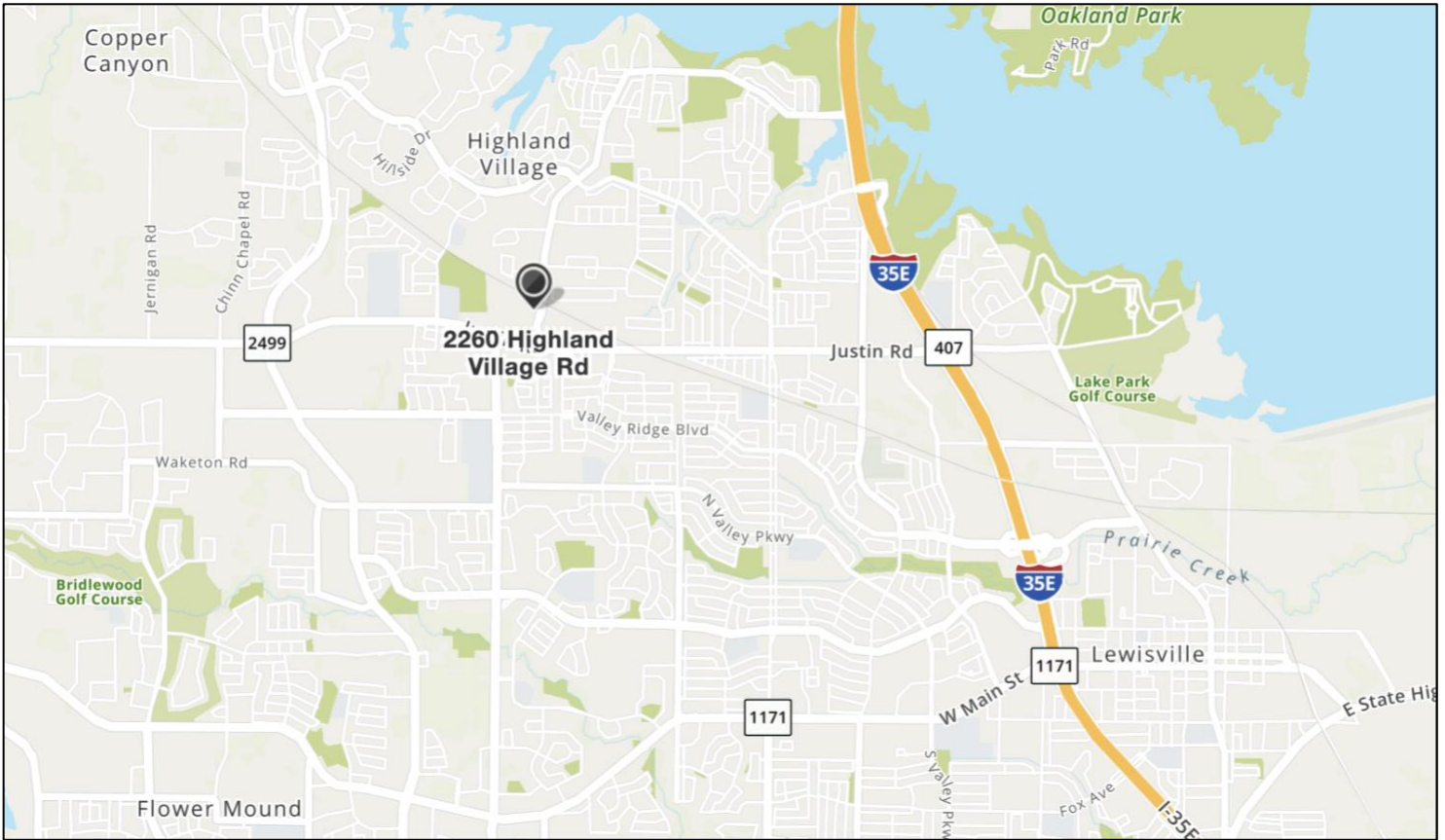

2260 Highland Village Road  
Suite 100 Floor Plan – 1,350 RSF

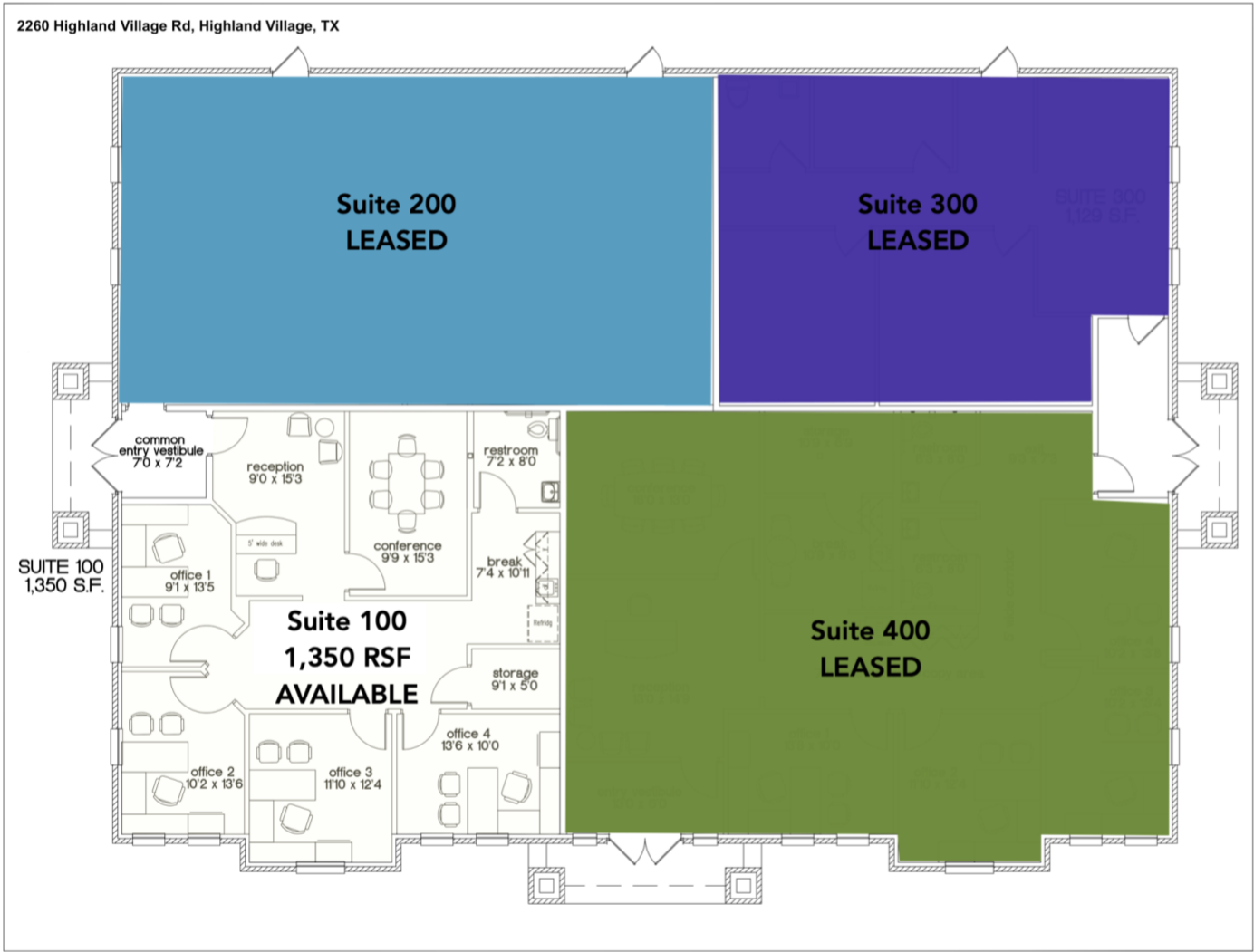



# 2260 Highland Village Road

## Photos

