

**27211**  
**Industrial Blvd**

**FOR LEASE**  
**64,485 SF**  
**ON 3.56 ACRES**



**Freestanding Industrial Building  
with Heavy Power & Parking**

**CHRIS VAN KEULEN**  
Senior Vice President  
chris.vankeulen@cbre.com  
+1 510 874 1934  
Lic. 01845520

**BROOKS BAKER**  
Senior Associate  
brooks.baker@cbre.com  
+1 510 874 1927  
Lic. 02000900



**FORTRESS**

**CBRE**



# PROPERTY HIGHLIGHTS



**Total Bldg**  
64,485 SF



**Site Area**  
3.56 acres (side portion  
secured and fenced)



**Power Plug**  
3,000 amps @ 120/208v  
(Tenant to Verify)



**Recently  
Renovated  
Office**  
3,276 SF



**Asking Rate**  
\$1.35 PSF NNN



**Interior Clear Height**  
20.5'



**Loading**  
Five (5) external dock-high doors  
with levelers, 2 drive-in doors



**Parking**  
70 off-street  
parking stalls



**Zoning**  
Light Industrial (LI)



# SITE PLAN

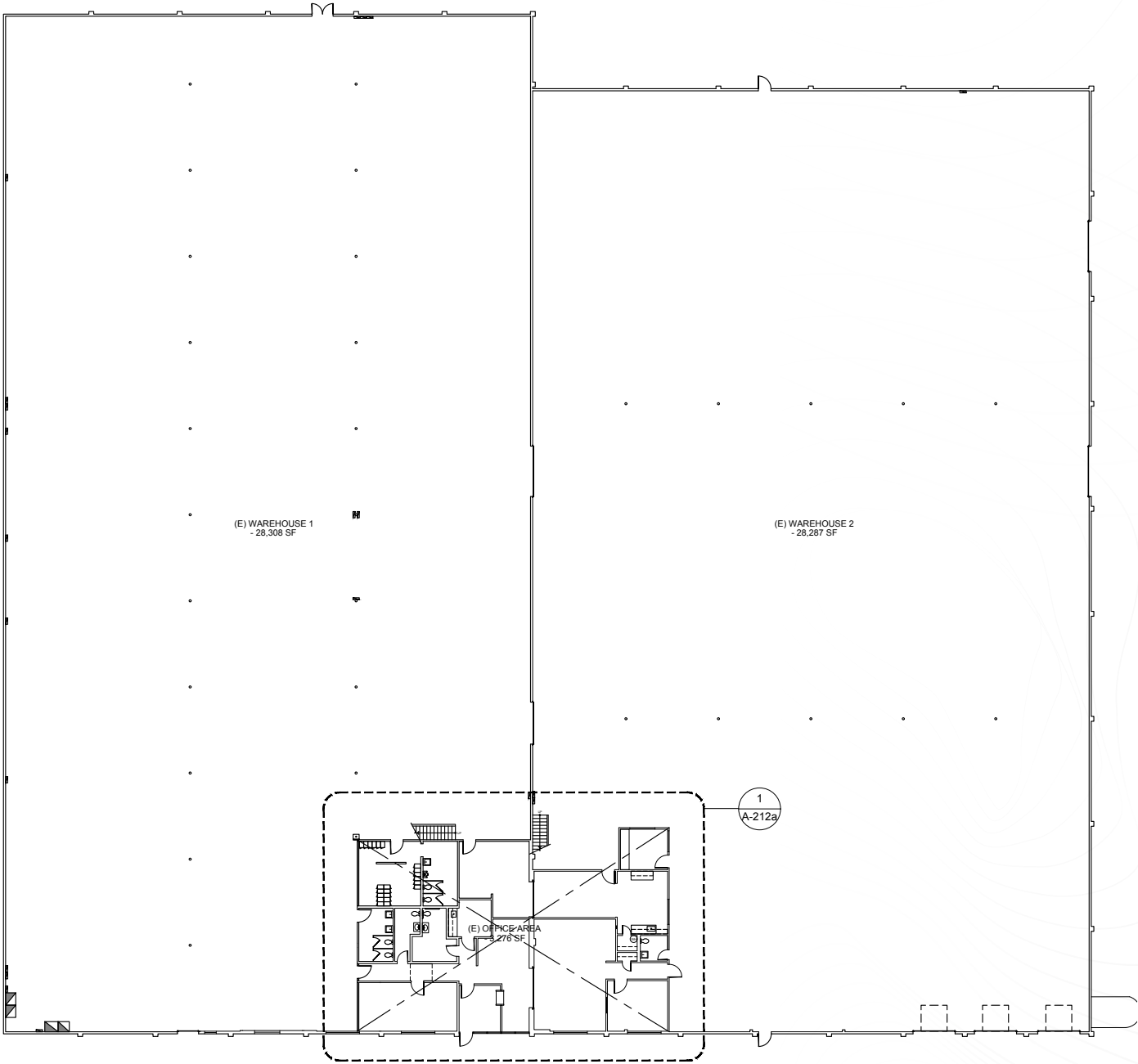

INDUSTRIAL BOULEVARD



← San Mateo

San Francisco  
↓

92

92

27211  
Industrial Blvd







27211  
Industrial Blvd

## CONTACTS

### CHRIS VAN KEULEN

Senior Vice President  
chris.vankeulen@cbre.com  
+1 510 874 1934  
Lic. 01845520

### BROOKS BAKER

Senior Associate  
brooks.baker@cbre.com  
+1 510 874 1927  
Lic. 02000900



**CBRE**

© 2025 CBRE, Inc. All rights reserved. This information has been obtained from sources believed reliable, but has not been verified for accuracy or completeness. You should conduct a careful, independent investigation of the property and verify all information. Any reliance on this information is solely at your own risk. CBRE and the CBRE logo are service marks of CBRE, Inc. All other marks displayed on this document are the property of their respective owners, and the use of such logos does not imply any affiliation with or endorsement of CBRE. Photos herein are the property of their respective owners. Use of these images without the express written consent of the owner is prohibited.