



SENTARA BROCK CANCER CENTER

6251 E. VIRGINIA BEACH BOULEVARD | NORFOLK, VA 23502 | SENTARALEASING.COM

CONSTRUCTION COMPLETE

**FOR MORE INFORMATION,
PLEASE CONTACT:**

John M. Profilet, SIOR

757.640.2278 (direct) | 757.679.3278 (mobile)

jprofilet@slnusbaum.com

Ben Leon

757.640.2272 (direct) | 757.469.2365 (mobile)

bleon@slnusbaum.com

PROPERTY HIGHLIGHTS

Lease Rate: \$23.15 PSF, NNN

- 43,326 LSF available within this Class A 251,183± SF cancer treatment center which serves over 700 people a day. The center is situated on the campus of Sentara Leigh Hospital, a 250-bed, full service hospital specializing in orthopedic, cardiac, advanced imaging, general surgical, gynecological, obstetrical and comprehensive breast care services.
- 600-vehicle parking deck.
- Strategic location with quick access to I-64 and I-264.
- In close proximity to multiple modes of public transportation that includes the [Newtown Road Light Rail Station](#) and [HRT Bus Route 22](#) and [HRT Bus Route 27](#).
- First class property management.
- Generous landlord contribution to tenant's construction costs.



FOR LEASE

**FOR MORE INFORMATION,
PLEASE CONTACT:**

John M. Profilet, SIOR

757.640.2278 (direct) | 757.679.3278 (mobile)
jprofilet@slnusbaum.com

Ben Leon

757.640.2272 (direct) | 757.469.2365 (mobile)
bleon@slnusbaum.com

SENTARA BROCK CANCER CENTER SERVICES

This new patient-centered facility is a clinically advanced destination for hope and healing. A few of the services patients can expect are:

- A beautiful, calming environment that includes an outdoor Healing Garden, original art by local community artists, and quiet family workstations for caregivers as they assist their loved ones at appointments
- Comprehensive portfolio of clinical offerings to support a cancer patient in all aspects of their care, including Sentara's first outpatient supportive care clinic in the Hampton Roads Community
- Advanced diagnostic and imaging services including PET, MRI, CT, X-Ray, Bone Density, and the Sentara Leigh Comprehensive Breast Center
- Complementary alternative medicine therapies and services to provide a holistic approach to patient care including art therapy, support groups, massage, and more
- Retail partners such as Silhouette Mastectomy Boutique, a retail shop for wig services, headwear and mastectomy products; and the Smoothie Stop Café, offering delicious and healthy smoothies, cold-pressed juices, grab-and-go wraps, and salads
- An outpatient therapy center specializing in cancer and neuro therapies
- Luke Hillier Cancer Research Alliance, an innovative partnership between Sentara, EVMS, and Virginia Oncology Associates working to advance oncology research



FOR LEASE

**FOR MORE INFORMATION,
PLEASE CONTACT:**

John M. Profilet, SIOR

757.640.2278 (direct) | 757.679.3278 (mobile)

jprofilet@slnusbaum.com

Ben Leon

757.640.2272 (direct) | 757.469.2365 (mobile)

bleon@slnusbaum.com



**FOR MORE INFORMATION,
PLEASE CONTACT:**

John M. Profilet, SIOR
757.640.2278 (direct) | 757.679.3278 (mobile)
jprofilet@slnusbaum.com

Ben Leon
757.640.2272 (direct) | 757.469.2365 (mobile)
bleon@slnusbaum.com



**FOR MORE INFORMATION,
PLEASE CONTACT:**

John M. Profilet, SIOR
757.640.2278 (direct) | 757.679.3278 (mobile)
jprofilet@slnusbaum.com

Ben Leon
757.640.2272 (direct) | 757.469.2365 (mobile)
bleon@slnusbaum.com



HAMPTON ROADS DEMOGRAPHICS (ESRI 2020)

Population:	1,410,381
Households:	525,085
Average Household Income:	\$84,947

**FOR MORE INFORMATION,
PLEASE CONTACT:**

John M. Profilet, SIOR
757.640.2278 (direct) | 757.679.3278 (mobile)
jprofilet@slnusbaum.com

Ben Leon
757.640.2272 (direct) | 757.469.2365 (mobile)
bleon@slnusbaum.com



**FOR MORE INFORMATION,
PLEASE CONTACT:**

John M. Profilet, SIOR
757.640.2278 (direct) | 757.679.3278 (mobile)
jprofilet@slnusbaum.com

Ben Leon
757.640.2272 (direct) | 757.469.2365 (mobile)
bleon@slnusbaum.com

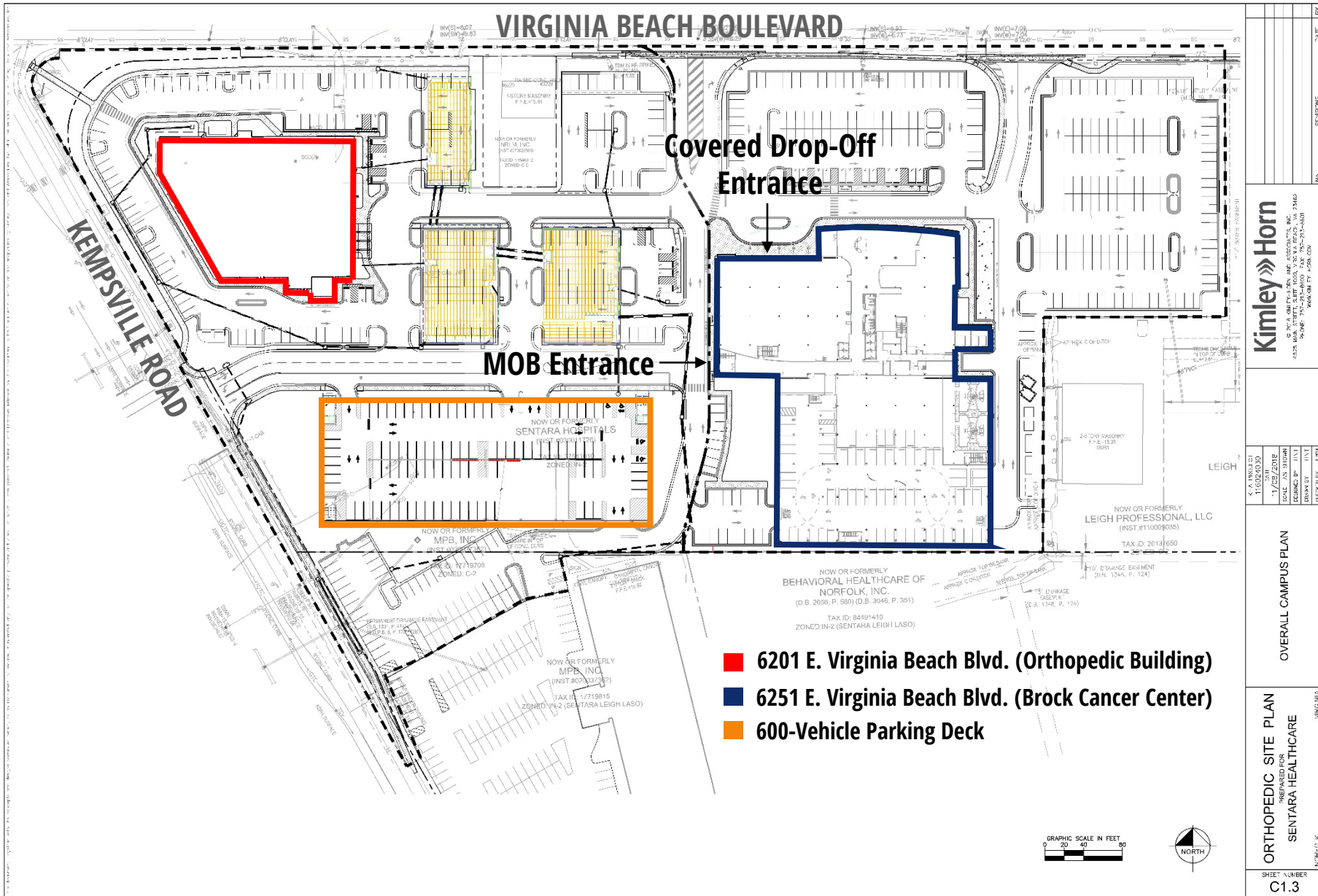

- 6201 E. Virginia Beach Blvd. (Orthopedic Building)
- 6251 E. Virginia Beach Blvd. (Brock Cancer Center)
- 600-Vehicle Parking Deck

Kimley»Horn <small>© 2018 KIMLEY-HORN AND ASSOCIATES, INC. 4501 MARKET STREET, SUITE 2000, FARMERSBURGH, VA 23061 WWW.KH.COM</small>	NO. _____ REVISIONS _____ DATE _____ BY _____
	K.A. PROJECT NO. _____ DATE _____ SCALE: AS SHOWN DRAWING NO. _____ DRAWN BY _____ CHECKED BY _____
OVERALL CAMPUS PLAN	SHEET NUMBER C1.3

FOR LEASE

**FOR MORE INFORMATION,
PLEASE CONTACT:**

John M. Profilet, SIOR
757.640.2278 (direct) | 757.679.3278 (mobile)
jprofilet@slnusbaum.com

Ben Leon
757.640.2272 (direct) | 757.469.2365 (mobile)
bleon@slnusbaum.com

THIRD FLOOR PLAN

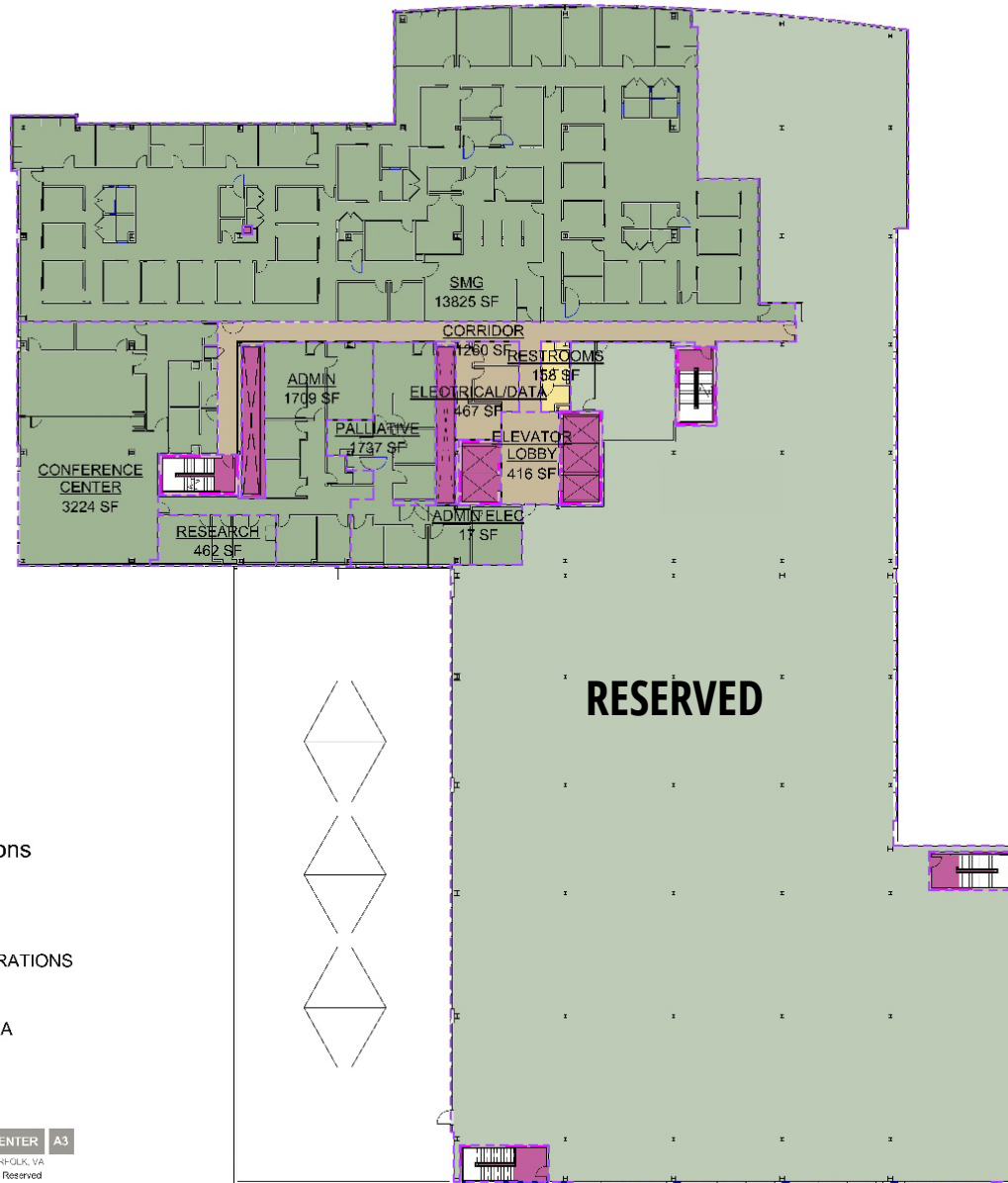

- BOMA Space Designations**
- FLOOR AMENITY AREAS
 - FLOOR SERVICE AREAS
 - MAJOR VERTICAL PENETRATIONS
 - OCCUPANT AREA
 - RENTABLE BUILDING AREA



BOMA AREAS - THIRD FLOOR | SENTARA CANCER CENTER | A3
12/13/19 | CITY OF NORFOLK, VA | © 2019 ODELL Associates, Inc. All Rights Reserved

111 Virginia Street | Richmond, VA 23219 | T. 804.287.8200 | F. 804.287.8279 | www.odell.com

FOR LEASE

**FOR MORE INFORMATION,
PLEASE CONTACT:**

John M. Profilet, SIOR
 757.640.2278 (direct) | 757.679.3278 (mobile)
 jprofilet@slnusbaum.com

Ben Leon
 757.640.2272 (direct) | 757.469.2365 (mobile)
 bleon@slnusbaum.com

FOURTH FLOOR PLAN

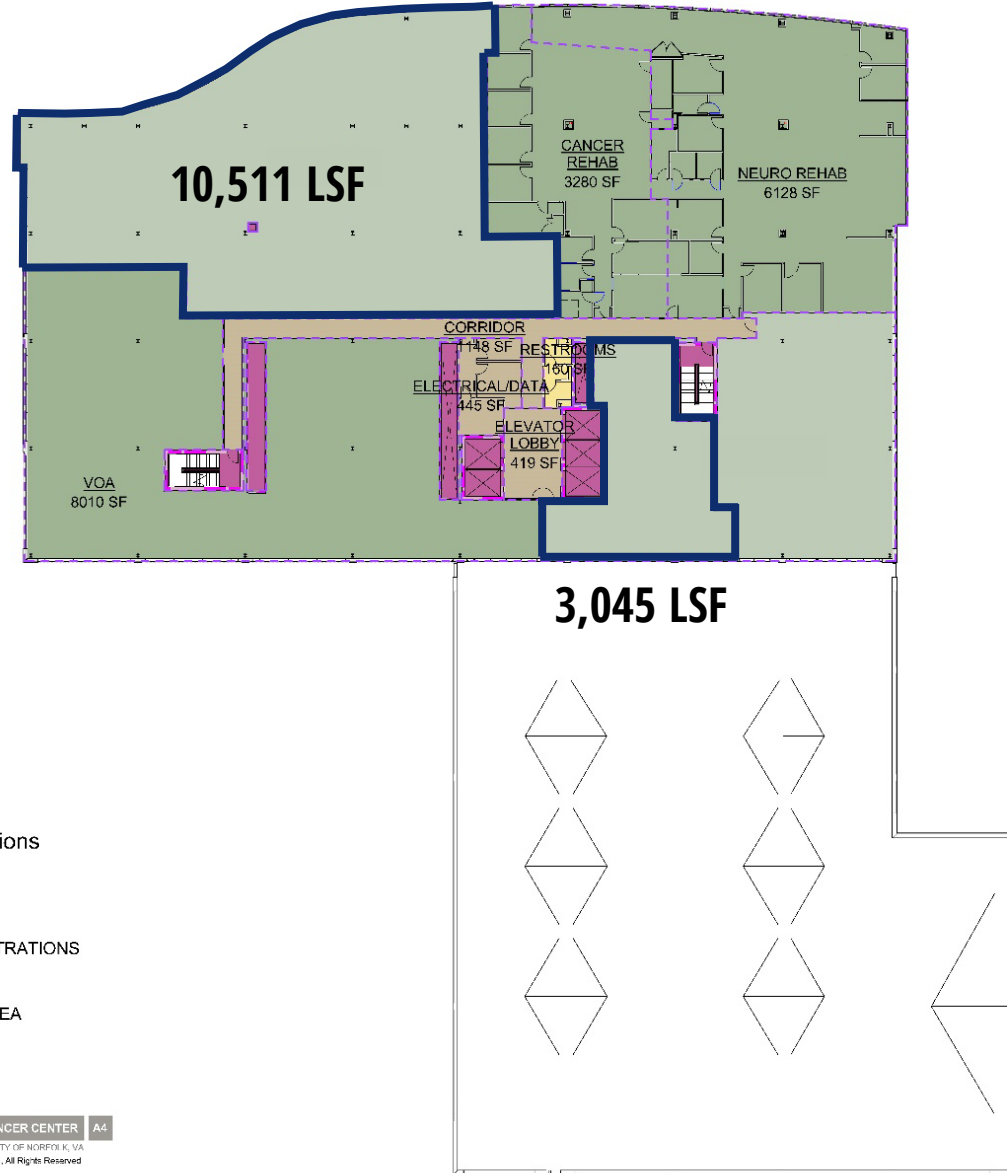

BOMA Space Designations

- FLOOR AMENITY AREAS
- FLOOR SERVICE AREAS
- MAJOR VERTICAL PENETRATIONS
- OCCUPANT AREA
- RENTABLE BUILDING AREA



BOMA AREAS - FOURTH FLOOR

SENTARA CANCER CENTER

A4

12/15/18

CITY OF NORFOLK, VA

© 2019 ODELL Associates, Inc. All Rights Reserved

FOR LEASE

**FOR MORE INFORMATION,
PLEASE CONTACT:**

John M. Profilet, SIOR
757.640.2278 (direct) | 757.679.3278 (mobile)
jprofilet@slnusbaum.com

Ben Leon
757.640.2272 (direct) | 757.469.2365 (mobile)
bleon@slnusbaum.com

FIFTH FLOOR PLAN

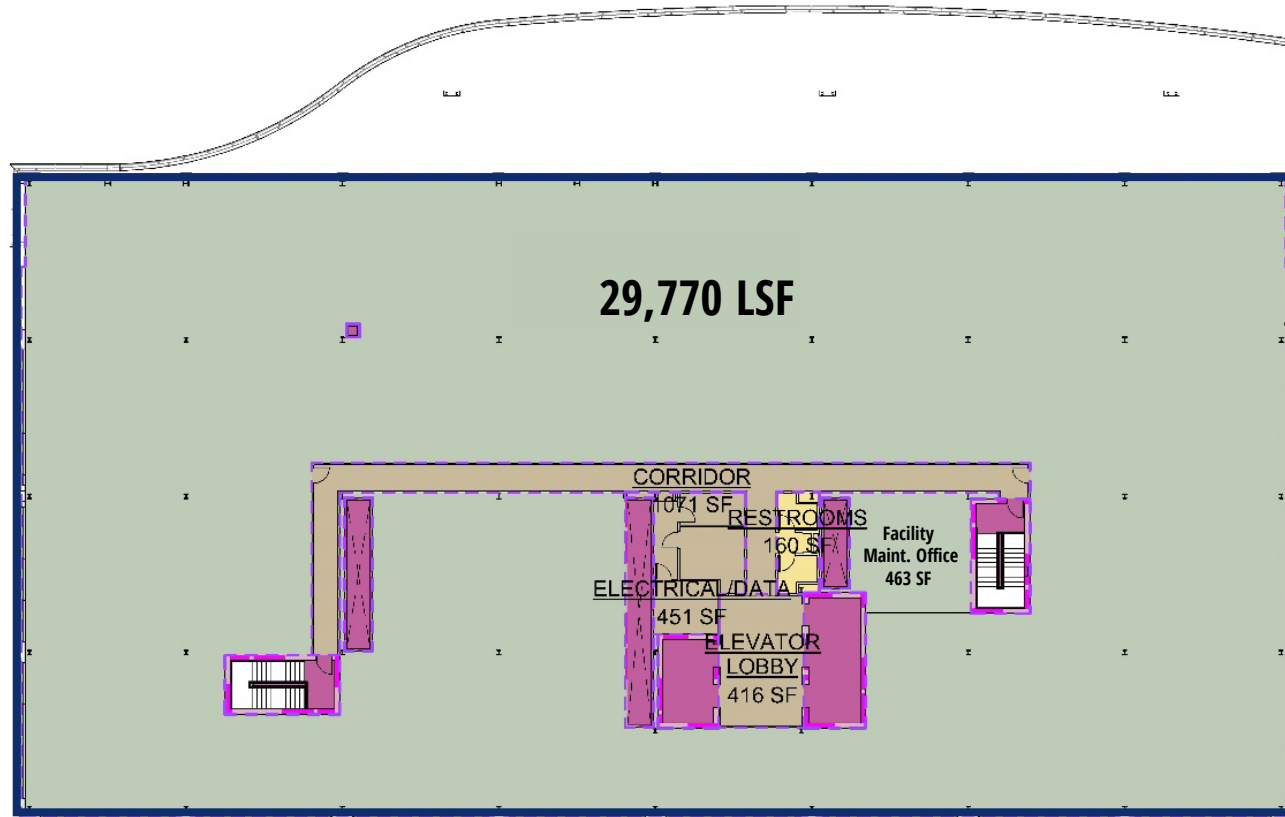

BOMA Space Designations

- FLOOR AMENITY AREAS
- FLOOR SERVICE AREAS
- MAJOR VERTICAL PENETRATIONS
- RENTABLE BUILDING AREA

111 Virginia Street | Richmond, VA 23219 | T. 804.287.8200 | F. 804.287.8279 | www.odell.com

FOR LEASE



BOMA AREAS - FIFTH FLOOR
SENTARA CANCER CENTER
A5

12/13/19 CITY OF NORFOLK, VA
 © 2019 ODELL Associates, Inc., All Rights Reserved

**FOR MORE INFORMATION,
PLEASE CONTACT:**

John M. Profilet, SIOR
757.640.2278 (direct) | 757.679.3278 (mobile)
jprofilet@slnusbaum.com

Ben Leon
757.640.2272 (direct) | 757.469.2365 (mobile)
bleon@slnusbaum.com

POTENTIAL LAYOUT



111 Virginia Street | Richmond, VA 23219 | T. 804.287.8200 | F. 804.287.8279 | www.odell.com

FOR LEASE



SCHEMATIC PLAN - OPTION 1

SENTARA CANCER CENTER 1

November 2, 2020

6229 E VIRGINIA BEACH BOULEVARD, NORFOLK, VA
© 2020 ODELL Associates, Inc., All Rights Reserve

**FOR MORE INFORMATION,
PLEASE CONTACT:**

John M. Profilet, SIOR
757.640.2278 (direct) | 757.679.3278 (mobile)
jprofilet@slnusbaum.com

Ben Leon
757.640.2272 (direct) | 757.469.2365 (mobile)
bleon@slnusbaum.com

POTENTIAL LAYOUT



ODELL
 111 Virginia Street Richmond, VA 23219 T. 804.287.8200 F. 804.287.8279 www.odell.com

FOR LEASE



DISCLAIMER:

No warranty or representation, expressed or implied, is made to the accuracy or completeness of the information contained herein, and same is submitted subject to errors, omissions, change of price, rental or other conditions, withdrawal without notice, and to any special listing conditions imposed by the property owner(s). As applicable, we make no representation as to the condition of the property (or properties) in question.

**FOR MORE INFORMATION,
PLEASE CONTACT:**

John M. Profilet, SIOR
757.640.2278 (direct) | 757.679.3278 (mobile)
jprofilet@slnusbaum.com

Ben Leon
757.640.2272 (direct) | 757.469.2365 (mobile)
bleon@slnusbaum.com