

# 28 Sycamore Avenue

Medford, MA



LEASED

26,000 SF

Available



# Property Overview

Cushman & Wakefield, as exclusive agent, is pleased to present the opportunity to lease 28 Sycamore Avenue (the "Property"), an approximately 41,000 square foot industrial building located in Medford, Massachusetts. Situated on 2.69 acres, the Property currently can subdivide to 26,000 SF and accommodate one tenant.

28 Sycamore Avenue is located less than five miles from Downtown Boston, four miles from Kendall Square and steps from Somerville's rapidly transforming neighborhood. The property sits directly off of Routes 16 and 28 allowing for immediate access to Interstate 93, providing accessibility in all directions.



## Building Specifications

<b>Total Size:</b>	41,000 SF
<b>Availabilities:</b>	26,000 SF (6,000 SF of office)
<b>Loading:</b>	1 Dock 1 Grade level
<b>Clear Height:</b>	32'
<b>Parking:</b>	1/1,000 SF
<b>Power:</b>	1,200 Amps at 480V







# Site Plan:

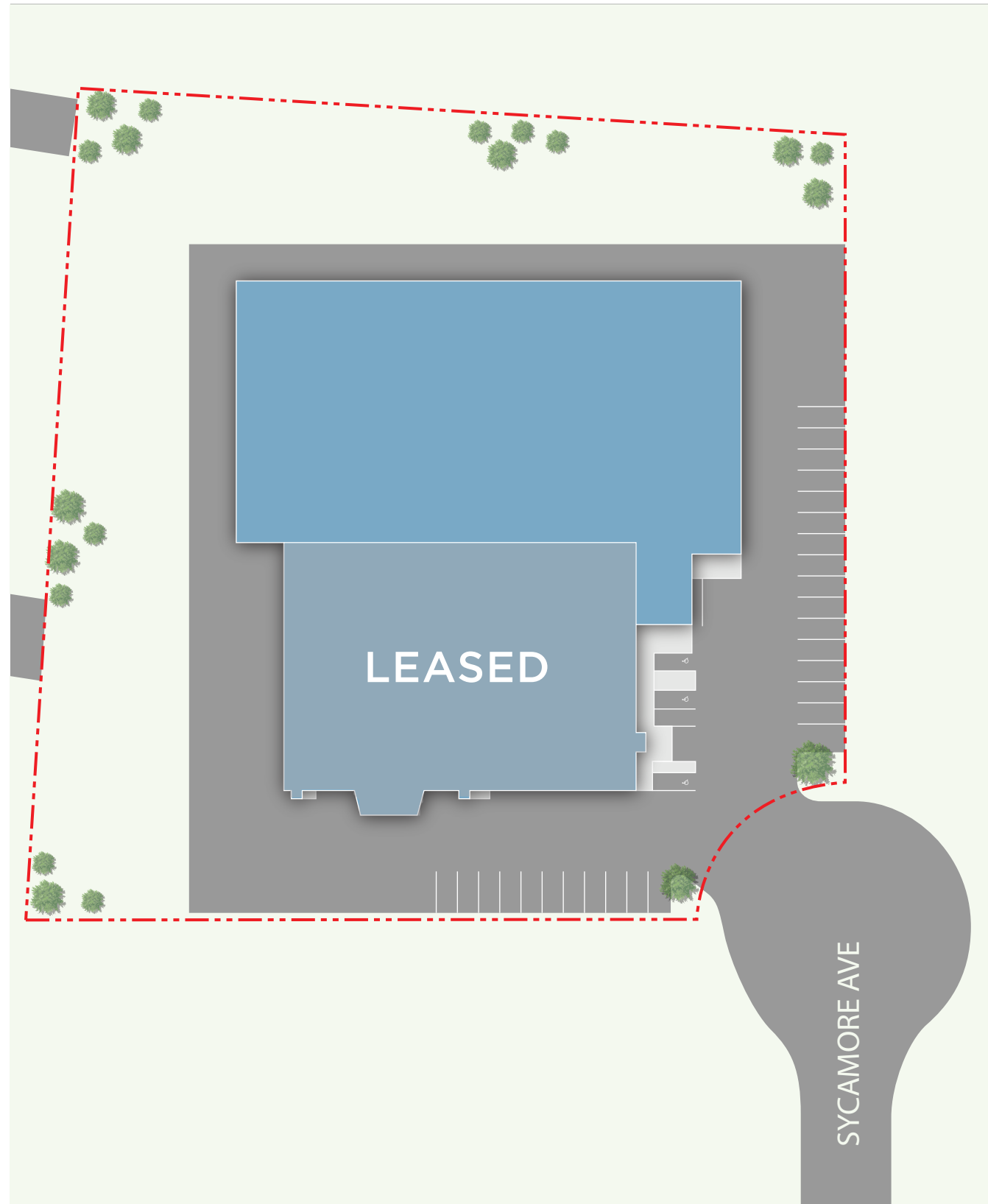

# Floor Plan:

## 1ST FLOOR

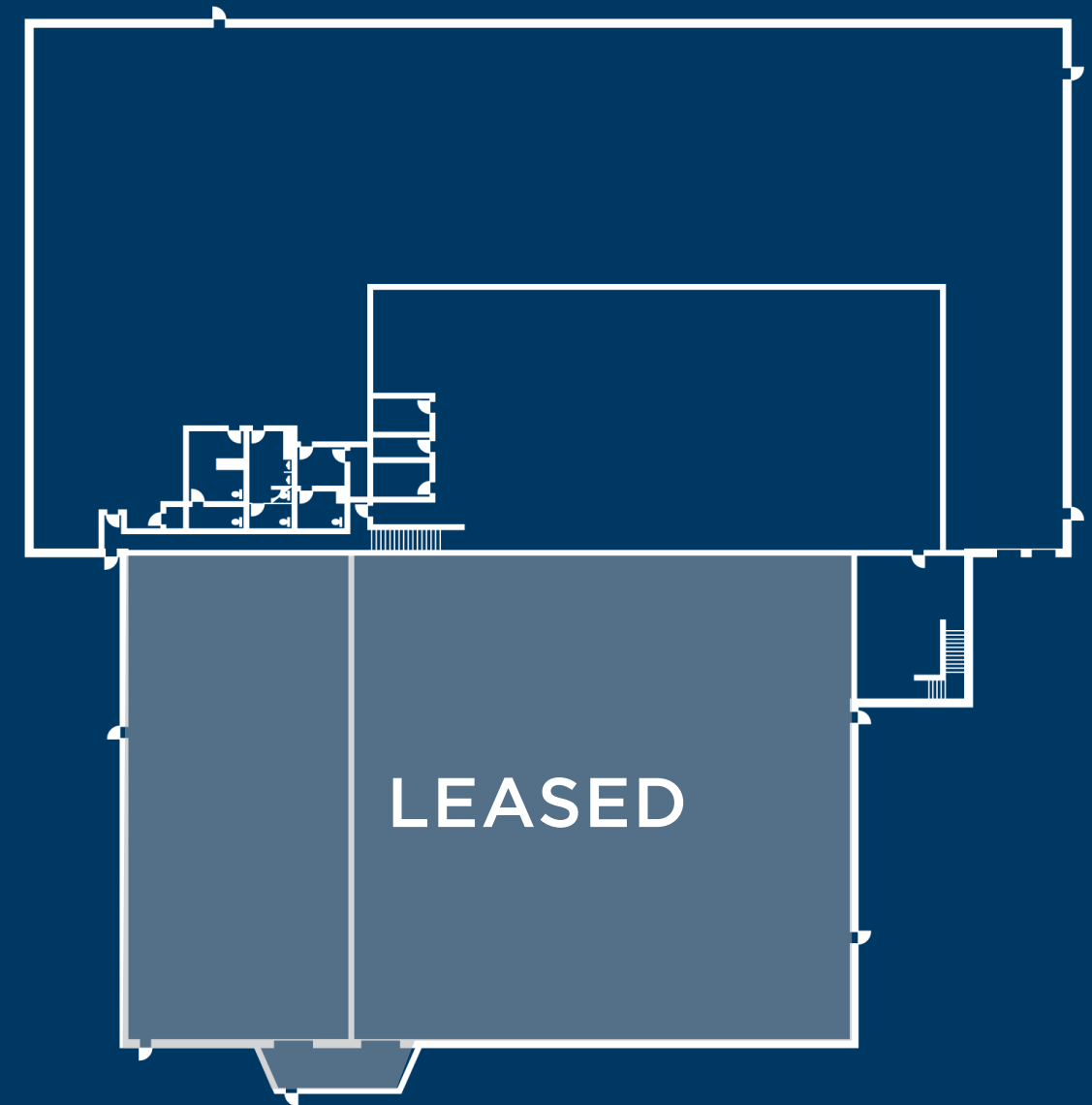

## MEZZANINE





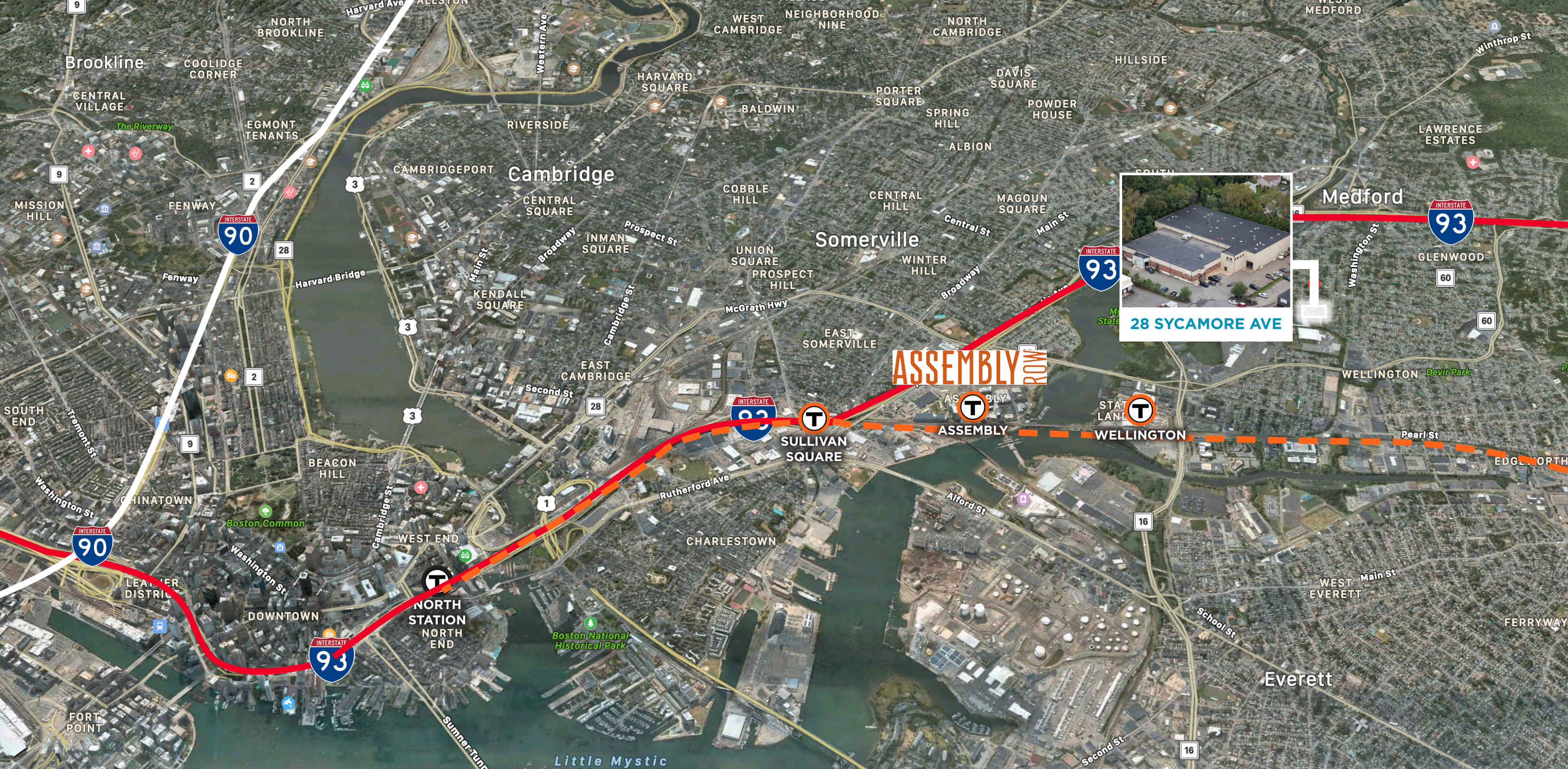

Access:

 3 Minutes

 Wellington | 7 minute walk

 13 Minutes

 Downtown Boston  
10 Minutes

 Logan Airport  
15 Minutes

Nearby Amenities:





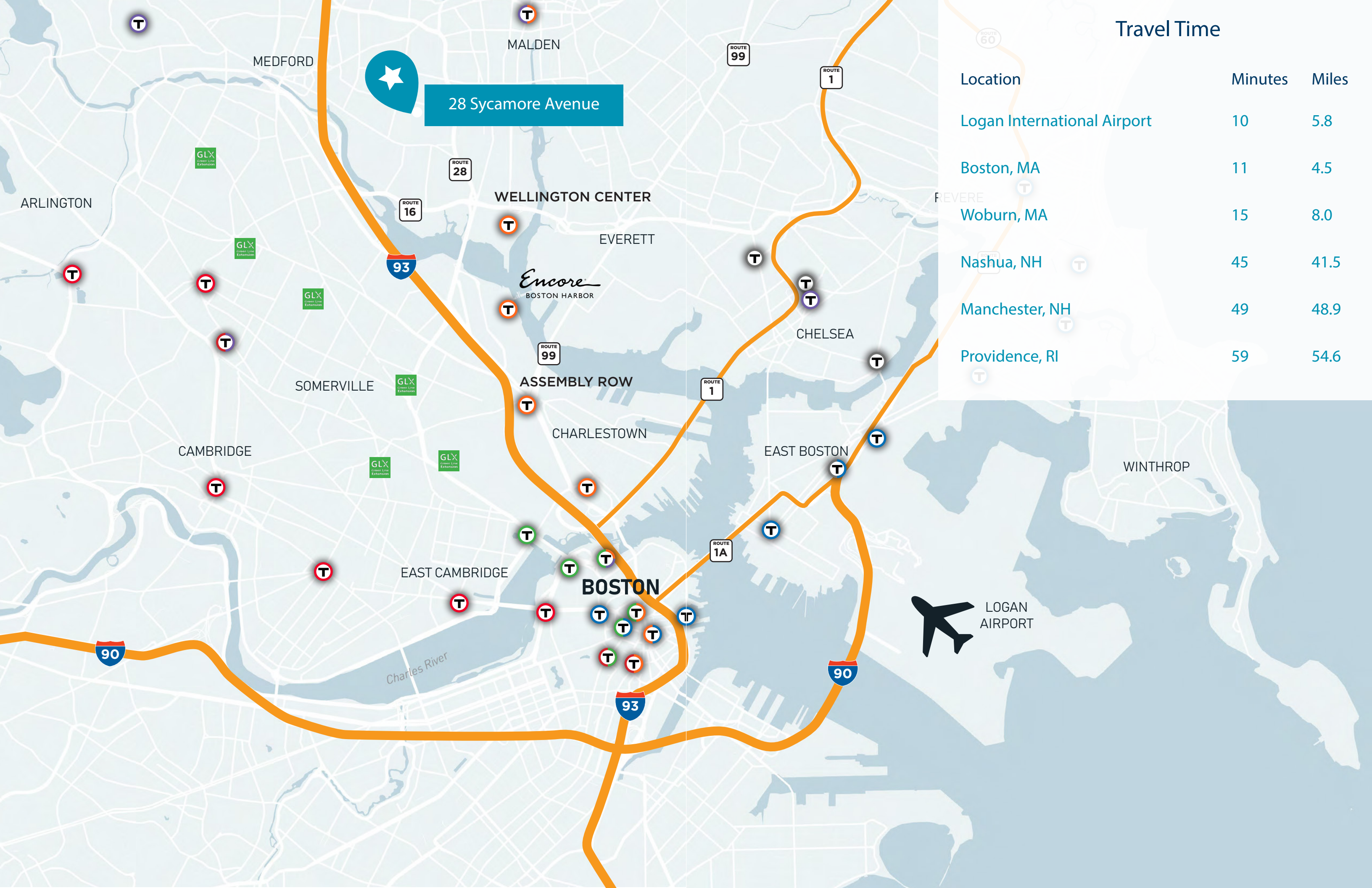

28 Sycamore Avenue

Travel Time

Location	Minutes	Miles
Logan International Airport	10	5.8
Boston, MA	11	4.5
Woburn, MA	15	8.0
Nashua, NH	45	41.5
Manchester, NH	49	48.9
Providence, RI	59	54.6





# 28 Sycamore Avenue

Medford, MA

---

## CONTACTS:

**Scott Gredler**  
scott.gredler@cushwake.com  
+1 617 204 5975

**Philip Verre**  
philip.verre@cushwake.com  
+1 617 204 4124

**Jim Murphy**  
jim.murphy@cushwake.com  
+1 617 204 4168