

BARTON ROAD

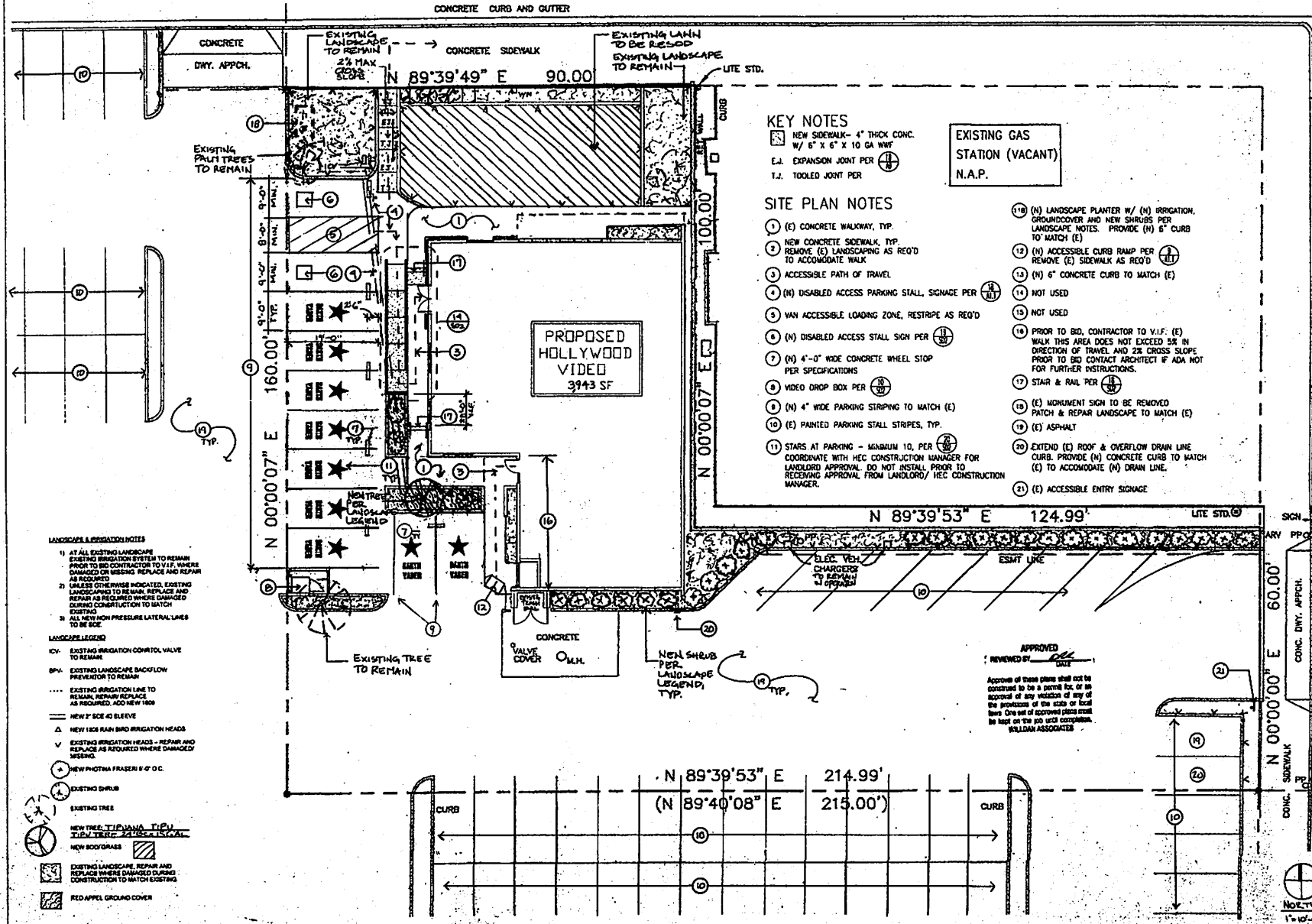

KEY NOTES

- NEW SIDEWALK - 4" THICK CONC. W/ 6" X 6" X 10 GA WWF
- E.J. EXPANSION JOINT PER $\frac{1}{8}$
- T.J. TOOLED JOINT PER $\frac{1}{8}$

EXISTING GAS STATION (VACANT) N.A.P.

SITE PLAN NOTES

- (1) (E) CONCRETE WALKWAY, TYP.
- (2) NEW CONCRETE SIDEWALK, TYP. REMOVE (E) LANDSCAPING AS REQ'D TO ACCOMMODATE WALK.
- (3) ACCESSIBLE PATH OF TRAVEL
- (4) (N) DISABLED ACCESS PARKING STALL, SIGNAGE PER $\frac{1}{8}$
- (5) VAN ACCESSIBLE LOADING ZONE, RESTRIPE AS REQ'D
- (6) (N) DISABLED ACCESS STALL SIGN PER $\frac{1}{8}$
- (7) (N) 4'-0" WIDE CONCRETE WHEEL STOP PER SPECIFICATIONS
- (8) VIDEO DROP BOX PER $\frac{1}{8}$
- (9) (N) 4" WIDE PARKING STRIPING TO MATCH (E)
- (10) (E) PAINTED PARKING STALL STRIPES, TYP.
- (11) STARS AT PARKING - MINIMUM 10, PER $\frac{1}{8}$ COORDINATE WITH HEC CONSTRUCTION MANAGER FOR LANDLORD APPROVAL. DO NOT INSTALL PRIOR TO RECEIVING APPROVAL FROM LANDLORD/ HEC CONSTRUCTION MANAGER.
- (12) (N) ACCESSIBLE CURB RAMP PER $\frac{1}{8}$ REMOVE (E) SIDEWALK AS REQ'D
- (13) (N) 6" CONCRETE CURB TO MATCH (E)
- (14) NOT USED
- (15) NOT USED
- (16) (N) LANDSCAPE PLANTER W/ (N) IRRIGATION, GROUNDCOVER AND NEW SHRUBS PER LANDSCAPE NOTES. PROVIDE (N) 6" CURB TO MATCH (E)
- (17) STAIR & RAIL PER $\frac{1}{8}$
- (18) (E) MONUMENT SIGN TO BE REMOVED PATCH & REPAIR LANDSCAPE TO MATCH (E)
- (19) (E) ASPHALT
- (20) EXTEND (E) ROOF & OVERFLOW DRAIN LINE CURB. PROVIDE (N) CONCRETE CURB TO MATCH (E) TO ACCOMMODATE (N) DRAIN LINE.
- (21) (E) ACCESSIBLE ENTRY SIGNAGE

LANDSCAPE & IRRIGATION NOTES

- 1) AT ALL EXISTING LANDSCAPE EXISTING IRRIGATION SYSTEM TO REMAIN PRIOR TO BID CONTRACTOR TO V.I.F. WHERE DAMAGED OR MISSING, REPLACE AND REPAIR AS REQUIRED
- 2) UNLESS OTHERWISE INDICATED, EXISTING LANDSCAPING TO REMAIN, REPLACE AND REPAIR AS REQUIRED WHERE DAMAGED DURING CONSTRUCTION TO MATCH EXISTING
- 3) ALL NEW NON PRESSURE LATERAL LINES TO BE SOE

LANDSCAPE LEGEND

- EXISTING IRRIGATION CONTROL VALVE TO REMAIN
- EXISTING LANDSCAPE BACKFLOW PREVENTOR TO REMAIN
- EXISTING IRRIGATION LINE TO REMAIN, REPAIR/REPLACE AS REQUIRED, ADD NEW 1808
- NEW 2" SOE 40 BLEEVE
- NEW 1808 RAIN BIRD IRRIGATION HEADS
- EXISTING IRRIGATION HEADS - REPAIR AND REPLACE AS REQUIRED WHERE DAMAGED OR MISSING
- NEW PHOTIA FRASER 8" O.C.
- EXISTING SHRUB
- EXISTING TREE
- NEW TREE, TIP MANA TIP, TYP. TREE, TIP MANA TIP, TYP.
- NEW BODIFORS
- EXISTING LANDSCAPE REPAIR AND REPLACE WHERE DAMAGED DURING CONSTRUCTION TO MATCH EXISTING
- RED APPLE GROUND COVER

APPROVED
REVIEWED BY: [Signature]
DATE: [Date]
Approval of these plans shall not be construed to be a permit for, or an approval of any violation of any of the provisions of the state or local laws. One set of approved plans must be kept on the job until completion. WILLIAM ASSOCIATES

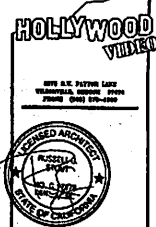

REVISIONS:
DRAWN: [Name]
CHECKED: [Name]
DATE: [Date]
PROJECT NO. [Number]
GRAND TERRACE
22-471 BARTON RD.
GRAND TERRACE, CA 92324
STORE # 00

SHEET TITLE
SITE PLAN
SD1