

An aerial photograph of an industrial district in Santa Ana, California. The image shows several large, single-story industrial buildings with flat roofs, some of which have solar panels installed. There are numerous parking lots filled with cars and trucks. A street labeled 'E WAKEHAM AVENUE' runs horizontally across the middle of the image. A specific building, located at 1131 East Wakeham Avenue, is highlighted with a red outline. The surrounding area includes other commercial buildings, parking areas, and some greenery.

FOR SUBLEASE

Freestanding Industrial Building with Private Yard

1131 East Wakeham Avenue | Santa Ana, CA



Freestanding Industrial Building with Private Yard

1131 East Wakeham Avenue | Santa Ana, CA



FOR SUBLEASE

±15,480 SF

Building Size

1,700 SF

Office Size

1987

Year Built

Contact Broker

Rental Rate

PROPERTY HIGHLIGHTS

Available SF	±15,480
Office SF	1,700
Clear Height	±18'
Grade Level	3
Exterior Truckwell	1
Power	600A
Year Built	1978
Access	I-5 and Highway 55
Parcel	#011-262-37

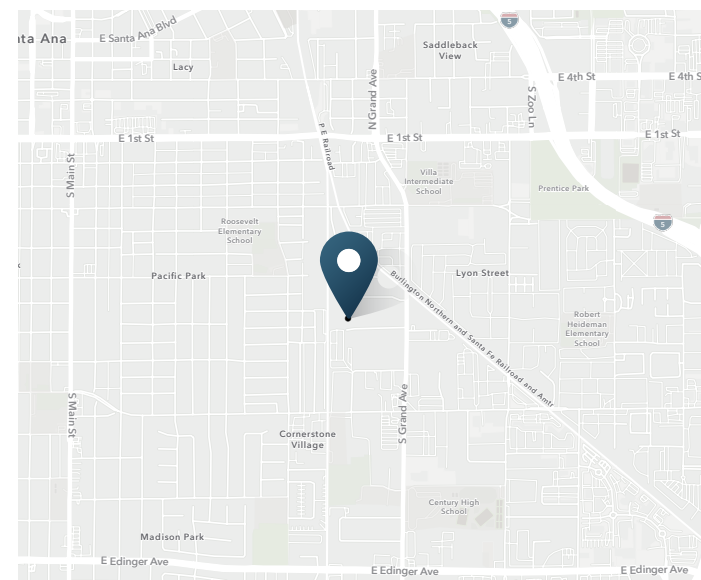

Freestanding Industrial Building with Private Yard

1131 East Wakeham Avenue | Santa Ana, CA



SITE PLAN

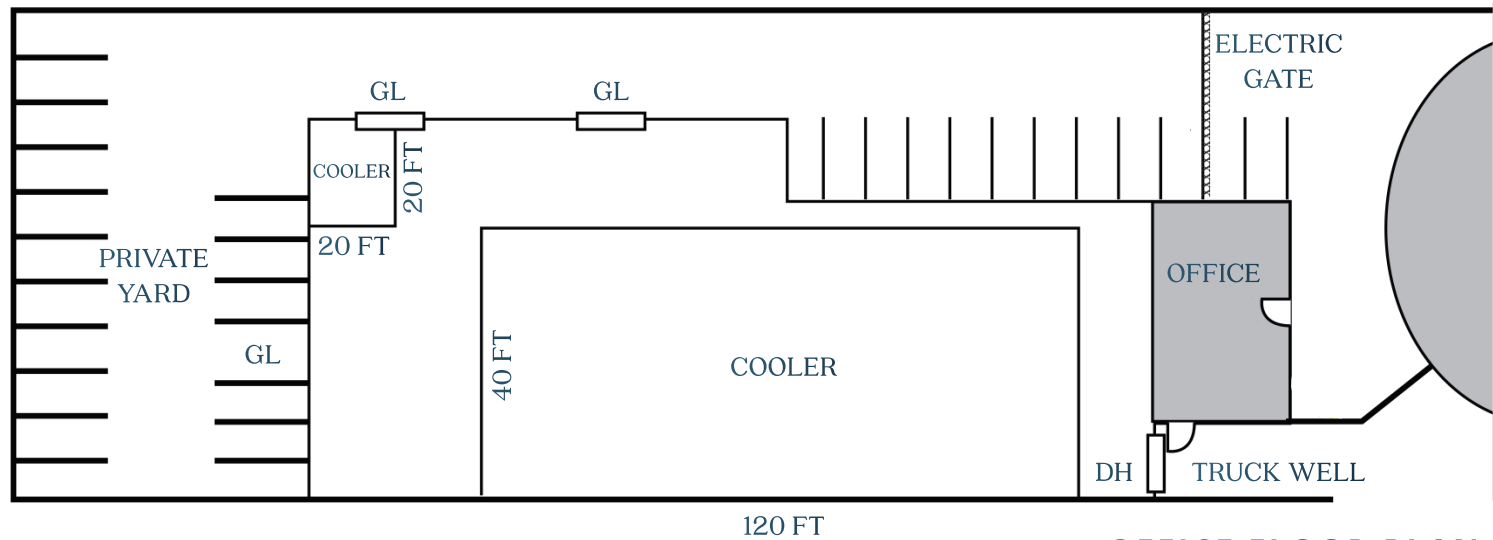

OFFICE FLOOR PLAN

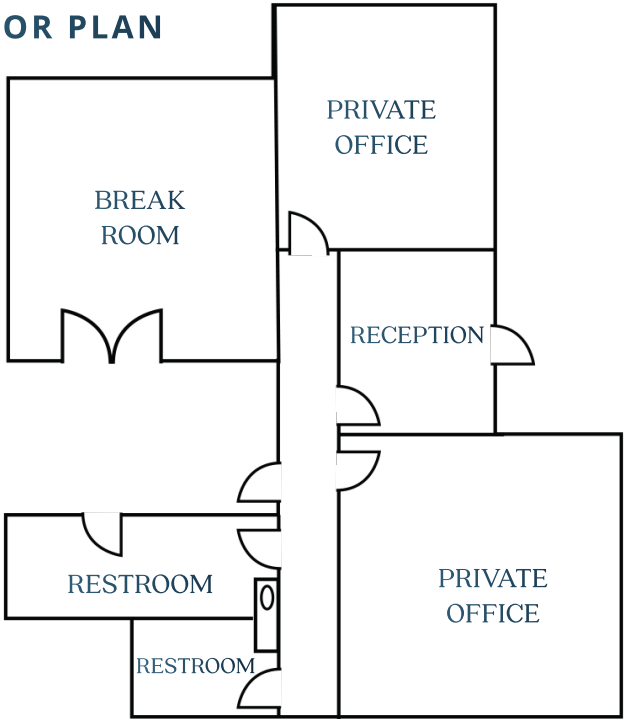

Freestanding Industrial Building with Private Yard

1131 East Wakeham Avenue | Santa Ana, CA

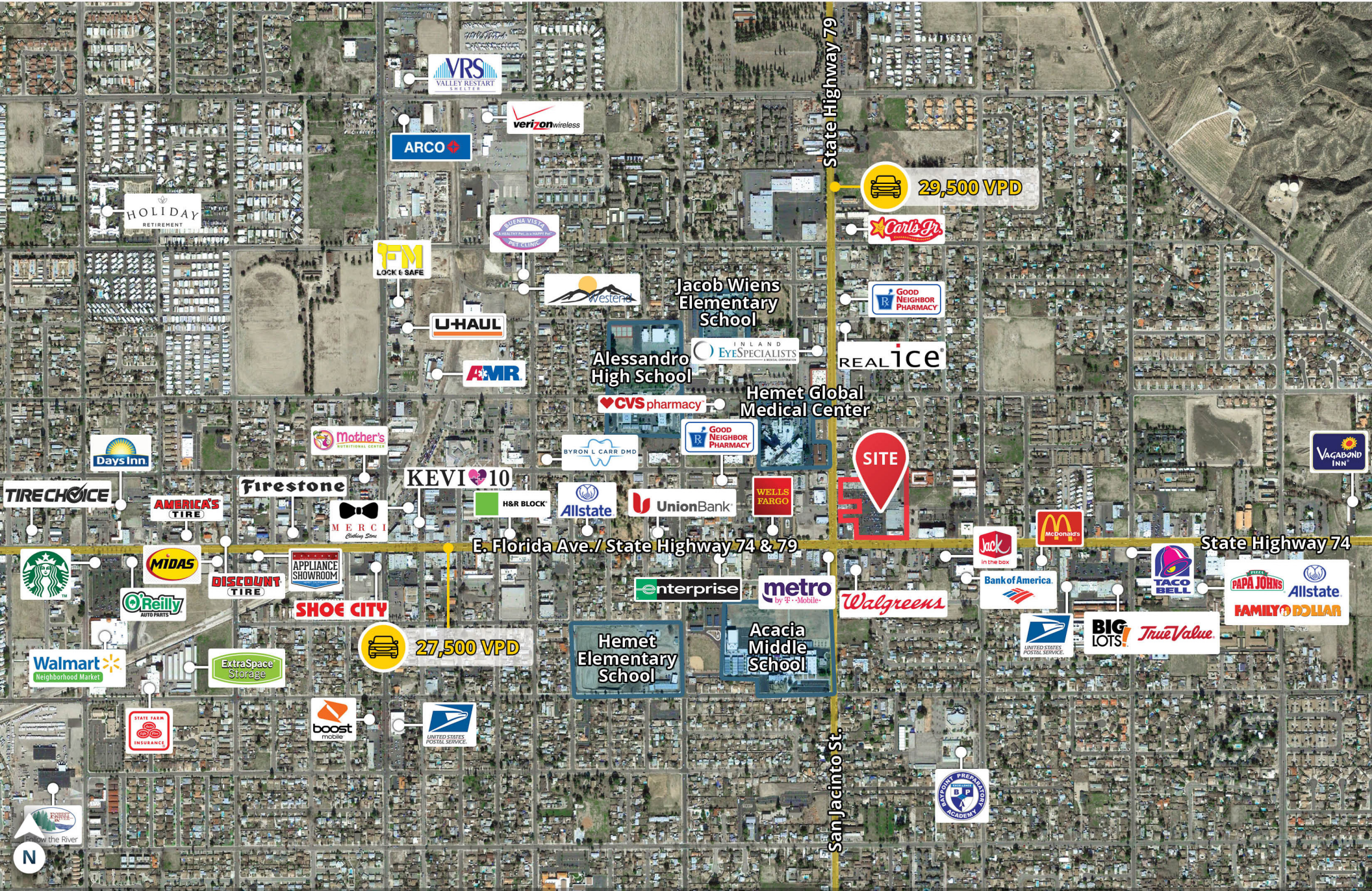

Freestanding Industrial Building with Private Yard

1131 East Wakeham Avenue | Santa Ana, CA



DEMOGRAPHIC HIGHLIGHTS

Population

	1 Mile	3 Miles	5 Miles
2025 Estimated Population	48,292	286,758	674,027
2030 Projected Population	49,792	289,591	683,277
Proj. Annual Growth 2025 to 2030	0.61%	0.20%	0.27%

Daytime Population

2025 Daytime Population	42,233	293,209	781,271
Workers	17,170	152,325	459,140
Residents	25,063	140,884	322,131

Income

2025 Est. Average Household Income	\$94,792	\$122,069	\$135,008
2025 Est. Median Household Income	\$75,011	\$94,702	\$104,141

Households & Growth

2025 Estimated Households	12,344	80,594	210,916
2030 Estimated Households	13,033	83,653	219,962
Proj. Annual Growth 2025 to 2030	1.09%	0.75%	0.84%

Race & Ethnicity

2025 Est. White	14%	23%	28%
2025 Est. Black or African American	1%	1%	2%
2025 Est. Asian or Pacific Islander	4%	9%	21%
2025 Est. American Indian or Native Alaskan	4%	3%	2%
2025 Est. Other Races	77%	63%	48%
2025 Est. Hispanic (Any Race)	90%	74%	54%

> **Want more?** Contact us for a complete demographic, foot-traffic, and mobile data insights report.

SOURCE

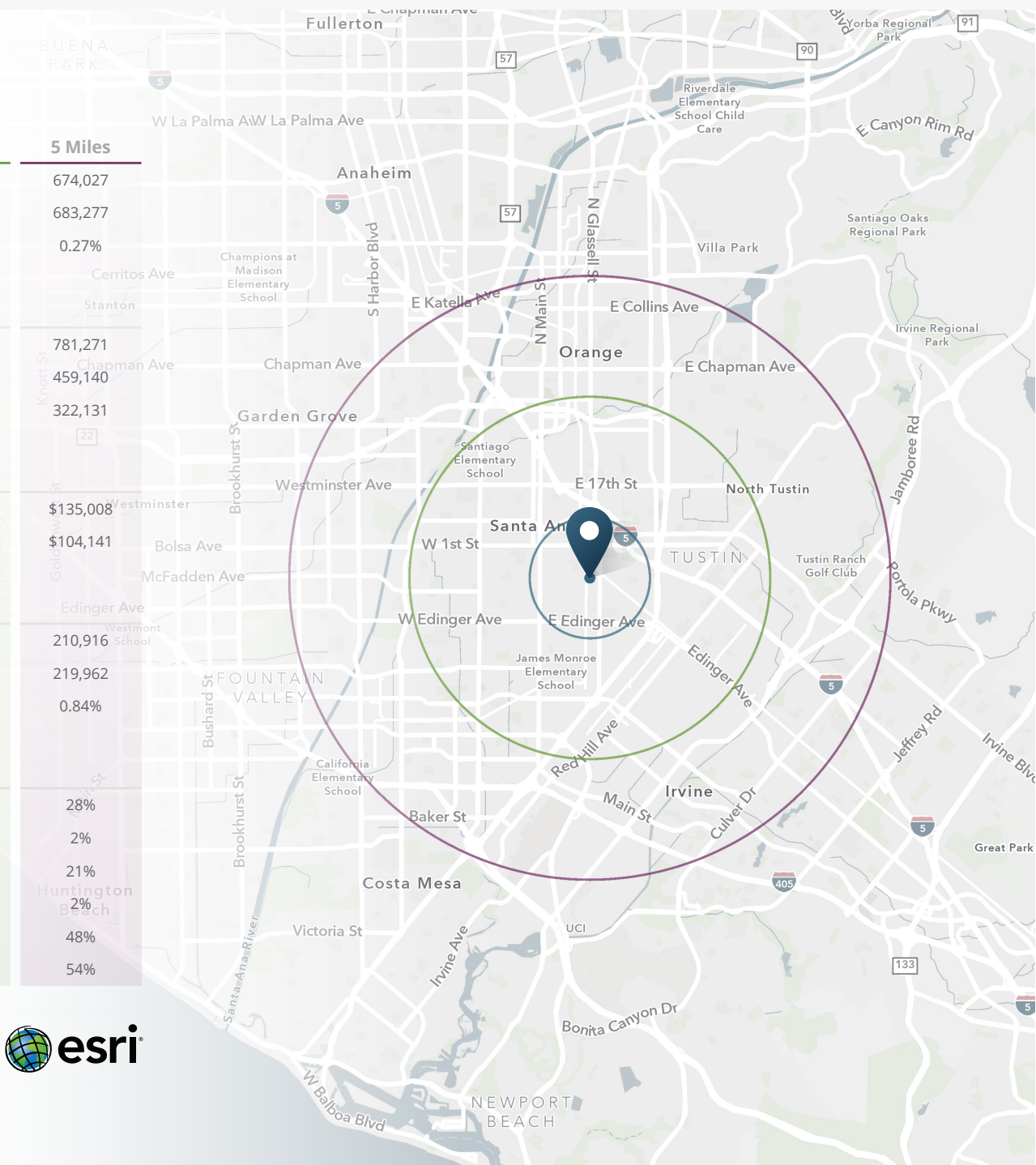



SRS Real Estate Partners
610 Newport Center Drive
Suite 1500
Newport Beach, CA 92660

Nick Krakower

714.336.8647

nick.krakower@srsre.com

CA License No. 02100512

RJ Dumke

916.799.2448

rj.dumke@srsre.com

CA License No. 02226306

SRSRE.COM/Industrial

© SRS Real Estate Partners

The information presented was obtained from sources deemed reliable;
however SRS Real Estate Partners does not guarantee its completeness or accuracy.