

AVISON
YOUNG

801

T O W E R

801 S. FIGUEROA
LOS ANGELES

Transforming
the downtown
experience
with a modern
workplace



The Elevated Workplace



GATEWAY TO SOUTH
PARK AND SPORTS
ENTERTAINMENT DISTRICT



CERTIFIED FITWELL



1.5/1,000 SECURE
ON-SITE PARKING



FREEWAY AND PUBLIC
TRANSIT ACCESS



12 CORNER OFFICES
PER FLOOR



801 Tower and the immediate South
Park neighborhood are redefining
“workforce well-being” and
drawing businesses and residents
from around the City and County

801 Accolades

Standing out among its peers with unrivaled excellence in DTLA



Award for Leadership in Sustainability – 2021
Water Sustainable Innovation Award Winner – 2021



Earth Sustainability Award Winner – 2021
Real Estate Manager of the Year Award Winner – 2021



FITWEL Built Certification – 2021
FITWEL Viral Response Certification – 2021



Southwest Region - Building of the Year Winner - 2020
International - Building of the Year Finalist - 2020

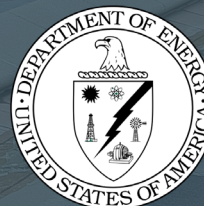

LA Better Building Challenge, Water Performance Winner – 2021
LA Better Building Challenge, Energy Performance Finalist – 2021

801

T O W E R

801 S. FIGUEROA

LOS ANGELES

Courtyard





EXPLORE THE SPEC-SUITE
EXPERIENCE AT 801 TOWER

Highest quality finish and design, ready-to-occupy space



It's All About "Workforce Well-Being"

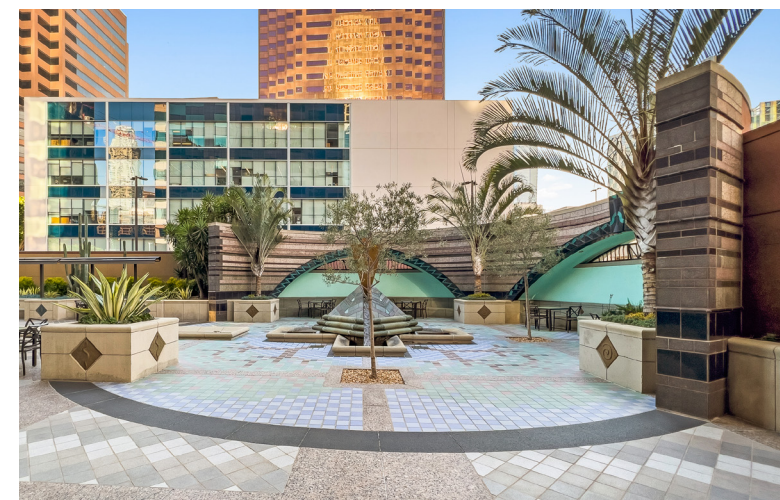
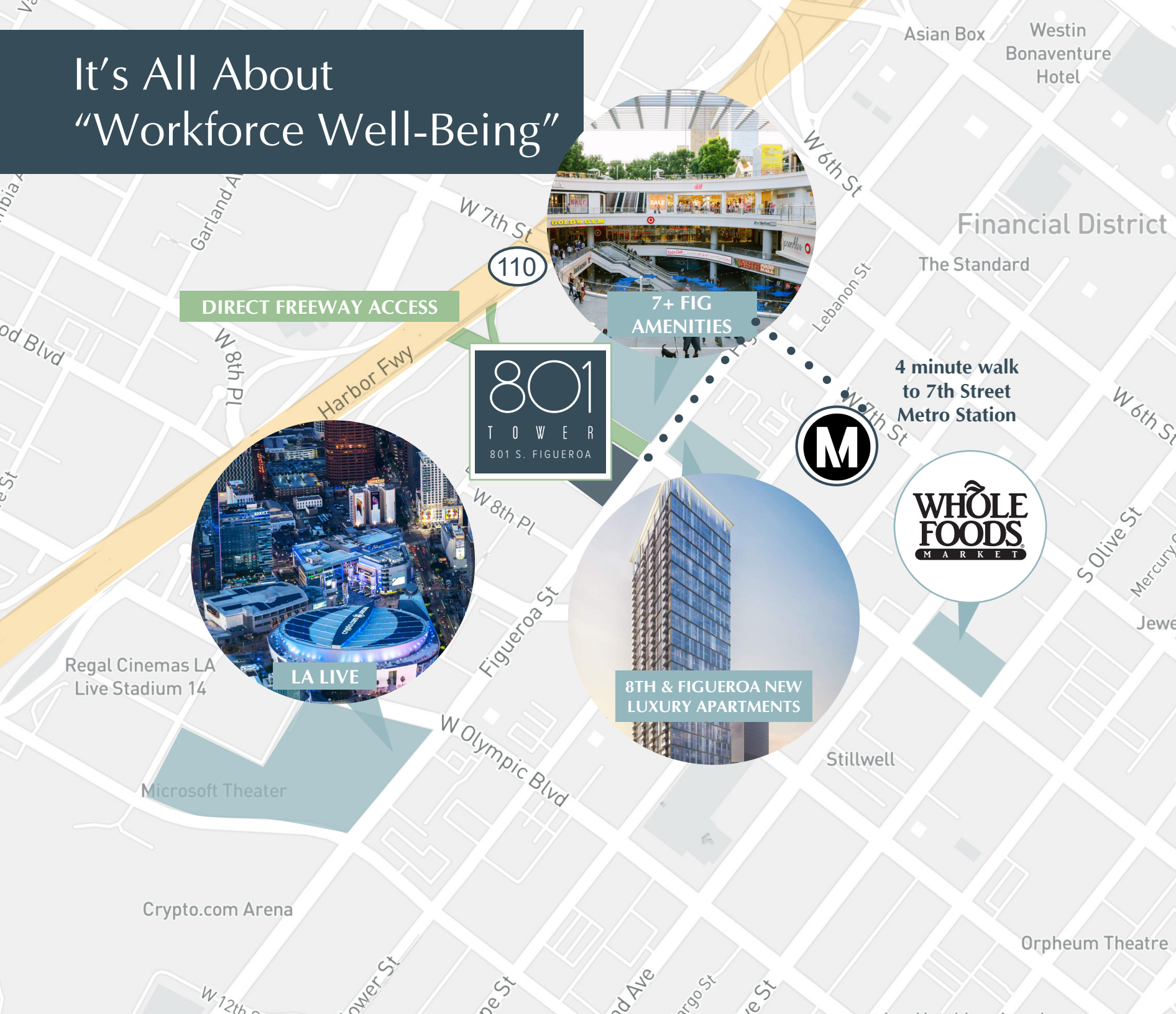

801

T O W E R

801 S. FIGUEROA
LOS ANGELES

John Eichler

Principal

john.eichler@avisonyoung.com

213 471 8718

CalDRE #868881

Tyler Stark

Senior Vice President

tyler.stark@avisonyoung.com

213 471 8717

CalDRE #01941054



AVISON
YOUNG