



**FOR LEASE**

**92 Talamine Court  
Colorado Springs, CO 80907**

**PROPERTY SPECIFICATIONS**

	<b>LOCATION:</b>	92 Talamine Court Colorado Springs, CO 80907
	<b>AVAILABLE SIZE:</b>	± 1,500 SF
	<b>LEASE RATE</b>	\$13.50 NNN
	<b>NNN</b>	\$4.30
	<b>CEILING CLEARANCE:</b>	± 18'
	<b>LOADING:</b>	Drive In Door
	<b>POWER:</b>	3 Phase
	<b>ZONING:</b>	M1

**MAP**

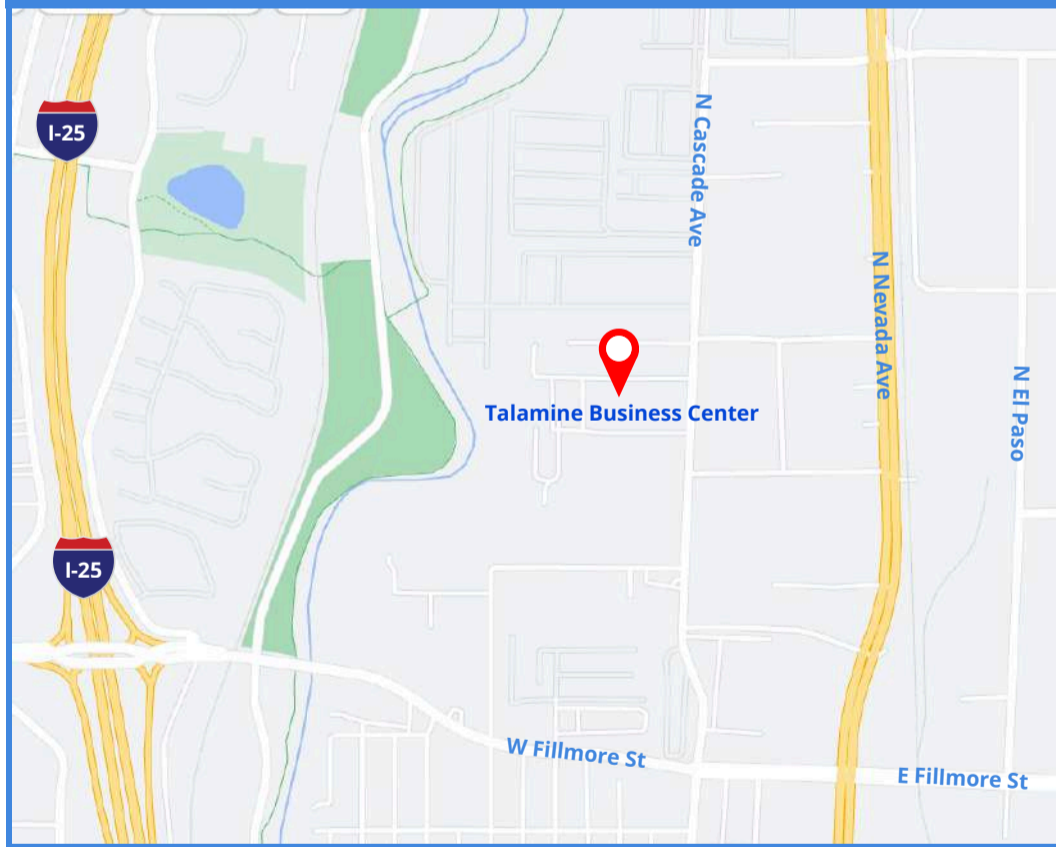

**Additional Features:**

- I 25 is easily accessible from property via Fillmore, Garden of the Gods or Nevada

**JASON CASTRO**  
Broker



jason@peakcp.net  
719.227.9987

## FLOOR PLAN

### AS IS

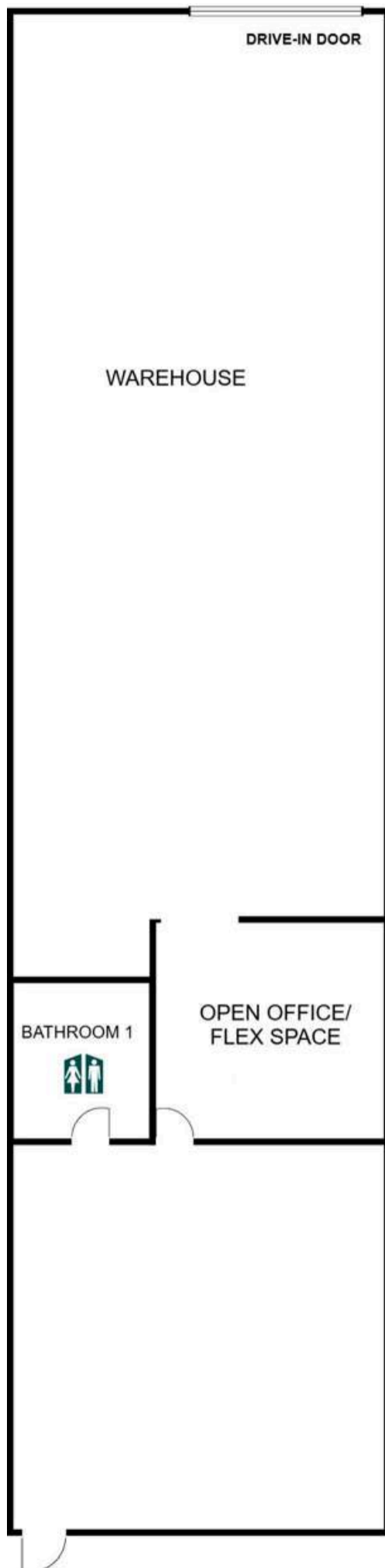

### CONCEPT

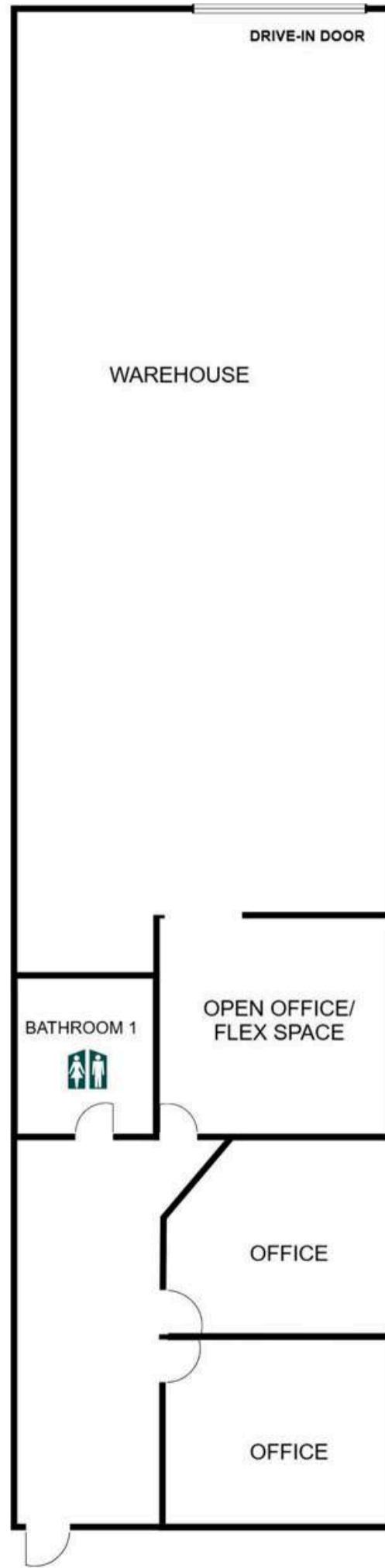

The particulars, details and visuals shown herein are intended to give a general idea of the property. As such, they are not to be relied upon as statements of fact