

PROPERTY MAP - PASCO COUNTY, FLORIDA

6203 SPRINGER DRIVE

PORT RICHEY, FL 34668 · LOT 4, BLOCK B, PORT RICHEY ACRES UNIT 2 · S28-T255-R16E

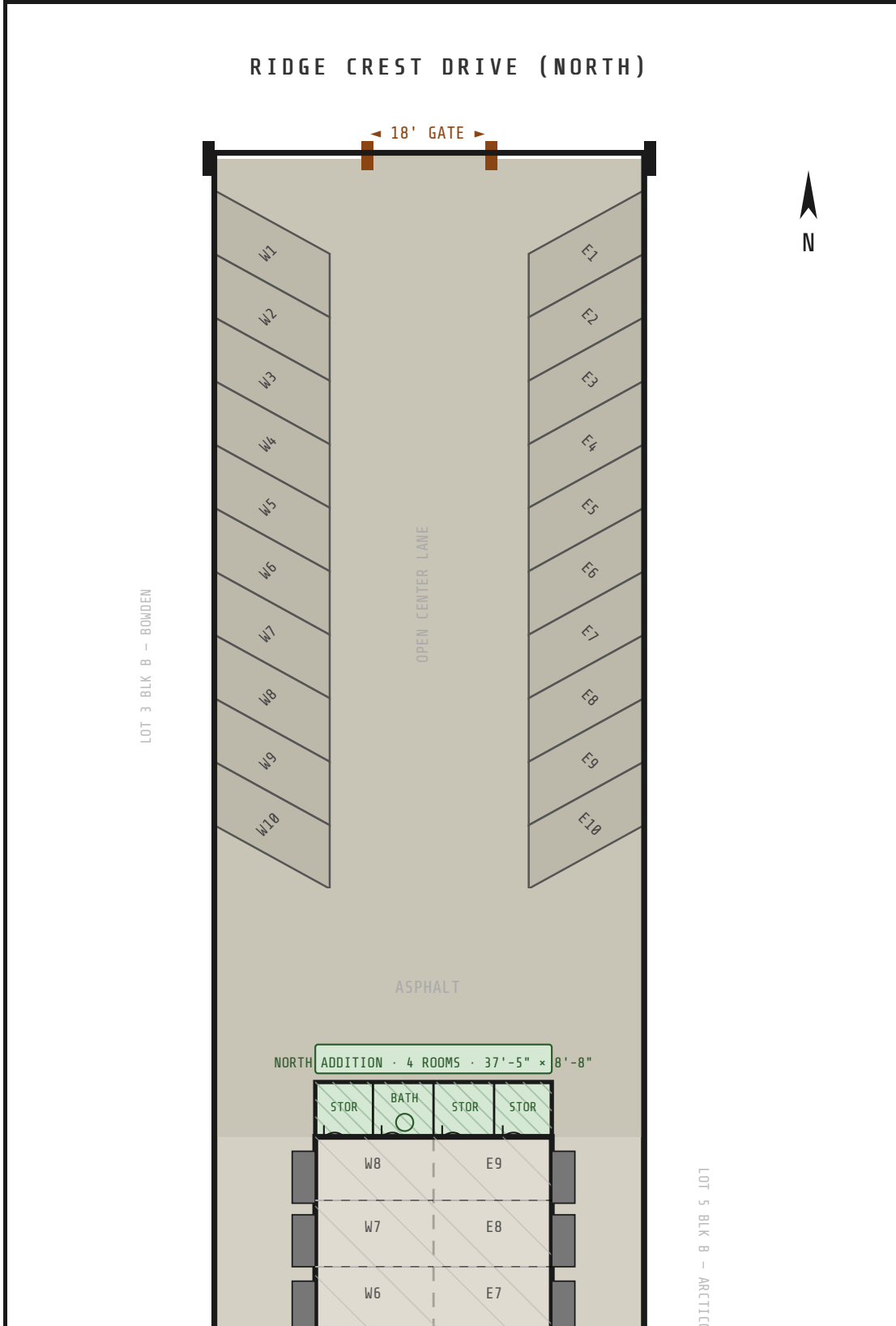

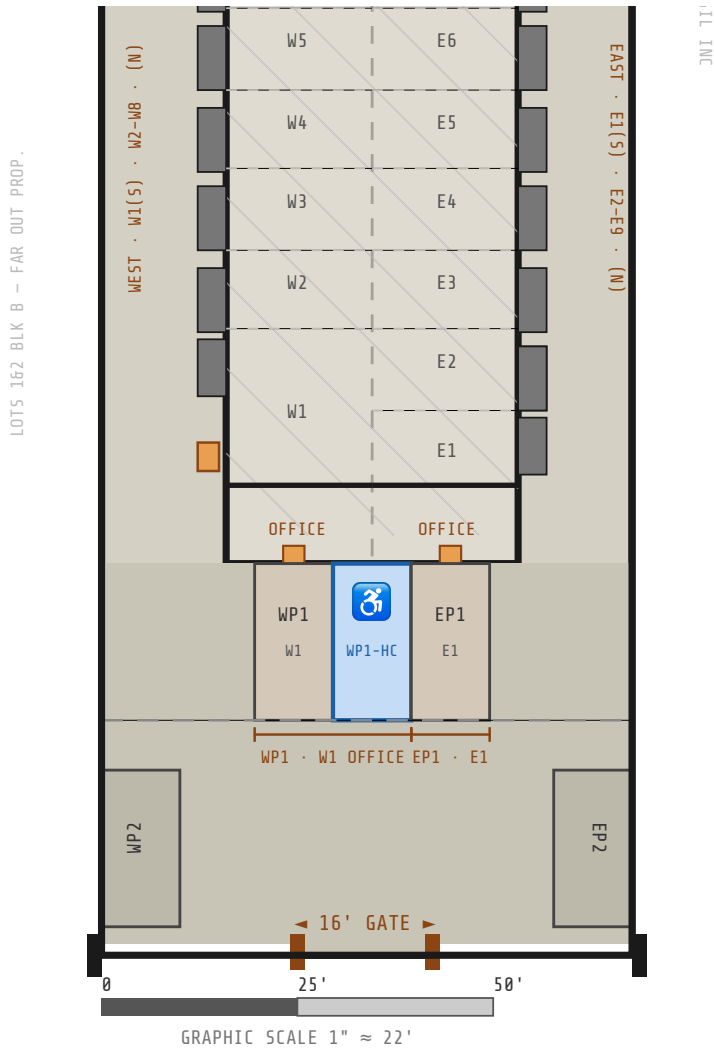

SPRINGER DRIVE (SOUTH)

50' R/W - PUBLIC

PARCEL DEPTH: 306.45' (P) / 303.72' (M)

BLDG WIDTH: 37.4' (E-W)

BLDG AREA: ±3,914 SF · 1 STORY · ±16.4'

E SETBACK: 14.6'

SOUTH APRON: 49.8'

WEST UNITS: W1(OFF+2GAR) · W2 · W3 · W4 · W5 · W6 · W7 · W8

NORTH GATE: 18' - RIDGE CREST DR

SOUTH GATE: 16' - SPRINGER DR

TRUCK STALLS: PT-SW + PT-SE PARALLEL (10×20)

ADDITION ROOMS: STORAGE (×3) + BATHROOM

PARCEL WIDTH: 67.8'

BLDG LENGTH: 101.5' (N-S)

W SETBACK: 15.8'

NORTH LOT: 155.15'

TOTAL UNITS: 17 LEASABLE

EAST UNITS: E1(OFF+GAR) · E2 · E3 · E4 · E5 · E6 · E7 · E8 · E9

NORTH STALLS: 20 ANGLED 45° (W1-W10 + E1-E10) · 10×18

SOUTH STALLS: 4 DEDICATED · W1(×2 incl HC) · E1(×2)

NORTH ADDITION: 4 ROOMS · 37'-5" × 8'-8" · 13' HT