

TEAM CONDON

alexa • amara • brittany • erica
kylie • mike • michael • pete
reid • scott • whitney • zoe

6600

BANDINI BOULEVARD

COMMERCE, CALIFORNIA

6600

SUNSCOPE

SUNSCOPE

FOR LEASE

±64,231 Sq. Ft. of Class A Distribution Facility

Lease Rate: \$1.53 IG | Available: May 1, 2026

 CUSHMAN &
WAKEFIELD

6600 BANDINI BOULEVARD

FOR LEASE

PROPERTY OVERVIEW

Address:	6600 Bandini Boulevard, Commerce, CA 90040
Building Size:	±64,231 SF
Land Size:	±108,658 SF (±2.5 Acres)
Office Size:	±4,926 SF
Parking:	±58 Stalls
Clear Height:	28'-32'
Loading:	6 Dock High Doors; 1 Ground Level Door
Truck Court Depth:	120'
Building Features:	<ul style="list-style-type: none">• M2 Zoning• 400a/270 - 480v 3p 4w• Fenced lot

PROPERTY HIGHLIGHTS

- Freestanding Building
- Renovated Offices
- Racking Available
- ESFR in place
- 6 DH Positions w/ Dock Levelers
- 7 Dedicated Truck Parking Spaces On-Site
- 2 Universal Electric Vehicle Charging Stations
- Close proximity to the 5 and 710 freeways, Downtown Los Angeles, and the ports of Los Angeles & Long Beach



6600 BANDINI BOULEVARD

FOR LEASE

PROPERTY PHOTOS



6600 BANDINI BOULEVARD

FOR LEASE

SITE PLAN

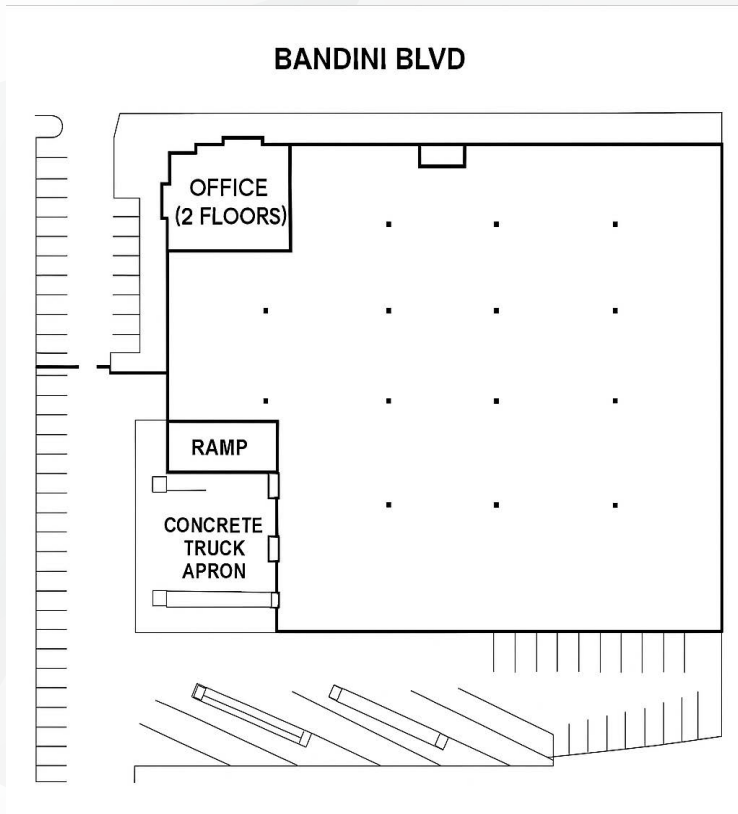

RACKING PLAN

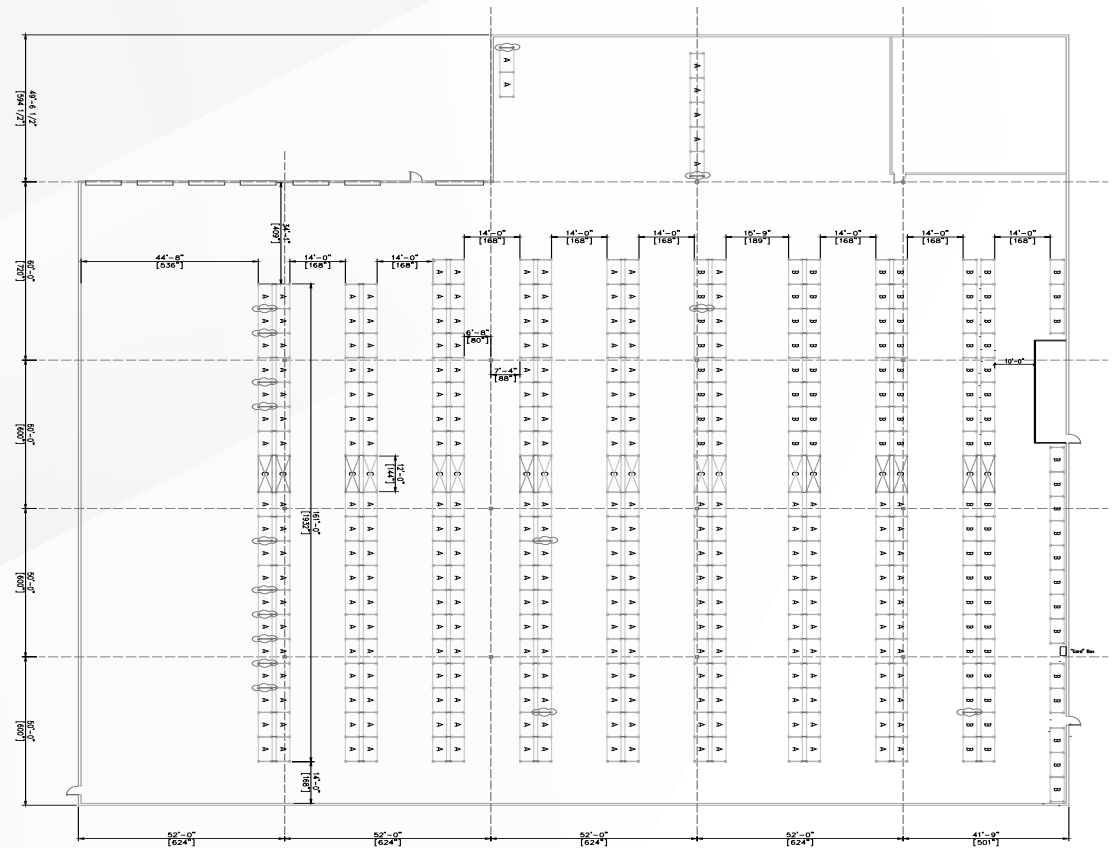

LOCATION

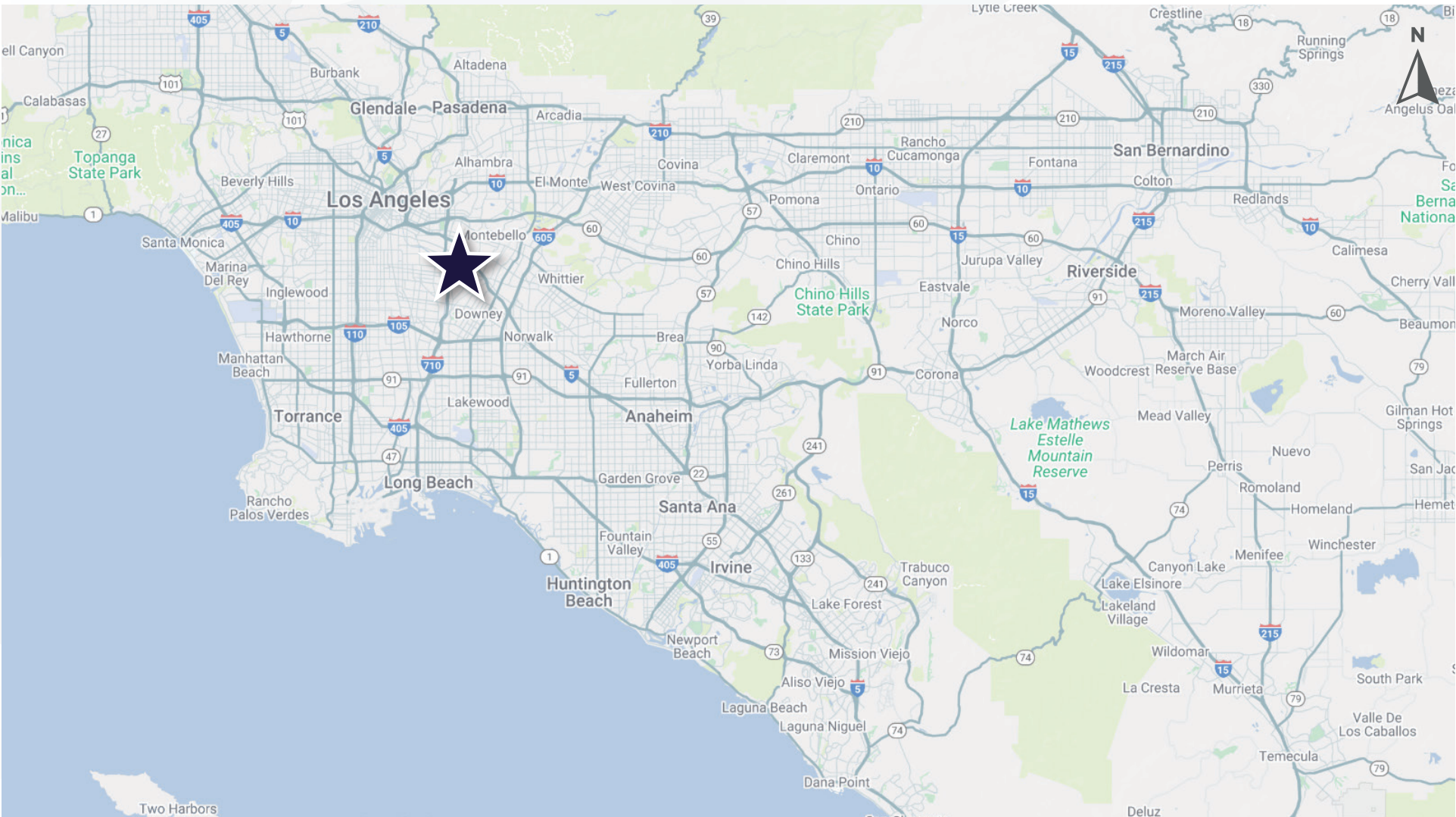

TEAM CONDON

alexa • amara • brittany • erica
kylie • mike • michael • pete
reid • scott • whitney • zoe



Exclusive Agents

Mike Condon, Jr.

CA Lic. #01884476

mike.condon@cushwake.com

+1 213 629 7379

Tim Wallace

CA Lic. #01779950

tim.wallace@cushwake.com

+1 213 955 5108

Kylie Rawn

CA Lic. #02196566

kylie.rawn@cushwake.com

+1 213 629 6518

David Schatz

CA Lic. #02060440

david.schatz@cushwake.com

+1 310 943 4201

Cushman & Wakefield

900 Wilshire Boulevard

Suite 2400

Los Angeles, CA 90017

cushmanwakefield.com

©2025 Cushman & Wakefield. All rights reserved. The information contained in this communication is strictly confidential. This information has been obtained from sources believed to be reliable but has not been verified. No warranty or representation, express or implied, is made as to the condition of the property (or properties) referenced herein or as to the accuracy or completeness of the information contained herein, and same is submitted subject to errors, omissions, change of price, rental or other conditions, withdrawal without notice, and to any special listing conditions imposed by the property owner(s). Any projections, opinions or estimates are subject to uncertainty and do not signify current or future property performance.

