



nationwide

SOUTH JORDAN OFFICE AVAILABLE FOR LEASE

859 W. SOUTH JORDAN PARKWAY, SOUTH JORDAN 84095



PROPERTY INFORMATION

- Suite 101: 3,376 RSF Available
- Suite 103: 1,985 RSF Available
- Class B Office Space
- Tenant Improvements Available
- Janitorial Provided with Full Service Rate
- Building Signage Available
- Comcast & Century Link Available
- Ample Parking: 3.5/1,000 SF
- Desired South Jordan Location
- Adjacent to Riverpark Office & Retail Center
- Many Retail Amenities Nearby, Including Lifetime Fitness
- Immediate I-15 Access

DEMOGRAPHICS

	2 Mile	5 Mile	10 Mile
Population	39,190	316,548	857,391
Households	13,903	99,065	274,097
Avg. Household Income	\$114,520	\$109,662	\$103,066

TRAFFIC COUNTS

South Jordan Prkwy: 45,596 Annual Average Daily Traffic
 Jordan Gateway: 16,533 Annual Average Daily Traffic

LEASE RATE: \$14.00/SF NNN

CRYSTAL JOHNSON

801.617.1700

WEST HARADIN

CRYSTAL.JOHNSON@CRCNATIONWIDE.COM

WEST.HARADIN@CRCNATIONWIDE.COM



SOUTH JORDAN OFFICE AVAILABLE FOR LEASE

859 W. SOUTH JORDAN PARKWAY, SOUTH JORDAN 84095

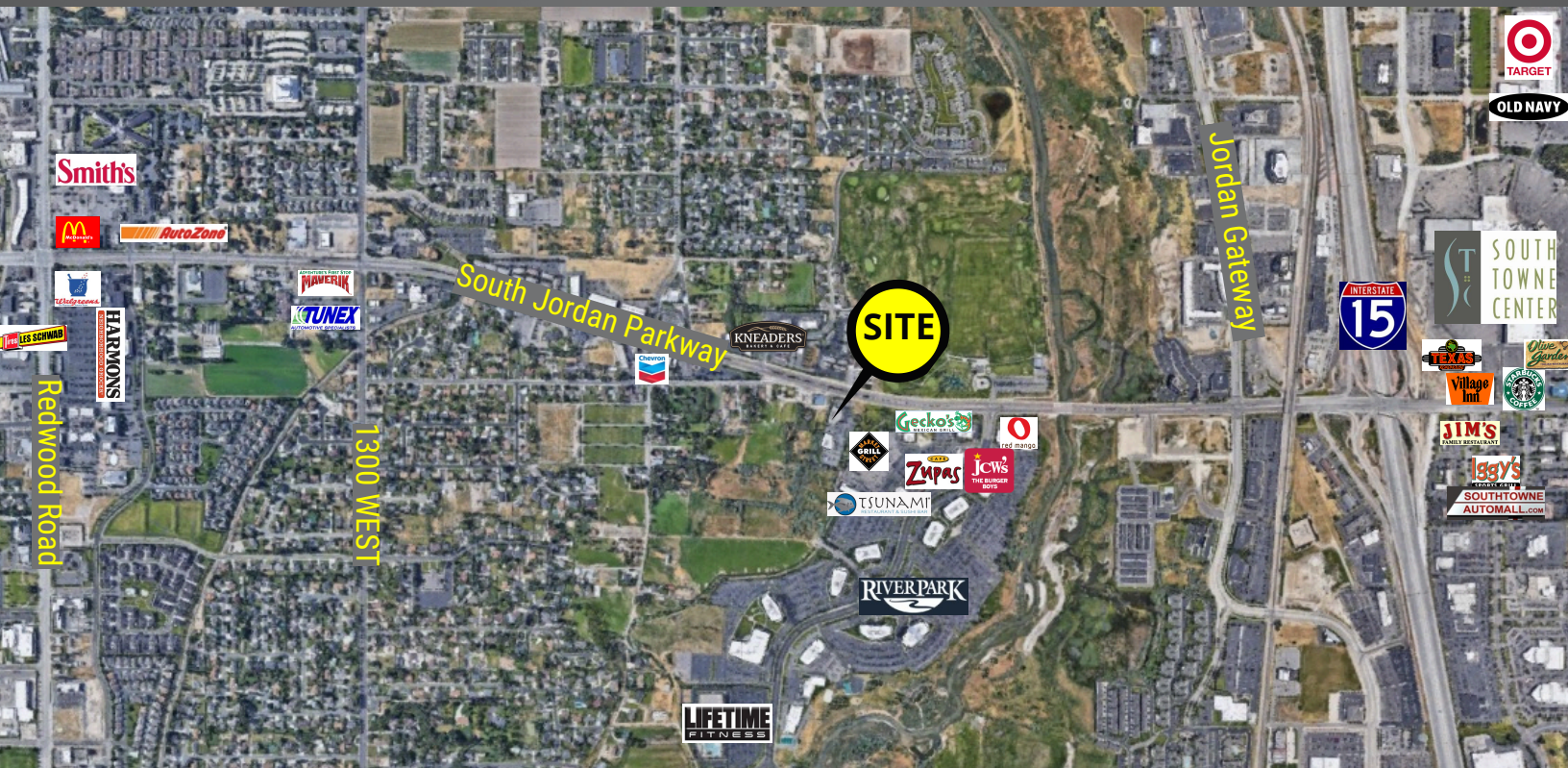
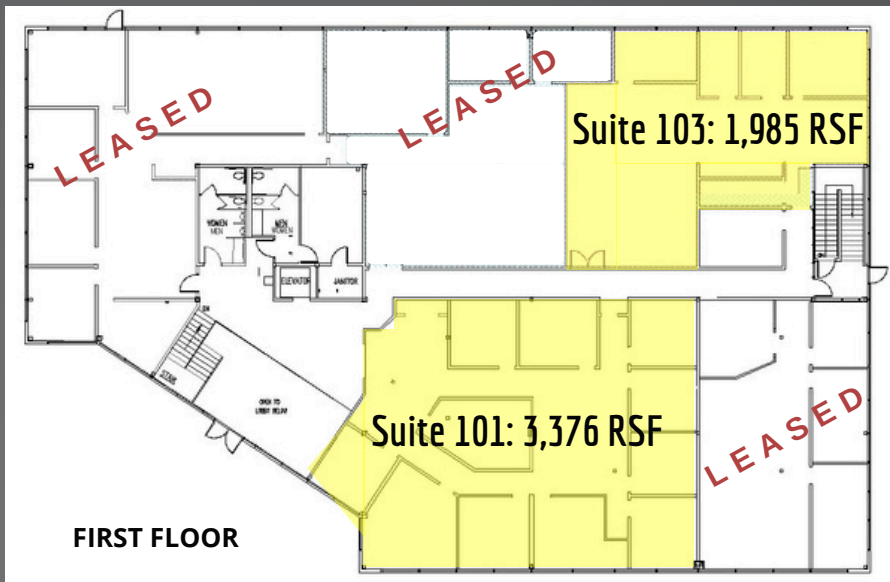

This information is given with the understanding that all negotiations and/or real estate activity related to the property described above shall be conducted through this cRc Nationwide office. The above information while not guaranteed, was obtained from sources we believe to be reliable.

CRYSTAL JOHNSON

801.617.1700

WEST HARADIN

CRYSTAL.JOHNSON@CRCNATIONWIDE.COM

WEST.HARADIN@CRCNATIONWIDE.COM