

Boasting the highest customer satisfaction in the flexible office industry, Industrious locations offer premium coworking, private offices, and conference facilities. With flexible and all-inclusive pricing, members also have access to locations in 60 markets in the U.S., the U.K., Europe and Asia.

1925

CENTURY PARK EAST
17th & 18th Floors | Los Angeles, CA 90067



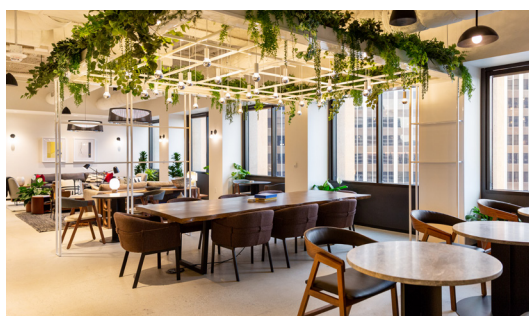

±39,762 Square Feet
13 Conference Rooms
141 Offices

Industrious Services:

- Daily breakfast and craft coffee 
- Dedicated on-site staff 
- Convenient mail services 
- Wellness Room 
- Professional conference rooms 
- Beautiful common spaces 
- Fast, Secure Wi-Fi 



Building Amenities:

-  On-Site: Dry Cleaning Service, Florist, Starbucks, convenience store and FedEx
-  Multi-million dollar lobby and amenity renovation in 2021
-  State of the art conference center
-  On-Site Parking / Valet
-  Walkable to Century City mall, the Fairmont Century Plaza hotel and the future Metro Purple Line

DAVID FREITAG
First Vice President
Lic. 01908952
+1 310 550 2690
david.freitag@cbre.com

KAYLA RIX
Associate
Lic. 02193097
+1 310 228 2113
kayla.rix@cbre.com

1925

1925 CENTURY PARK EAST
17TH AND 18TH FLOORS
Los Angeles, CA 90067

COWORKING & FLEX OFFICE

17th Floor

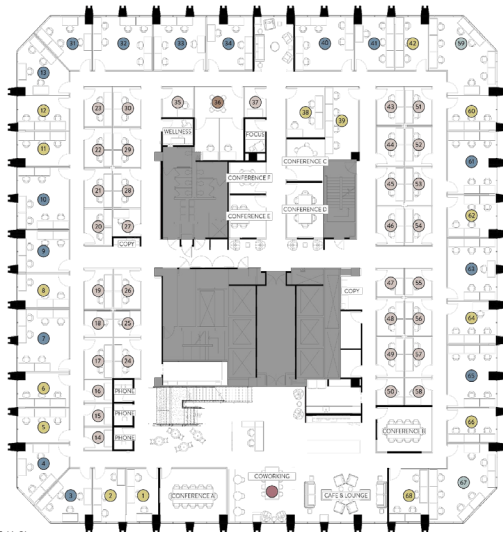

18th Floor

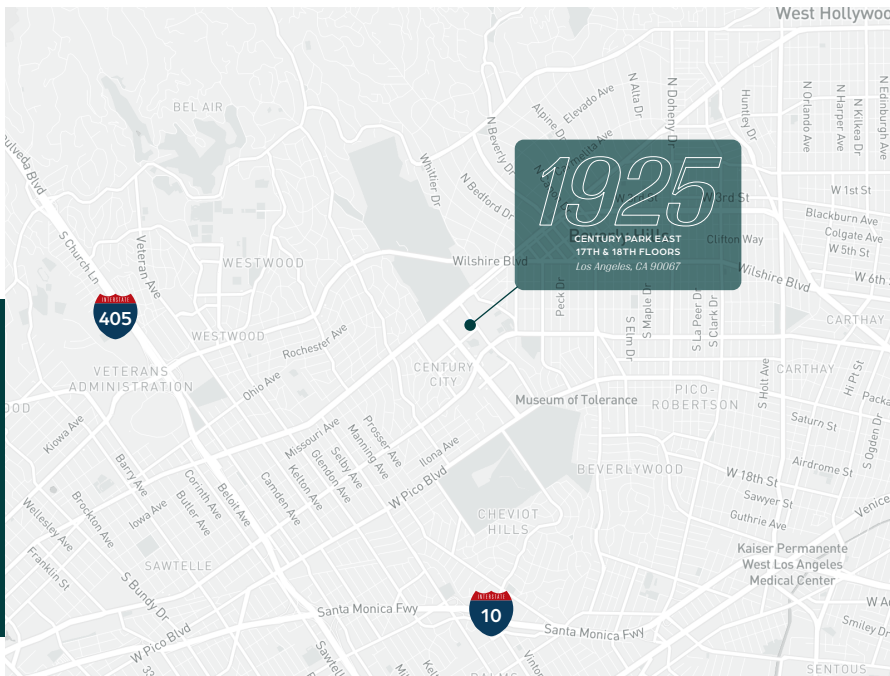
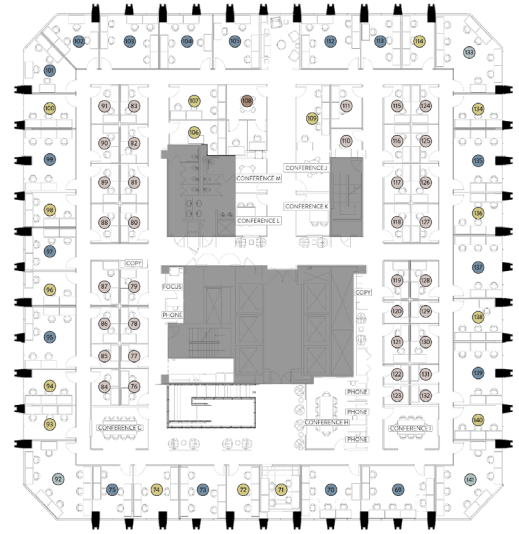

- Coworking
- Small Office (1-2)
- Medium Office (3-4)
- Large Office (5-8)
- Extra Large Office (9+)
- Executive Suite



DAVID FREITAG

First Vice President
Lic. 01908952
+1 310 550 2690
david.freitag@cbre.com

KAYLA RIX

Associate
Lic. 02193097
+1 310 228 2113
kayla.rix@cbre.com



INDUSTRIOUS

CBRE

© 2022 CBRE, Inc. All rights reserved. This information has been obtained from reliable sources but has not been verified for accuracy or completeness. CBRE, Inc. makes no guarantee, representation, or warranty and accepts no responsibility or liability for the accuracy, completeness, or reliability of the information contained herein. You should conduct a careful, independent investigation of the property and verify all information. Any reliance on this information is solely at your own risk. CBRE and the CBRE logo are service marks of CBRE, Inc. All other marks displayed on this document are the property of their respective owners, and the use of such marks does not imply any affiliation with or endorsement of CBRE. Photos herein are the property of their respective owners. Use of these images without the express written consent of the owner is prohibited.