

FOR SUBLEASE | FLEX LAB/OFFICE
450 SHERMAN AVE N
HAMILTON, ON



RATE REDUCTION

RECENTLY RENOVATED



OPPORTUNITY DETAILS

TOTAL SIZE:	5,904 SF
POTENTIAL CONFIGURATIONS:	1,771 SF 4,133 SF 5,904 SF
ZONING:	M13
CLEAR HEIGHT:	9' to drop ceiling
LOADING:	Double door access at dock height
PARKING:	Ample stalls in front of unit
LEASE RATE:	\$16.50 PSF Gross per Annum (excludes janitorial)
AVAILABILITY:	Immediate
FLEXIBLE TERM:	12 months to 10 years

- Suitable for many uses - office, lab, high tech. services, port related support services
- Recently renovated and move in condition
- Flexible lease term and variable size configurations
- Ground floor accessible space.
- Potential to increase the size by including 2nd floor space leased direct with landlord
- Options for outside storage yard space for storage

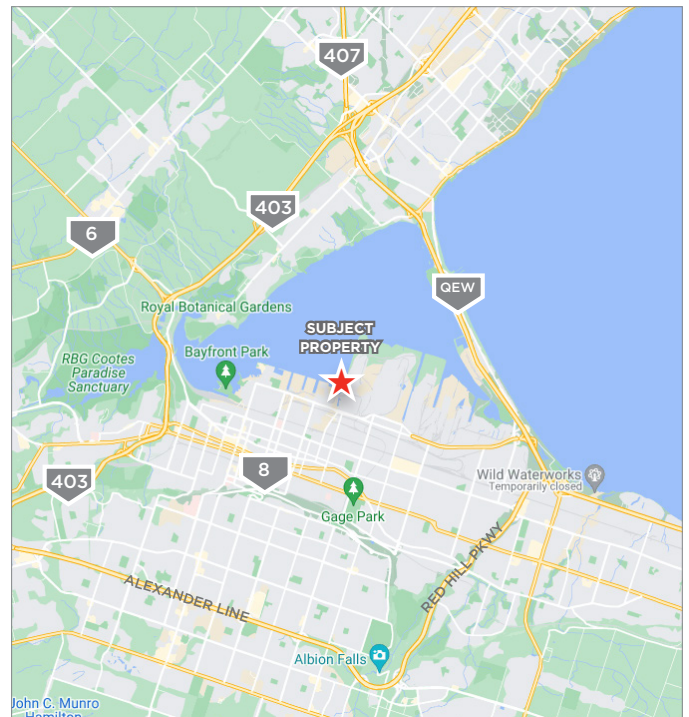

CONTACT INFORMATION

WALTER SPOJA*
Associate Vice President
905 501 6469
walter.spoja@cushwake.com

CUSHMAN & WAKEFIELD ULC, BROKERAGE
1 Prologis Blvd., Suite 300
Mississauga, Ontario L5W 0G2
905 568 9500
cushmanwakefield.com

©2023 Cushman & Wakefield. All rights reserved. The information contained in this communication is strictly confidential. This information has been obtained from sources believed to be reliable but has not been verified. No warranty or representation, express or implied, is made as to the condition of the property (or properties) referenced herein or as to the accuracy or completeness of the information contained herein, and same is submitted subject to errors, omissions, change of price, rental or other conditions, withdrawal without notice, and to any special listing conditions imposed by the property owner(s). Any projections, opinions or estimates are subject to uncertainty and do not signify current or future property performance. *Sales Representative

FOR SUBLEASE | FLEX LAB/OFFICE

450 SHERMAN AVE

HAMILTON, ON



IMAGE GALLERY



CONTACT INFORMATION

WALTER SPOJA*

Associate Vice President

905 501 6469

walter.spoja@cushwake.com

CUSHMAN & WAKEFIELD ULC, BROKERAGE

1 Prologis Blvd., Suite 300

Mississauga, Ontario L5W 0G2

905 568 9500

cushmanwakefield.com

©2023 Cushman & Wakefield. All rights reserved. The information contained in this communication is strictly confidential. This information has been obtained from sources believed to be reliable but has not been verified. No warranty or representation, express or implied, is made as to the condition of the property (or properties) referenced herein or as to the accuracy or completeness of the information contained herein, and same is submitted subject to errors, omissions, change of price, rental or other conditions, withdrawal without notice, and to any special listing conditions imposed by the property owner(s). Any projections, opinions or estimates are subject to uncertainty and do not signify current or future property performance. *Sales Representative

FOR SUBLEASE | FLEX LAB/OFFICE
450 SHERMAN AVE
 HAMILTON, ON



FLOORPLAN

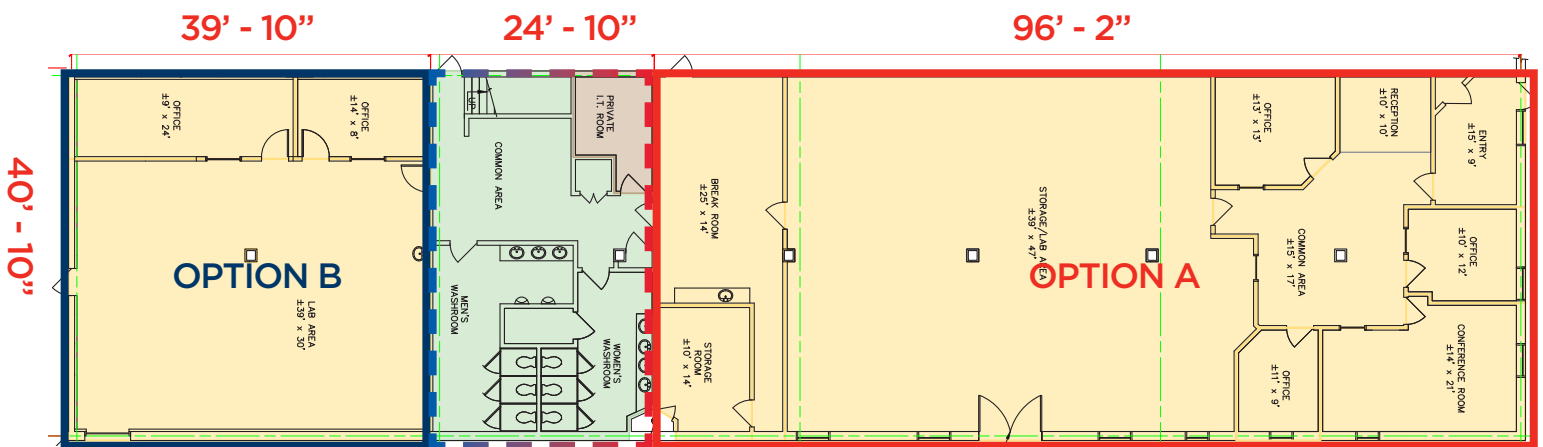

OPTION A - 4,133 SF

OPTION B - 1,771 SF

OPTION A & B - 5,904 SF



Shared Common Space

CONTACT INFORMATION

WALTER SPOJA*
 Associate Vice President
 905 501 6469
 walter.spoja@cushwake.com

CUSHMAN & WAKEFIELD ULC, BROKERAGE
 1 Prologis Blvd., Suite 300
 Mississauga, Ontario L5W 0G2
 905 568 9500
cushmanwakefield.com

©2023 Cushman & Wakefield. All rights reserved. The information contained in this communication is strictly confidential. This information has been obtained from sources believed to be reliable but has not been verified. No warranty or representation, express or implied, is made as to the condition of the property (or properties) referenced herein or as to the accuracy or completeness of the information contained herein, and same is submitted subject to errors, omissions, change of price, rental or other conditions, withdrawal without notice, and to any special listing conditions imposed by the property owner(s). Any projections, opinions or estimates are subject to uncertainty and do not signify current or future property performance. *Sales Representative

FOR SUBLEASE | FLEX LAB/OFFICE

450 SHERMAN AVE

HAMILTON, ON



AMENITIES & TRANSIT MAP

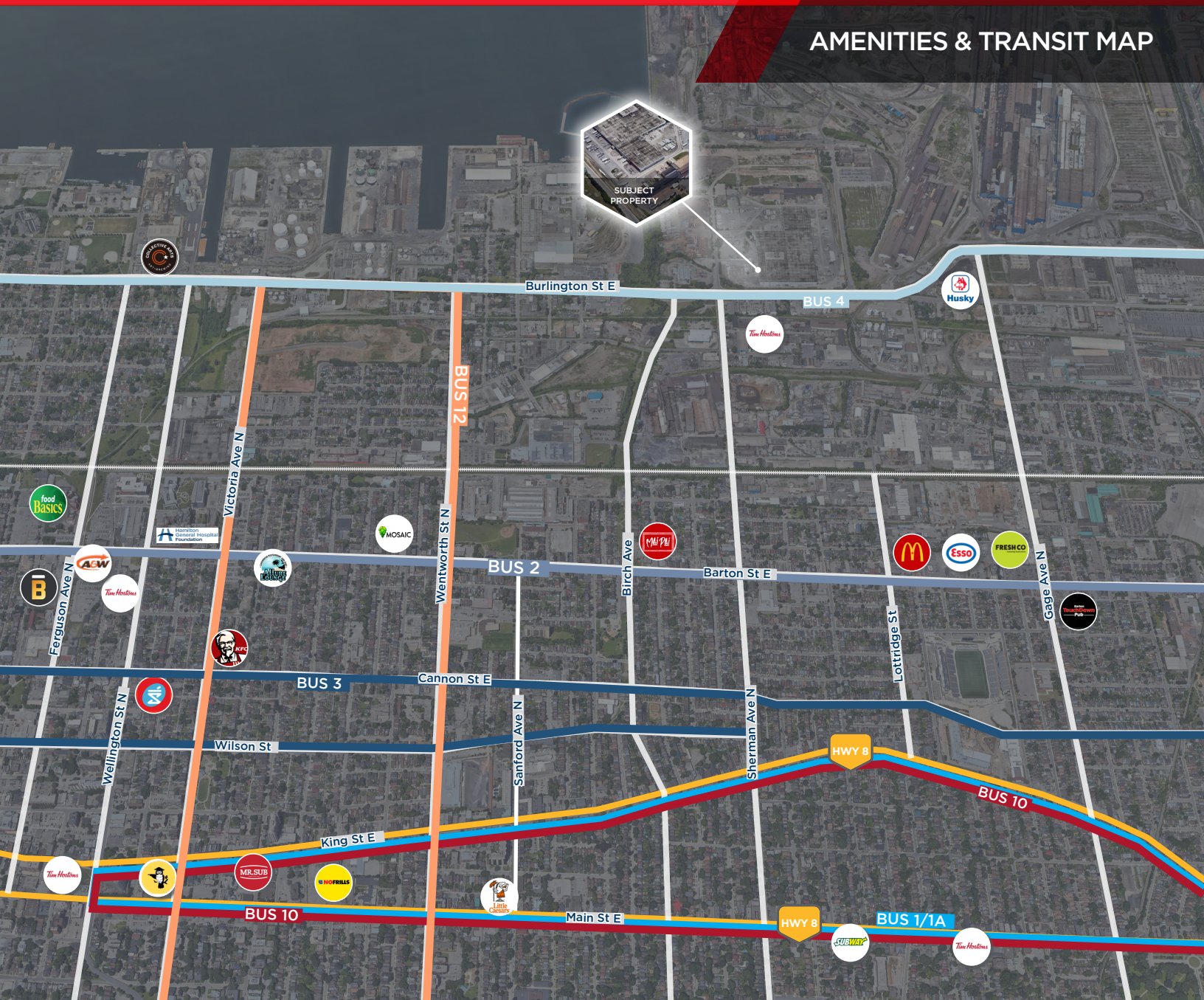

LEGEND | TRANSIT

- Bus 1/1A
- Bus 2
- Bus 3
- Bus 4
- Bus 10
- Bus 12



CONTACT INFORMATION

WALTER SPOJA*
 Associate Vice President
 905 501 6469
 walter.spoja@cushwake.com

CUSHMAN & WAKEFIELD ULC, BROKERAGE
 1 Prologis Blvd., Suite 300
 Mississauga, Ontario L5W 0G2
 905 568 9500
cushmanwakefield.com

©2023 Cushman & Wakefield. All rights reserved. The information contained in this communication is strictly confidential. This information has been obtained from sources believed to be reliable but has not been verified. No warranty or representation, express or implied, is made as to the condition of the property (or properties) referenced herein or as to the accuracy or completeness of the information contained herein, and same is submitted subject to errors, omissions, change of price, rental or other conditions, withdrawal without notice, and to any special listing conditions imposed by the property owner(s). Any projections, opinions or estimates are subject to uncertainty and do not signify current or future property performance. *Sales Representative