

Southcreek Corporate Center II

13160 Foster Street, Suite 190, Overland Park, Kansas



Office Available for Lease

- ◆ 14,202 rsf available
- ◆ Large open floor plan
- ◆ 4.5 spaces per 1,000 sf
- ◆ Back up generator in place
- ◆ 10' ceilings throughout
- ◆ Signage to Alt-169 Hwy.
- ◆ Exterior entry directly into premises
- ◆ 100% tenant control of premises with separate HVAC, separately metered electric and restrooms within space
- ◆ For lease at \$18.95/sf net electric & janitorial

Exclusive Property Listing

Debora H. Field 816.512.1030 dfield@ngzimmer.com

Richard H. Chamberlain, SIOR, LEED AP 816.268.4222 rchamberlain@ngzimmer.com



Procuring broker shall only be entitled to a commission calculated in accordance with the rates approved by our principal only if such procuring broker executes a brokerage agreement acceptable to us and our principal and the conditions as set forth in the brokerage agreement are fully and unconditionally satisfied. Although all information furnished regarding property for sale, rental, or financing is from sources deemed reliable, such information has not been verified and no express representation is made nor is any to be implied as to the accuracy thereof and it is submitted subject to errors, omissions, change of price, rental or other conditions, prior sale, lease or financing, or withdrawal without notice and to any special conditions imposed by our principal.

Southcreek Corporate Center II

13160 Foster Street, Suite 190, Overland Park, Kansas

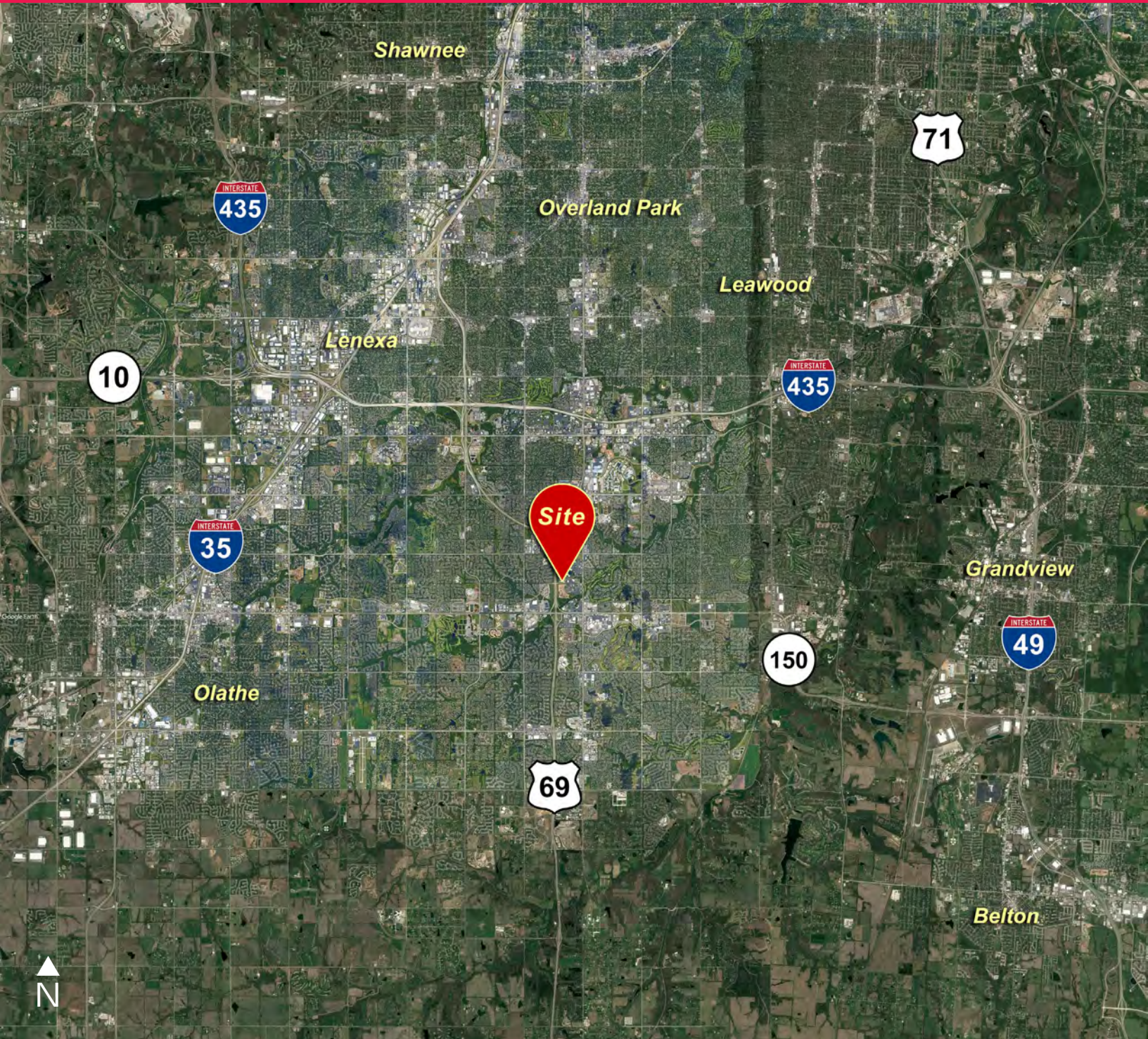

Exclusive Property Listing

Debora H. Field 816.512.1030 dfield@ngzimmer.com

Richard H. Chamberlain, SIOR, LEED AP 816.268.4222 rchamberlain@ngzimmer.com

Southcreek Corporate Center II

13160 Foster Street, Suite 190, Overland Park, Kansas

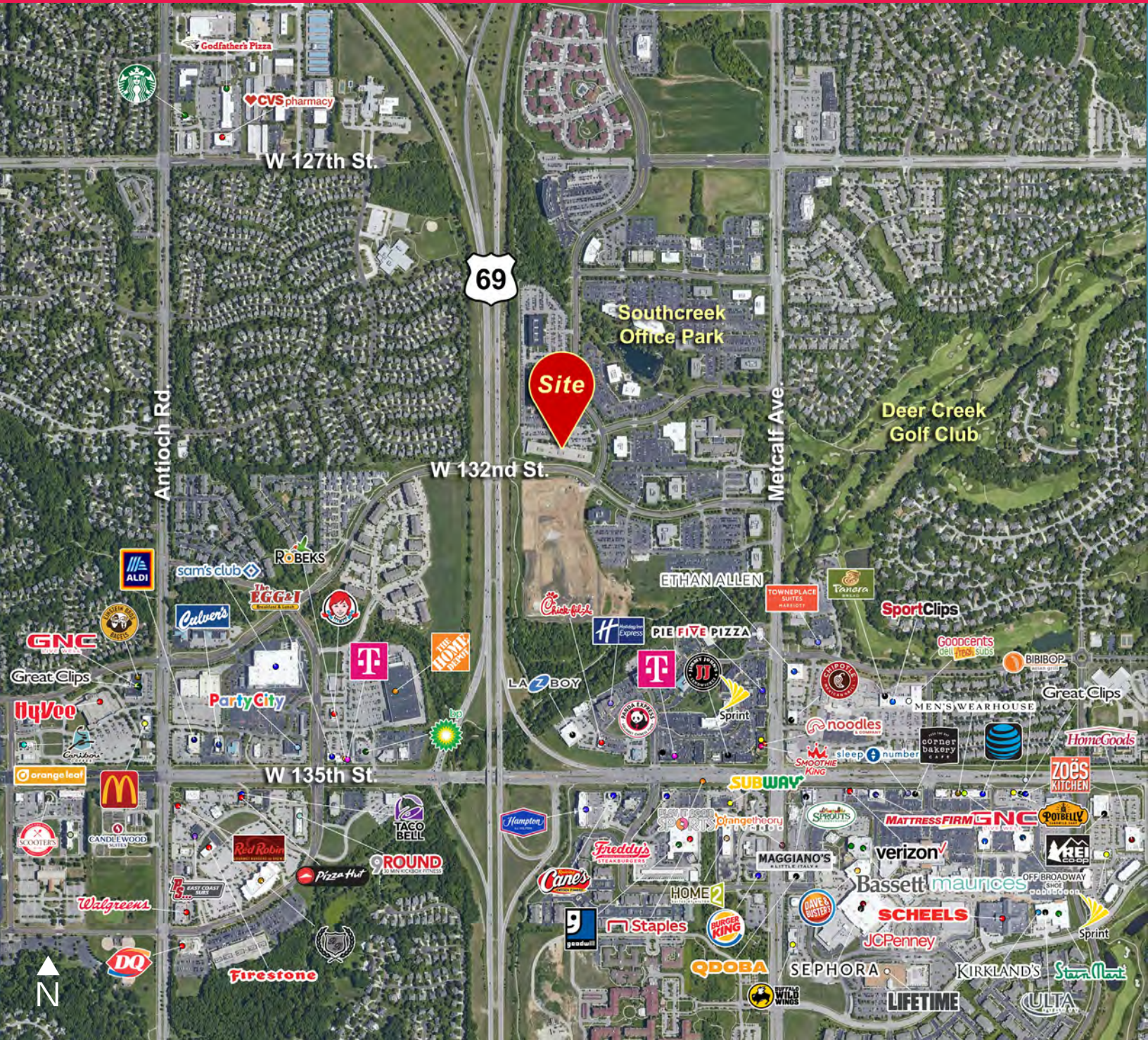

Exclusive Property Listing

Debora H. Field 816.512.1030 dfield@ngzimmer.com

Richard H. Chamberlain, SIOR, LEED AP 816.268.4222 rchamberlain@ngzimmer.com

Southcreek Corporate Center II

13160 Foster Street, Suite 190, Overland Park, Kansas

Floor Plan:

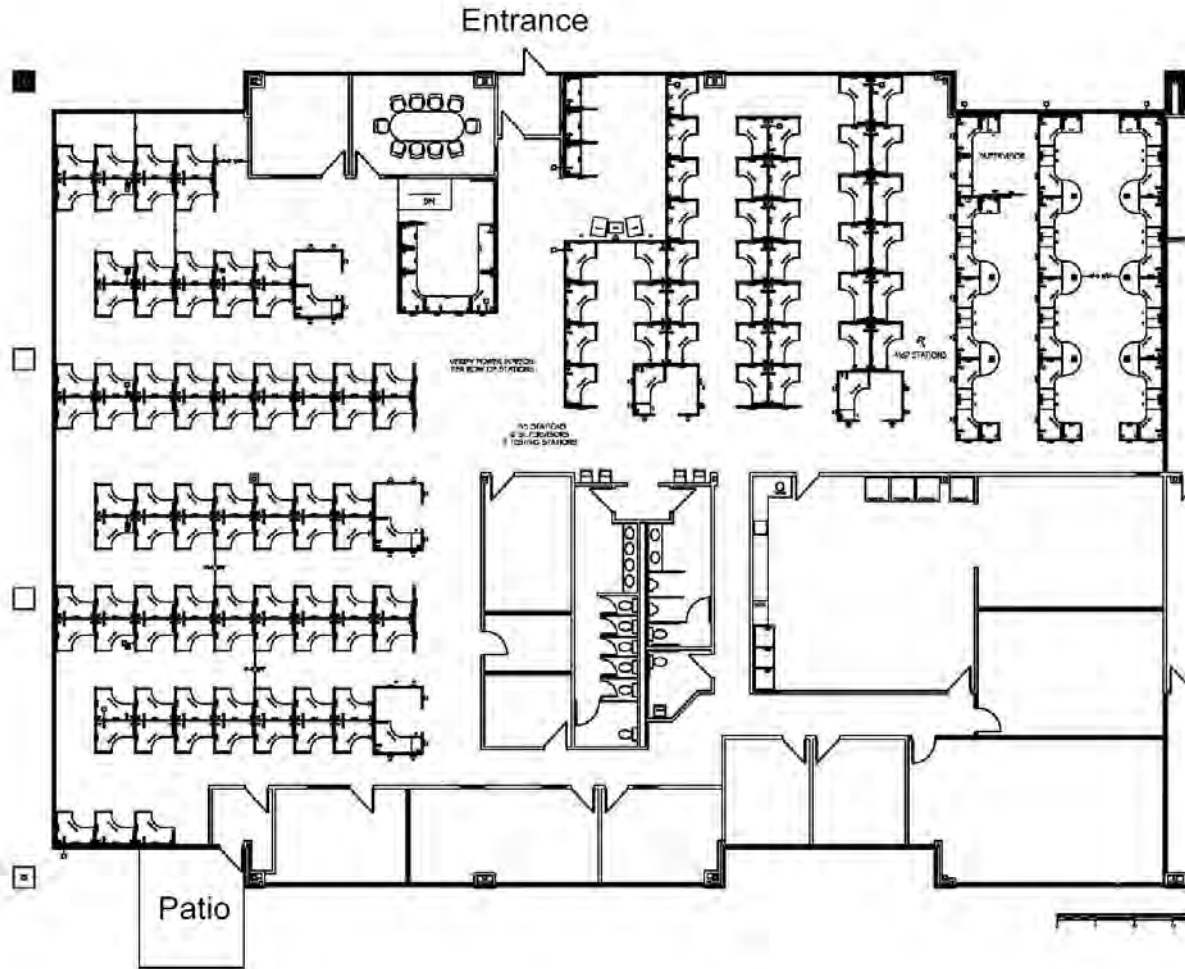

Exclusive Property Listing

Debora H. Field 816.512.1030 dfield@ngzimmer.com

Richard H. Chamberlain, SIOR, LEED AP 816.268.4222 rchamberlain@ngzimmer.com

Southcreek Corporate Center II

13160 Foster Street, Suite 190, Overland Park, Kansas

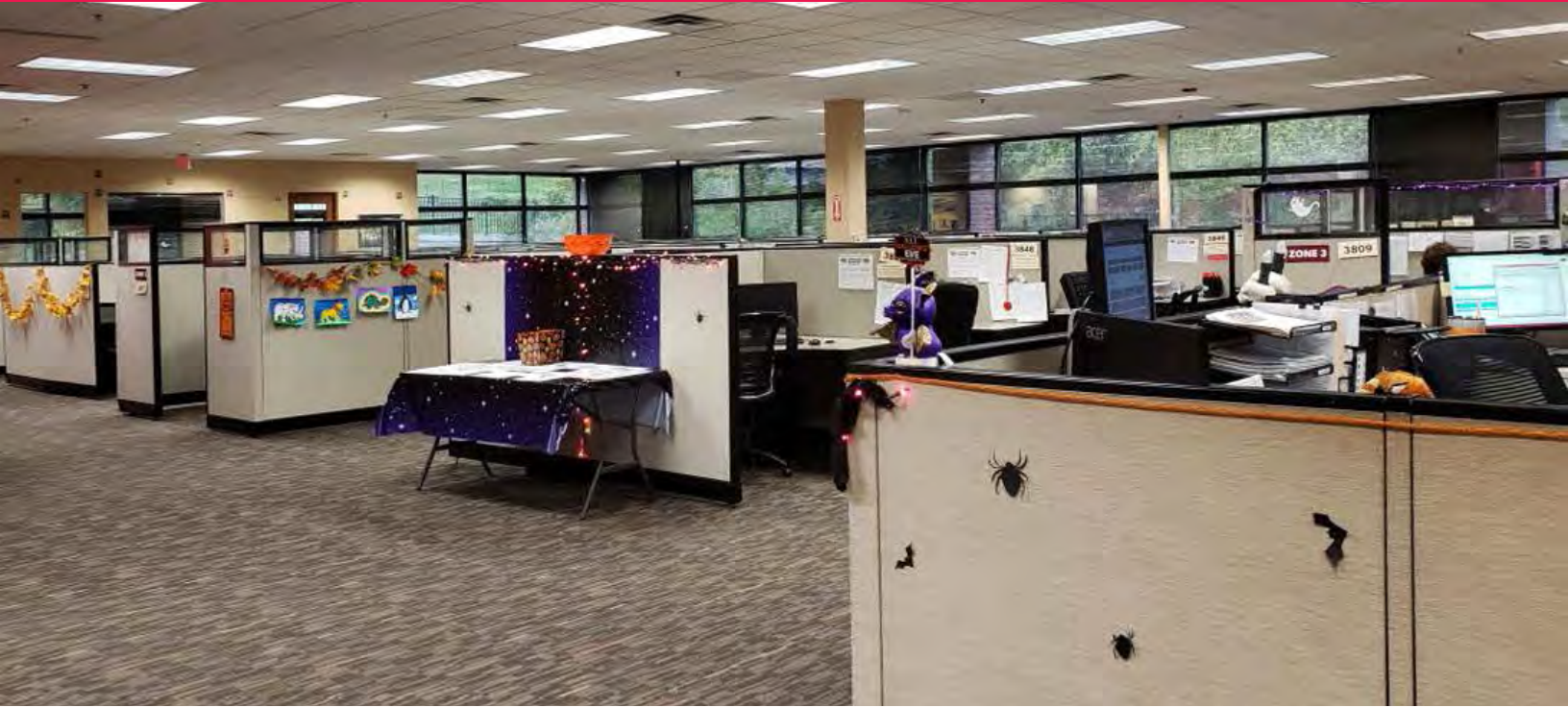

Exclusive Property Listing

Debora H. Field 816.512.1030 dfield@ngzimmer.com

Richard H. Chamberlain, SIOR, LEED AP 816.268.4222 rchamberlain@ngzimmer.com