

5,740 SF RETAIL SPACE FOR LEASE

147-25  
94TH  
AVE

JAMAICA, QUEENS, NEW YORK

EXCLUSIVE LEASING AGENT

 CUSHMAN &  
WAKEFIELD





147-25  
94TH  
AVE

**RETAIL GROUND SPACE AVAILABLE**

SPACE A	Approx. 2,540 SF
SPACE B	Approx. 2,000 SF
SPACE C	Approx. 1,200 SF
<b>TOTAL</b>	<b>Approx. 5,740 SF</b>

*Space configuration is flexible*

<b>LOCATION</b>	Sutphin Blvd on 94th Avenue
<b>FRONTAGE</b>	94th Avenue Approx. 150 FT
<b>POSSESSION</b>	Immediate
<b>TAXES</b>	Proportionate share of increases over base year
<b>POSSESSION</b>	Immediate
<b>ASKING RENT</b>	Upon Request
<b>NEIGHBORS</b>	Dunkin', Capital One, Bank of America, Chase, Metro by T-Mobile, Crown Fried Chicken & More

**COMMENTS**

- New construction retail space at the base of a 543 unit residential building
- Residential units fully occupied
- Over 1,500 units in the immediate vicinity (counting Crossings and the new building next to Towers)
- Steps from the Jamaica Station (LIRR) and Sutphin Blvd, Archer Ave, JFK Airport Station, with E, J, and Z subway lines
- Ideal for a variety of users, including retail, medical, restaurant, and fitness



147-25  
**94TH  
AVE**

**APPROX. 5,740 SF TOTAL**

**FRONTAGE**

APPROX. 150 FT ON 94TH AVENUE

**CEILING HEIGHT**

APPROX. 19 FT ON GROUND FLOOR

**SUTPHIN BOULEVARD**

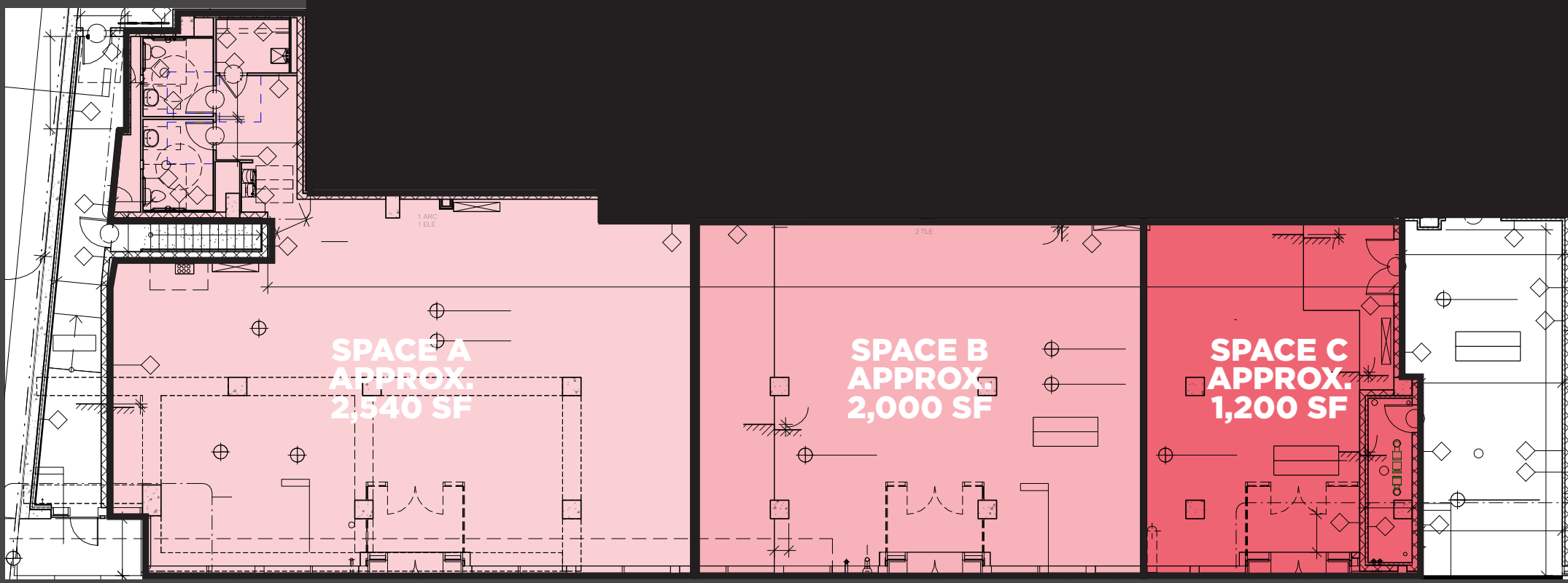

**94TH AVENUE**

147-25  
**94TH  
AVE**

**LOCATION MAP**

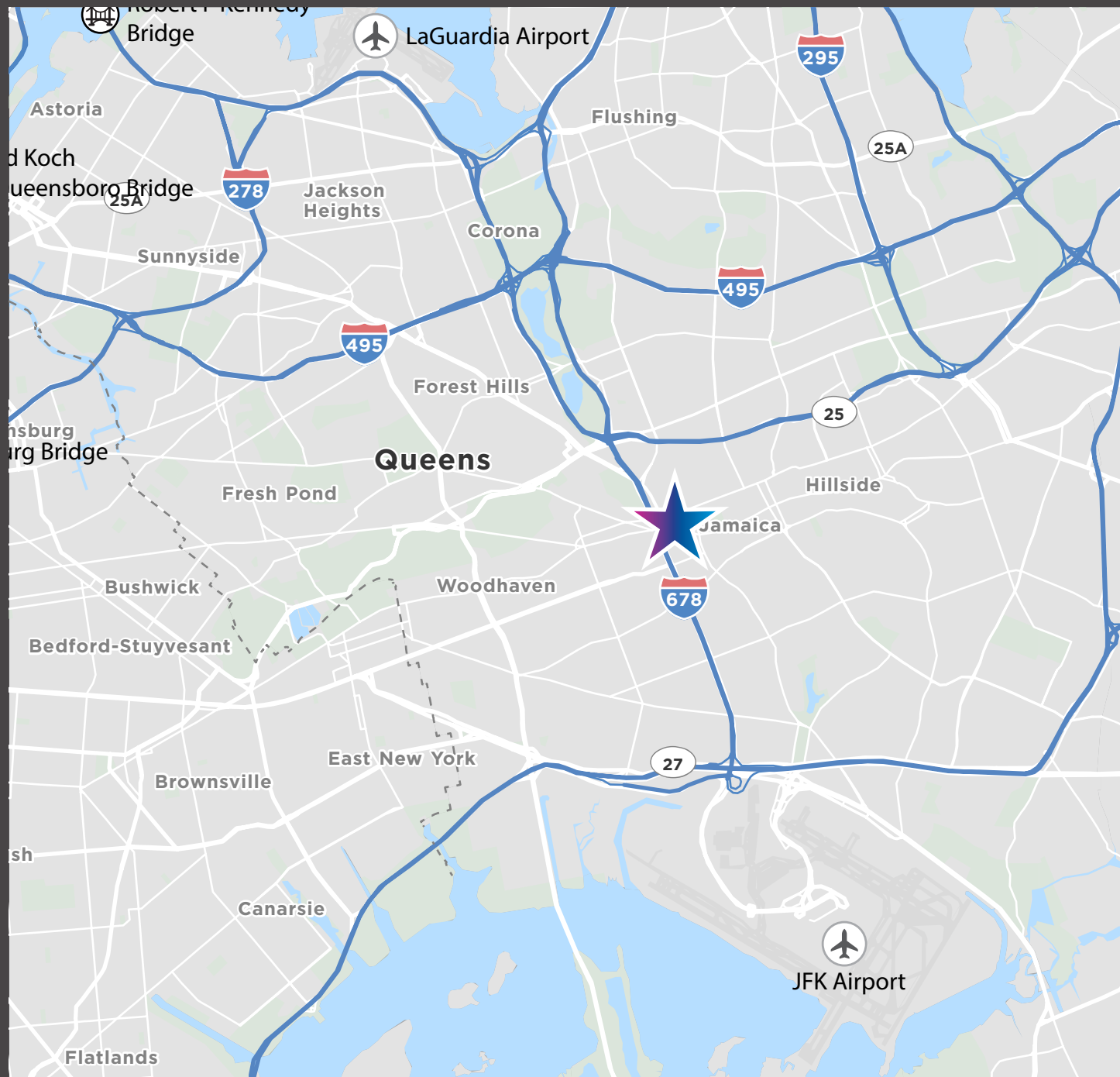



147-25  
**94TH  
AVE**

**ELIZABETH HOLMES**

631 546 5885

elizabeth.holmes@cushwake.com

**MITZI FLEXER**

718 307 6504

mitzi.flexer@cushwake.com

**1290 AVENUE OF THE AMERICAS**

NEW YORK, NY 10001

T +1 212 841 7500

CUSHMANWAKEFIELD.COM



**CUSHMAN &  
WAKEFIELD**

©2024 Cushman & Wakefield. All rights reserved. The information contained in this communication is strictly confidential. This information has been obtained from sources believed to be reliable but has not been verified. NO WARRANTY OR REPRESENTATION, EXPRESS OR IMPLIED, IS MADE AS TO THE CONDITION OF THE PROPERTY (OR PROPERTIES) REFERENCED HEREIN OR AS TO THE ACCURACY OR COMPLETENESS OF THE INFORMATION CONTAINED HEREIN, AND SAME IS SUBMITTED SUBJECT TO ERRORS, OMISSIONS, CHANGE OF PRICE, RENTAL OR OTHER CONDITIONS, WITHDRAWAL WITHOUT NOTICE, AND TO ANY SPECIAL LISTING CONDITIONS IMPOSED BY THE PROPERTY OWNER(S). ANY PROJECTIONS, OPINIONS OR ESTIMATES ARE SUBJECT TO UNCERTAINTY AND DO NOT SIGNIFY CURRENT OR FUTURE PROPERTY PERFORMANCE.