

MEDICAL OFFICE FOR LEASE AT CHINO MEDICAL CENTER



Medical Office Adjacent to Chino Valley Medical Center(CVMC) and CA-60 FWY
5365 Walnut Avenue, Chino, CA 91710

Kavita Bhatia (Gurjeet)
President & Broker
Email: kavita@kbrealestate.net
Phone: 909.210.1570
DRE #01895064

KB REAL ESTATE
Phone: 909.233.8003
Fax: 909.912.8093
Address : 15210 Central Avenue,
Chino, CA 91710
DRE #02034779



MEDICAL OFFICE FOR LEASE AT CHINO MEDICAL CENTER



Address: **5365 Walnut Avenue, Chino, CA 91710**

- **CONVENIENT LOCATION:** Located adjacent to United State Postal Services and walkable distance to the Chino Valley Medical Center (CVMC)
- **FREEWAY ACCESS:** Great access to CA-60 Fwy (less than 400 meters and less than 4 miles to the CA-71 Fwy).
- **AVAILABLE SIZE:** One available Suite of approx. 1,944 sq. ft. and ideal setup for a medical office
- **MEDICAL OFFICES:** the vacant units are built out with multiple exam rooms, waiting room, restrooms (see floorplan)
- **HIGH POPULATION:** It is estimated to have over 400,000 residents living in a five(5) mile radius.
- **BUILDING DETAILS:** Chino Medical Center is a professional medical office building of approx. 14,400 square feet with onsite pharmacy and other medical use Tenants.
- **HIGH TRAFFIC:** Central Avenue and Walnut Avenue is heavily traveled by approx. 64,000 vehicle per day
- **SURROUNDINGS:** The building is surrounded by other Medical users, restaurants, coffee shops, banks and with easy access to freeways and more...

FOR LEASE



Available Suites

Area

Rent /Month

Suite P

1,944 (+/-) s. f.

\$1.80 /s. f. / month plus CAM

Information was obtained from sources believed to be reliable but it is not guaranteed, all information is subject to change at anytime.

FLOOR PLAN

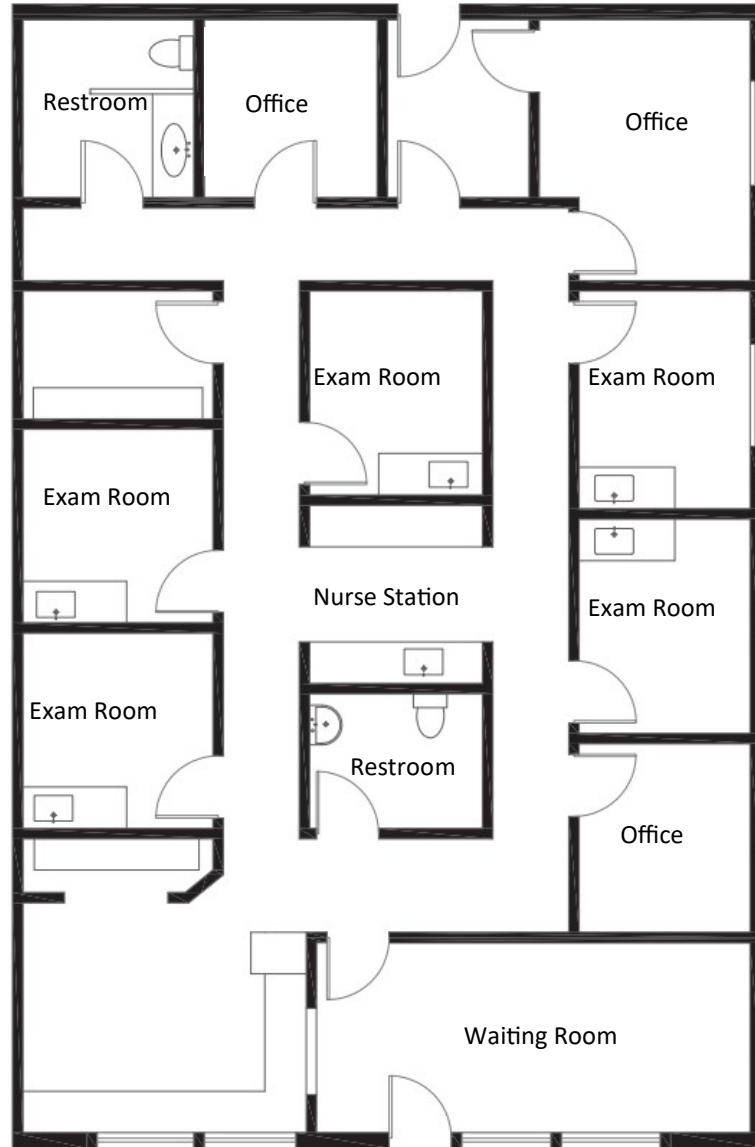

SUITE P - 1,944(+/-) sq. ft.

Not Drawn to scale. Exact measurements and proportions may vary. Tenant/ buyer to conduct own due diligence

Information was obtained from sources believed to be reliable but it is not guaranteed, all information is subject to change at anytime.

LOCATION MAP

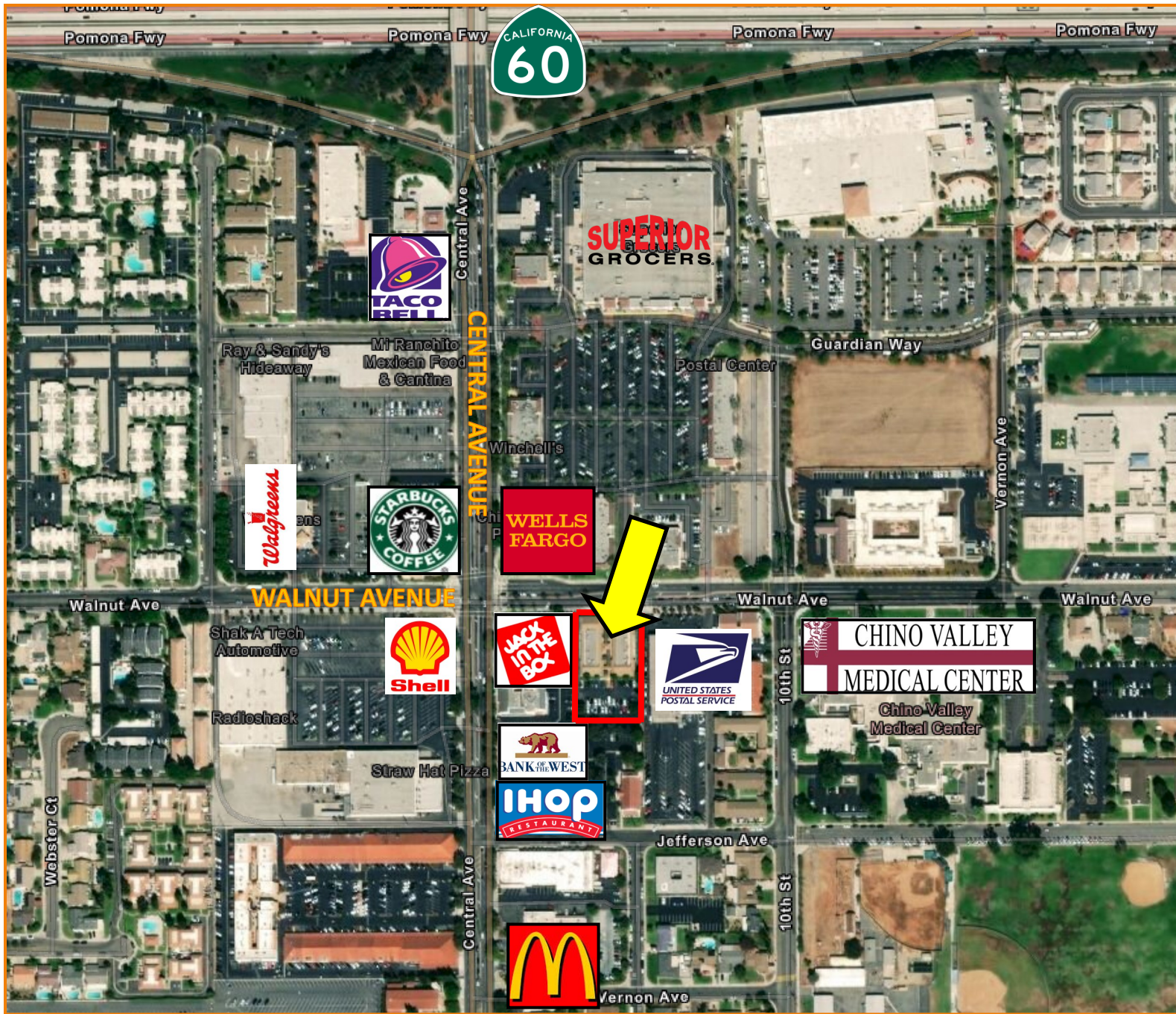

Information was obtained from sources believed to be reliable but it is not guaranteed, all information is subject to change at anytime.

LOCATION MAP

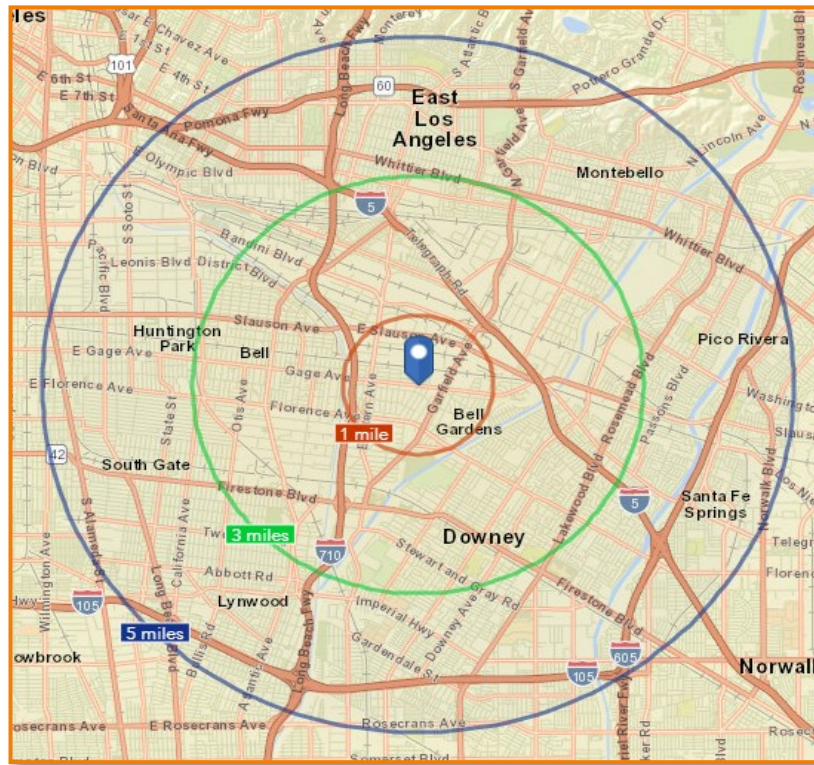

	1 Mile	3 Mile	5 Mile
2019 Estimate Population:	26,406	163,622	426,636
Population Growth 2019-2023:	0.54%	0.59%	0.65%
Median Age:	32.7	32.9	32.7
2019 Estimate Households:	7,541	43,530	116,287
HH Growth 2019-2024	0.46%	0.58%	0.63%
Median Household Income:	\$59,756	\$66,023	\$64,730

Information was obtained from sources believed to be reliable but it is not guaranteed, all information is subject to change at anytime.