

FOR SUBLEASE ±8,520 SQ. FT.

1169 N. Grove St., Anaheim



Property Features

- 1,000 Sq. Ft. of Office (Verify)
- Large Fenced Yard
- **One (1) Shop Restroom**
- Ground Level Loading Doors
- 400 Amps of Distributed 120/208 Volt Power
- 16' Warehouse Clearance (Verify)
- Fire Sprinklers
- Excellent Access to 57 and 91 Freeways
- **Sublease Expires July 31, 2027**



MICHAEL HEFNER, SIOR

Executive Vice President
714.935.2331
mhefner@voitco.com
Lic. #00857352

BRENDEN HEFNER

Senior Associate
714.935.2326
bhefner@voitco.com
Lic. #02114046

Voit
REAL ESTATE SERVICES

**HEFNER
VERNICK
TEAM**

FOR SUBLEASE ±8,520 SQ. FT.

1169 N. Grove St., Anaheim

SITE PLAN

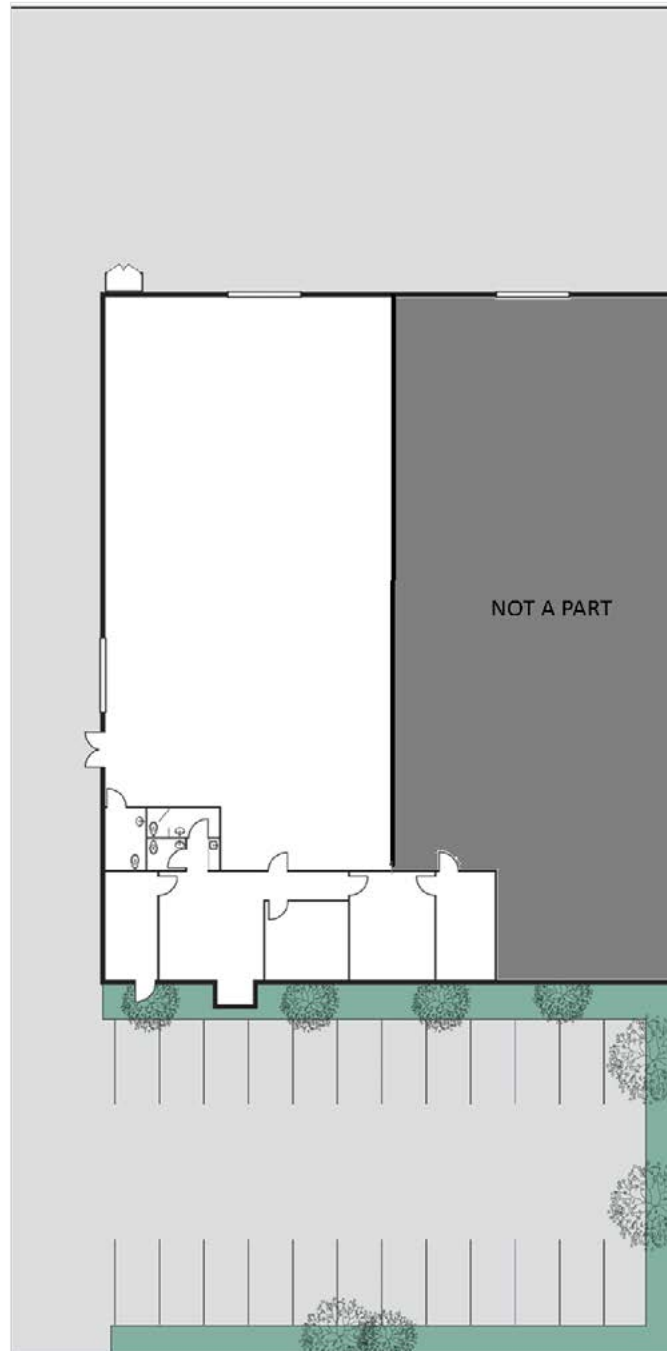

*Site plan not to scale.

MICHAEL HEFNER, SIOR

Executive Vice President
714.935.2331
mhefner@voitco.com
Lic. #00857352

BRENDEN HEFNER

Senior Associate
714.935.2326
bhefner@voitco.com
Lic. #02114046

Voit
REAL ESTATE SERVICES

HV HEFNER
VERNICK
TEAM

2400 E. Katella Avenue, Suite 750, Anaheim, CA 92806 • 714.978.7880 • 714.978.9431 Fax

Licensed as Real Estate Salespersons by the DRE. The information contained herein has been obtained from sources we deem reliable. While we have no reason to doubt its accuracy, we do not guarantee it. ©2025 Voit Real Estate Services, Inc. All Rights Reserved. License #01991785.