

2384-2390 westwood  
boulevard

West LA  
prime retail opportunity







## property features

JLL is pleased to present 2384-2390 Westwood Boulevard, an exciting retail opportunity located in the heart of West LA. The 6,549+ RSF space features strong flexibility and an unparalleled location with easy access to some of the Westside's most iconic landmarks. Just steps from One Westside (Google's future Los Angeles Headquarters) and the corner of Westwood Blvd. and Pico Blvd, 2384-2390 Westwood offers extremely strong visibility, a heavily trafficked location, and exceptional access to daytime employees and residents.

size: 6,549 rsf (divisible)

rent: available upon request

availability: now

parking: abundant metered street parking  
on-site parking structure

site  
plan



available space

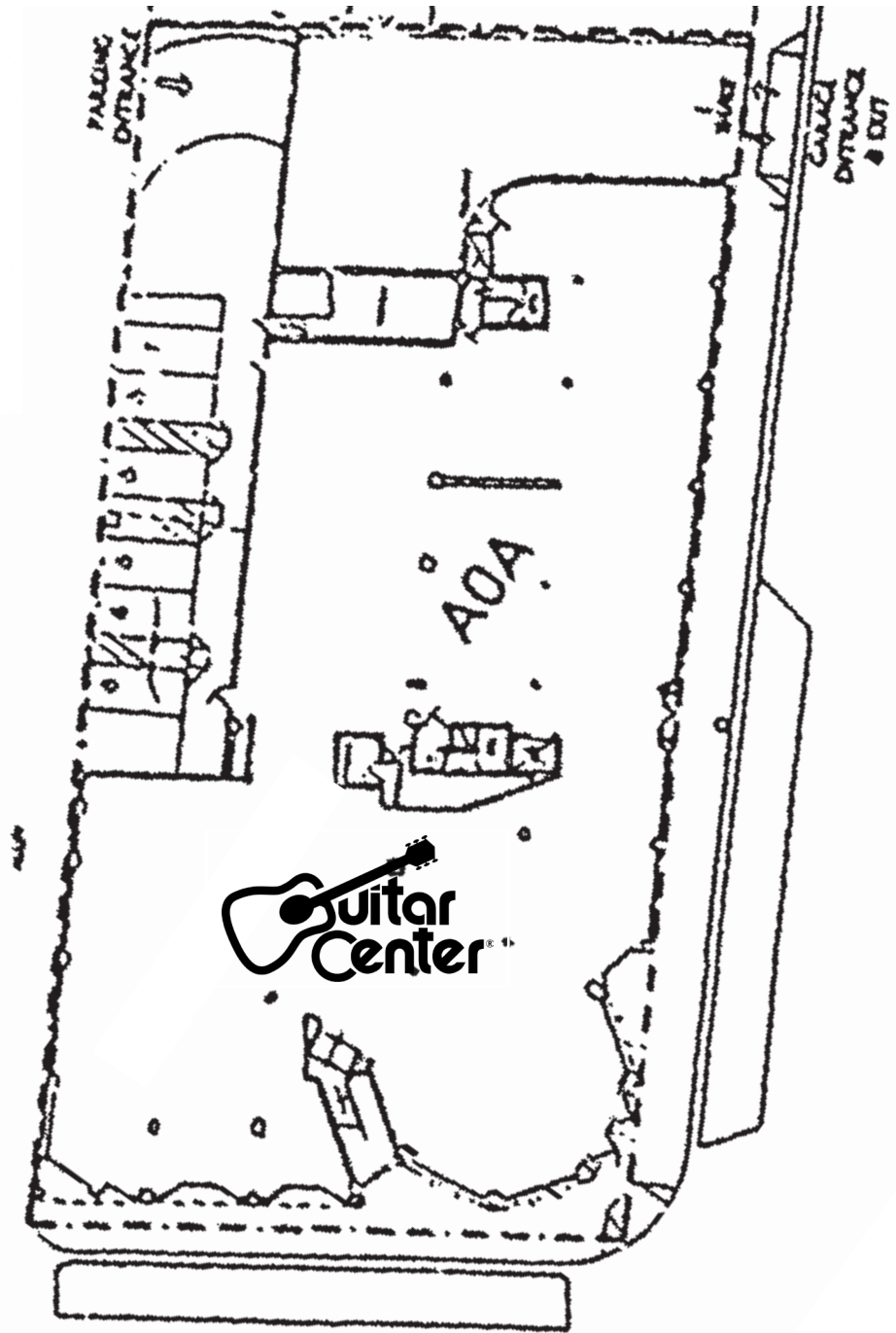





\$2.14b  
consumer spending

## welcome to WEST LA

130k  
avg. hh. income

50,288  
total population

224k  
daytime employees

Ensnconced in the heart of West LA, 2384-2390 Westwood Boulevard's central location offers unparralleled access to some of the Westside's most iconic landmarks, including One Westside, UCLA, Westfield Century City, and more. The property is also located at the heavily trafficked intersection of Westwood Blvd. and Pico Blvd., and offers easy accessibility to both the I-405, I-10, and numerous major thoroughfares. A truly rare location that provides exceptional accessibility and visibility.





# a look at West LA

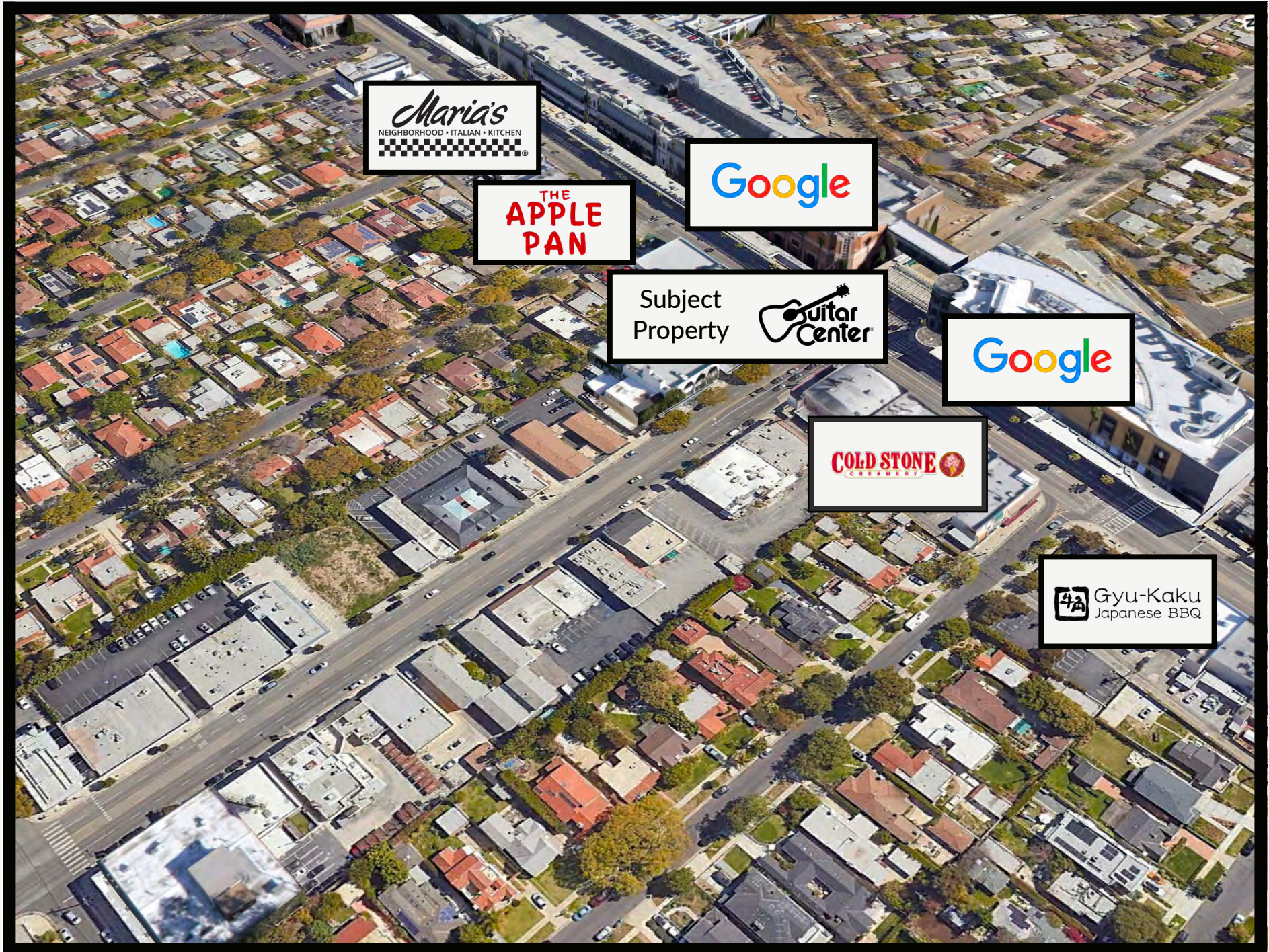





for leasing information,  
**contact us at:**

**Marisa Renfro**  
+1 949 922 7278  
Associate  
Marisa.Renfro@jll.com  
Lic #02178774

**Greg Briest**  
+1 310 595 3623  
Senior Vice President  
Greg.Briest@jll.com  
Lic #01949565

**Houman Mahboubi**  
+1 310 595 3621  
Managing Director  
Houman.Mahboubi@jll.com  
Lic #01450237

**\*\*Although information has been obtained from sources deemed reliable, neither Owner nor JLL makes any guarantees, warranties or representations, express or implied, as to the completeness or accuracy as to the information contained herein. Any projections, opinions, assumptions or estimates used are for example only. There may be differences between projected and actual results, and those differences may be material. The Property may be withdrawn without notice. Neither Owner nor JLL accepts any liability for any loss or damage suffered by any party resulting from reliance on this information. If the recipient of this information has signed a confidentiality agreement regarding this matter, this information is subject to the terms of that agreement. ©2022. Jones Lang La Salle IP, Inc. All rights reserved.\*\***

**\*\*\*The outbreak of the COVID-19 virus (novel coronavirus) since the end of January 2020 has resulted in market uncertainty and volatility. While the economic impact of a contagion disease generally arises from the uncertainty and loss of consumer confidence, its impact on real estate values is unknown at this stage.\*\***