

WORKSHOP/STORAGE UNIT PORTFOLIO FOR SALE

4810 110TH AVE N., PINELLAS PARK, FL 33762 - 14,971 SF
6270 118TH AVE N., PINELLAS PARK, FL 33773 – 24,486 SF
(2.6 MILES APART)

ASKING PRICE \$6,200,000

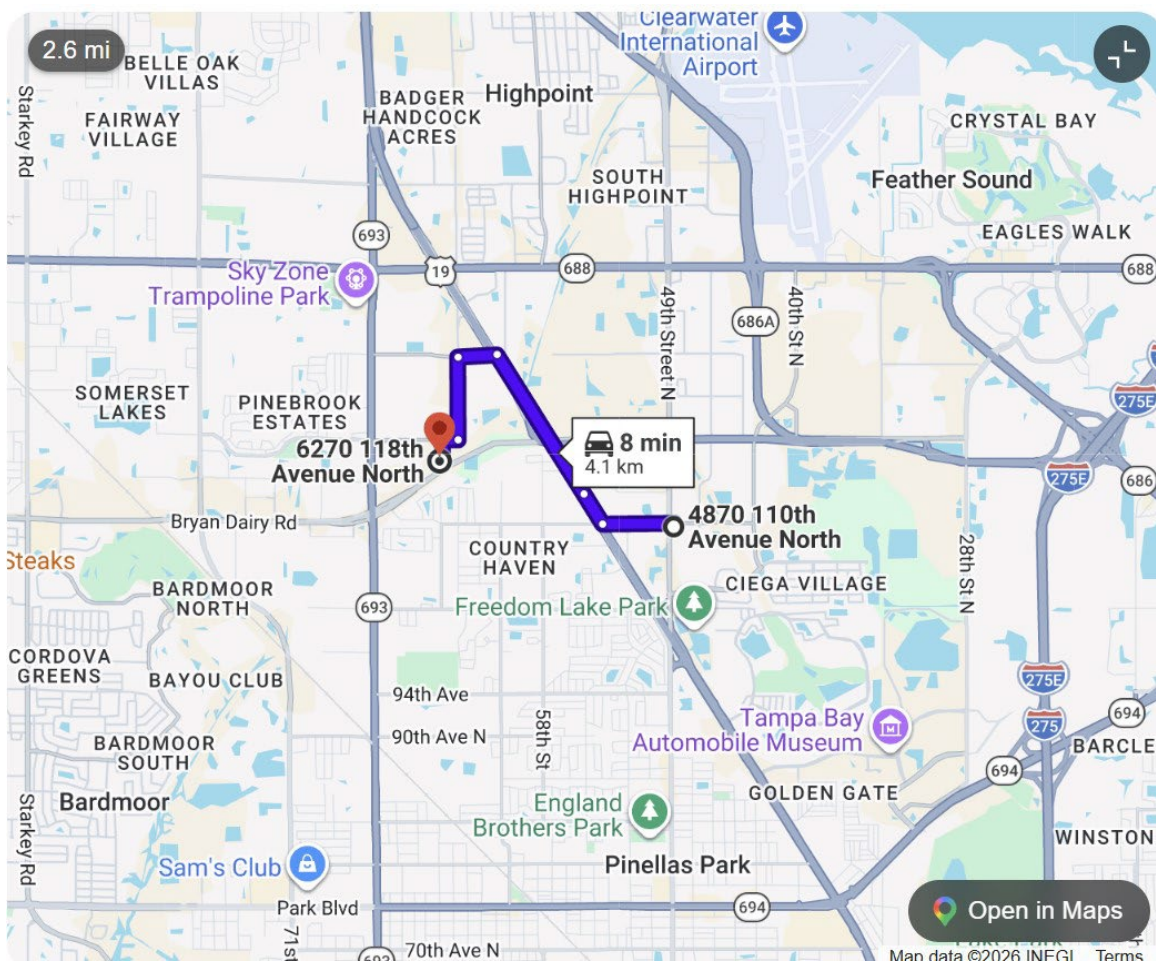

**4810 110th Ave N.
Pinellas Park, FL 33762**

SITE INFORMATION

- Storage / Work Office Spaces
- 25 Workshop/Storage Units from 100, 200, 400, 600, 1,100 and 2,000 SF (13,500 SF)
- Stand Alone Building Office/Car Sales – 1,375 SF
- Gated (24 HR Access)
- Power – Duke Energy
- Water/Sewer/Garable provided by Pinellas Park
- On-Site Restroom

PROPERTY INFORMATION

- Address: 4810 110th Ave. N., Pinellas Park, FL 33762
- Legal: Pinellas Farms SE 1/4, SEC 16-30-16 N 200 FT of E 200 FT W 362.58 FT of Farm 34 Less N 15 FT thereof (See survey for full legal description).
- Folio #: 16-30-16-69732-400-3401
- Year Built: 1957, 1983, 1983
- Zoning: M-1
- Flood Zone: X

Broker: Jon Sipera (813) 695-2886

The information contained herein was gathered from sources believed reliable; however, RaJoKa Realty, LLC., or its agents, cannot be responsible for errors, omissions, changes, withdrawal. Please verify all information.

**4810 110th Ave N.
Pinellas Park, FL 33762**

LOCATION MAP

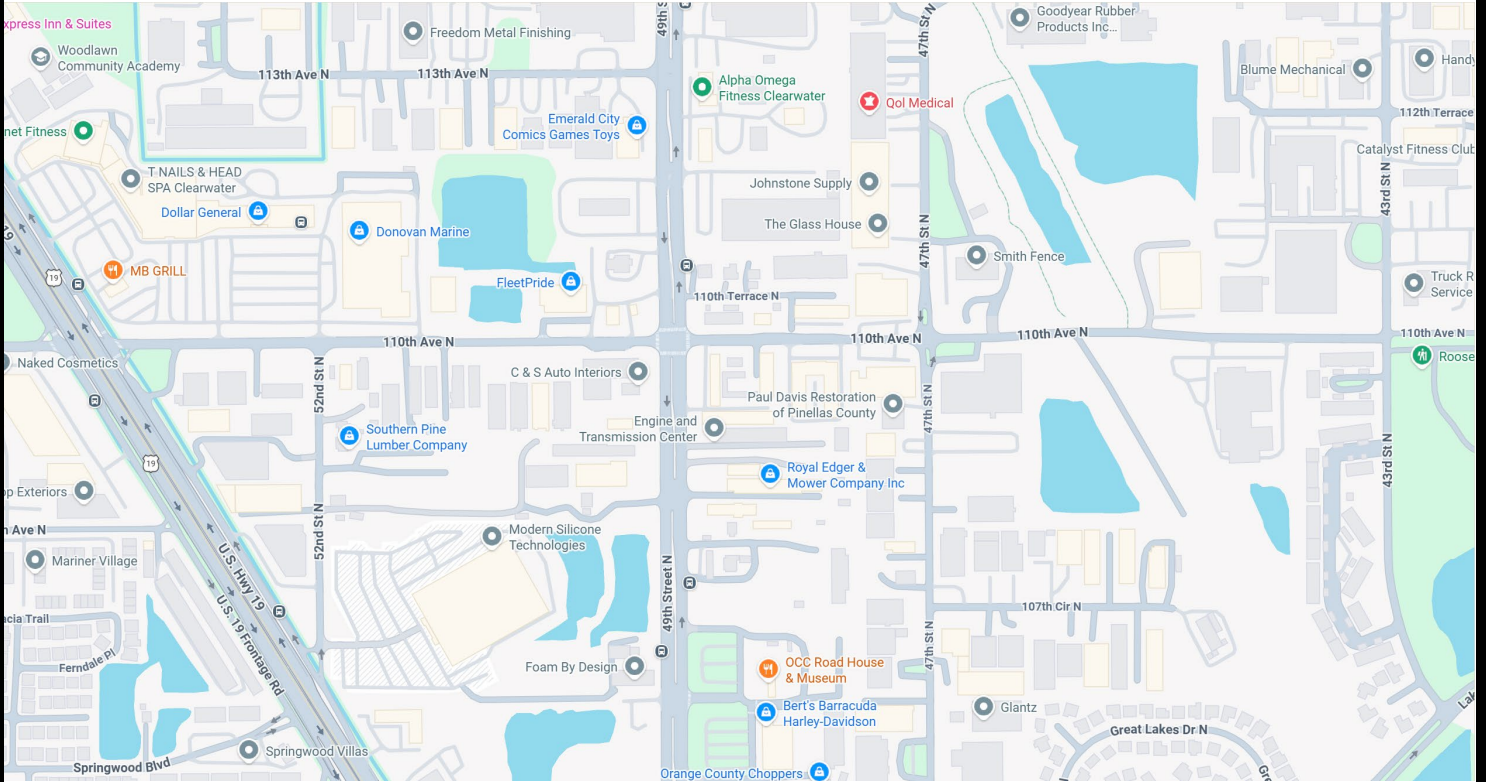

**The information contained herein was gathered from sources believed reliable;
however, RaJoKa Realty, LLC., or its agents, cannot be responsible for errors,
omissions, changes, withdrawal. Please verify all information.**

**4810 110th Ave N.
Pinellas Park, FL 33762**



**The information contained herein was gathered from sources believed reliable;
however, RaJoKa Realty, LLC., or its agents, cannot be responsible for errors,
omissions, changes, withdrawal. Please verify all information.**

**4810 110th Ave N.
Pinellas Park, FL 33762**



The information contained herein was gathered from sources believed reliable; however, RaJoKa Realty, LLC., or its agents, cannot be responsible for errors, omissions, changes, withdrawal. Please verify all information.

**4810 110th Ave N.
Pinellas Park, FL 33762**



The information contained herein was gathered from sources believed reliable; however, RaJoKa Realty, LLC., or its agents, cannot be responsible for errors, omissions, changes, withdrawal. Please verify all information.

**4810 110th Ave N.
Pinellas Park, FL 33762**

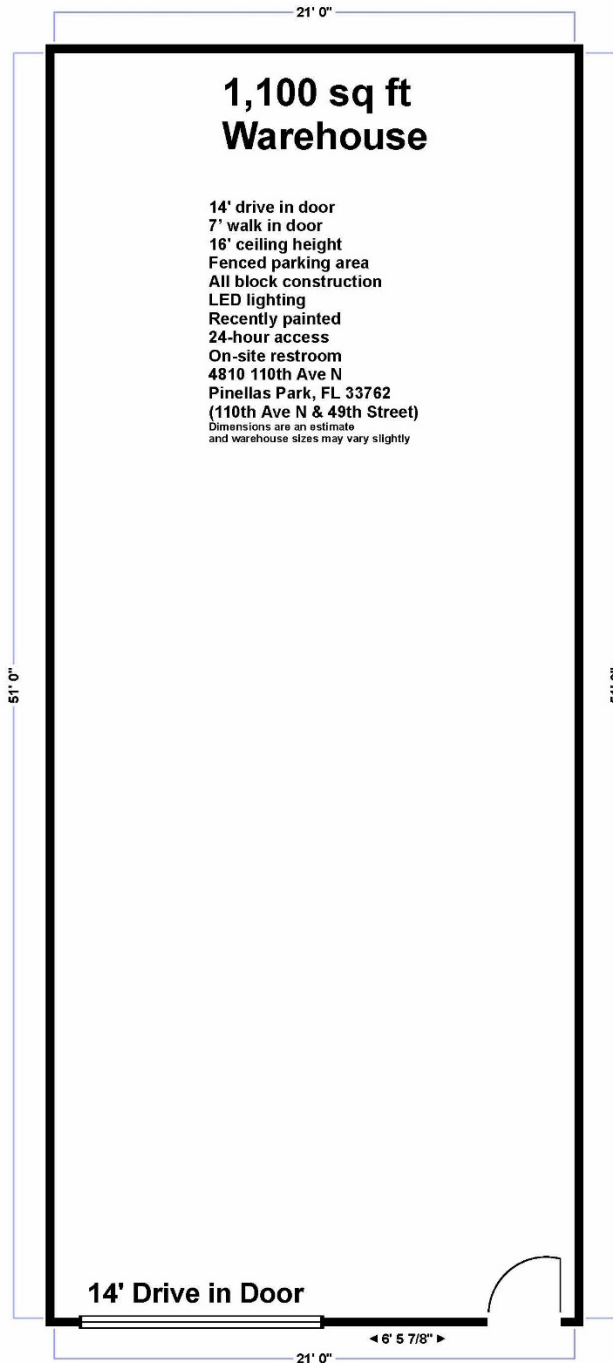

**The information contained herein was gathered from sources believed reliable;
however, RaJoKa Realty, LLC., or its agents, cannot be responsible for errors,
omissions, changes, withdrawal. Please verify all information.**

**4810 110th Ave N.
Pinellas Park, FL 33762**

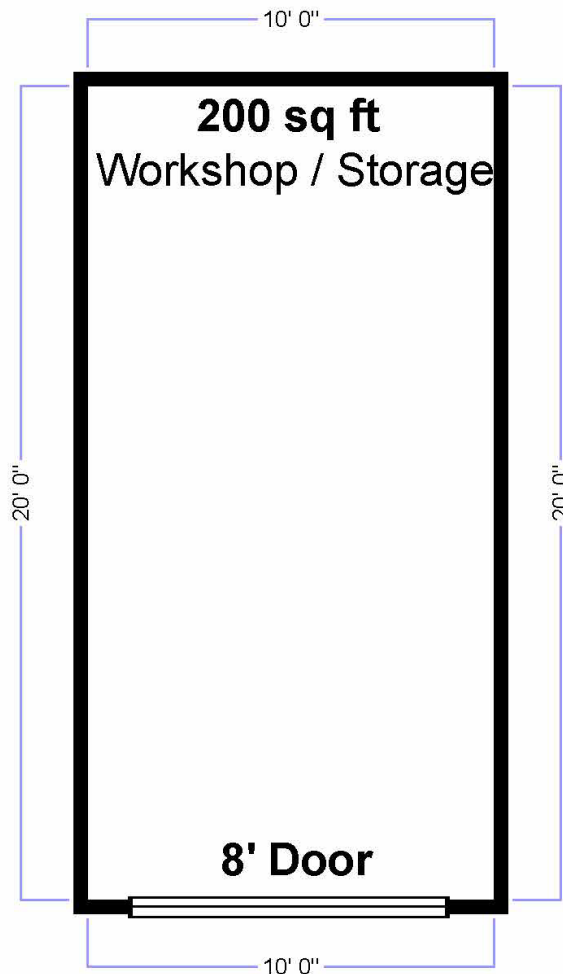

8' drive in door
10' ceilings
LED lighting
Recently painted
24 hour access
On-site restroom
4810 110th Ave N
Pinellas Park, FL 33762
(110th Ave N & 49th Street)
Dimensions are an estimate and
workshop sizes may vary slightly

**The information contained herein was gathered from sources believed reliable;
however, RaJoKa Realty, LLC., or its agents, cannot be responsible for errors,
omissions, changes, withdrawal. Please verify all information.**

**4810 110th Ave N.
Pinellas Park, FL 33762**

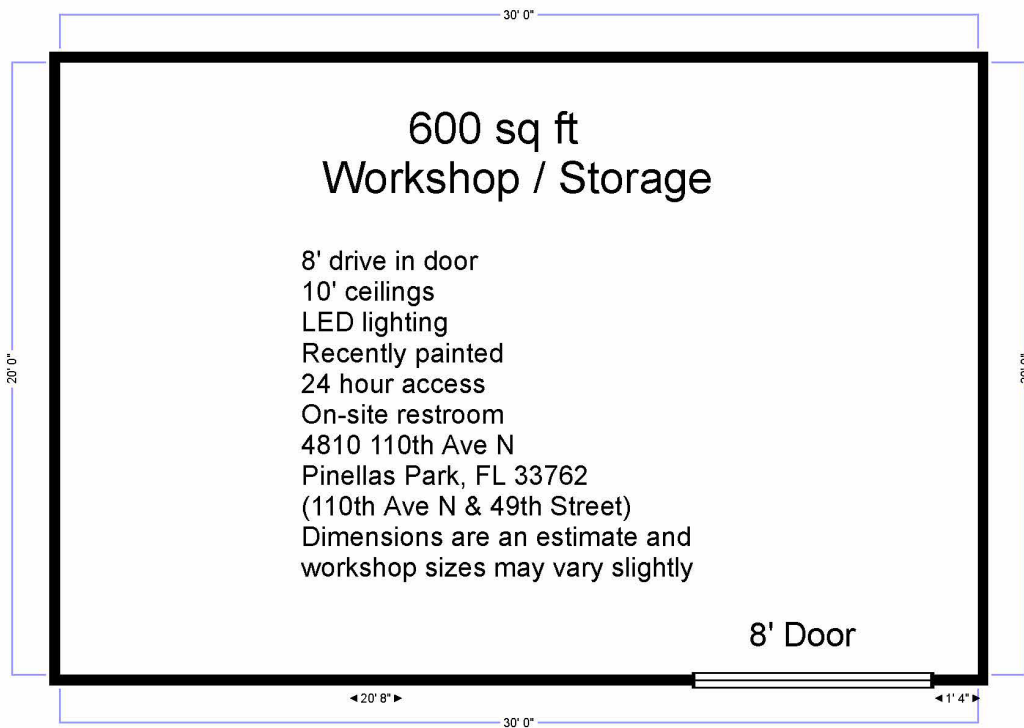

**The information contained herein was gathered from sources believed reliable;
however, RaJoKa Realty, LLC., or its agents, cannot be responsible for errors,
omissions, changes, withdrawal. Please verify all information.**

**6270 118th Ave N.
Pinellas Park, FL 33773**

SITE INFORMATION

- Storage / Work Office Spaces
- 43 Workshop/Storage Units from 70, 120, 200, 325, 650, 700, 800, and 1,600 SF
- Building 6254 – 6,286 SF
- Building 6258 – 4,700 SF
- Building 6266 – 7,200 SF
- Building 6270 – 6,300 SF
- Power – Duke Energy
- Water/Garbage provided by Pinellas Park
- Sewer - Septic
- On-Site Restroom

PROPERTY INFORMATION

- Address: 6270 118th Ave. N., Pinellas Park, FL 33773
- Legal: Pinellas Groves NW 1/4, SEC 17-30-16 Part of Lots 1 & 16 Desc from NE cor of NW 1/4 of SD Sec TH W 329.25 FT TH S 617.3 FT for POB TH S 106 FT (S) Th S 55 D (See survey for full legal description).
- Folio #: 17-30-16-71046-200-1601
- Year Built: 1980, 1993, 2008, 2009
- Zoning: M-1
- Flood Zone: AE

Broker: Jon Sipera (813) 695-2886

The information contained herein was gathered from sources believed reliable; however, RaJoKa Realty, LLC., or its agents, cannot be responsible for errors, omissions, changes, withdrawal. Please verify all information.

**6270 118th Ave N.
Pinellas Park, FL 33773**

LOCATION MAP

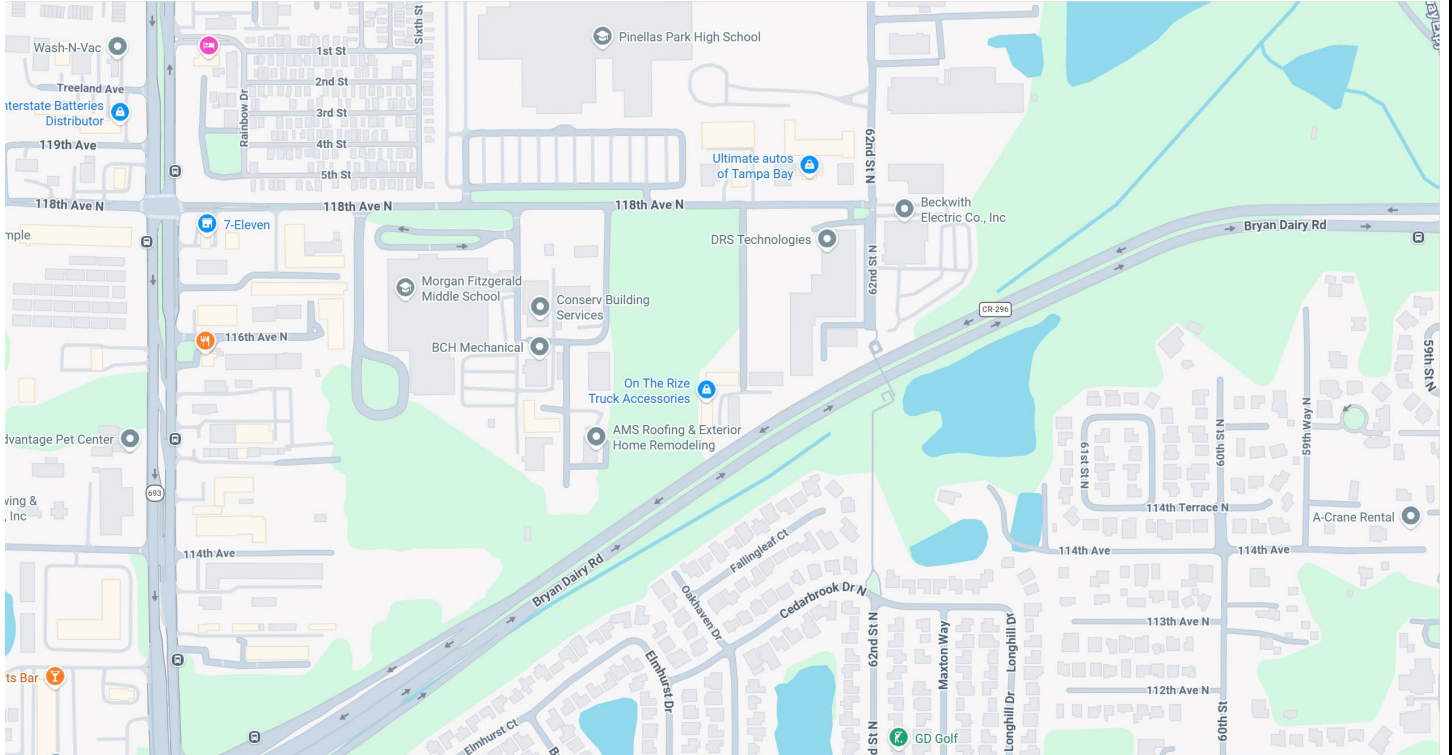

**The information contained herein was gathered from sources believed reliable;
however, RaJoKa Realty, LLC., or its agents, cannot be responsible for errors,
omissions, changes, withdrawal. Please verify all information.**

**6270 118th Ave N.
Pinellas Park, FL 33773**



**The information contained herein was gathered from sources believed reliable;
however, RaJoKa Realty, LLC., or its agents, cannot be responsible for errors,
omissions, changes, withdrawal. Please verify all information.**

**6270 118th Ave N.
Pinellas Park, FL 33773**



**The information contained herein was gathered from sources believed reliable;
however, RaJoKa Realty, LLC., or its agents, cannot be responsible for errors,
omissions, changes, withdrawal. Please verify all information.**

**6270 118th Ave N.
Pinellas Park, FL 33773**



**The information contained herein was gathered from sources believed reliable;
however, RaJoKa Realty, LLC., or its agents, cannot be responsible for errors,
omissions, changes, withdrawal. Please verify all information.**

**6270 118th Ave N.
Pinellas Park, FL 33773**



**The information contained herein was gathered from sources believed reliable;
however, RaJoKa Realty, LLC., or its agents, cannot be responsible for errors,
omissions, changes, withdrawal. Please verify all information.**

**6270 118th Ave N.
Pinellas Park, FL 33773**

1,600 sq ft Warehouse

**16' - 18' ceilings
Two separate 12' drive-in door(s)
3' wide walk in door
LED high bay lighting
Recently painted
24 hour access
On-site restrooms
6270 118th Ave N
Pinellas Park, FL 33773
(66th Street & Bryan Dairy)
\$2,400 per Month
Dimensions are an estimate and
warehouse sizes may vary slightly**

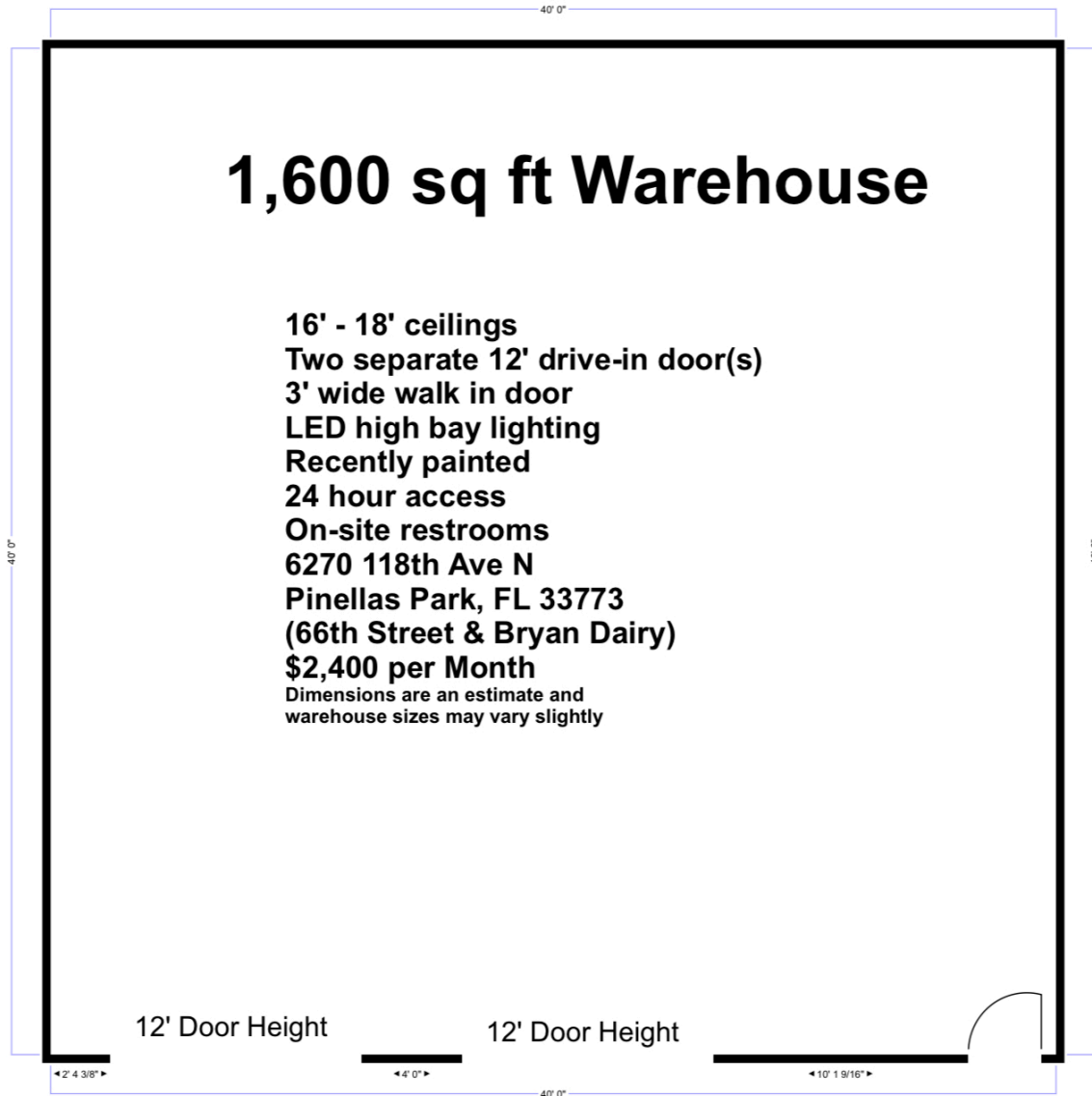

**The information contained herein was gathered from sources believed reliable;
however, RaJoKa Realty, LLC., or its agents, cannot be responsible for errors,
omissions, changes, withdrawal. Please verify all information.**

**6270 118th Ave N.
Pinellas Park, FL 33773**

Small Workshop

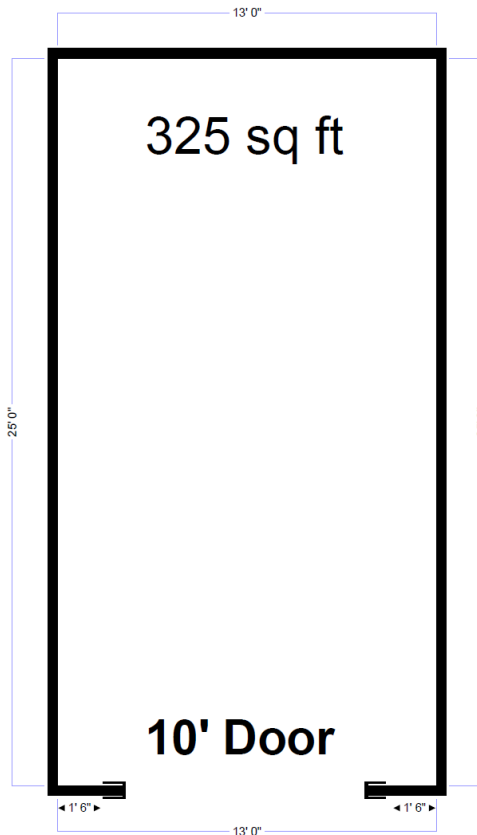

10' drive-in door
12' - 14' ceilings
LED high bay lighting
Recently painted
24 hour access
On-site restrooms
6270 118th Ave N
Pinellas Park, FL 33773
(66th Street & Bryan Dairy)

Dimensions are an estimate and
workshop sizes may vary slightly

**The information contained herein was gathered from sources believed reliable;
however, RaJoKa Realty, LLC., or its agents, cannot be responsible for errors,
omissions, changes, withdrawal. Please verify all information.**

**6270 118th Ave N.
Pinellas Park, FL 33773**



Medium Workshop

**10' drive-in door(s)
12' - 14' ceilings
LED high bay lighting
Recently painted
24 hour access
On-site restrooms
6270 118th Ave N
Pinellas Park, FL 33773
(66th Street & Bryan Dairy)**

Dimensions are an estimate and
workshop sizes may vary slightly

10' Door Height

10' Door Height

← 3' 4" →

26' 0"

**The information contained herein was gathered from sources believed reliable;
however, RaJoKa Realty, LLC., or its agents, cannot be responsible for errors,
omissions, changes, withdrawal. Please verify all information.**

**6270 118th Ave N.
Pinellas Park, FL 33773**

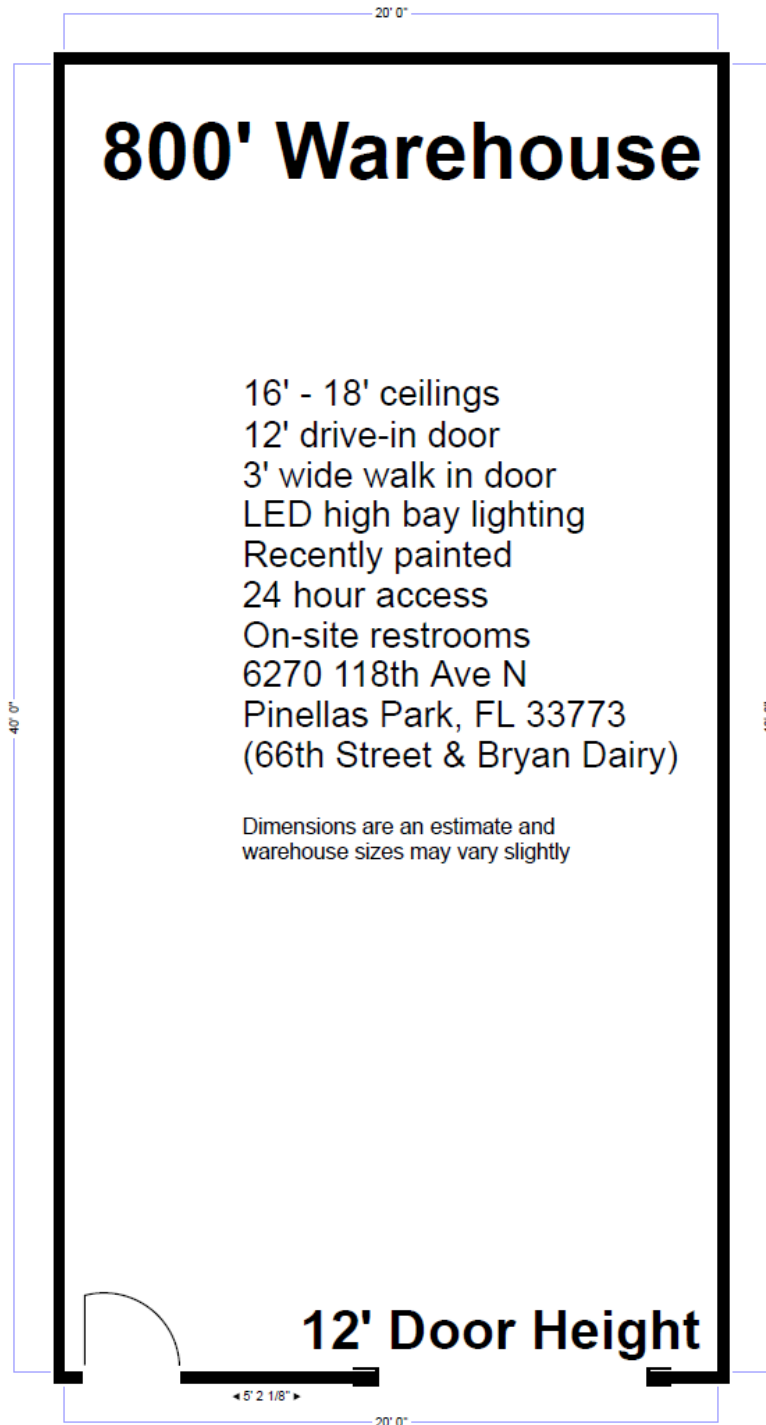

800' Warehouse

16' - 18' ceilings
12' drive-in door
3' wide walk in door
LED high bay lighting
Recently painted
24 hour access
On-site restrooms
6270 118th Ave N
Pinellas Park, FL 33773
(66th Street & Bryan Dairy)

Dimensions are an estimate and
warehouse sizes may vary slightly

12' Door Height

**The information contained herein was gathered from sources believed reliable;
however, RaJoKa Realty, LLC., or its agents, cannot be responsible for errors,
omissions, changes, withdrawal. Please verify all information.**