

**7501 W. Roosevelt Rd.**

**FOREST PARK, IL**

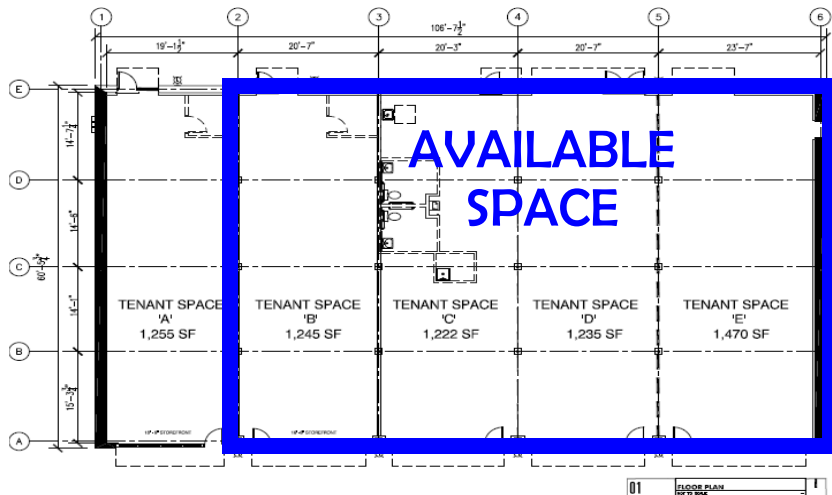

### Demographics

	<b>1 MILE</b>
Population	20,299
Number of Household	8,482
Average Household Income	\$ 71,401

	<b>3 MILES</b>
Population	242,005
Number of Household	90,495
Average Household Income	\$ 75,059

	<b>5 MILES</b>
Population	668,763
Number of Household	229,433
Average Household Income	\$ 67,927

### Leasing Information

Available space:	1,245 SF min 5,172 SF max
Lease Rate:	\$20.00 per square foot – Triple Net
Taxes/CAM:	\$9.00 per square foot
Building Size:	6,427 square feet
Parking space:	25 spaces

### Building Features

- One story building
- Newer construction

### Area Features

- 1 Mile to Eisenhower Expressway, I-290

