

# 2447 THIRD AVENUE

CORNER OF EAST 135TH & THIRD AVENUE | MOTT HAVEN



# 2447 THIRD AVENUE

CORNER OF EAST 135TH & THIRD AVENUE | MOTT HAVEN

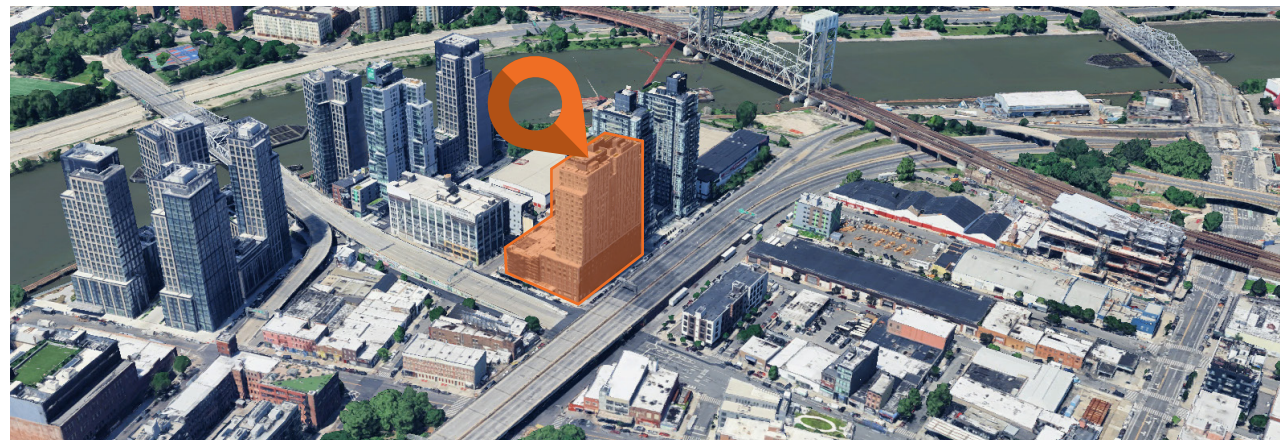

SIZE: 9,512 SF Ground Floor

FRONTAGE: 100'+

CEILING HEIGHT: 12.5'

POSSESSION: Arranged

ASKING RENT: Upon Request

TRANSPORTATION: **4 5 6**

HIGHLIGHTS:

- New development
- Space is divisible
- Drive-in possible
- High pressure gas
- Highly visible frontage on Third Avenue
- Over 3,000 new apartment developments in the area
- Neighboring tenants include: *787 Coffee, Comfort Inn, Cubesmart, The Arches, Dunkin', Equis Fitness, Chase, Shell, Volkswagon, Popeyes, McDonald's, & many more!*



All information supplied in this marketing presentation and/or flyer is from sources deemed reliable and is furnished subject to errors, omissions, modifications, removal of listings from sale/lease and to any listing condition. Any square footage, dimensions, floor plans and/or technical data set forth are approximations and are subject to further elaboration/confirmation.

# 2447 THIRD AVENUE

CORNER OF EAST 135TH & THIRD AVENUE | MOTT HAVEN

FLOOR PLAN DIVISION:  
OPTION 1



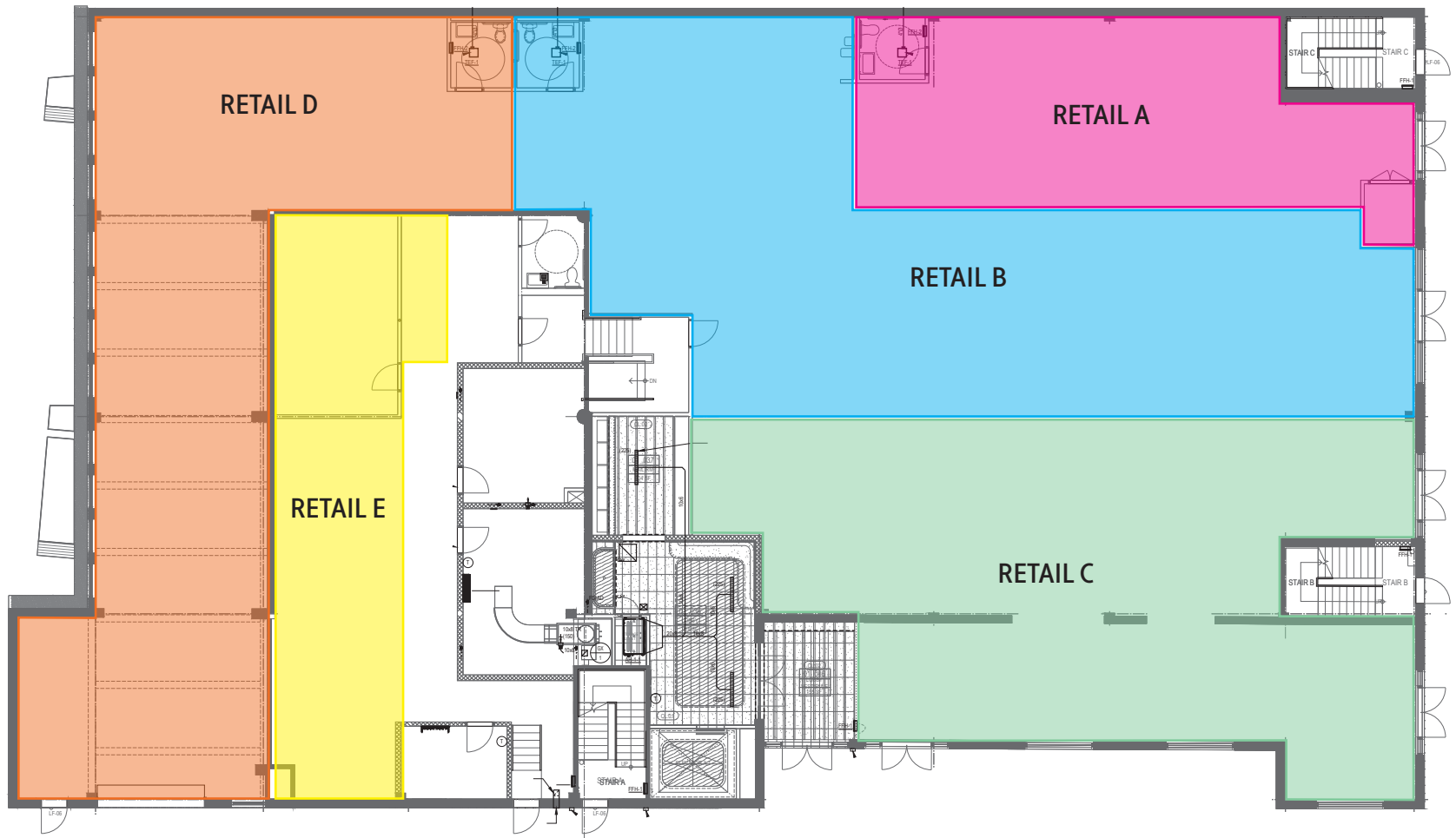

- RETAIL A**  
1,247 SF
- RETAIL B**  
2,900 SF
- RETAIL C**  
2,800 SF
- RETAIL D**  
2,600 SF
- RETAIL E**  
1,250 SF



# 2447 THIRD AVENUE

CORNER OF EAST 135TH & THIRD AVENUE | MOTT HAVEN

FLOOR PLAN DIVISION:  
OPTION 2

-  **RETAIL A**  
1,247 SF
-  **RETAIL B**  
5,700 SF
-  **RETAIL C**  
2,600 SF
-  **RETAIL D**  
1,250 SF

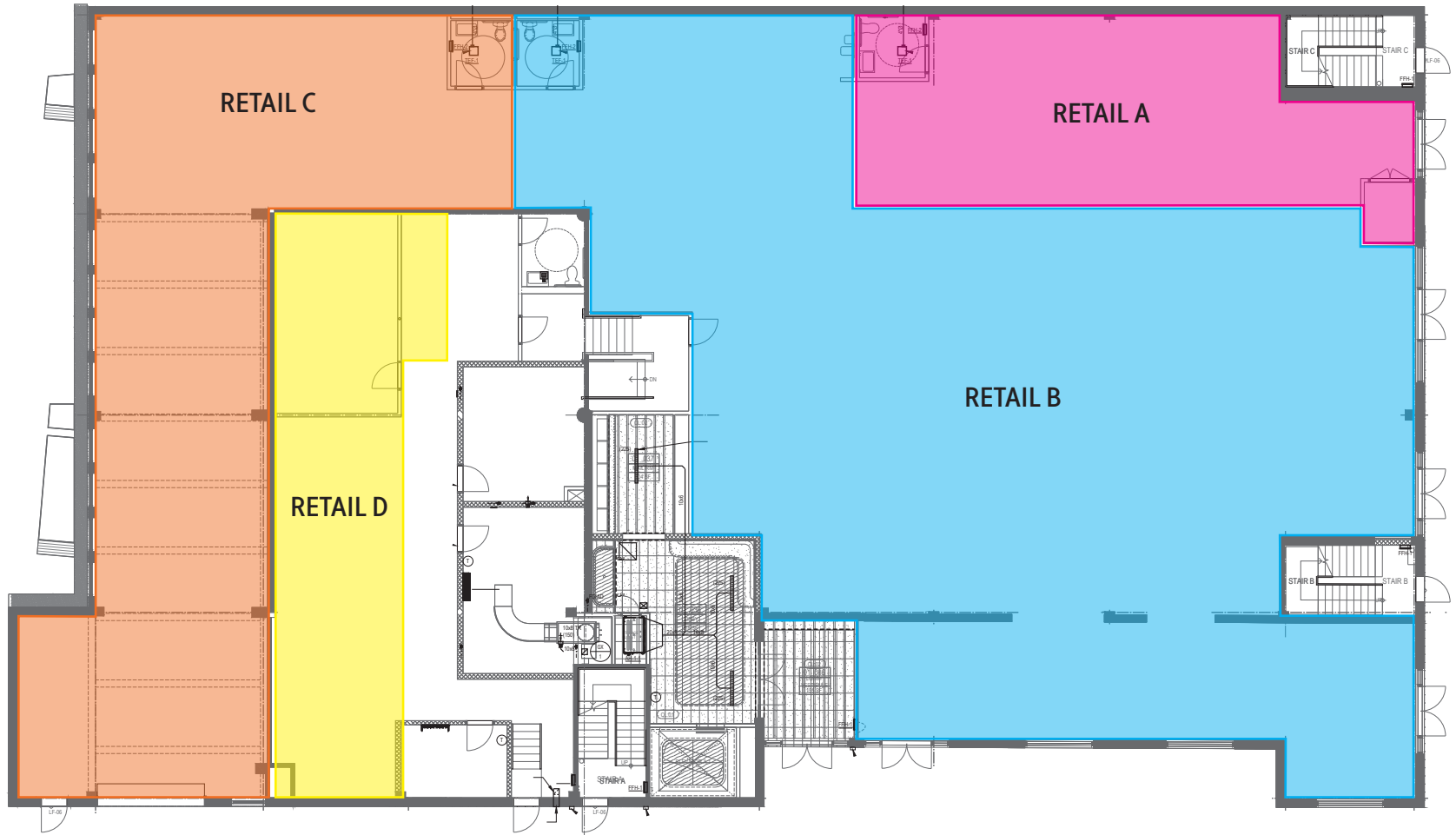

# 2447 THIRD AVENUE

CORNER OF EAST 135TH & THIRD AVENUE | MOTT HAVEN



# 2447 THIRD AVENUE

CORNER OF EAST 135TH & THIRD AVENUE | MOTT HAVEN

FOR MORE INFORMATION,  
PLEASE CONTACT:

**MILES SABBAGH**

646.894.3176 | Miles@ksrny.com

**JACK HAMADANI**

718.415.0095 | JHamadani@ksrny.com

**MARC SITT**

917.757.8863 | MSitt@ksrny.com

