

INDUSTRIAL FOR SUBLEASE

Marymoor Business Park

17725 NE 65th Street | Redmond, WA 98052



2,400 Square Feet
\$23.00/RSF, plus Utilities
Available Immediately



Dan Krekel, CCIM
(425) 586-4655
dkrekel@leibsohn.com

Maxton MacLachlan
(425) 586-4659
mmaclachlan@leibsohn.com

Marymoor Business Park

FOR SUBLEASE

Property Highlights



Nearby restaurants & various retail amenities



Excellent Access to SR-520



2 Grade Level Loading Doors



Next door to Marymoor Park



Marymoor Business Park

FOR SUBLEASE

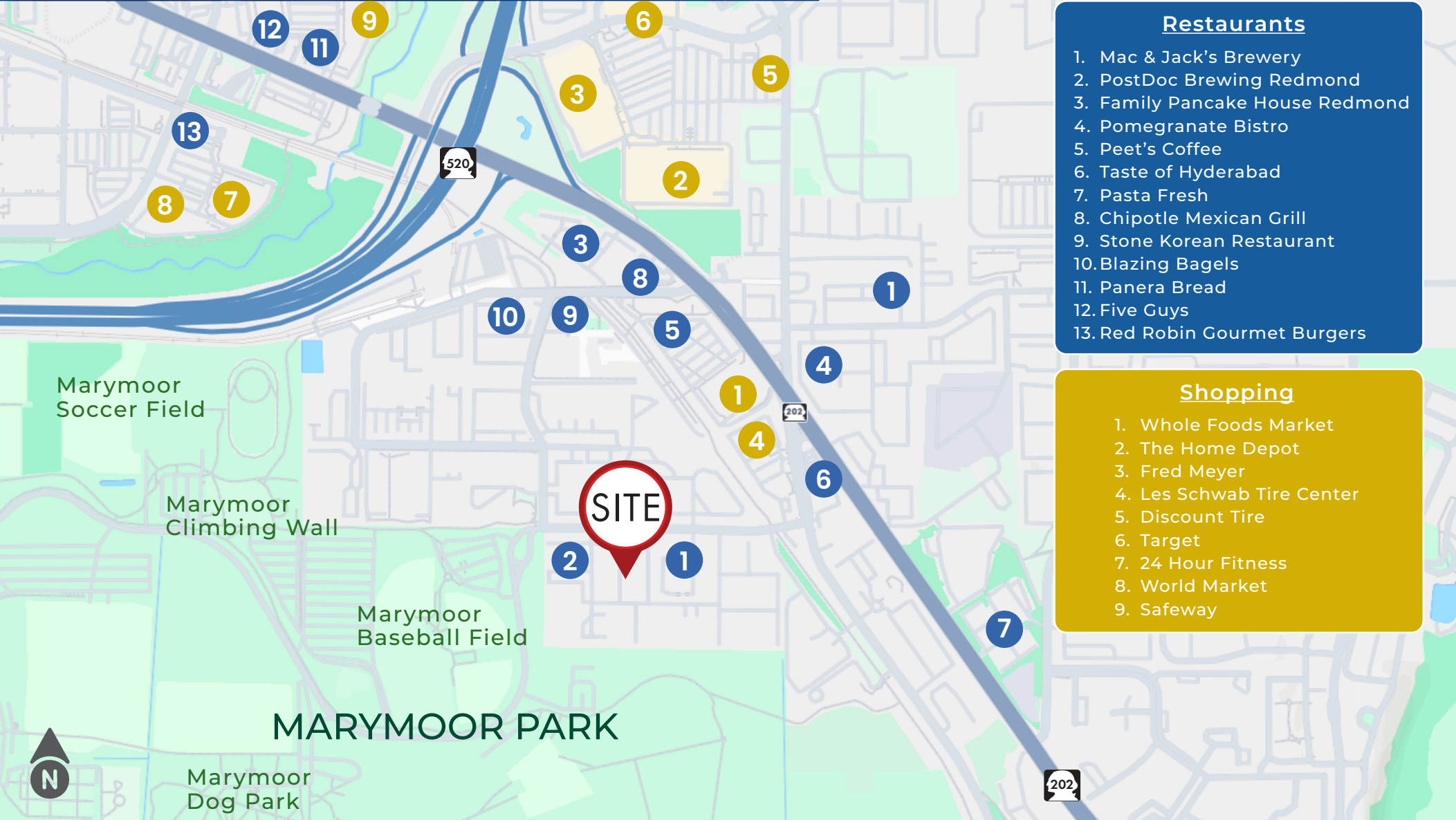

Suite A175 | 2,400 RSF

- *Sublease Term Thru June 30, 2027*
- Base Rate: \$23.00/RSF
- Est Utilities: \$3.50/RSF
- Available Immediately
- Current Martial Arts Space
- Corner Suite
- 2 Grade-Level Roll Up Doors

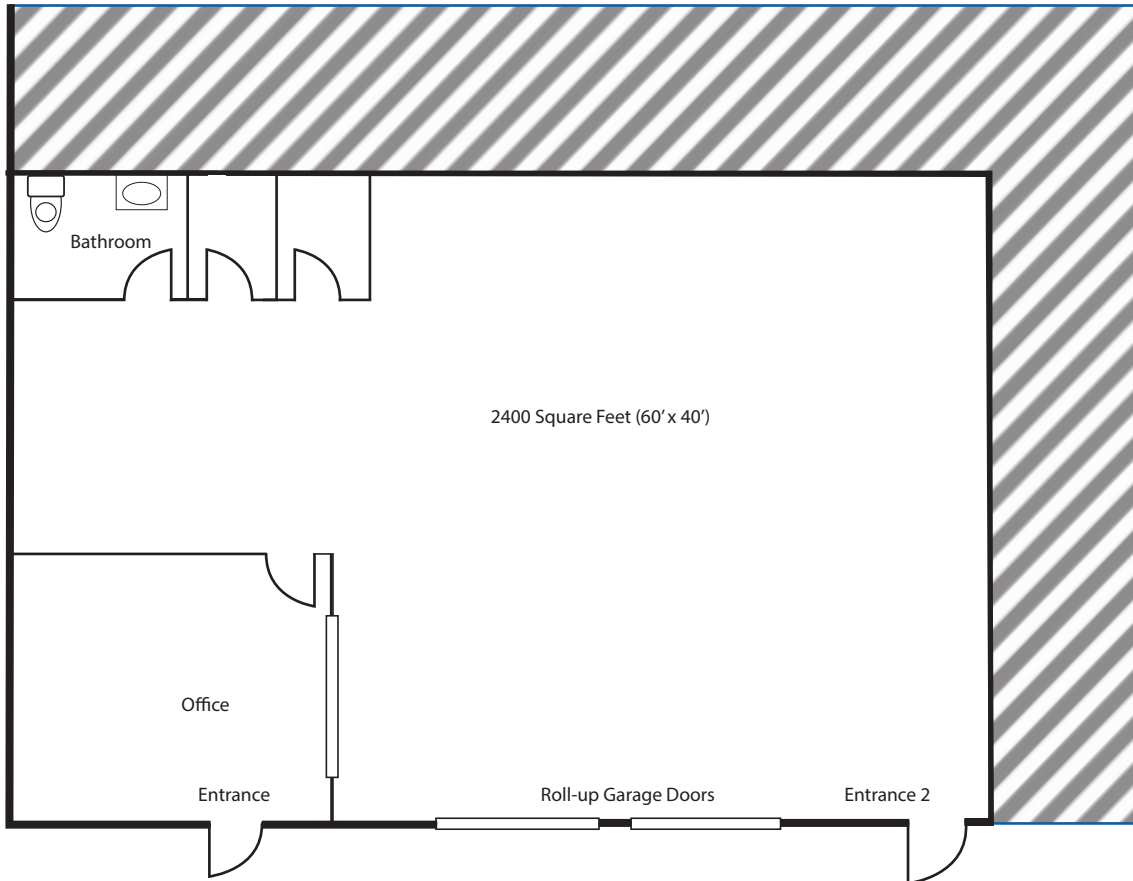

Marymoor Business Park

FOR SUBLEASE



Marymoor Business Park

17725 NE 65th Street | Redmond, WA 98052

Dan Krekel

Senior Vice President • Leibsohn & Company
(425) 586-4655 | dkrekel@leibsohn.com

Maxton MacLachlan

Associate Vice President • Leibsohn & Company
(425) 586-4659 | mmaclachlan@leibsohn.com

THE INFORMATION CONTAINED HEREIN HAS BEEN RECEIVED FROM SOURCES WE DEEM RELIABLE. WHILE WE HAVE NO REASON TO DOUBT ITS ACCURACY, WE DO NOT GUARANTEE IT. YOU ARE ADVISED TO INDEPENDENTLY VERIFY ALL INFORMATION.
COPYRIGHT Leibsohn & Company

