

**1701 LORETTA AVENUE**  
FEASTERVILLE-TREVOSE, PA

AVAILABLE FOR LEASE  
**INDUSTRIAL PROPERTY**

7,595 SF  
UNIT B

## PROPERTY HIGHLIGHTS

- **Unit B:**  
7,595 SF
- **Ceiling Height:**  
20' clear
- **Docks:**  
One (1) 10' x 8'
- **Drive-ins:**  
One (1) 14' x 12'
- **Zoning:**  
Business Technology (Lower Southampton Township)
- **Taxes:**  
\$39,542.99 (Estimated 2024)
- **Location:**  
Convenient location in Feasterville, with easy access to PA 132 (Street Road), Interstate 276 (Pennsylvania Turnpike), US Route 1, and bridges to New Jersey. The property is served by SEPTA Bus Route 58.

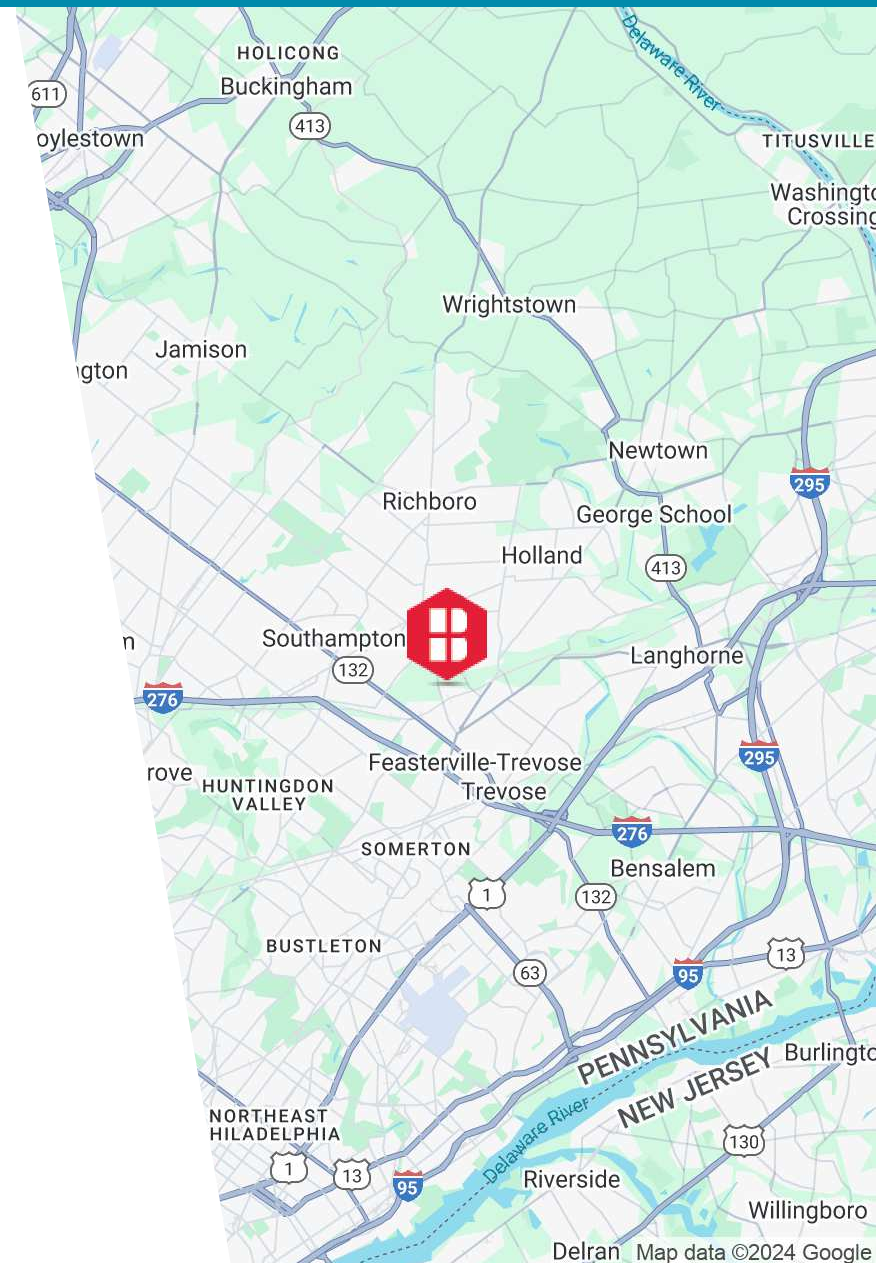



## UNIT B

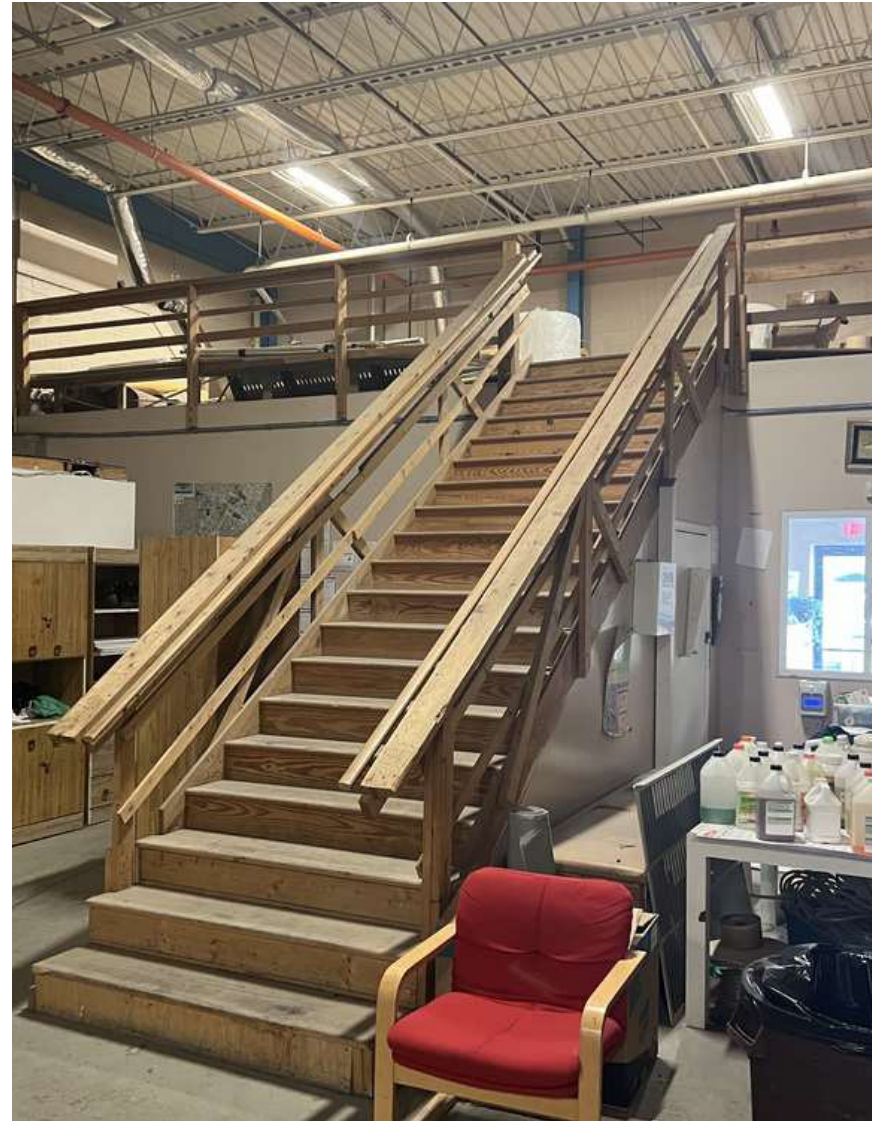



# DEMOGRAPHICS MAP & REPORT

## POPULATION

	1 MILE	5 MILES	10 MILES
Total Population	5,558	225,387	988,724
Average Age	44	44	43
Average Age (Male)	43	43	41
Average Age (Female)	45	45	44

## HOUSEHOLDS & INCOME

	1 MILE	5 MILES	10 MILES
Total Households	2,047	84,878	376,685
# of Persons per HH	2.7	2.7	2.6
Average HH Income	\$142,325	\$127,978	\$121,760
Average House Value	\$452,684	\$437,829	\$391,498

*Demographics data derived from AlphaMap*

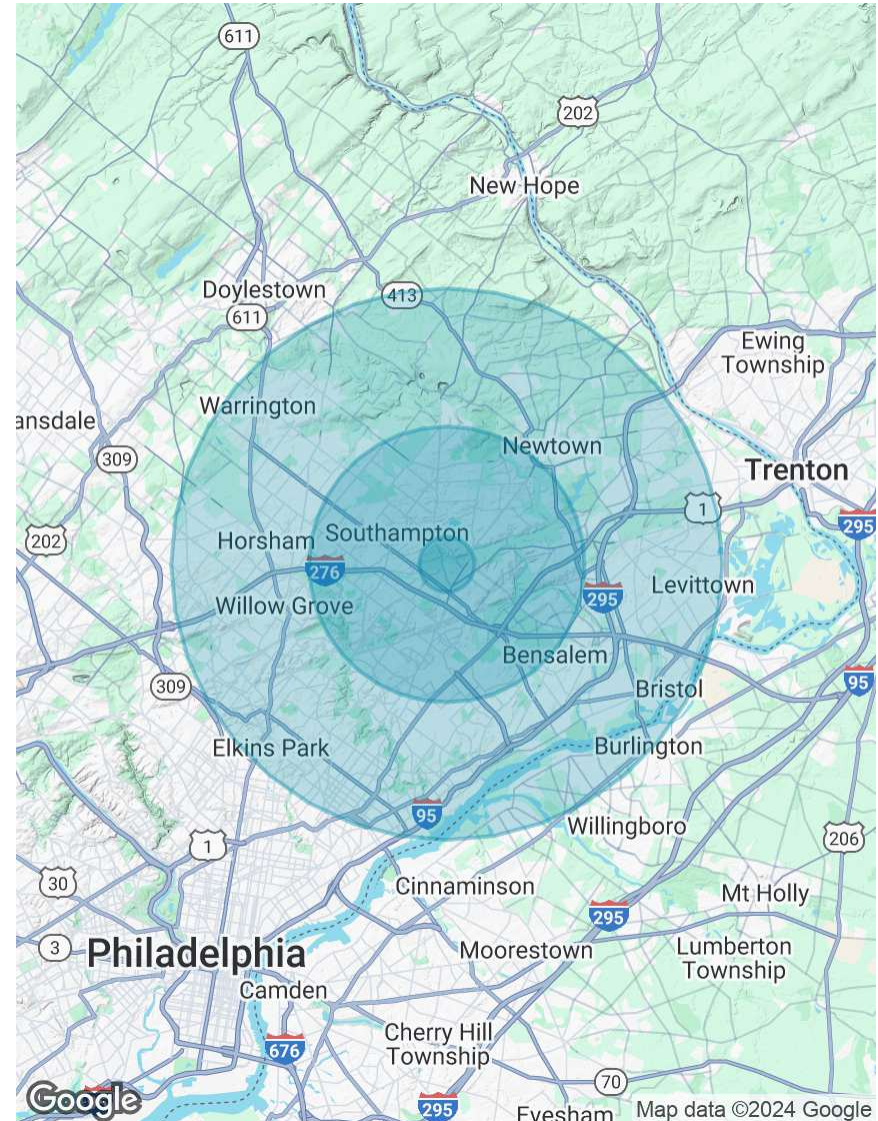

# CONTACT



**Christopher Pennington**  
Partner & Senior Vice President  
**215.448.6053**  
cpennington@binswanger.com



**Jason Ostach**  
Vice President  
**215.448.6021**  
jostach@binswanger.com



Three Logan Square  
1717 Arch Street, Suite 5100  
Philadelphia, PA 19103  
Phone: 215.448.6000  
binswanger.com

The information contained herein is from sources deemed reliable, but no warranty or representation is made as to the accuracy thereof and no liability may be imposed.