

LEASE
2215 W 2200 S
WEST VALLEY CITY, UTAH

ADVENT
PROPERTY ADVISORS

**DECKER LAKE
WAREHOUSE**
\$.60 PSF MG



PROPERTY DETAILS

Total Size: 18,615 SF
Office: 1,413 SF
Warehouse: 17,202 SF
Ceiling: 17' Clear
Doors: (1) 12'x12' GL (3) 12'x12' DH
Power: 225 A | 208V | 3 Phase
Zoning: M

HIGHLIGHTS

- Small fenced and paved yard (approximately 15,000 SF)
- Fire sprinkled
- Skylight in warehouse
- Column spacing: 25' x 40'



CONTACT

Bob Mills **Riley Mills**
385.988.6477 385.988.6478
bob@adventut.com riley@adventut.com

This information has been secured from sources Advent believes to be reliable. Advent makes no representations or warranties, expressed or implied, as to the accuracy of the information. Buyer to verify the information and bares all risk for inaccuracies.

ADVENT
PROPERTY ADVISORS

5284 S. Commerce Dr. #C 274, Murray, Utah 84107 | o:801.433.2480 f:801.290.3172

Floor Plan

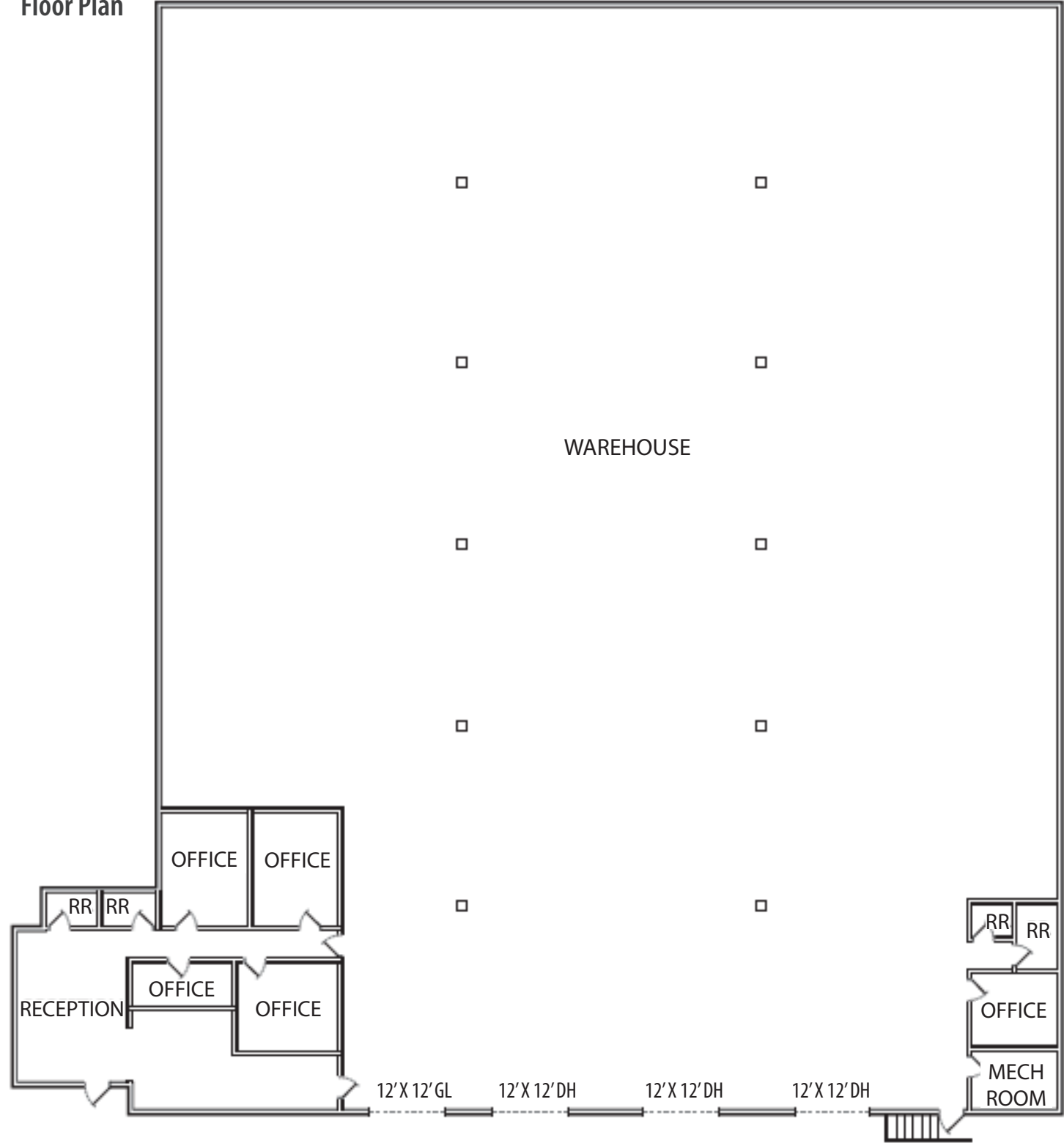

This information has been secured from sources Advent believes to be reliable. Advent makes no representations or warranties, expressed or implied, as to the accuracy of the information. Buyer to verify the information and bares all risk for inaccuracies.