



# Industrial Space For Lease

## Highlights

- > Full HVAC in warehouse
- > Hard to find small unit
- > Wadsworth visibility

## 1460-1470 S. Wadsworth Blvd. Lakewood, CO 80232

Unit 1470:	1,600 SF
Office:	750 SF
Warehouse:	850 SF
Lease Rate:	\$9.95/SF NNN
Expenses:	\$9.41/SF
Ceiling Height:	12' - Presently Dropped Ceiling
Power:	TBD
Loading:	One (1) Drive-In - 10'x10'
Zoning:	M-N-S
Parking:	Ample

This communication has been prepared by Colliers Denver for advertising and/or general information only. Colliers Denver makes no guarantees, representations or warranties of any kind, expressed or implied, regarding the information including, but not limited to, warranties of content, accuracy and reliability. Any interested party should undertake their own inquiries as to the accuracy of the information. Colliers Denver excludes unequivocally all inferred or implied terms, conditions and warranties arising out of this document and excludes all liability for loss and damages arising there from. This publication is the copyrighted property of Colliers Denver and/or its licensor(s). © 2023. All rights reserved. This communication is not intended to cause or induce breach of an existing listing agreement.

1,600 SF

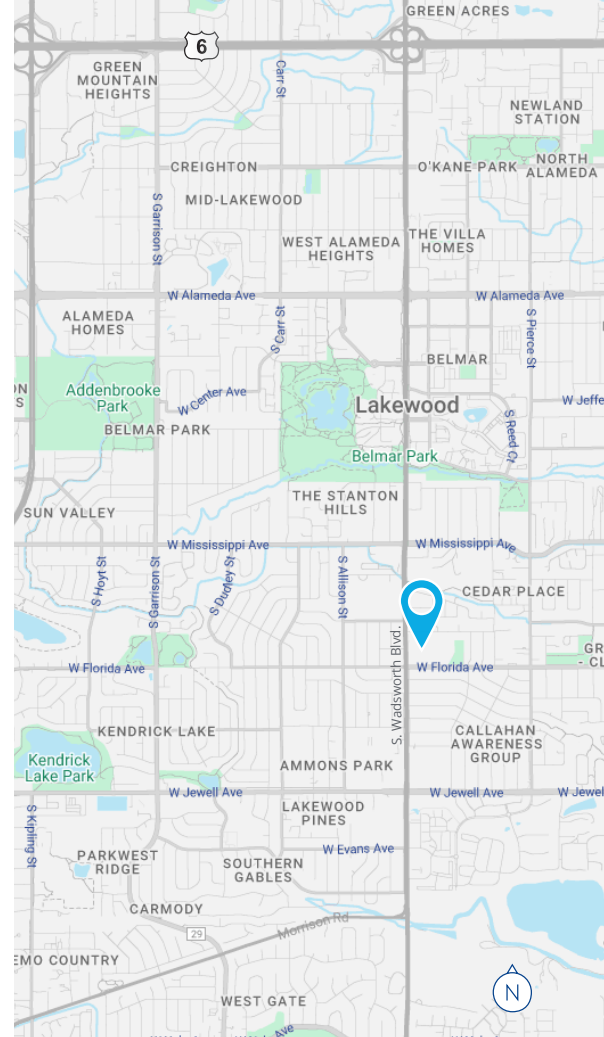
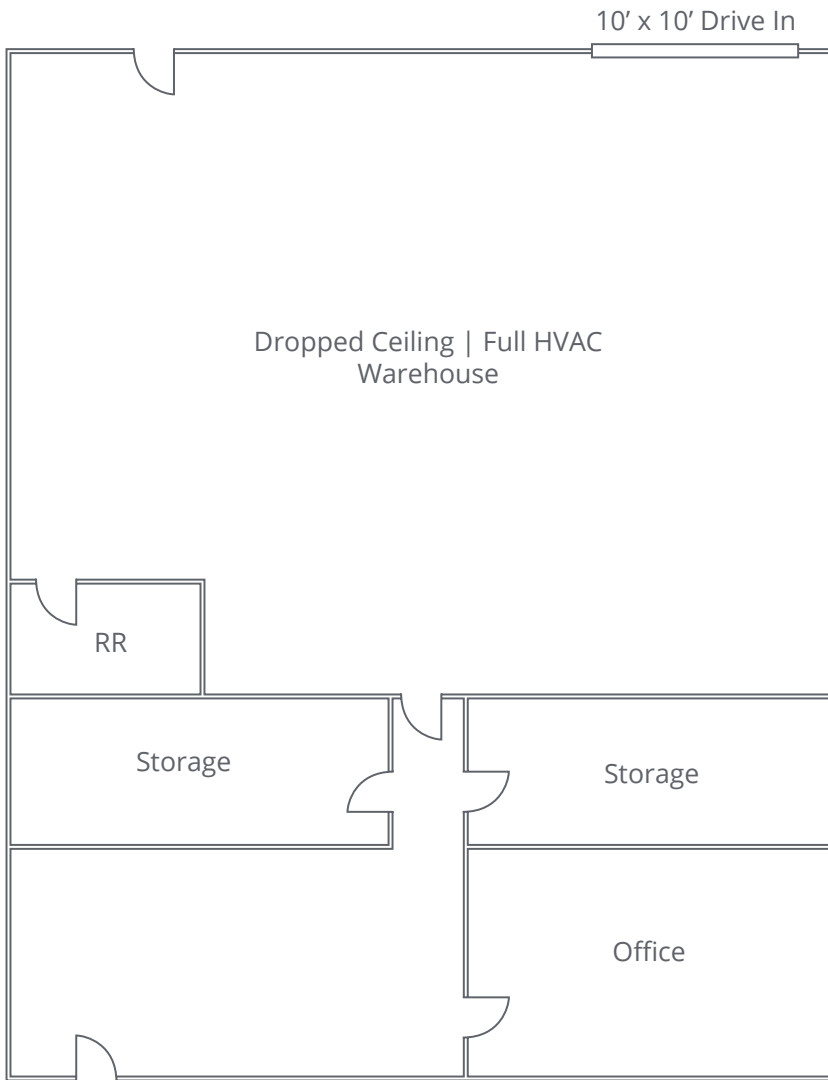

Contact us:

Tim Shay

+1 303 283 4594

tim.shay@colliers.com



Brokerage Disclosure

Colliers

4643 S. Ulster Street, Suite 1000

Denver, CO 80237

P: +1 303 745 5800

F: +1 303 745 5888

colliers.com/denver

