

The Colliers logo is located in the top right corner of the image. It consists of the word "Colliers" in a white serif font, set against a dark blue rectangular background with a thin yellow and red horizontal stripe at the bottom.The background of the entire advertisement is a photograph of a modern, three-story office building with a large glass facade. The building has a grey concrete frame and is surrounded by a parking lot and some landscaping. The sky is a mix of blue and pinkish-purple, suggesting a sunset or sunrise. The building's name "CFS" is visible on the upper part of the facade.

For Lease CFS Building

3001 Executive Drive
Clearwater, FL 33762

- Three-story 62,936 SF office building with two-story lobby
- Newly renovated common areas
- 5/1,000 parking ratio
- On-site building maintenance

CFS Building



Property Highlights

Superior Pinellas Gateway location:

- Easy access to I-275 & airports
- At intersection of all points of Tampa Bay

Perfect Office Environment:

- Abundant shaded parking
- Natural light and fresh spaces
- Functional floor plans
- Multiple road access
- Attractive to targeted workforce
- Cluster effect of suppliers

Available Spaces

- Suite 200 6,539 rsf
- Suite 240 3,878 rsf
- Suite 260 5,173 rsf
- Suite 275 981 rsf
- Suite 280 2,119 rsf
- Suite 340 10,580 rsf

Lease Rate

- \$23.50/SF, Full Service

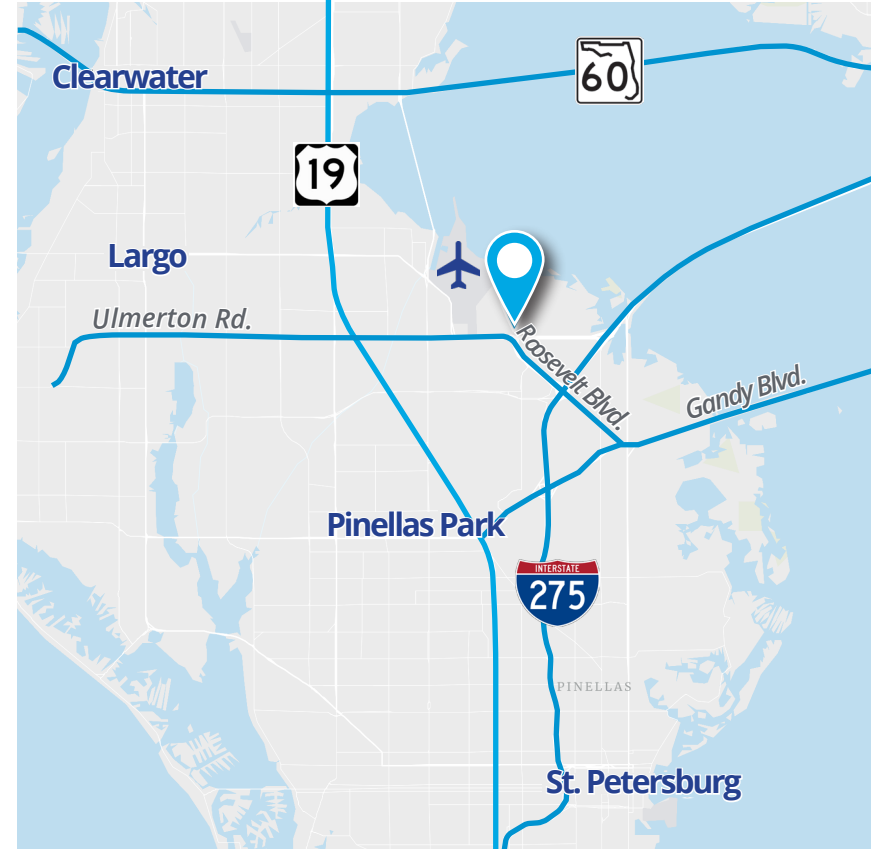

Strong demographic profile and deep employment pool



Home to the region's top employers



Highly accessible to regional transportation

Floorplan - 2nd level

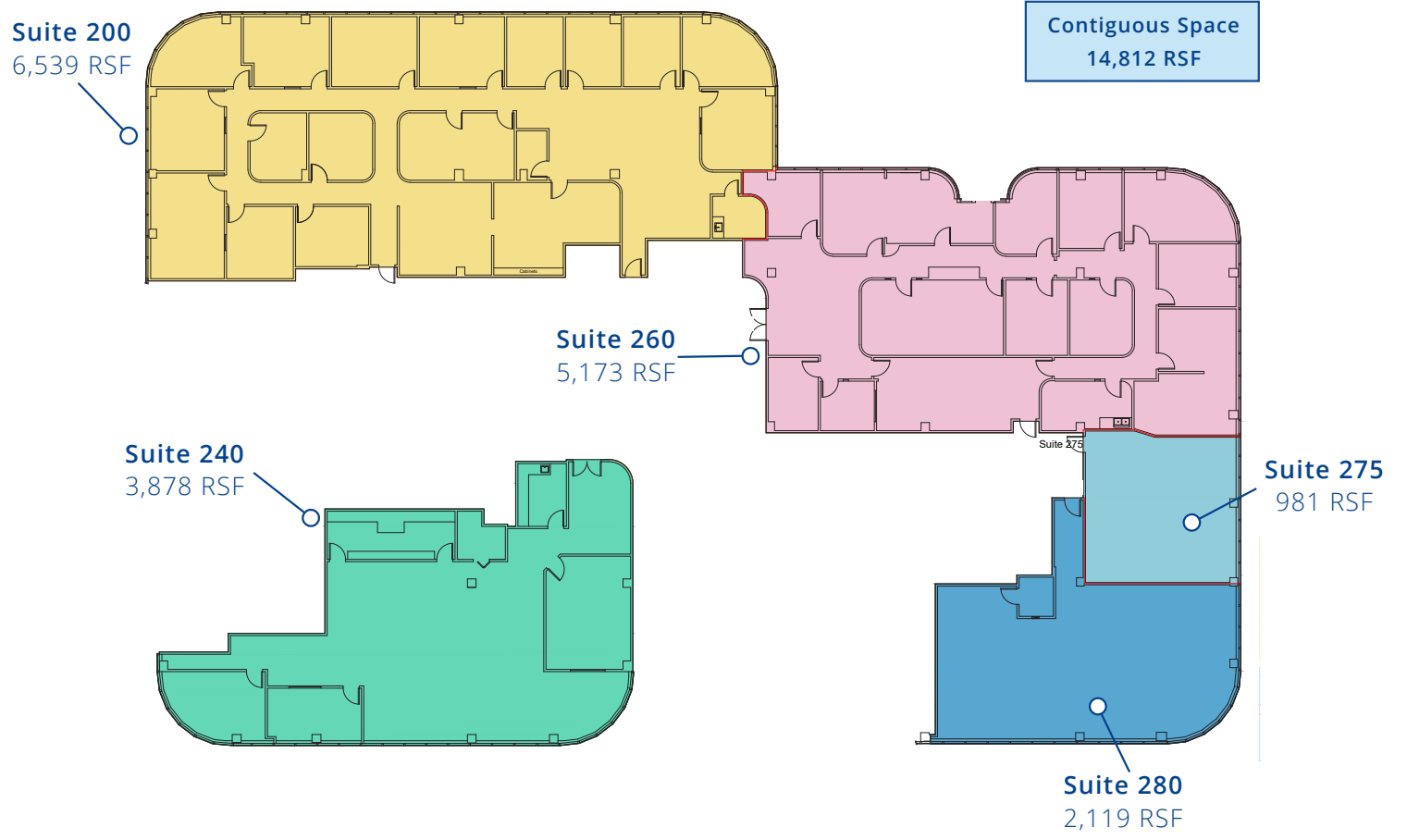

Floorplan - 3rd level

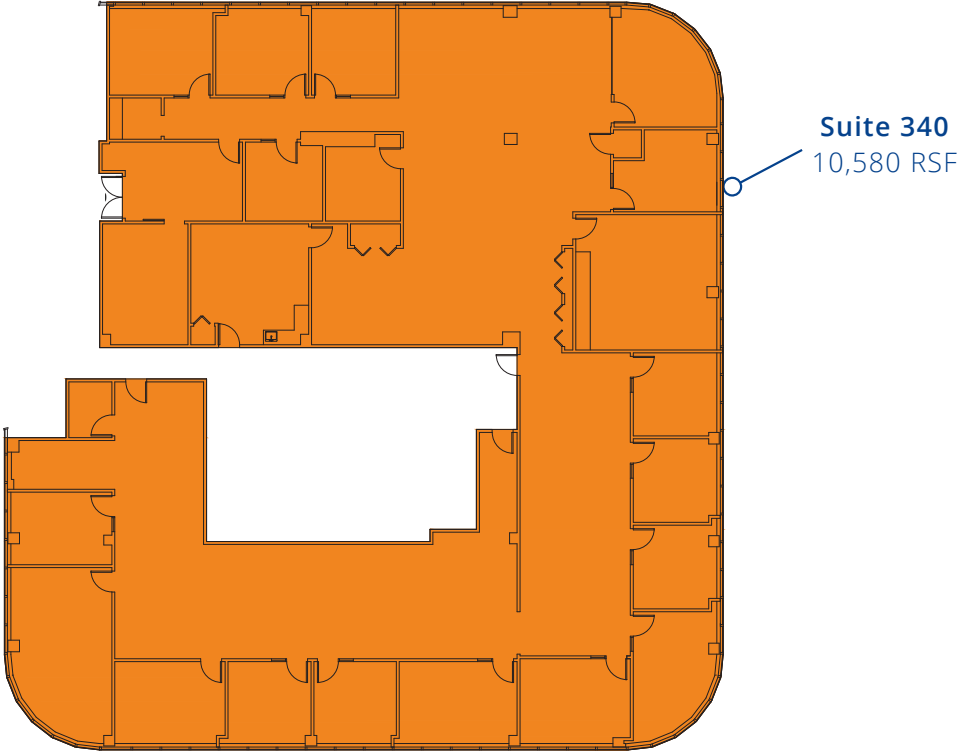

Suite 340
10,580 RSF

CFS Building Major Employers

Within 3.5-Mile Radius

Pinellas Gateway: Home to Some of Tampa Bay's Largest Employers

Twenty-two companies within 3.5 miles of the CFS Building have annual revenue of \$100M or more and up to 2,800 employees.

#	Company Name
1	Tech Data Corp
2	Jabil, Inc.
3	General Dynamics Ordnance & Tactical Systems
4	Raymond James Financial, Inc.
5	HSN, Inc.
6	Power Design
7	Compulink Cable Assemblies, Inc.
8	Arthur Rutenberg Homes
9	Pinch A Penny, Inc.
10	US Ameri Bancorp, Inc.
11	Catalent
12	Valpak Direct Marketing Systems
13	Raymond James Bank NA
14	Digital Media Solutions
15	CCS Medical, Inc.
16	Signature Aviation
17	APG Electric, Inc.
18	DRS Technologies/Leonardo DRS
19	e-TeleQuote Insurance, Inc.
20	PODS LLC
21	PODS
22	Salon Centric

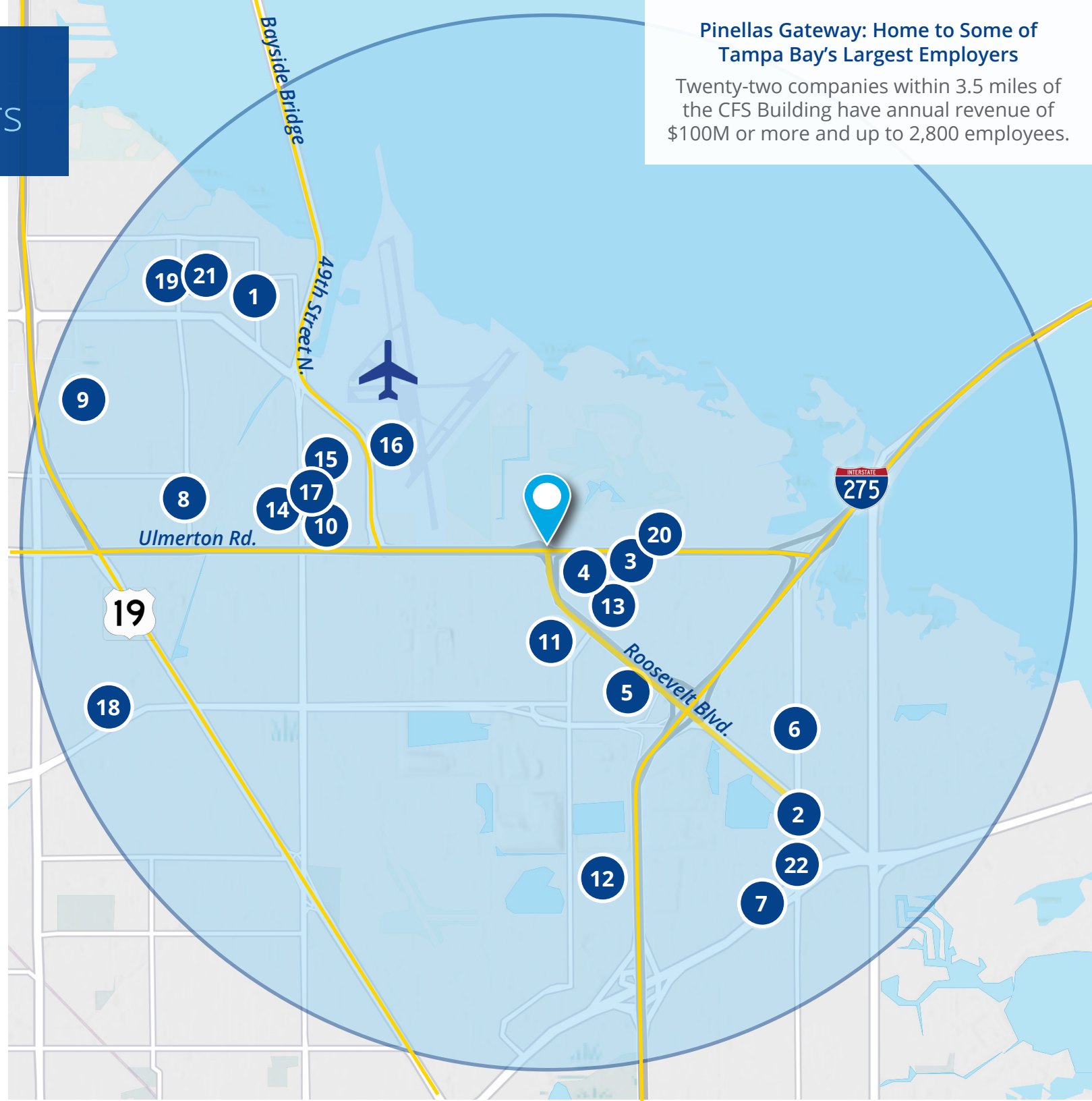



Scan to view the complete listing

Questions? Want to schedule a tour?
Contact Me!

Paula Clair Smith, CCIM
Senior Vice President | Tampa Bay
727 409 5539 Direct
paulaclair.smith@colliers.com



311 Park Place Blvd., Suite 600
Clearwater, FL 33759
727 442 7184
www.colliers.com

