

For Sale

# Lakeside Dr. & Lakeside Ct.



LOGIC



3480 Lakeside Ct.  
Reno, NV 89509

**Michael Keating, SIOR**  
Partner  
775.386.9727  
mkeating@logicCRE.com  
S.0174942

**Michael Dorn**  
Senior Associate  
775.453.4436  
mdorn@logicCRE.com  
S.0189635



Listing Snapshot



**\$3,725,000**  
Sale Price



**± 21,282 SF**  
Total Square Footage



**\$175 PSF**  
Price Per Square Foot

Property Highlights

- Owner-User or Value Add Investment Opportunity
- Priced well below replacement cost
- GC Zoning
- Easy access to Midtown & Downtown
- Diverse suite sizes
- On-site parking
- New exterior renovations recently completed

Demographics

	1-mile	3-mile	5-mile
2025 Population	10,956	115,874	218,248
2025 Average Household Income	\$163,554	\$108,138	\$102,568
2025 Total Households	4,874	52,260	94,090













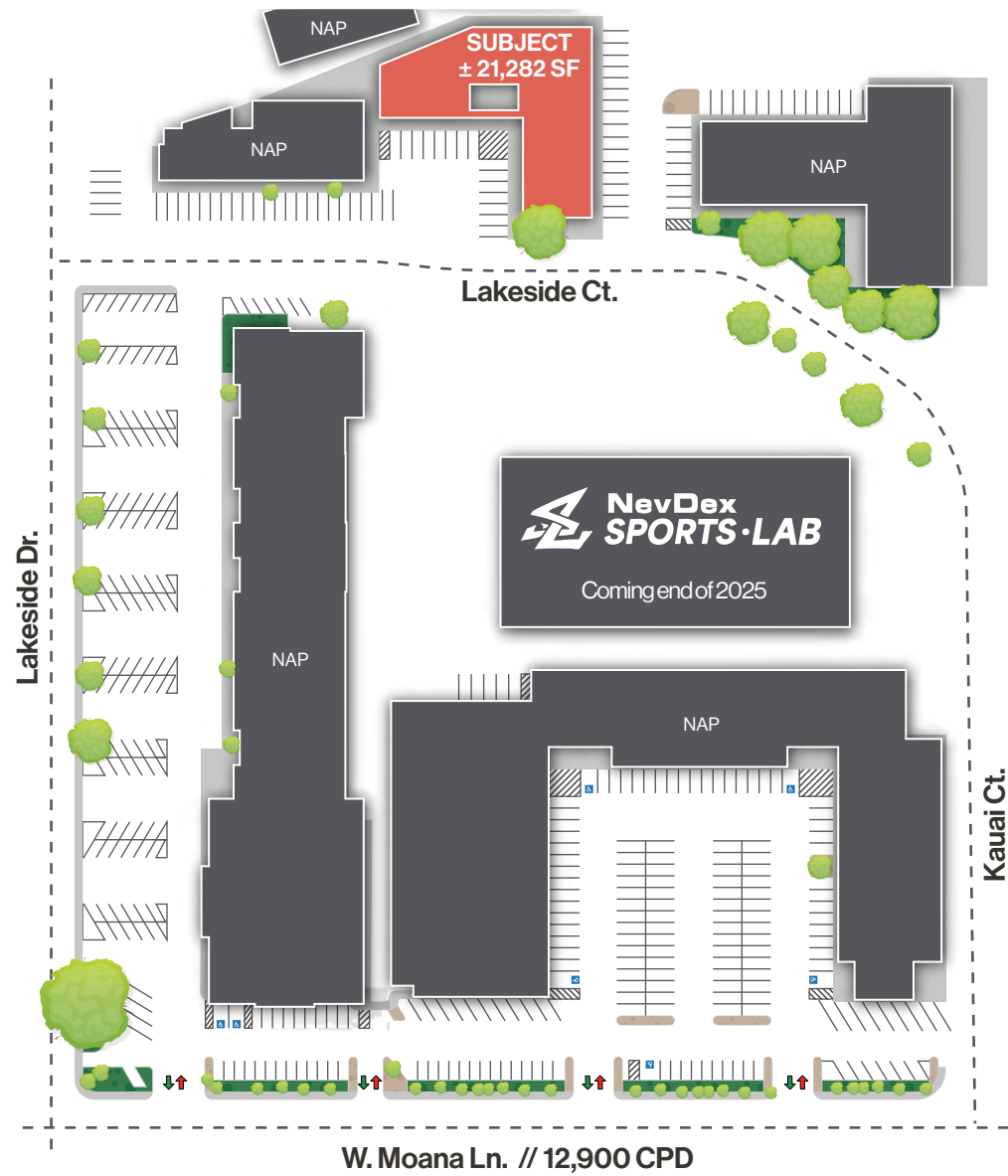

Floor Plan | First Floor

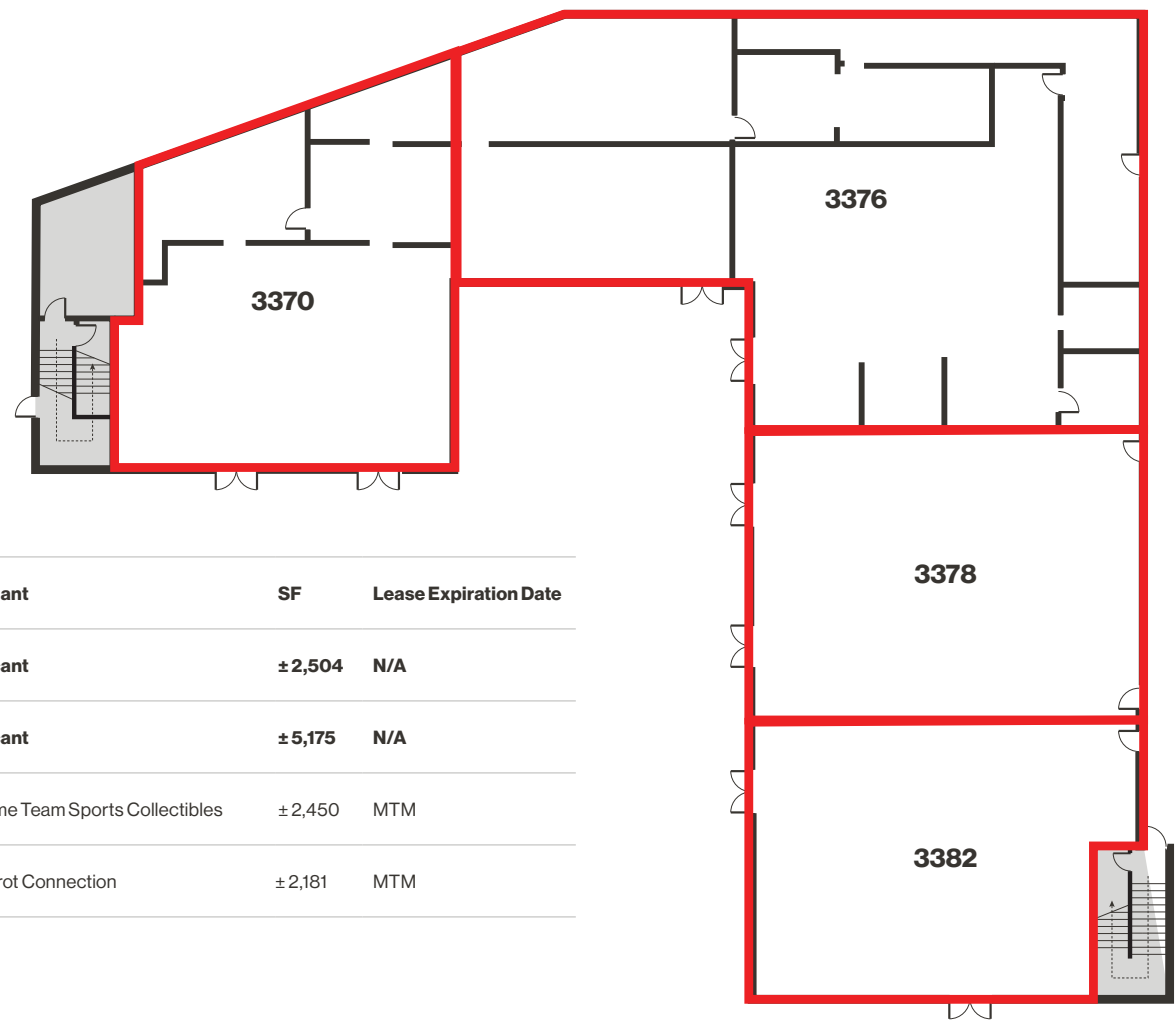

Suite	Tenant	SF	Lease Expiration Date
3370 Lakeside Ct.	Vacant	± 2,504	N/A
3376 Lakeside Ct.	Vacant	± 5,175	N/A
3378 Lakeside Ct.	Home Team Sports Collectibles	± 2,450	MTM
3382 Lakeside Ct.	Parrot Connection	± 2,181	MTM

Floor Plan | Second Floor

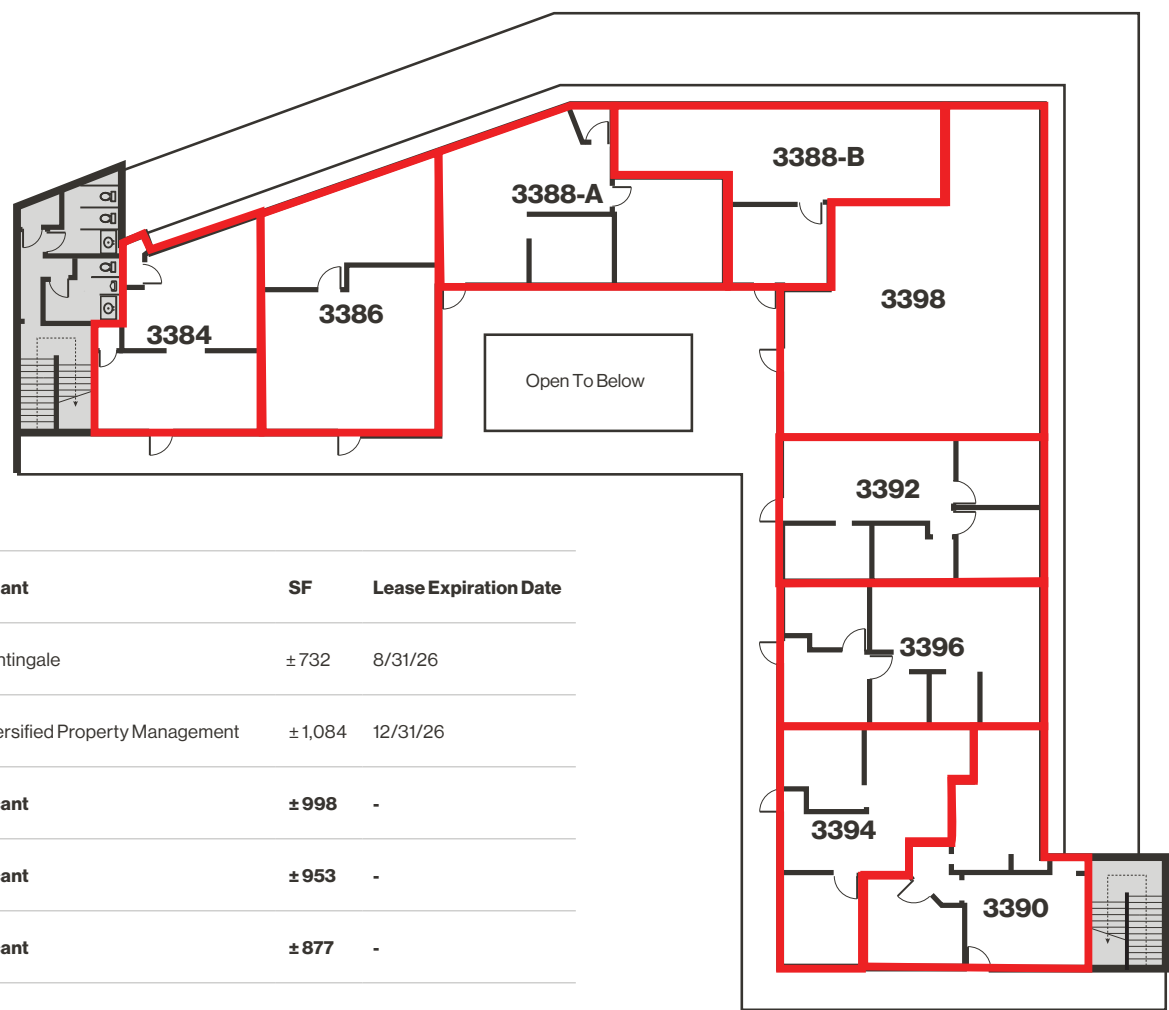

Suite	Tenant	SF	Lease Expiration Date
3384 Lakeside Ct.	Nightingale	± 732	8/31/26
3386 Lakeside Ct.	Diversified Property Management	± 1,084	12/31/26
3388-A Lakeside Ct.	Vacant	± 998	-
3388-B Lakeside Ct.	Vacant	± 953	-
3390 Lakeside Ct.	Vacant	± 877	-
3392 Lakeside Ct.	Vacant	± 943	-
3394 Lakeside Ct.	Arcadesma Architecture	± 794	MTM
3396 Lakeside Ct.	Vacant	± 947	-
3398 Lakeside Ct.	Vacant	± 1,644	-



Property Photos





# LOGIC Commercial Real Estate

## Specializing in Brokerage and Receivership Services



Join our email list and  
connect with us on LinkedIn

The information herein was obtained from sources deemed reliable; however LOGIC Commercial Real Estate makes no guarantees, warranties or representation as to the completeness or accuracy thereof.

For inquiries please reach out to our team.

**Michael Keating, SIOR**

Partner  
775.386.9727  
mkeating@logicCRE.com  
S.0174942

**Michael Dorn**

Senior Associate  
775.453.4436  
mdorn@logicCRE.com  
S.0189635