

RETAIL SPACE FOR LEASE AT EUCLID PLAZA CENTER



**1714-1740** **EUCLID AVENUE**  
SAN DIEGO, CA 92105

**BO GIBBONS**

Senior Vice President  
(858) 699-3458  
Bo@PacificCoastCommercial.com  
Lic. 01367936

**LEE SURYANI**

Associate Vice President  
(619) 210-5265  
Lee@PacificCoastCommercial.com  
Lic. 01384873

**PACIFIC COAST COMMERCIAL**

10721 Trenea Street, Suite 200  
San Diego, CA 92131  
(619) 469-3600  
www.PacificCoastCommercial.com  
Lic. 01209930



# PROPERTY DESCRIPTION



## PROPERTY

1714-1740 Euclid Avenue, San Diego, CA 92105  
Euclid Plaza Center: ± 20,335 SF on 2.1 AC



## AVAILABILITY

± 507 SF - 2,667 SF Retail Space  
Recently Renovated Vanilla Shell Suites



## SUITE SIZES

1726 Euclid Ave: ± 507 SF  
1730 Euclid Ave: ± 507 SF  
1740 Euclid Ave: ± 1,653 SF



## PARKING

Abundant Onsite Parking Available in Retail Center



## VISIBILITY

Building & Monument Signage Available  
25,000 Cars Per Day on Euclid Avenue



## TENANT IMPROVEMENTS

Including New Electric, HVAC and ADA Restroom



## ZONING

CC-2-3



## LEASE RATE

\$2.50/SF NNN



# INTERIOR PHOTOS



## AVAILABILITY

± 507 SF - 2,667 SF (Contiguous) Retail Space

- ± 1726 Euclid Ave: 507 SF: open retail with 1 restroom
- ± 1730 Euclid Ave: 507 SF: open retail with 1 restroom
- ± 1740 Euclid Ave: 1,653 SF: open retail with 1 restroom

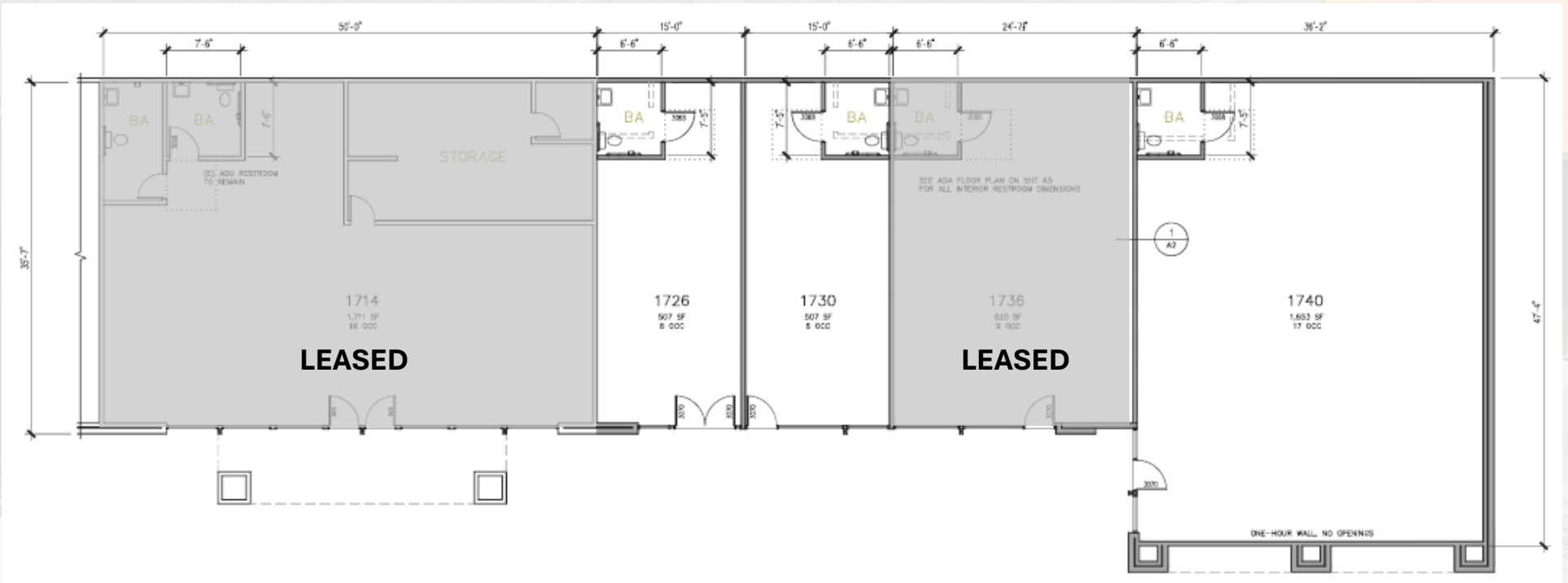

# CONTACT INFORMATION



## BO GIBBONS

Senior Vice President  
(858) 699-3458  
Bo@PacificCoastCommercial.com  
Lic. 01367936

## LEE SURYANI

Associate Vice President  
(619) 210-5265  
Lee@PacificCoastCommercial.com  
Lic. 01384873

## PACIFIC COAST COMMERCIAL

10721 Treena Street, Suite 200  
San Diego, CA 92131  
(619) 469-3600  
www.PacificCoastCommercial.com  
Lic. 01209930

The information contained herein has been given to us by the owner of the property or other sources we deem reliable, we have no reason to doubt its accuracy, but we do not guarantee it. All information should be verified prior to purchase or lease.



# 1714-1740 EUCLID AVENUE

SAN DIEGO, CA 92105