

# 1130 Oxford Street

OFFERING MEMORANDUM

**\$3,000,000.**



**NORHEIM  
& YOST**

732 Addison St. Suite "C"  
Berkeley, CA 94710  
BRE # 00770171

**Steve Smith**  
BRE# 01330154  
ss@noryost.com  
510-527-3400 x12

**Elena Holsman**  
BRE# 01731812  
eh@noryost.com  
510-527-3400 x11



## OFFERING SUMMARY



Norheim & Yost is pleased to present a unique opportunity in the heart of the beautiful Berkeley Hills. **1130 Oxford Street** is a  $\pm 1.26$  acre, or  **$\pm 54,847$  sq. ft. lot**, with frontage on both Oxford and Walnut Streets. The site currently contains **two buildings, once housing Oxford Elementary School**. The main building, which is rectangular in shape, contains  $\pm 27,124$  sq ft of building spread over three floors, with a footprint of  $\pm 75' \times 150'$ . The second building is circular in shape, containing  $\pm 5,500$  sq ft, with a footprint of 84' in diameter. Originally developed in 1909, the school was then rebuilt in 1965 and then remodeled and modernized in 1998. When functioning as Oxford Elementary, the buildings housed 16 classrooms, a library, offices, restrooms, a multipurpose room with an elevated stage and a commercial kitchen for onsite food service. The buildings are elevator served and contain two interior stairwells. Currently there is 800 amps / 3-phase power serving the property.





## DEVELOPMENT OPPORTUNITY

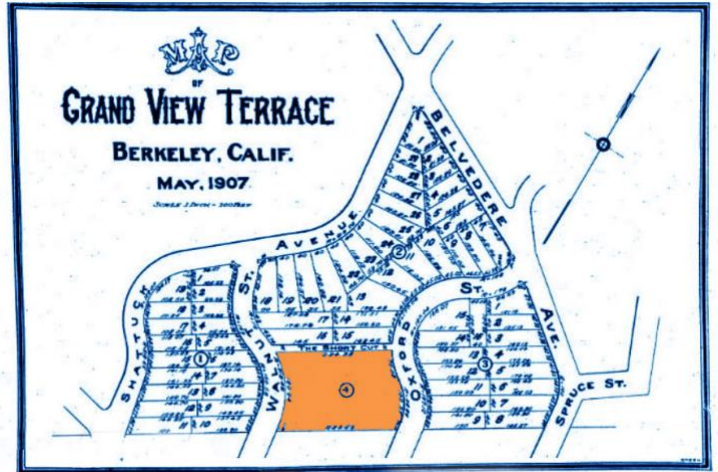

## R-1H ZONING HIGHLIGHTS (refer to development study)

- The R-1H zoning district is a Single-Family Residential zone, which requires minimum 5,000 sq. ft. per lot. Based on the lot size listed above, this would allow for subdivision of the existing lot into 10 new residential lots, 5 facing Oxford St and 5 facing Walnut St.
- New primary residences would be allowed to be up to 3 stories and occupy up to 40% of the lot. One parking space would be required, per primary residence.
- Multifamily uses are not allowed in this district. However, a detached ADU would be allowed on each of the 10 lots as well. The ADUs could be up to 1000 sqft in gross floor area and up to 20' tall, allowing for two stories.
- Non-residential uses are allowed with the approval of Use Permit with Public Hearing, a Zoning Certificate or an Administrative Use Permit.

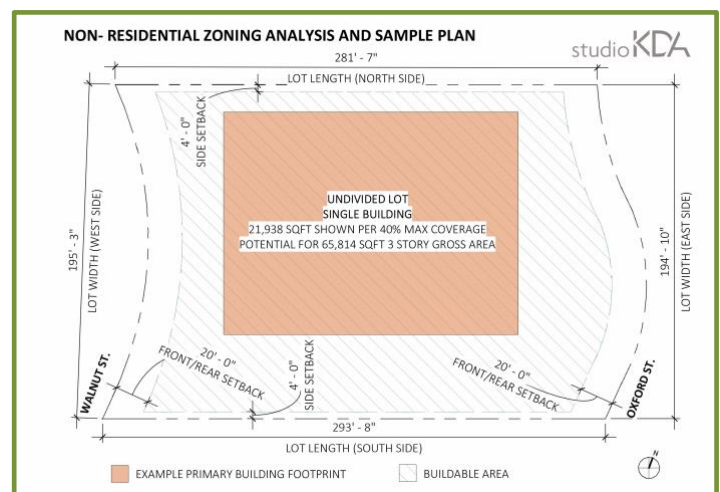
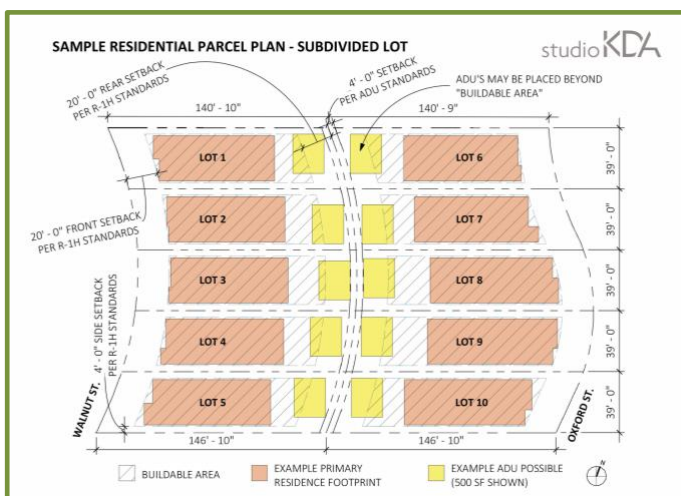

## NEIGHBORHOOD INFORMATION

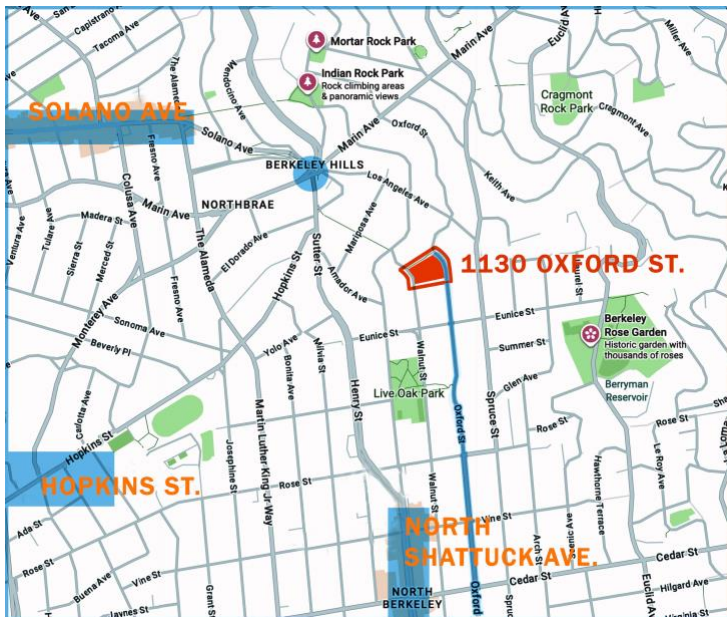

**1130 OXFORD STREET** presents a rare opportunity to own a substantial piece of land in one of the city's most desirable residential enclaves. This serene stretch of Oxford Street is known for its quiet, tree-lined ambiance, historic homes, and commanding views of the San Francisco Bay.

**OXFORD STREET** continues one mile south to **The University of California at Berkeley** and Downtown Berkeley with businesses shops and restaurants. Three unique shopping and dining areas are walkable distance. **SOLANO AVENUE** is two miles of neighborhood restaurants and businesses and hosts the annual Solano Stroll festival. **HOPKINS STREET** has a lively beer garden, specialty food shops including Monterey Market grocery, and garden nurseries. **NORTH SHATTUCK** is home to world-class dining including the seminal Chez Panisse, the original Peet's Coffee location, and upscale markets including Cheese Board Collective. **NATURE LOVERS** will appreciate nearby Live Oak Park, the Berkeley Rose Garden, rock climbing at Indian Rock, and hiking trails through Tilden Park, all just minutes away.

The location offers a true urban-suburban balance, with tranquil residential streets yet easy access to public transit. It has top-rated public schools with dedicated teachers and strong funding, and many cultural landmarks. Whether envisioning a private estate, multiple single-family lot development, or an owner/user site, this is an unmatched canvas for your vision.

### BERKELEY CITY-WIDE DEMOGRAPHICS

Population:  
**124,321**

Median Age:  
**31.3**

Housing Units:  
**52,331**

Occupancy:  
**91%**

Median Household Income:  
**\$108,558**

Berkeley Median Sold Price:  
**\$1,500,000-\$1,770,000**





## ADDITIONAL INFORMATION



The information contained in the Offering Memorandum is furnished solely for the purpose of review by a prospective purchaser of 1130 Oxford Street, Berkeley, California, and is not to be used for any other purpose. The material contained here is based in part upon information supplied by the owner of this property and in part upon information obtained by Norheim & Yost from sources deemed reliable. The information contained here is not intended to be comprehensive or all-inclusive and each potential buyer should verify all of its own material and research. No warranty or representation expressed or implied is made by the owner or by Norheim & Yost as to the accuracy of the information contained herein or any other written or oral communication transmitted to a prospective purchaser in the course of its evaluation of the property. The information contained herein was prepared by Norheim & Yost and reviewed by the owner and contains select information about the property and does not purport to be all inclusive or contain all of the information which a prospective purchaser may desire.